

# TRAFFIC CRASH REPORT

\*DENOTES MANDATORY FIELD FOR SUPPLEMENT REPORT

LOCAL REPORT NUMBER \*

2 | 0 | 2 | 3 | 1 | 4 | 4 | 2 |

PHOTOS TAKEN     OH-2     OH-3  
 SECONDARY CRASH     OH-1P     OTHER  
 Private Property

LOCAL INFORMATION

REPORTING AGENCY NAME \*

GARFIELD HEIGHTS

NCIC \*  
0 | 1 | 8 | 2 | 0

HITSKIP  
1 - Solved  
2 - Unsolved  
1

NUMBER OF UNITS  
0 | 2

UNIT IN EDDP  
98 - ANIMAL  
99 - UNKNOWN  
0 | 2

COUNTY \*  
1 | 8

LOCALITY \*  
1

LOCATION: CITY, VILLAGE, TOWNSHIP \*  
GARFIELD HTS

CRASH DATE/TIME \*  
0 | 5 | 2 | 7 | 2 | 0 | 2 | 3 | 0 | 8 | 1 | 5 |

CRASH SEVERITY  
5

1 - FATAL  
2 - SERIOUS INJURY SUSPECTED  
3 - MINOR INJURY SUSPECTED  
4 - INJURY POSSIBLE  
5 - PROPERTY DAMAGE ONLY

ROUTE TYPE  
ROUTE NUMBER  
PREFIX

1 - NORTH  
2 - SOUTH  
3 - EAST  
4 - WEST

LOCATION ROAD NAME  
EAST 85TH

ROAD TYPE  
S | T

LATITUDE DECIMAL DEGREES  
4 | 1 | . | 4 | 2 | 6 | 7 | 4 | 3 |

ROUTE TYPE  
ROUTE NUMBER  
PREFIX

1 - NORTH  
2 - SOUTH  
3 - EAST  
4 - WEST

REFERENCE ROAD NAME (ROAD, MILEPOST, HOUSE #)  
4874

ROAD TYPE

LONGITUDE DECIMAL DEGREES  
- 8 | 1 | . | 6 | 2 | 5 | 5 | 3 | 5 |

REFERENCE POINT  
1 - INTERSECTION  
2 - MILE POST  
3 - HOUSE #  
3

DIRECTION  
1 - NORTH  
2 - SOUTH  
3 - EAST  
4 - WEST

ROUTE TYPE  
IR - INTERSTATE ROUTE (TP)  
US - FEDERAL US ROUTE  
SR - STATE ROUTE  
CR - NUMBERED COUNTY ROUTE  
TR - NUMBERED TOWNSHIP ROUTE

ROAD TYPE  
AL - ALLEY  
AV - AVENUE  
BL - BOULEVARD  
CR - CIRCLE  
CT - COURT  
DR - DRIVE  
HE - HEIGHTS  
HW - HIGHWAY  
LA - LANE  
MP - MILEPOST  
OV - OVAL  
PK - PARKWAY  
PI - PIKE  
PL - PLACE  
RD - ROAD  
SQ - SQUARE  
ST - STREET  
TE - TERRACE  
TL - TRAIL  
WA - WAY

INTERSECTION RELATED  
 WITHIN INTERSECTION OR ON APPROACH  
 WITHIN INTERCHANGE AREA

NUMBER OF APPROACHES

DISTANCE  
1 - Miles  
2 - Feet  
3 - Yards

DISTANCE  
1 - Miles  
2 - Feet  
3 - Yards

ROADWAY  
 ROADWAY DIVIDED

LOCATION OF FIRST DAMAGE EVENT  
0 | 1

1 - ON ROADWAY  
2 - ON SHOULDER  
3 - IN MEDIAN  
4 - ON ROADSIDE  
5 - ON GORE  
6 - OUTSIDE TRAFFICWAY  
7 - ON RAMP  
8 - OFF RAMP  
9 - CROSSOVER  
10 - DRIVEWAY / ALLEY ACCESS  
11 - RAILWAY GRADE CROSSING  
12 - SHARED USE PATHS OR TRAILS  
13 - BIKE LANE  
14 - TOLL BOOTH  
99 - OTHER / UNKNOWN

MANNER OF CRASH COLLISION/IMPACT  
1

1 - NOT COLLISION BETWEEN TWO MOTOR VEHICLES IN TRANSPORT  
2 - REAR-END  
3 - HEAD-ON  
4 - REAR-TO-REAR  
5 - BACKING  
6 - ANGLE  
7 - SIDESWIPE, SAME DIRECTION  
8 - SIDESWIPE, OPPOSITE DIRECTION  
9 - OTHER / UNKNOWN

DIRECTION OF TRAVEL  
1 - NORTH  
2 - SOUTH  
3 - EAST  
4 - WEST

MEDIAN TYPE  
1 - DIVIDED FLUSH MEDIAN (<4 FEET)  
2 - DIVIDED FLUSH MEDIAN (24 FEET)  
3 - DIVIDED, DEPRESSED MEDIAN  
4 - DIVIDED, RAISED MEDIAN (ANY TYPE)  
9 - OTHER / UNKNOWN

WORK ZONE RELATED  
 WORKERS PRESENT  
 LAW ENFORCEMENT PRESENT  
 ACTIVE SCHOOL ZONE

WORK ZONE TYPE  
1 - LANE CLOSURE  
2 - LANE SHIFT/CROSSOVER  
3 - WORK ON SHOULDER  
4 - INTERMITTENT OR MOVING WORK  
5 - OTHER

LOCATION OF CRASH IN WORK ZONE  
1 - BEFORE THE 1ST WORK ZONE WARNING SIGN  
2 - ADVANCE WARNING AREA  
3 - TRANSITION AREA  
4 - ACTIVITY AREA  
5 - TERMINATION AREA

CONTOUR  
1

1 - STRAIGHT LEVEL  
2 - STRAIGHT GRADE  
3 - CURVE LEVEL  
4 - CURVE GRADE  
9 - OTHER / UNKNOWN

CONDITIONS  
1

1 - DRY  
2 - WET  
3 - SNOW  
4 - ICE  
5 - SAND, MUD, DIRT, OIL, GRAVEL  
6 - WATER (STANDING, MOVING)  
7 - SLUSH  
9 - OTHER/UNKNOWN

SURFACE  
2

1 - CONCRETE  
2 - BLACKTOP, BITUMINOUS, ASPHALT  
3 - BRICK/BLOCK  
4 - SLAG, GRAVEL, STONE  
5 - DIRT  
9 - OTHER / UNKNOWN

LIGHT CONDITION  
3

1 - DAYLIGHT  
2 - DAWN/DUSK  
3 - DARK - LIGHTED ROADWAY  
4 - DARK - ROADWAY NOT LIGHTED  
5 - DARK - UNKNOWN ROADWAY LIGHTING  
9 - OTHER / UNKNOWN

WEATHER  
1

1 - CLEAR  
2 - CLOUDY  
3 - FOG, SMOG, SMOKE  
4 - RAIN  
5 - SLEET, HAIL  
6 - SNOW  
7 - SEVERE CROSSWINDS  
8 - BLOWING SAND, SOIL, DIRT, SNOW  
9 - FREEZING RAIN OR FREEZING DRIZZLE  
99 - OTHER / UNKNOWN

CONTOUR  
1

CONDITIONS  
1

SURFACE  
2

NARRATIVE  
UNIT #1 WAS LEGALLY PARKED, UNOCCUPIED, IN FRONT OF 4874 E. 85TH STREET. UNIT #2 (HIT/SKIP VEHICLE) WAS TRAVELLING S/B ON E. 85TH STREET AND STRUCK THE LEFT REAR OF UNIT #1. UPON CHECKING THE AREA I LOCATED A BLACK CHEVY MALIBU (OHIO REG. # JZP6266) WITH FRESH MATCHING DAMAGE IN THE DRIVEWAY OF 4965 E. 85TH STREET. I WAS ABLE TO MAKE CONTACT WITH THE OWNER, LASHAWN WILLIAMS, ON 5/31/2023 AND SHE STATED SHE WAS OUT OF TOWN FOR THE WEEKEND AND ONE OF HER RELATIVES (UNKNOWN WHICH) MUST HAVE USED HER CAR AND STRUCK THE VEHICLE.

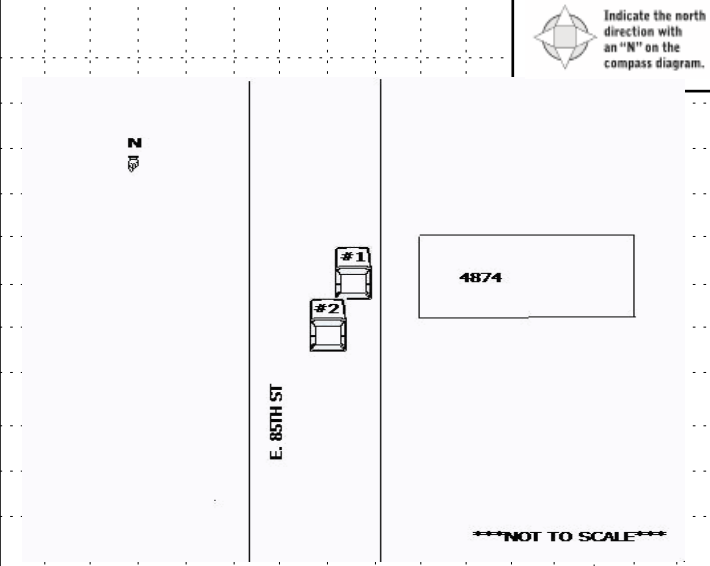

CRASH REPORTED DATE/TIME  
0 | 5 | 2 | 7 | 2 | 0 | 2 | 3 | 0 | 8 | 1 | 5 |

DISPATCH DATE/TIME  
0 | 5 | 2 | 7 | 2 | 0 | 2 | 3 | 0 | 9 | 0 | 6 |

ARRIVAL DATE/TIME  
0 | 5 | 2 | 7 | 2 | 0 | 2 | 3 | 0 | 9 | 1 | 5 |

SCENE CLEARED DATE/TIME  
0 | 5 | 2 | 7 | 2 | 0 | 2 | 3 | 0 | 9 | 5 | 2 |

REPORT TAKEN BY  
 POLICE AGENCY  
 MOTORIST

TOTAL TIME ROADWAY CLOSED  
0

OTHER INVESTIGATION TIME  
4 | 4

TOTAL MINUTES  
8 | 1

OFFICER'S NAME \*  
T. Tatulinski

OFFICER'S BADGE NUMBER \*  
0 | 0 | 6 |

CHECKED BY OFFICER'S NAME \*  
T. Baon

CHECKED BY OFFICER'S BADGE NUMBER \*  
S | 2 | 0 |

SUPPLEMENT  
 (CORRECTION = ADDITION)

OWNER INFORMATION

UNIT # 0 1 OWNER NAME: LAST, FIRST, MIDDLE ( ) Same As Driver  
**BROWNLEE JEVAON DESEAN**

OWNER PHONE: INCLUDE AREA CODE ( ) Same As Driver

OWNER ADDRESS: STREET, CITY, STATE, ZIP ( ) Same As Driver  
**4877 E 85 ST UP GARFIELD HTS OH 44125**

COMMERCIAL CARRIER: NAME, ADDRESS, CITY, STATE, ZIP

COMMERCIAL CARRIER PHONE: INCLUDE AREA CODE

DAMAGE

DAMAGE SCALE

1 - NONE  
2 - MINOR DAMAGE  
3 - FUNCTIONAL DAMAGE  
4 - DISABLING DAMAGE  
9 - UNKNOWN

2

VEHICLE INFORMATION

LP STATE OH LICENSE PLATE # JYV6789 VEHICLE IDENTIFICATION # 1C3C3CB1B71DN727289 VEHICLE YEAR 2013 VEHICLE MAKE Chrysler

INSURANCE VERIFIED  INSURANCE COMPANY FOUNDERS INSURANCE POLICY # \_\_\_\_\_ VEHICLE COLOR BLU VEHICLE MODEL Other/Unknw

TYPE OF USE:  COMMERCIAL  GOVERNMENT  IN EMERGENCY RESPONSE

INTERLOCK DEVICE EQUIPPED  HIT/SKIP UNIT  # OCCUPANTS 0 0 US DOT # \_\_\_\_\_ TOWED BY: COMPANY NAME \_\_\_\_\_

HAZARDOUS MATERIAL:  MATERIAL RELEASED CLASS # \_\_\_\_\_ PLACARD ID # \_\_\_\_\_

DAMAGED AREA(S)

INDICATE ALL THAT APPLY

VEHICLE WEIGHT GVWR/GVWR

1 - ≤10K LBS.  
2 - 10,001 - 26K LBS.  
3 - >26K LBS.

VEHICLE TYPE

1 - PASSENGER CAR  
2 - PASSENGER VAN (MINIVAN)  
3 - SPORT UTILITY VEHICLE  
4 - PICK UP  
5 - CARGO VAN  
6 - VAN (9-15 SEATS)  
7 - MOTORCYCLE 2-WHEELED  
8 - MOTORCYCLE 3-WHEELED  
9 - AUTOCYCLE  
10 - MOPED OR MOTORIZED BICYCLE  
11 - ALL TERRAIN VEHICLE (ATV / UTV)  
12 - GOLF CART  
13 - SNOWMOBILE  
14 - SINGLE UNIT TRUCK  
15 - SEMI-TRACTOR  
16 - FARM EQUIPMENT  
17 - MOTORHOME  
18 - LIMO (LIVERY VEHICLE)  
19 - BUS (16+ PASSENGERS)  
20 - OTHER VEHICLE  
21 - HEAVY EQUIPMENT  
22 - ANIMAL WITH RIDER OR ANIMAL-DRAWN VEHICLE  
23 - PEDESTRIANSKATER  
24 - WHEELCHAIR (ANY TYPE)  
25 - OTHER NON-MOTORIST  
26 - BICYCLE  
27 - TRAIN  
99 - UNKNOWN OR HIT/SKIP

# OF TRAILING UNITS \_\_\_\_\_

WAS VEHICLE OPERATING IN AUTONOMOUS MODE WHEN CRASH OCCURRED? 2

1 - YES 2 - NO 9 - OTHER / UNKNOWN

AUTONOMOUS MODE LEVEL 0

0 - NO AUTOMATION  
1 - DRIVER ASSISTANCE  
2 - PARTIAL AUTOMATION  
3 - CONDITIONAL AUTOMATION  
4 - HIGH AUTOMATION  
5 - FULL AUTOMATION  
9 - UNKNOWN

SPECIAL FUNCTION 0 1

1 - NONE  
2 - TAXI  
3 - ELECTRONIC RIDE SHARING  
4 - SCHOOL TRANSPORT  
5 - BUS-TRANSIT/COMMUTER  
6 - BUS - CHARTER/TOUR  
7 - BUS - INTERCITY  
8 - BUS - SHUTTLE  
9 - BUS - OTHER  
10 - AMBULANCE  
11 - FIRE  
12 - MILITARY  
13 - POLICE  
14 - PUBLIC UTILITY  
15 - CONSTRUCTION EQUIPMENT  
16 - FARM  
17 - MOWING  
18 - SNOW REMOVAL  
19 - TOWING  
20 - SAFETY SERVICE PATROL  
21 - MAIL CARRIER  
99 - OTHER UNKNOWN

CARGO BODY TYPE 0 1

1 - NO CARGO BODY TYPE / NOT APPLICABLE  
2 - BUS  
3 - VEHICLE TOWING ANOTHER MOTOR VEHICLE  
4 - LOGGING  
5 - INTERMODAL CONTAINER CHASSIS  
6 - CARGO VAN/ENCLOSED BOX  
7 - GRAIN/CHIPS/GRAVEL  
8 - POLE  
9 - CARGO TANK  
10 - FLAT BED  
11 - DUMP  
12 - CONCRETE MIXER  
13 - AUTO TRANSPORTER  
14 - GARBAGE/REFUSE  
99 - OTHER / UNKNOWN

VEHICLE DEFECTS

1 - TURN SIGNALS  
2 - HEAD LAMPS  
3 - TAIL LAMPS  
4 - BRAKES  
5 - STEERING  
6 - TIRE BLOWOUT  
7 - WORN OR SLICK TIRES  
8 - TRAILER EQUIPMENT DEFECTIVE  
9 - MOTOR TROUBLE  
10 - DISABLED FROM PRIOR ACCIDENT  
99 - OTHER / UNKNOWN

NON-MOTORIST LOCATION AT IMPACT 0 1

1 - INTERSECTION - MARKED CROSSWALK  
2 - INTERSECTION - UNMARKED CROSSWALK  
3 - INTERSECTION - OTHER  
4 - MIDBLOCK - MARKED CROSSWALK  
5 - TRAVEL LANE-OTHER LOCATION  
6 - BICYCLE LANE  
7 - SHOULDER/ROADSIDE  
8 - SIDEWALK  
9 - MEDIAN/CROSSING ISLAND  
10 - DRIVEWAY ACCESS  
11 - SHARED USE PATHS OR TRAILS  
12 - FIRST RESPONDER AT INCIDENT SCENE  
99 - OTHER / UNKNOWN

ACTION 4

1 - NON-CONTACT  
2 - NON-COLLISION  
3 - STRIKING  
4 - STRUCK  
5 - BOTH STRIKING & STRUCK  
9 - OTHER / UNKNOWN  
1 - STRAIGHT AHEAD  
2 - BACKING  
3 - CHANGING LANES  
4 - OVERTAKING/PASSING  
5 - MAKING RIGHT TURN  
6 - MAKING LEFT TURN  
7 - MAKING U-TURN  
8 - ENTERING TRAFFIC LANE  
9 - LEAVING TRAFFIC LANE  
10 - PARKED  
11 - SLOWING OR STOPPED IN TRAFFIC  
12 - DRIVERLESS  
13 - NEGOTIATING A CURVE  
14 - ENTERING OR CROSSING SPECIFIED LOCATION  
15 - WALKING, RUNNING, JOGGING, PLAYING  
16 - WORKING  
17 - PUSHING VEHICLE  
18 - APPROACHING OR LEAVING VEHICLE  
19 - STANDING  
20 - OTHER NON-MOTORIST  
21 - STANDING OUTSIDE DISABLED VEHICLE  
99 - OTHER / UNKNOWN

INITIAL POINT OF CONTACT 0 7

0 - NO DAMAGE  
1-12 - REFER TO UNIT DIAGRAM  
13 - TOP  
14 - UNDERCARRIAGE  
15 - VEHICLE NOT AT SCENE  
99 - UNKNOWN

TRAFFIC

TRAFFICWAY FLOW 2

1 - ONE-WAY  
2 - TWO-WAY

TRAFFIC CONTROL 6

1 - ROUNDABOUT  
2 - SIGNAL  
3 - FLASHER  
4 - STOP SIGN  
5 - YIELD SIGN  
6 - NO CONTROL

VEHICLE INFORMATION

LP STATE OH LICENSE PLATE # JYV6789 VEHICLE IDENTIFICATION # 1C3C3CB1B71DN727289 VEHICLE YEAR 2013 VEHICLE MAKE Chrysler

INSURANCE VERIFIED  INSURANCE COMPANY FOUNDERS INSURANCE POLICY # \_\_\_\_\_ VEHICLE COLOR BLU VEHICLE MODEL Other/Unknw

TYPE OF USE:  COMMERCIAL  GOVERNMENT  IN EMERGENCY RESPONSE

INTERLOCK DEVICE EQUIPPED  HIT/SKIP UNIT  # OCCUPANTS 0 0 US DOT # \_\_\_\_\_ TOWED BY: COMPANY NAME \_\_\_\_\_

HAZARDOUS MATERIAL:  MATERIAL RELEASED CLASS # \_\_\_\_\_ PLACARD ID # \_\_\_\_\_

VEHICLE TYPE

1 - PASSENGER CAR  
2 - PASSENGER VAN (MINIVAN)  
3 - SPORT UTILITY VEHICLE  
4 - PICK UP  
5 - CARGO VAN  
6 - VAN (9-15 SEATS)  
7 - MOTORCYCLE 2-WHEELED  
8 - MOTORCYCLE 3-WHEELED  
9 - AUTOCYCLE  
10 - MOPED OR MOTORIZED BICYCLE  
11 - ALL TERRAIN VEHICLE (ATV / UTV)  
12 - GOLF CART  
13 - SNOWMOBILE  
14 - SINGLE UNIT TRUCK  
15 - SEMI-TRACTOR  
16 - FARM EQUIPMENT  
17 - MOTORHOME  
18 - LIMO (LIVERY VEHICLE)  
19 - BUS (16+ PASSENGERS)  
20 - OTHER VEHICLE  
21 - HEAVY EQUIPMENT  
22 - ANIMAL WITH RIDER OR ANIMAL-DRAWN VEHICLE  
23 - PEDESTRIANSKATER  
24 - WHEELCHAIR (ANY TYPE)  
25 - OTHER NON-MOTORIST  
26 - BICYCLE  
27 - TRAIN  
99 - UNKNOWN OR HIT/SKIP

# OF TRAILING UNITS \_\_\_\_\_

WAS VEHICLE OPERATING IN AUTONOMOUS MODE WHEN CRASH OCCURRED? 2

1 - YES 2 - NO 9 - OTHER / UNKNOWN

AUTONOMOUS MODE LEVEL 0

0 - NO AUTOMATION  
1 - DRIVER ASSISTANCE  
2 - PARTIAL AUTOMATION  
3 - CONDITIONAL AUTOMATION  
4 - HIGH AUTOMATION  
5 - FULL AUTOMATION  
9 - UNKNOWN

SPECIAL FUNCTION 0 1

1 - NONE  
2 - TAXI  
3 - ELECTRONIC RIDE SHARING  
4 - SCHOOL TRANSPORT  
5 - BUS-TRANSIT/COMMUTER  
6 - BUS - CHARTER/TOUR  
7 - BUS - INTERCITY  
8 - BUS - SHUTTLE  
9 - BUS - OTHER  
10 - AMBULANCE  
11 - FIRE  
12 - MILITARY  
13 - POLICE  
14 - PUBLIC UTILITY  
15 - CONSTRUCTION EQUIPMENT  
16 - FARM  
17 - MOWING  
18 - SNOW REMOVAL  
19 - TOWING  
20 - SAFETY SERVICE PATROL  
21 - MAIL CARRIER  
99 - OTHER UNKNOWN

CARGO BODY TYPE 0 1

1 - NO CARGO BODY TYPE / NOT APPLICABLE  
2 - BUS  
3 - VEHICLE TOWING ANOTHER MOTOR VEHICLE  
4 - LOGGING  
5 - INTERMODAL CONTAINER CHASSIS  
6 - CARGO VAN/ENCLOSED BOX  
7 - GRAIN/CHIPS/GRAVEL  
8 - POLE  
9 - CARGO TANK  
10 - FLAT BED  
11 - DUMP  
12 - CONCRETE MIXER  
13 - AUTO TRANSPORTER  
14 - GARBAGE/REFUSE  
99 - OTHER / UNKNOWN

VEHICLE DEFECTS

1 - TURN SIGNALS  
2 - HEAD LAMPS  
3 - TAIL LAMPS  
4 - BRAKES  
5 - STEERING  
6 - TIRE BLOWOUT  
7 - WORN OR SLICK TIRES  
8 - TRAILER EQUIPMENT DEFECTIVE  
9 - MOTOR TROUBLE  
10 - DISABLED FROM PRIOR ACCIDENT  
99 - OTHER / UNKNOWN

NON-MOTORIST LOCATION AT IMPACT 0 1

1 - INTERSECTION - MARKED CROSSWALK  
2 - INTERSECTION - UNMARKED CROSSWALK  
3 - INTERSECTION - OTHER  
4 - MIDBLOCK - MARKED CROSSWALK  
5 - TRAVEL LANE-OTHER LOCATION  
6 - BICYCLE LANE  
7 - SHOULDER/ROADSIDE  
8 - SIDEWALK  
9 - MEDIAN/CROSSING ISLAND  
10 - DRIVEWAY ACCESS  
11 - SHARED USE PATHS OR TRAILS  
12 - FIRST RESPONDER AT INCIDENT SCENE  
99 - OTHER / UNKNOWN

ACTION 4

1 - NON-CONTACT  
2 - NON-COLLISION  
3 - STRIKING  
4 - STRUCK  
5 - BOTH STRIKING & STRUCK  
9 - OTHER / UNKNOWN  
1 - STRAIGHT AHEAD  
2 - BACKING  
3 - CHANGING LANES  
4 - OVERTAKING/PASSING  
5 - MAKING RIGHT TURN  
6 - MAKING LEFT TURN  
7 - MAKING U-TURN  
8 - ENTERING TRAFFIC LANE  
9 - LEAVING TRAFFIC LANE  
10 - PARKED  
11 - SLOWING OR STOPPED IN TRAFFIC  
12 - DRIVERLESS  
13 - NEGOTIATING A CURVE  
14 - ENTERING OR CROSSING SPECIFIED LOCATION  
15 - WALKING, RUNNING, JOGGING, PLAYING  
16 - WORKING  
17 - PUSHING VEHICLE  
18 - APPROACHING OR LEAVING VEHICLE  
19 - STANDING  
20 - OTHER NON-MOTORIST  
21 - STANDING OUTSIDE DISABLED VEHICLE  
99 - OTHER / UNKNOWN

INITIAL POINT OF CONTACT 0 7

0 - NO DAMAGE  
1-12 - REFER TO UNIT DIAGRAM  
13 - TOP  
14 - UNDERCARRIAGE  
15 - VEHICLE NOT AT SCENE  
99 - UNKNOWN

TRAFFIC

TRAFFICWAY FLOW 2

1 - ONE-WAY  
2 - TWO-WAY

TRAFFIC CONTROL 6

1 - ROUNDABOUT  
2 - SIGNAL  
3 - FLASHER  
4 - STOP SIGN  
5 - YIELD SIGN  
6 - NO CONTROL

VEHICLE INFORMATION

LP STATE OH LICENSE PLATE # JYV6789 VEHICLE IDENTIFICATION # 1C3C3CB1B71DN727289 VEHICLE YEAR 2013 VEHICLE MAKE Chrysler

INSURANCE VERIFIED  INSURANCE COMPANY FOUNDERS INSURANCE POLICY # \_\_\_\_\_ VEHICLE COLOR BLU VEHICLE MODEL Other/Unknw

TYPE OF USE:  COMMERCIAL  GOVERNMENT  IN EMERGENCY RESPONSE

INTERLOCK DEVICE EQUIPPED  HIT/SKIP UNIT  # OCCUPANTS 0 0 US DOT # \_\_\_\_\_ TOWED BY: COMPANY NAME \_\_\_\_\_

HAZARDOUS MATERIAL:  MATERIAL RELEASED CLASS # \_\_\_\_\_ PLACARD ID # \_\_\_\_\_

VEHICLE TYPE

1 - PASSENGER CAR  
2 - PASSENGER VAN (MINIVAN)  
3 - SPORT UTILITY VEHICLE  
4 - PICK UP  
5 - CARGO VAN  
6 - VAN (9-15 SEATS)  
7 - MOTORCYCLE 2-WHEELED  
8 - MOTORCYCLE 3-WHEELED  
9 - AUTOCYCLE  
10 - MOPED OR MOTORIZED BICYCLE  
11 - ALL TERRAIN VEHICLE (ATV / UTV)  
12 - GOLF CART  
13 - SNOWMOBILE  
14 - SINGLE UNIT TRUCK  
15 - SEMI-TRACTOR  
16 - FARM EQUIPMENT  
17 - MOTORHOME  
18 - LIMO (LIVERY VEHICLE)  
19 - BUS (16+ PASSENGERS)  
20 - OTHER VEHICLE  
21 - HEAVY EQUIPMENT  
22 - ANIMAL WITH RIDER OR ANIMAL-DRAWN VEHICLE  
23 - PEDESTRIANSKATER  
24 - WHEELCHAIR (ANY TYPE)  
25 - OTHER NON-MOTORIST  
26 - BICYCLE  
27 - TRAIN  
99 - UNKNOWN OR HIT/SKIP

# OF TRAILING UNITS \_\_\_\_\_

WAS VEHICLE OPERATING IN AUTONOMOUS MODE WHEN CRASH OCCURRED? 2

1 - YES 2 - NO 9 - OTHER / UNKNOWN

AUTONOMOUS MODE LEVEL 0

0 - NO AUTOMATION  
1 - DRIVER ASSISTANCE  
2 - PARTIAL AUTOMATION  
3 - CONDITIONAL AUTOMATION  
4 - HIGH AUTOMATION  
5 - FULL AUTOMATION  
9 - UNKNOWN

SPECIAL FUNCTION 0 1

1 - NONE  
2 - TAXI  
3 - ELECTRONIC RIDE SHARING  
4 - SCHOOL TRANSPORT  
5 - BUS-TRANSIT/COMMUTER  
6 - BUS - CHARTER/TOUR  
7 - BUS - INTERCITY  
8 - BUS - SHUTTLE  
9 - BUS - OTHER  
10 - AMBULANCE  
11 - FIRE  
12 - MILITARY  
13 - POLICE  
14 - PUBLIC UTILITY  
15 - CONSTRUCTION EQUIPMENT  
16 - FARM  
17 - MOWING  
18 - SNOW REMOVAL  
19 - TOWING  
20 - SAFETY SERVICE PATROL  
21 - MAIL CARRIER  
99 - OTHER UNKNOWN

CARGO BODY TYPE 0 1

1 - NO CARGO BODY TYPE / NOT APPLICABLE  
2 - BUS  
3 - VEHICLE TOWING ANOTHER MOTOR VEHICLE  
4 - LOGGING  
5 - INTERMODAL CONTAINER CHASSIS  
6 - CARGO VAN/ENCLOSED BOX  
7 - GRAIN/CHIPS/GRAVEL  
8 - POLE  
9 - CARGO TANK  
10 - FLAT BED  
11 - DUMP  
12 - CONCRETE MIXER  
13 - AUTO TRANSPORTER  
14 - GARBAGE/REFUSE  
99 - OTHER / UNKNOWN

VEHICLE DEFECTS

1 - TURN SIGNALS  
2 - HEAD LAMPS  
3 - TAIL LAMPS  
4 - BRAKES  
5 - STEERING  
6 - TIRE BLOWOUT  
7 - WORN OR SLICK TIRES  
8 - TRAILER EQUIPMENT DEFECTIVE  
9 - MOTOR TROUBLE  
10 - DISABLED FROM PRIOR ACCIDENT  
99 - OTHER / UNKNOWN

NON-MOTORIST LOCATION AT IMPACT 0 1

1 - INTERSECTION - MARKED CROSSWALK  
2 - INTERSECTION - UNMARKED CROSSWALK  
3 - INTERSECTION - OTHER  
4 - MIDBLOCK - MARKED CROSSWALK  
5 - TRAVEL LANE-OTHER LOCATION  
6 - BICYCLE LANE  
7 - SHOULDER/ROADSIDE  
8 - SIDEWALK  
9 - MEDIAN/CROSSING ISLAND  
10 - DRIVEWAY ACCESS  
11 - SHARED USE PATHS OR TRAILS  
12 - FIRST RESPONDER AT INCIDENT SCENE  
99 - OTHER / UNKNOWN

ACTION 4

1 - NON-CONTACT  
2 - NON-COLLISION  
3 - STRIKING  
4 - STRUCK  
5 - BOTH STRIKING & STRUCK  
9 - OTHER / UNKNOWN  
1 - STRAIGHT AHEAD  
2 - BACKING  
3 - CHANGING LANES  
4 - OVERTAKING/PASSING  
5 - MAKING RIGHT TURN  
6 - MAKING LEFT TURN  
7 - MAKING U-TURN  
8 - ENTERING TRAFFIC LANE  
9 - LEAVING TRAFFIC LANE  
10 - PARKED  
11 - SLOWING OR STOPPED IN TRAFFIC  
12 - DRIVERLESS  
13 - NEGOTIATING A CURVE  
14 - ENTERING OR CROSSING SPECIFIED LOCATION  
15 - WALKING, RUNNING, JOGGING, PLAYING  
16 - WORKING  
17 - PUSHING VEHICLE  
18 - APPROACHING OR LEAVING VEHICLE  
19 - STANDING  
20 - OTHER NON-MOTORIST  
21 - STANDING OUTSIDE DISABLED VEHICLE  
99 - OTHER / UNKNOWN

INITIAL POINT OF CONTACT 0 7

0 - NO DAMAGE  
1-12 - REFER TO UNIT DIAGRAM  
13 - TOP  
14 - UNDERCARRIAGE  
15 - VEHICLE NOT AT SCENE  
99 - UNKNOWN

TRAFFIC

TRAFFICWAY FLOW 2

1 - ONE-WAY  
2 - TWO-WAY

TRAFFIC CONTROL 6

1 - ROUNDABOUT  
2 - SIGNAL  
3 - FLASHER  
4 - STOP SIGN  
5 - YIELD SIGN  
6 - NO CONTROL

EVENT(S)

SEQUENCE OF EVENTS

EVENTS

1 2 0

1 - OVERTURN/ROLLOVER  
2 - FIRE/EXPLOSION  
3 - IMMERSION  
4 - JACKKNIFE  
5 - CARGO / EQUIPMENT LOSS OR SHIFT  
6 - EQUIPMENT FAILURE  
7 - SEPARATION OF UNITS  
8 - RAN OFF ROAD RIGHT  
9 - RAN OFF ROAD LEFT  
10 - CROSS MEDIAN  
11 - CROSS CENTERLINE - OPPOSITE DIRECTION OF TRAVEL  
12 - DOWNHILL RUNAWAY  
13 - OTHER NON-COLLISION  
14 - PEDESTRIAN  
15 - PEDALCYCLE  
16 - RAILWAY VEHICLE  
17 - ANIMAL - FARM  
18 - ANIMAL - DEER  
19 - ANIMAL - OTHER  
20 - MOTOR VEHICLE IN TRANSPORT  
21 - PARKED MOTOR VEHICLE  
22 - WORK ZONE MAINTENANCE EQUIPMENT  
23 - STRUCK BY FALLING, SHIFTING CARGO OR ANYTHING SET IN MOTION BY A MOTOR VEHICLE  
24 - OTHER MOVABLE OBJECT

COLLISION WITH FIXED OBJECT - STRUCK

25 - IMPACT ATTENUATOR / CRASH CUSHION  
26 - BRIDGE OVERHEAD STRUCTURE  
27 - BRIDGE PIER OR ABUTMENT  
28 - BRIDGE PARAPET  
29 - BRIDGE RAIL  
30 - GUARDRAIL FACE  
31 - GUARDRAIL END  
32 - PORTABLE BARRIER  
33 - MEDIAN CABLE BARRIER  
34 - MEDIAN GUARDRAIL BARRIER  
35 - MEDIAN CONCRETE BARRIER  
36 - MEDIAN OTHER BARRIER  
37 - TRAFFIC SIGN POST  
38 - OVERHEAD SIGN POST  
39 - LIGHT/LUMINARIES SUPPORT  
40 - UTILITY POLE  
41 - OTHER POST, POLE OR SUPPORT  
42 - CULVERT  
43 - CURB  
44 - DITCH  
45 - EMBANKMENT  
46 - FENCE  
47 - MAILBOX  
48 - TREE  
49 - FIRE HYDRANT  
50 - WORKZONE MAINTENANCE EQUIPMENT  
51 - WALL  
52 - BUILDING  
53 - TUNNEL  
54 - OTHER FIXED OBJECT  
99 - OTHER / UNKNOWN

FIRST HARMFUL EVENT 1 MOST HARMFUL EVENT 1

INITIAL POINT OF CONTACT 0 7

0 - NO DAMAGE  
1-12 - REFER TO UNIT DIAGRAM  
13 - TOP  
14 - UNDERCARRIAGE  
15 - VEHICLE NOT AT SCENE  
99 - UNKNOWN

TRAFFIC

TRAFFICWAY FLOW 2

1 - ONE-WAY  
2 - TWO-WAY

TRAFFIC CONTROL 6

1 - ROUNDABOUT  
2 - SIGNAL  
3 - FLASHER  
4 - STOP SIGN  
5 - YIELD SIGN  
6 - NO CONTROL

# OF THROUGH LANES ON ROAD 2

RAIL GRADE CROSSING

1 - NOT INVOLVED  
2 - INVOLVED - ACTIVE CROSSING  
3 - INVOLVED - PASSIVE CROSSING

UNIT / NON-MOTORIST DIRECTION

FROM 1 TO 2

1 - NORTH  
2 - SOUTH  
3 - EAST  
4 - WEST  
5 - NORTHEAST  
6 - NORTHWEST  
7 - SOUTHEAST  
8 - SOUTHWEST  
9 - OTHER / UNKNOWN

UNIT SPEED 0

POSTED SPEED 2 5

DETECTED SPEED

1 - STATED/ESTIMATED SPEED  
2 - CALCULATED / EDR  
3 - UNDETERMINED

UNIT # 012 OWNER NAME: LAST, FIRST, MIDDLE ( ) Same As Driver  
**WILLIAMS LASHAWN MONIQUE**  
 OWNER PHONE: INCLUDE AREA CODE ( ) Same As Driver  
 OWNER ADDRESS: STREET, CITY, STATE, ZIP ( ) Same As Driver  
**4965 E 85TH ST GARFIELD HTS OH 44125**  
 COMMERCIAL CARRIER: NAME, ADDRESS, CITY, STATE, ZIP  
 COMMERCIAL CARRIER PHONE: INCLUDE AREA CODE

LP STATE OH LICENSE PLATE # JZP6266 VEHICLE IDENTIFICATION # 1G1ZC5E101C1F104740 VEHICLE YEAR 2012 VEHICLE MAKE Chevrolet  
 INSURANCE VERIFIED INSURANCE COMPANY GEICO INSURANCE POLICY # \_\_\_\_\_ VEHICLE COLOR BLK VEHICLE MODEL Malibu  
 COMMERCIAL  GOVERNMENT  IN EMERGENCY RESPONSE US DOT # \_\_\_\_\_ TOWED BY: COMPANY NAME \_\_\_\_\_  
 INTERLOCK DEVICE EQUIPPED  HIT/SKIP UNIT # OCCUPANTS 01 VEHICLE WEIGHT GVWR/GVWR HAZARDOUS MATERIAL  
 1- <10K LBS. 2- 10,001 - 26K LBS. 3- >26K LBS.  MATERIAL RELEASED CLASS # \_\_\_\_\_ PLACARD ID # \_\_\_\_\_  
 PLACARD

UNIT TYPE 01 # of TRAILING UNITS \_\_\_\_\_  
 1 - PASSENGER CAR 7 - MOTORCYCLE 2-WHEELED 12 - GOLF CART 18 - LIMO (LIVERY VEHICLE) 23 - PEDESTRIAN SKATER  
 2 - PASSENGER VAN (MINIVAN) 8 - MOTORCYCLE 3-WHEELED 13 - SNOWMOBILE 19 - BUS (16+ PASSENGERS) 24 - WHEELCHAIR (ANY TYPE)  
 3 - SPORT UTILITY VEHICLE 9 - AUTOCYCLE 14 - SINGLE UNIT TRUCK 20 - OTHER VEHICLE 25 - OTHER NON-MOTORIST  
 4 - PICK UP 10 - MOPED OR MOTORIZED BICYCLE 15 - SEMI-TRACTOR 21 - HEAVY EQUIPMENT 26 - BICYCLE  
 5 - CARGO VAN 11 - ALL TERRAIN VEHICLE (ATV / UTV) 16 - FARM EQUIPMENT 22 - ANIMAL WITH RIDER OR ANIMAL-DRAWN VEHICLE 27 - TRAIN  
 6 - VAN (9-15 SEATS) 17 - MOTORHOME 16 - FARM EQUIPMENT 99 - UNKNOWN OR HIT/SKIP

WAS VEHICLE OPERATING IN AUTONOMOUS MODE WHEN CRASH OCCURRED? 2 AUTONOMOUS MODE LEVEL 0  
 1 - YES 2 - NO 9 - OTHER / UNKNOWN  
 0 - NO AUTOMATION 1 - DRIVER ASSISTANCE 3 - CONDITIONAL AUTOMATION 9 - UNKNOWN  
 1 - PARTIAL AUTOMATION 2 - PARTIAL AUTOMATION 4 - HIGH AUTOMATION 5 - FULL AUTOMATION

SPECIAL FUNCTION 01  
 1 - NONE 2 - TAXI 3 - ELECTRONIC RIDE SHARING 4 - SCHOOL TRANSPORT 5 - BUS-TRANSIT/COMMUTER 6 - BUS-CHARTER/TOUR 7 - BUS-INTERCITY 8 - BUS-SHUTTLE 9 - BUS-OTHER 10 - AMBULANCE 11 - FIRE 12 - MILITARY 13 - POLICE 14 - PUBLIC UTILITY 15 - CONSTRUCTION EQUIPMENT 16 - FARM 17 - MOWING 18 - SNOW REMOVAL 19 - TOWING 20 - SAFETY SERVICE PATROL 21 - MAIL CARRIER 99 - OTHER UNKNOWN

CARGO BODY TYPE 01  
 1 - NO CARGO BODY TYPE / NOT APPLICABLE 2 - BUS 3 - VEHICLE TOWING ANOTHER MOTOR VEHICLE 4 - LOGGING 5 - INTERMODAL CONTAINER CHASSIS 6 - CARGO VAN/ENCLOSED BOX 7 - GRAIN/CHIPS/GRAVEL 8 - POLE 9 - CARGO TANK 10 - FLAT BED 11 - DUMP 12 - CONCRETE MIXER 13 - AUTO TRANSPORTER 14 - GARBAGE/REFUSE 99 - OTHER / UNKNOWN

VEHICLE DEFECTS 01  
 1 - TURN SIGNALS 2 - HEAD LAMPS 3 - TAIL LAMPS 4 - BRAKES 5 - STEERING 6 - TIRE BLOWOUT 7 - WORN OR SLICK TIRES 8 - TRAILER EQUIPMENT DEFECTIVE 9 - MOTOR TROUBLE 10 - DISABLED FROM PRIOR ACCIDENT 99 - OTHER / UNKNOWN

NON-MOTORIST LOCATION AT IMPACT 3  
 1 - INTERSECTION - MARKED CROSSWALK 2 - INTERSECTION - UNMARKED CROSSWALK 3 - INTERSECTION - OTHER 4 - MIDBLOCK - MARKED CROSSWALK 5 - TRAVEL LANE-OTHER LOCATION 6 - BICYCLE LANE 7 - SHOULDER/ROADSIDE 8 - SIDEWALK 9 - MEDIAN/CROSSING ISLAND 10 - DRIVEWAY ACCESS 11 - SHARED USE PATHS OR TRAILS 12 - FIRST RESPONDER AT INCIDENT SCENE 99 - OTHER / UNKNOWN

ACTION 99 PRE-CRASH ACTION 99  
 1 - NON-CONTACT 2 - NON-COLLISION 3 - STRIKING 4 - STRUCK 5 - BOTH STRIKING & STRUCK 9 - OTHER / UNKNOWN  
 1 - STRAIGHT AHEAD 2 - BACKING 3 - CHANGING LANES 4 - OVERTAKING/PASSING 5 - MAKING RIGHT TURN 6 - MAKING LEFT TURN 7 - MAKING U-TURN 8 - ENTERING TRAFFIC LANE 9 - LEAVING TRAFFIC LANE 10 - PARKED 11 - SLOWING OR STOPPED IN TRAFFIC 12 - DRIVERLESS 13 - NEGOTIATING A CURVE 14 - ENTERING OR CROSSING SPECIFIED LOCATION 15 - WALKING, RUNNING, JOGGING, PLAYING 16 - WORKING 17 - PUSHING VEHICLE 18 - APPROACHING OR LEAVING VEHICLE 19 - STANDING 20 - OTHER NON-MOTORIST 21 - STANDING OUTSIDE DISABLED VEHICLE 99 - OTHER / UNKNOWN

CONTRIBUTING CIRCUMSTANCES 99  
 1 - NONE 2 - FAILURE TO YIELD 3 - RAN RED LIGHT 4 - RAN STOP SIGN 5 - UNSAFE SPEED 6 - IMPROPER TURN 7 - LEFT OF CENTER 8 - FOLLOWING TOO CLOSE/ACDA 9 - IMPROPER LANE CHANGING 10 - IMPROPER PASSING 11 - DROVE OFF ROAD 12 - IMPROPER BACKING 13 - IMPROPER START FROM A PARKED POSITION 14 - STOPPED OR PARKED ILLEGALLY 15 - SWERVING TO AVOID 16 - WRONG WAY 17 - VISION OBSTRUCTION 18 - OPERATING DEFECTIVE EQUIPMENT 19 - LOAD SHIFTING/ FALLING/SPILLING 20 - IMPROPER CROSSING 21 - LYING IN ROADWAY 22 - NOT DISCERNABLE 23 - OPENING DOOR INTO ROADWAY 99 - OTHER IMPROPER ACTION

SEQUENCE OF EVENTS  
 1 21 2 \_\_\_\_\_ 3 \_\_\_\_\_  
 1 - OVERTURN/ROLLOVER 2 - FIRE/EXPLOSION 3 - IMMERSION 4 - JACKKNIFE 5 - CARGO / EQUIPMENT LOSS OR SHIFT 6 - EQUIPMENT FAILURE 7 - SEPARATION OF UNITS 8 - RAN OFF ROAD RIGHT 9 - RAN OFF ROAD LEFT 10 - CROSS MEDIAN 11 - CROSS CENTERLINE - OPPOSITE DIRECTION OF TRAVEL 12 - DOWNHILL RUNAWAY 13 - OTHER NON-COLLISION 14 - PEDESTRIAN 15 - PEDALCYCLE 16 - RAILWAY VEHICLE 17 - ANIMAL - FARM 18 - ANIMAL - DEER 19 - ANIMAL - OTHER 20 - MOTOR VEHICLE IN TRANSPORT 21 - PARKED MOTOR VEHICLE 22 - WORK ZONE MAINTENANCE EQUIPMENT 23 - STRUCK BY FALLING, SHIFTING CARGO OR ANYTHING SET IN MOTION BY A MOTOR VEHICLE 24 - OTHER MOVABLE OBJECT

COLLISION WITH FIXED OBJECT - STRUCK  
 25 - IMPACT ATTENUATOR / CRASH CUSHION 26 - BRIDGE OVERHEAD STRUCTURE 27 - BRIDGE PIER OR ABUTMENT 28 - BRIDGE PARAPET 29 - BRIDGE RAIL 30 - GUARDRAIL FACE 31 - GUARDRAIL END 32 - PORTABLE BARRIER 33 - MEDIAN CABLE BARRIER 34 - MEDIAN GUARDRAIL BARRIER 35 - MEDIAN CONCRETE BARRIER 36 - MEDIAN OTHER BARRIER 37 - TRAFFIC SIGN POST 38 - OVERHEAD SIGN POST 39 - LIGHT/LUMINARIES SUPPORT 40 - UTILITY POLE 41 - OTHER POST, POLE OR SUPPORT 42 - CULVERT 43 - CURB 44 - DITCH 45 - EMBANKMENT 46 - FENCE 47 - MAILBOX 48 - TREE 49 - FIRE HYDRANT 50 - WORKZONE MAINTENANCE EQUIPMENT 51 - WALL 52 - BUILDING 53 - TUNNEL 54 - OTHER FIXED OBJECT 99 - OTHER / UNKNOWN

FIRST HARMFUL EVENT 1 MOST HARMFUL EVENT 1  
 1 - STATED/ESTIMATED SPEED 2 - CALCULATED / EDR 3 - UNDETERMINED

LOCAL REPORT NUMBER  
20231442

DAMAGE  
 DAMAGE SCALE  
 1 - NONE 2 - MINOR DAMAGE 3 - FUNCTIONAL DAMAGE 4 - DISABLING DAMAGE  
9 9 - UNKNOWN

DAMAGED AREA(S)  
 INDICATE ALL THAT APPLY  
  
 - NO DAMAGE [0]  - UNDERCARRIAGE [14]  
 - TOP [13]  - ALL AREAS [15]  
 - UNIT NOT AT SCENE [16]

INITIAL POINT OF CONTACT  
99 0 - NO DAMAGE 1-12 - REFER TO UNIT DIAGRAM 13 - TOP 14 - UNDERCARRIAGE 15 - VEHICLE NOT AT SCENE 99 - UNKNOWN

TRAFFIC  
 TRAFFICWAY FLOW 2 TRAFFIC CONTROL 6  
 1 - ONE-WAY 2 - TWO-WAY 1 - ROUNDABOUT 2 - SIGNAL 3 - FLASHER 4 - STOP SIGN 5 - YIELD SIGN 6 - NO CONTROL

# OF THROUGH LANES ON ROAD 2 RAIL GRADE CROSSING  
 1 - NOT INVOLVED 2 - INVOLVED - ACTIVE CROSSING 3 - INVOLVED - PASSIVE CROSSING

UNIT / NON-MOTORIST DIRECTION  
 FROM 1 TO 2  
 1 - NORTH 2 - SOUTH 3 - EAST 4 - WEST 5 - NORTHEAST 6 - NORTHWEST 7 - SOUTHEAST 8 - SOUTHWEST 9 - OTHER / UNKNOWN

UNIT SPEED 10 POSTED SPEED 25  
 DETECTED SPEED  
 1 - STATED/ESTIMATED SPEED 2 - CALCULATED / EDR 3 - UNDETERMINED

