

TRAFFIC CRASH REPORT

*DENOTES MANDATORY FIELD FOR SUPPLEMENT REPORT

LOCAL REPORT NUMBER *

2 | 0 | 2 | 5 | 0 | 4 | 1 | 2

PHOTOS TAKEN OH-2 OH-3
 SECONDARY CRASH OH-1P OTHER
 Private Property

LOCAL INFORMATION

REPORTING AGENCY NAME *

GARFIELD HEIGHTS

NCIC *
0 | 1 | 8 | 2 | 0

HITSKIP
1 - Solved
2 - Unsolved

NUMBER OF UNITS
0 | 2

UNIT IN ERROR
98 - ANIMAL
99 - UNKNOWN
0 | 1

COUNTY *
1 | 8

LOCALITY *
1

LOCATION: CITY, VILLAGE, TOWNSHIP *
GARFIELD HTS

CRASH DATE/TIME *
0 | 2 | 2 | 5 | 2 | 0 | 2 | 5 | 0 | 8 | 1 | 7

CRASH SEVERITY
5

- 1 - FATAL
- 2 - SERIOUS INJURY SUSPECTED
- 3 - MINOR INJURY SUSPECTED
- 4 - INJURY POSSIBLE
- 5 - PROPERTY DAMAGE ONLY

ROUTE TYPE: I | R
ROUTE NUMBER: 4 | 8 | 0
PREFIX: []

LOCATION ROAD NAME
ROAD TYPE: H | W

ATTITUDE (NORMAL DEGREE)
4 | 1 | 4 | 1 | 1 | 4 | 8 | 2

ROUTE TYPE: []
ROUTE NUMBER: []
PREFIX: []

REFERENCE ROAD NAME (ROAD, MILEPOST, HOUSE #)
24.0
ROAD TYPE: M | P

LONGITUDE (DECIMAL DEGREES)
8 | 1 | 6 | 1 | 7 | 9 | 1 | 6

REFERENCE POINT
2

DIRECTION
[]

ROUTE TYPE
IR - INTERSTATE ROUTE (TP)
US - FEDERAL US ROUTE
SR - STATE ROUTE
CR - NUMBERED COUNTY ROUTE
TR - NUMBERED TOWNSHIP ROUTE

ROAD TYPE
AL - ALLEY
AV - AVENUE
BL - BOULEVARD
CR - CIRCLE
CT - COURT
DR - DRIVE
HE - HEIGHTS
HW - HIGHWAY
LA - LANE
MP - MILEPOST
OV - OVAL
PK - PARKWAY
PI - PIKE
PL - PLACE
RD - ROAD
SQ - SQUARE
ST - STREET
TE - TERRACE
TL - TRAIL
WA - WAY

INTERSECTION RELATED
 WITHIN INTERSECTION OR ON APPROACH
 WITHIN INTERCHANGE AREA
NUMBER OF APPROACHES: []

DISTANCE
[]

DISTANCE
[]

ROADWAY
 ROADWAY DIVIDED

LOCATION OF FIRST VEHICLE EVENT
0 | 1

- 1 - ON ROADWAY
- 2 - ON SHOULDER
- 3 - IN MEDIAN
- 4 - ON ROADSIDE
- 5 - ON GORE
- 6 - OUTSIDE TRAFFICWAY
- 7 - ON RAMP
- 8 - OFF RAMP
- 9 - CROSSOVER
- 10 - DRIVEWAY / ALLEY ACCESS
- 11 - RAILWAY GRADE CROSSING
- 12 - SHARED USE PATHS OR TRAILS
- 13 - BIKE LANE
- 14 - TOLL BOOTH
- 99 - OTHER / UNKNOWN

MANNER OF CRASH COLLISION/IMPACT
7

- 1 - NOT COLLISION BETWEEN TWO MOTOR VEHICLES IN TRANSPORT
- 2 - REAR-END
- 3 - HEAD-ON
- 4 - REAR-TO-REAR
- 5 - BACKING
- 6 - ANGLE
- 7 - SIDESWIPE, SAME DIRECTION
- 8 - SIDESWIPE, OPPOSITE DIRECTION
- 9 - OTHER / UNKNOWN

DIRECTION OF TRAVEL
3

- 1 - NORTH
- 2 - SOUTH
- 3 - EAST
- 4 - WEST

MEDIAN TYPE
9

- 1 - DIVIDED FLUSH MEDIAN (<4 FEET)
- 2 - DIVIDED FLUSH MEDIAN (24 FEET)
- 3 - DIVIDED, DEPRESSED MEDIAN
- 4 - DIVIDED, RAISED MEDIAN (ANY TYPE)
- 9 - OTHER / UNKNOWN

WORK ZONE RELATED
 WORKERS PRESENT
 LAW ENFORCEMENT PRESENT
 ACTIVE SCHOOL ZONE

WORK ZONE TYPE
1 - LANE CLOSURE
2 - LANE SHIFT/CROSSOVER
3 - WORK ON SHOULDER
[] OR MEDIAN
4 - INTERMITTENT OR MOVING WORK
5 - OTHER

LOCATION OF CRASH IN WORK ZONE
1 - BEFORE THE 1ST WORK ZONE WARNING SIGN
2 - ADVANCE WARNING AREA
3 - TRANSITION AREA
4 - ACTIVITY AREA
5 - TERMINATION AREA

CONTOUR
9

- 1 - STRAIGHT LEVEL
- 2 - STRAIGHT GRADE
- 3 - CURVE LEVEL
- 4 - CURVE GRADE
- 9 - OTHER / UNKNOWN

CONDITIONS
2

- 1 - DRY
- 2 - WET
- 3 - SNOW
- 4 - ICE
- 5 - SAND, MUD, DIRT, OIL, GRAVEL
- 6 - WATER (STANDING, MOVING)
- 7 - SLUSH
- 9 - OTHER/UNKNOWN

SURFACE
2

- 1 - CONCRETE
- 2 - BLACKTOP, BITUMINOUS, ASPHALT
- 3 - BRICK/BLOCK
- 4 - SLAG, GRAVEL, STONE
- 5 - DIRT
- 9 - OTHER / UNKNOWN

LIGHT CONDITION
1

- 1 - DAYLIGHT
- 2 - DAWN/DUSK
- 3 - DARK - LIGHTED ROADWAY
- 4 - DARK - ROADWAY NOT LIGHTED
- 5 - DARK - UNKNOWN ROADWAY LIGHTING
- 9 - OTHER / UNKNOWN

WEATHER
2

- 1 - CLEAR
- 2 - CLOUDY
- 3 - FOG, SMOG, SMOKE
- 4 - RAIN
- 5 - SLEET, HAIL
- 6 - SNOW
- 7 - SEVERE CROSSWINDS
- 8 - BLOWING SAND, SOIL, DIRT, SNOW
- 9 - FREEZING RAIN OR FREEZING DRIZZLE
- 99 - OTHER / UNKNOWN

ROADWAY SURFACE
1 - CONCRETE
2 - BLACKTOP, BITUMINOUS, ASPHALT
3 - BRICK/BLOCK
4 - SLAG, GRAVEL, STONE
5 - DIRT
9 - OTHER / UNKNOWN

UNIT#1 WAS TRAVELING EAST ON IR 480 NEAR MILE POST 24.0 UNIT#2 WAS TRAVELING EAST ON IR 480 NEAR MILE POST 24.0. THE LEFT SIDE OF UNIT#1 COLLIDED WITH THE RIGHT SIDE OF UNIT#2. BOTH UNITS WERE MOVED FROM FINAL REST AND WERE PARKED ON SOUTH SHOULDER UPON ARRIVAL. BWC
NOTE: SEE OH-2

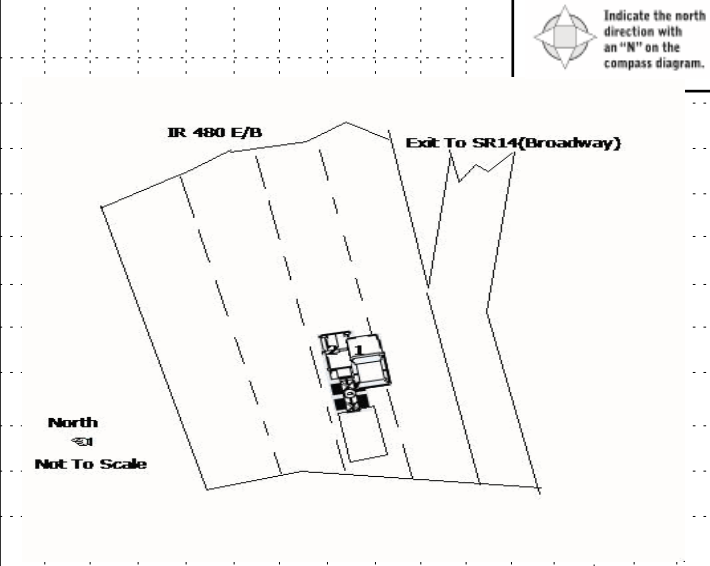

CRASH REPORTED DATE/TIME
0 | 2 | 2 | 5 | 2 | 0 | 2 | 5 | 0 | 8 | 1 | 7

DISPATCH DATE/TIME
0 | 2 | 2 | 5 | 2 | 0 | 2 | 5 | 0 | 8 | 1 | 9

ARRIVAL DATE/TIME
0 | 2 | 2 | 5 | 2 | 0 | 2 | 5 | 0 | 8 | 2 | 6

SCENE CLEARED DATE/TIME
0 | 2 | 2 | 5 | 2 | 0 | 2 | 5 | 0 | 8 | 5 | 1

REPORT TAKEN BY
 POLICE AGENCY
 MOTORIST

TOTAL TIME ROADWAY CLOSED
0

OTHER INVESTIGATION TIME
3 | 8

TOTAL MINUTES
7 | 0

OFFICER'S NAME *
R. Cramer

OFFICER'S BADGE NUMBER *
0 | 3 | 7

CHECKED BY OFFICER'S NAME *
D. Bailey

CHECKED BY OFFICER'S BADGE NUMBER *
L | 0 | 7

SUPPLEMENT (CORRECTION IN ADDITION TO ORIGINAL REPORT)

UNIT # 0 1 OWNER NAME: LAST, FIRST, MIDDLE (Same As Driver)
DENNISON ANNELESE KRISTELLE
 OWNER PHONE: INCLUDE AREA CODE (Same As Driver)
 OWNER ADDRESS: STREET, CITY, STATE, ZIP (Same As Driver)
422 TOLLIS PKWY BROADVIEW HTS OH 44147
 COMMERCIAL CARRIER: NAME, ADDRESS, CITY, STATE, ZIP
 COMMERCIAL CARRIER PHONE: INCLUDE AREA CODE

DAMAGE
DAMAGE SCALE
 1 - NONE
 2 - MINOR DAMAGE
 3 - FUNCTIONAL DAMAGE
 4 - DISABLING DAMAGE
 9 - UNKNOWN
3

LP STATE O H LICENSE PLATE # KFB3215 VEHICLE IDENTIFICATION # 4S3GKAT68L3603408 VEHICLE YEAR 2020 VEHICLE MAKE Subaru
 INSURANCE VERIFIED INSURANCE COMPANY State Farm INSURANCE POLICY # 24743532fp35 VEHICLE COLOR SIL VEHICLE MODEL Impreza
 COMMERCIAL GOVERNMENT IN EMERGENCY RESPONSE US DOT # _____ TOWED BY: COMPANY NAME _____
 INTERLOCK DEVICE EQUIPPED HIT/SKIP UNIT # OCCUPANTS 0 1 VEHICLE WEIGHT GVWR/GVWR 1 - ≤10K LBS. 2 - 10,001 - 26K LBS. 3 - >26K LBS. HAZARDOUS MATERIAL MATERIAL RELEASED CLASS # _____ PLACARD ID # _____
 PLACARD

DAMAGED AREA(S)
 INDICATE ALL THAT APPLY

- NO DAMAGE [0] - UNDERCARRIAGE [14]
 - TOP [13] - ALL AREAS [15]
 - UNIT NOT AT SCENE [16]

UNIT TYPE 0 1 # OF TRAILING UNITS _____
 1 - PASSENGER CAR 7 - MOTORCYCLE 2-WHEELED 12 - GOLF CART 18 - LIMO (LIVERY VEHICLE) 23 - PEDESTRIANSKATER
 2 - PASSENGER VAN (MINIVAN) 8 - MOTORCYCLE 3-WHEELED 13 - SNOWMOBILE 19 - BUS (16+ PASSENGERS) 24 - WHEELCHAIR (ANY TYPE)
 3 - SPORT UTILITY VEHICLE 9 - AUTOCYCLE 14 - SINGLE UNIT TRUCK 20 - OTHER VEHICLE 25 - OTHER NON-MOTORIST
 4 - PICK UP 10 - MOPED OR MOTORIZED BICYCLE 15 - SEMI-TRACTOR 21 - HEAVY EQUIPMENT 26 - BICYCLE
 5 - CARGO VAN 11 - ALL TERRAIN VEHICLE (ATV / UTV) 16 - FARM EQUIPMENT 22 - ANIMAL WITH RIDER OR ANIMAL-DRAWN VEHICLE 27 - TRAIN
 6 - VAN (9-15 SEATS) 17 - MOTORHOME

WAS VEHICLE OPERATING IN AUTONOMOUS MODE WHEN CRASH OCCURRED? 2 AUTONOMOUS MODE LEVEL 0
 1 - YES 2 - NO 9 - OTHER / UNKNOWN
 0 - NO AUTOMATION 1 - DRIVER ASSISTANCE 3 - CONDITIONAL AUTOMATION 9 - UNKNOWN
 1 - PARTIAL AUTOMATION 2 - PARTIAL AUTOMATION 4 - HIGH AUTOMATION 5 - FULL AUTOMATION

SPECIAL FUNCTION 0 1
 1 - NONE 6 - BUS - CHARTER/TOUR 11 - FIRE 16 - FARM 21 - MAIL CARRIER
 2 - TAXI 7 - BUS - INTERCITY 12 - MILITARY 17 - MOWING 99 - OTHER UNKNOWN
 3 - ELECTRONIC RIDE SHARING 8 - BUS - SHUTTLE 13 - POLICE 18 - SNOW REMOVAL
 4 - SCHOOL TRANSPORT 9 - BUS - OTHER 14 - PUBLIC UTILITY 19 - TOWING
 5 - BUS-TRANSIT/COMMUTER 10 - AMBULANCE 15 - CONSTRUCTION EQUIPMENT 20 - SAFETY SERVICE PATROL

CARGO BODY TYPE 0 1
 1 - NO CARGO BODY TYPE / NOT APPLICABLE 3 - VEHICLE TOWING ANOTHER MOTOR VEHICLE 5 - INTERMODAL CONTAINER CHASSIS 8 - POLE 12 - CONCRETE MIXER
 2 - BUS 4 - LOGGING 6 - CARGO VAN/ENCLOSED BOX 9 - CARGO TANK 13 - AUTO TRANSPORTER
 7 - GRAIN/CHIPS/GRAVEL 10 - FLAT BED 14 - GARBAGE/REFUSE 99 - OTHER / UNKNOWN
 11 - DUMP

VEHICLE DEFECTS 0 1
 1 - TURN SIGNALS 4 - BRAKES 7 - WORN OR SLICK TIRES 9 - MOTOR TROUBLE 99 - OTHER / UNKNOWN
 2 - HEAD LAMPS 5 - STEERING 8 - TRAILER EQUIPMENT DEFECTIVE 10 - DISABLED FROM PRIOR ACCIDENT
 3 - TAIL LAMPS 6 - TIRE BLOWOUT

NON-MOTORIST LOCATION AT IMPACT 0 1
 1 - INTERSECTION - MARKED CROSSWALK 3 - INTERSECTION - OTHER 6 - BICYCLE LANE 9 - MEDIAN/CROSSING ISLAND 12 - FIRST RESPONDER AT INCIDENT SCENE
 2 - INTERSECTION - UNMARKED CROSSWALK 4 - MIDBLOCK - MARKED CROSSWALK 7 - SHOULDER/ROADSIDE 10 - DRIVEWAY ACCESS 99 - OTHER / UNKNOWN
 5 - TRAVEL LANE-OTHER LOCATION 8 - SIDEWALK 11 - SHARED USE PATHS OR TRAILS

ACTION 0 1 3 PRE-CRASH ACTION 1 3
 1 - NON-CONTACT 1 - STRAIGHT AHEAD 7 - MAKING U-TURN 13 - NEGOTIATING A CURVE 18 - APPROACHING OR LEAVING VEHICLE
 2 - NON-COLLISION 2 - BACKING 8 - ENTERING TRAFFIC LANE 14 - ENTERING OR CROSSING SPECIFIED LOCATION 19 - STANDING
 3 - STRIKING 3 - CHANGING LANES 9 - LEAVING TRAFFIC LANE 15 - WALKING, RUNNING, JOGGING, PLAYING 20 - OTHER NON-MOTORIST
 4 - STRUCK 4 - OVERTAKING/PASSING 10 - PARKED 16 - WORKING 21 - STANDING OUTSIDE DISABLED VEHICLE
 5 - BOTH STRIKING & STRUCK 5 - MAKING RIGHT TURN IN TRAFFIC 99 - OTHER / UNKNOWN
 9 - OTHER / UNKNOWN 6 - MAKING LEFT TURN 12 - DRIVERLESS 17 - PUSHING VEHICLE

CONTRIBUTING CIRCUMSTANCES 0 9
 1 - NONE 7 - LEFT OF CENTER 13 - IMPROPER START FROM A PARKED POSITION 17 - VISION OBSTRUCTION 21 - LYING IN ROADWAY
 2 - FAILURE TO YIELD 8 - FOLLOWING TOO CLOSE/ACDA 14 - STOPPED OR PARKED ILLEGALLY 18 - OPERATING DEFECTIVE EQUIPMENT 22 - NOT DISCERNABLE
 3 - RAN RED LIGHT 9 - IMPROPER LANE CHANGING 15 - SWERVING TO AVOID 19 - LOAD SHIFTING/ FALLING/SPILLING 23 - OPENING DOOR INTO ROADWAY
 4 - RAN STOP SIGN 10 - IMPROPER PASSING 16 - WRONG WAY 20 - IMPROPER CROSSING 99 - OTHER IMPROPER ACTION
 5 - UNSAFE SPEED 11 - DROVE OFF ROAD
 6 - IMPROPER TURN 12 - IMPROPER BACKING

INITIAL POINT OF CONTACT
0 9
 0 - NO DAMAGE 14 - UNDERCARRIAGE
 1-12 - REFER TO UNIT DIAGRAM 15 - VEHICLE NOT AT SCENE
 99 - UNKNOWN
 13 - TOP

SEQUENCE OF EVENTS
 1 2 0
 1 - OVERTURN/ROLLOVER 6 - EQUIPMENT FAILURE 11 - CROSS CENTERLINE - OPPOSITE DIRECTION OF TRAVEL 16 - RAILWAY VEHICLE 22 - WORK ZONE MAINTENANCE EQUIPMENT
 2 - FIRE/EXPLOSION 7 - SEPARATION OF UNITS 12 - DOWNHILL RUNAWAY 17 - ANIMAL - FARM 23 - STRUCK BY FALLING, SHIFTING CARGO OR ANYTHING SET IN MOTION BY A MOTOR VEHICLE
 3 - IMMERSION 8 - RAN OFF ROAD RIGHT 13 - OTHER NON-COLLISION 18 - ANIMAL - DEER 24 - OTHER MOVABLE OBJECT
 4 - JACKKNIFE 9 - RAN OFF ROAD LEFT 14 - PEDESTRIAN 19 - ANIMAL - OTHER 25 - OTHER FIXED OBJECT
 5 - CARGO / EQUIPMENT LOSS OR SHIFT 10 - CROSS MEDIAN 15 - PEDALCYCLE 20 - MOTOR VEHICLE IN TRANSPORT 99 - OTHER / UNKNOWN
 6 - _____

TRAFFIC
TRAFFICWAY FLOW 1 **TRAFFIC CONTROL** 6
 1 - ONE-WAY 1 - ROUNDABOUT 4 - STOP SIGN
 2 - TWO-WAY 2 - SIGNAL 5 - YIELD SIGN
 3 - FLASHER 6 - NO CONTROL

COLLISION WITH FIXED OBJECT - STRUCK
 25 - IMPACT ATTENUATOR / CRASH CUSHION 31 - GUARDRAIL END 37 - TRAFFIC SIGN POST 43 - CURB 50 - WORKZONE MAINTENANCE EQUIPMENT
 26 - BRIDGE OVERHEAD STRUCTURE 32 - PORTABLE BARRIER 38 - OVERHEAD SIGN POST 44 - DITCH 51 - WALL
 27 - BRIDGE PIER OR ABUTMENT 33 - MEDIAN CABLE BARRIER 39 - LIGHT/LUMINARIES SUPPORT 45 - EMBANKMENT 52 - BUILDING
 28 - BRIDGE PARAPET 34 - MEDIAN GUARDRAIL BARRIER 40 - UTILITY POLE 46 - FENCE 53 - TUNNEL
 29 - BRIDGE RAIL 35 - MEDIAN CONCRETE BARRIER 41 - OTHER POST, POLE OR SUPPORT 47 - MAILBOX 54 - OTHER FIXED OBJECT
 30 - GUARDRAIL FACE 36 - MEDIAN OTHER BARRIER 42 - CULVERT 48 - TREE 99 - OTHER / UNKNOWN
 49 - FIRE HYDRANT

FIRST HARMFUL EVENT 1 MOST HARMFUL EVENT 1

RAIL GRADE CROSSING 1
 1 - NOT INVOLVED
 2 - INVOLVED - ACTIVE CROSSING
 3 - INVOLVED - PASSIVE CROSSING

UNIT / NON-MOTORIST DIRECTION
 FROM 4 TO 3
 1 - NORTH 5 - NORTHEAST
 2 - SOUTH 6 - NORTHWEST
 3 - EAST 7 - SOUTHEAST
 4 - WEST 8 - SOUTHWEST
 9 - OTHER / UNKNOWN

UNIT SPEED 6 0 **DETECTED SPEED** 1
 1 - STATED/ESTIMATED SPEED
 2 - CALCULATED / EDR
 3 - UNDETERMINED
POSTED SPEED 6 0

UNIT # 0 2 OWNER NAME: LAST, FIRST, MIDDLE () Same As Driver
Unlimited Deliveries

OWNER ADDRESS: STREET, CITY, STATE, ZIP () Same As Driver
517 W North St STE C PASS CHRISTIAN MS 39571

COMMERCIAL CARRIER: NAME, ADDRESS, CITY, STATE, ZIP
Unlimited Delervies 517 N W ST C Pass Christian MS 39577

OWNER PHONE: INCLUDE AREA CODE () Same As Driver

COMMERCIAL CARRIER PHONE: INCLUDE AREA CODE

DAMAGE

DAMAGE SCALE

1 - NONE
2 - MINOR DAMAGE
3 - FUNCTIONAL DAMAGE
4 - DISABLING DAMAGE
9 - UNKNOWN

2

LP STATE M S LICENSE PLATE # A550301 VEHICLE IDENTIFICATION # 1XPB0P9XXRD657821 VEHICLE YEAR 2024 VEHICLE MAKE Peterbilt

INSURANCE VERIFIED INSURANCE COMPANY Null INSURANCE POLICY # upk65147272 VEHICLE COLOR WHI VEHICLE MODEL Other/Unknw

TYPE OF USE: COMMERCIAL GOVERNMENT IN EMERGENCY RESPONSE

US DOT # 2855991 TOWED BY: COMPANY NAME

VEHICLE WEIGHT GVWR/GCWR: 3 HAZARDOUS MATERIAL: MATERIAL RELEASED PLACARD CLASS # PLACARD ID #

DAMAGED AREA(S)
INDICATE ALL THAT APPLY

- NO DAMAGE [0] - UNDERCARRIAGE [14]
 - TOP [13] - ALL AREAS [15]
 - UNIT NOT AT SCENE [16]

UNIT TYPE: 1 5

1 - PASSENGER CAR 2 - PASSENGER VAN (MINIVAN) 3 - SPORT UTILITY VEHICLE 4 - PICK UP 5 - CARGO VAN 6 - VAN (9-15 SEATS) 7 - MOTORCYCLE 2-WHEELED 8 - MOTORCYCLE 3-WHEELED 9 - AUTOCYCLE 10 - MOPED OR MOTORIZED BICYCLE 11 - ALL TERRAIN VEHICLE (ATV / UTV) 12 - GOLF CART 13 - SNOWMOBILE 14 - SINGLE UNIT TRUCK 15 - SEMI-TRACTOR 16 - FARM EQUIPMENT 17 - MOTORHOME 18 - LIMO (LIVERY VEHICLE) 19 - BUS (16+ PASSENGERS) 20 - OTHER VEHICLE 21 - HEAVY EQUIPMENT 22 - ANIMAL WITH RIDER OR ANIMAL-DRAWN VEHICLE 23 - PEDESTRIANSKATER 24 - WHEELCHAIR (ANY TYPE) 25 - OTHER NON-MOTORIST 26 - BICYCLE 27 - TRAIN 99 - UNKNOWN OR HIT/SKIP

of TRAILING UNITS

WAS VEHICLE OPERATING IN AUTONOMOUS MODE WHEN CRASH OCCURRED? 2

1 - YES 2 - NO 9 - OTHER / UNKNOWN

AUTONOMOUS MODE LEVEL: 0

0 - NO AUTOMATION 1 - DRIVER ASSISTANCE 2 - PARTIAL AUTOMATION 3 - CONDITIONAL AUTOMATION 4 - HIGH AUTOMATION 5 - FULL AUTOMATION 9 - UNKNOWN

SPECIAL FUNCTION: 0 1

1 - NONE 2 - TAXI 3 - ELECTRONIC RIDE SHARING 4 - SCHOOL TRANSPORT 5 - BUS-TRANSIT/COMMUTER 6 - BUS - CHARTER/TOUR 7 - BUS - INTERCITY 8 - BUS - SHUTTLE 9 - BUS - OTHER 10 - AMBULANCE 11 - FIRE 12 - MILITARY 13 - POLICE 14 - PUBLIC UTILITY 15 - CONSTRUCTION EQUIPMENT 16 - FARM 17 - MOWING 18 - SNOW REMOVAL 19 - TOWING 20 - SAFETY SERVICE PATROL 21 - MAIL CARRIER 99 - OTHER UNKNOWN

CARGO BODY TYPE: 0 1

1 - NO CARGO BODY TYPE / NOT APPLICABLE 2 - BUS 3 - VEHICLE TOWING ANOTHER MOTOR VEHICLE 4 - LOGGING 5 - INTERMODAL CONTAINER CHASSIS 6 - CARGO VAN/ENCLOSED BOX 7 - GRAIN/CHIPS/GRAVEL 8 - POLE 9 - CARGO TANK 10 - FLAT BED 11 - DUMP 12 - CONCRETE MIXER 13 - AUTO TRANSPORTER 14 - GARBAGE/REFUSE 99 - OTHER / UNKNOWN

VEHICLE DEFECTS: 0 1

1 - TURN SIGNALS 2 - HEAD LAMPS 3 - TAIL LAMPS 4 - BRAKES 5 - STEERING 6 - TIRE BLOWOUT 7 - WORN OR SLICK TIRES 8 - TRAILER EQUIPMENT DEFECTIVE 9 - MOTOR TROUBLE 10 - DISABLED FROM PRIOR ACCIDENT 99 - OTHER / UNKNOWN

NON-MOTORIST LOCATION AT IMPACT: 0 1

1 - INTERSECTION - MARKED CROSSWALK 2 - INTERSECTION - UNMARKED CROSSWALK 3 - INTERSECTION - OTHER 4 - MIDBLOCK - MARKED CROSSWALK 5 - TRAVEL LANE-OTHER LOCATION 6 - BICYCLE LANE 7 - SHOULDER/ROADSIDE 8 - SIDEWALK 9 - MEDIAN/CROSSING ISLAND 10 - DRIVEWAY ACCESS 11 - SHARED USE PATHS OR TRAILS 12 - FIRST RESPONDER AT INCIDENT SCENE 99 - OTHER / UNKNOWN

ACTION: 4

1 - NON-CONTACT 2 - NON-COLLISION 3 - STRIKING 4 - STRUCK 5 - BOTH STRIKING & STRUCK 9 - OTHER / UNKNOWN

PRE-CRASH ACTION: 1 3

1 - STRAIGHT AHEAD 2 - BACKING 3 - CHANGING LANES 4 - OVERTAKING/PASSING 5 - MAKING RIGHT TURN 6 - MAKING LEFT TURN 7 - MAKING U-TURN 8 - ENTERING TRAFFIC LANE 9 - LEAVING TRAFFIC LANE 10 - PARKED 11 - SLOWING OR STOPPED IN TRAFFIC 12 - DRIVERLESS 13 - NEGOTIATING A CURVE 14 - ENTERING OR CROSSING SPECIFIED LOCATION 15 - WALKING, RUNNING, JOGGING, PLAYING 16 - WORKING 17 - PUSHING VEHICLE 18 - APPROACHING OR LEAVING VEHICLE 19 - STANDING 20 - OTHER NON-MOTORIST 21 - STANDING OUTSIDE DISABLED VEHICLE 99 - OTHER / UNKNOWN

INITIAL POINT OF CONTACT: 0 2

0 - NO DAMAGE 1-12 - REFER TO UNIT DIAGRAM 13 - TOP 14 - UNDERCARRIAGE 15 - VEHICLE NOT AT SCENE 99 - UNKNOWN

CONTRIBUTING CIRCUMSTANCES: 0 1

1 - NONE 2 - FAILURE TO YIELD 3 - RAN RED LIGHT 4 - RAN STOP SIGN 5 - UNSAFE SPEED 6 - IMPROPER TURN 7 - LEFT OF CENTER 8 - FOLLOWING TOO CLOSE/ACDA 9 - IMPROPER LANE CHANGING 10 - IMPROPER PASSING 11 - DROVE OFF ROAD 12 - IMPROPER BACKING 13 - IMPROPER START FROM A PARKED POSITION 14 - STOPPED OR PARKED ILLEGALLY 15 - SWERVING TO AVOID 16 - WRONG WAY 17 - VISION OBSTRUCTION 18 - OPERATING DEFECTIVE EQUIPMENT 19 - LOAD SHIFTING/ FALLING/SPILLING 20 - IMPROPER CROSSING 21 - LYING IN ROADWAY 22 - NOT DISCERNABLE 23 - OPENING DOOR INTO ROADWAY 99 - OTHER IMPROPER ACTION

TRAFFIC: 1

TRAFFICWAY FLOW: 1 - ONE-WAY 2 - TWO-WAY

TRAFFIC CONTROL: 1 - ROUNDABOUT 2 - SIGNAL 3 - FLASHER 4 - STOP SIGN 5 - YIELD SIGN 6 - NO CONTROL

SEQUENCE OF EVENTS

EVENTS

1 2 0

1 - OVERTURN/ROLLOVER 2 - FIRE/EXPLOSION 3 - IMMERSION 4 - JACKKNIFE 5 - CARGO / EQUIPMENT LOSS OR SHIFT 6 - EQUIPMENT FAILURE 7 - SEPARATION OF UNITS 8 - RAN OFF ROAD RIGHT 9 - RAN OFF ROAD LEFT 10 - CROSS MEDIAN 11 - CROSS CENTERLINE - OPPOSITE DIRECTION OF TRAVEL 12 - DOWNHILL RUNAWAY 13 - OTHER NON-COLLISION 14 - PEDESTRIAN 15 - PEDALCYCLE 16 - RAILWAY VEHICLE 17 - ANIMAL - FARM 18 - ANIMAL - DEER 19 - ANIMAL - OTHER 20 - MOTOR VEHICLE IN TRANSPORT 21 - PARKED MOTOR VEHICLE 22 - WORK ZONE MAINTENANCE EQUIPMENT 23 - STRUCK BY FALLING, SHIFTING CARGO OR ANYTHING SET IN MOTION BY A MOTOR VEHICLE 24 - OTHER MOVABLE OBJECT

COLLISION WITH FIXED OBJECT - STRUCK

25 - IMPACT ATTENUATOR / CRASH CUSHION 26 - BRIDGE OVERHEAD STRUCTURE 27 - BRIDGE PIER OR ABUTMENT 28 - BRIDGE PARAPET 29 - BRIDGE RAIL 30 - GUARDRAIL FACE 31 - GUARDRAIL END 32 - PORTABLE BARRIER 33 - MEDIAN CABLE BARRIER 34 - MEDIAN GUARDRAIL BARRIER 35 - MEDIAN CONCRETE BARRIER 36 - MEDIAN OTHER BARRIER 37 - TRAFFIC SIGN POST 38 - OVERHEAD SIGN POST 39 - LIGHT/LUMINARIES SUPPORT 40 - UTILITY POLE 41 - OTHER POST, POLE OR SUPPORT 42 - CULVERT 43 - CURB 44 - DITCH 45 - EMBANKMENT 46 - FENCE 47 - MAILBOX 48 - TREE 49 - FIRE HYDRANT 50 - WORKZONE MAINTENANCE EQUIPMENT 51 - WALL 52 - BUILDING 53 - TUNNEL 54 - OTHER FIXED OBJECT 99 - OTHER / UNKNOWN

FIRST HARMFUL EVENT: 1 MOST HARMFUL EVENT: 1

TRAFFICWAY FLOW: 1

1 - ONE-WAY 2 - TWO-WAY

TRAFFIC CONTROL: 6

1 - ROUNDABOUT 2 - SIGNAL 3 - FLASHER 4 - STOP SIGN 5 - YIELD SIGN 6 - NO CONTROL

OF THROUGH LANES ON ROAD: 5

RAIL GRADE CROSSING: 1

1 - NOT INVOLVED 2 - INVOLVED - ACTIVE CROSSING 3 - INVOLVED - PASSIVE CROSSING

UNIT / NON-MOTORIST DIRECTION

FROM 4 TO 3

1 - NORTH 2 - SOUTH 3 - EAST 4 - WEST 5 - NORTHEAST 6 - NORTHWEST 7 - SOUTHEAST 8 - SOUTHWEST 9 - OTHER / UNKNOWN

UNIT SPEED: 5 5

POSTED SPEED: 6 0

DETECTED SPEED: 1

1 - STATED/ESTIMATED SPEED 2 - CALCULATED / EDR 3 - UNDETERMINED

MOTORIST / NON-MOTORIST

LOCAL REPORT NUMBER
2 0 2 5 0 4 1 2

UNIT # 0 1	NAME: LAST, FIRST, MIDDLE DENNISON ANNELIESE KRISTELLE		DATE OF BIRTH 0 4 1 6 1 9 9 4	AGE 	GENDER F
ADDRESS: STREET, CITY, STATE, ZIP 422 TOLLIS PKWY BROADVIEW HTS OH 44147			CONTACT PHONE - INCLUDE AREA CODE 		
INJURIES 5	INJURED TAKEN BY 	EMS AGENCY (NAME) 	INJURED TAKEN TO: MEDICAL FACILITY (NAME, CITY) 	SAFETY EQUIPMENT USED 0 4	<input type="checkbox"/> DOT-COMPLIANT MC HELMET
OL STATE 	OPERATOR LICENSE NUMBER 	OFFENSE CHARGED 	LOCAL CODE <input type="checkbox"/>	OFFENSE DESCRIPTION 	CITATION NUMBER
OL CLASS 4	ENDORSEMENT SELECT UP TO 2 	RESTRICTION SELECT UP TO 3 	DRIVER DISTRACTED BY 7	ALCOHOL / DRUG SUSPECTED <input type="checkbox"/> ALCOHOL <input type="checkbox"/> MARIJUANA <input type="checkbox"/> OTHER DRUG	CONDITION 1
ALCOHOL TEST		DRUG TEST(S)			
STATUS	TYPE	VALUE	STATUS	TYPE	RESULT SELECT UP TO 4
1	1		1	1	

UNIT # 0 2	NAME: LAST, FIRST, MIDDLE HERNANDEZ MIGUEL		DATE OF BIRTH 1 0 2 8 1 9 6 9	AGE 5 5	GENDER M
ADDRESS: STREET, CITY, STATE, ZIP 655 SE 4Th St Butler FL 32054			CONTACT PHONE - INCLUDE AREA CODE 		
INJURIES 5	INJURED TAKEN BY 	EMS AGENCY (NAME) 	INJURED TAKEN TO: MEDICAL FACILITY (NAME, CITY) 	SAFETY EQUIPMENT USED 0 4	<input type="checkbox"/> DOT-COMPLIANT MC HELMET
OL STATE 	OPERATOR LICENSE NUMBER 	OFFENSE CHARGED 	LOCAL CODE <input type="checkbox"/>	OFFENSE DESCRIPTION 	CITATION NUMBER
OL CLASS 1	ENDORSEMENT SELECT UP TO 2 	RESTRICTION SELECT UP TO 3 	DRIVER DISTRACTED BY 1	ALCOHOL / DRUG SUSPECTED <input type="checkbox"/> ALCOHOL <input type="checkbox"/> MARIJUANA <input type="checkbox"/> OTHER DRUG	CONDITION 1
ALCOHOL TEST		DRUG TEST(S)			
STATUS	TYPE	VALUE	STATUS	TYPE	RESULT SELECT UP TO 4
1	1		1	1	

UNIT # 	NAME: LAST, FIRST, MIDDLE 		DATE OF BIRTH 	AGE 	GENDER
ADDRESS: STREET, CITY, STATE, ZIP 			CONTACT PHONE - INCLUDE AREA CODE 		
INJURIES 	INJURED TAKEN BY 	EMS AGENCY (NAME) 	INJURED TAKEN TO: MEDICAL FACILITY (NAME, CITY) 	SAFETY EQUIPMENT USED 	<input type="checkbox"/> DOT-COMPLIANT MC HELMET
OL STATE 	OPERATOR LICENSE NUMBER 	OFFENSE CHARGED 	LOCAL CODE <input type="checkbox"/>	OFFENSE DESCRIPTION 	CITATION NUMBER
OL CLASS 	ENDORSEMENT SELECT UP TO 2 	RESTRICTION SELECT UP TO 3 	DRIVER DISTRACTED BY 	ALCOHOL / DRUG SUSPECTED <input type="checkbox"/> ALCOHOL <input type="checkbox"/> MARIJUANA <input type="checkbox"/> OTHER DRUG	CONDITION
ALCOHOL TEST		DRUG TEST(S)			
STATUS	TYPE	VALUE	STATUS	TYPE	RESULT SELECT UP TO 4

INJURIES	SEATING POSITION	AIR BAG	OL CLASS	OL RESTRICTION(S)	DRIVER DISTRACTION	TEST STATUS
1 - FATAL	1 - FRONT - LEFT SIDE (MOTORCYCLE DRIVER)	1 - NOT DEPLOYED	1 - CLASS A	1 - ALCOHOL INTERLOCK DEVICE	1 - NOT DISTRACTED	1 - NONE GIVEN
2 - SUSPECTED SERIOUS INJURY	2 - FRONT - MIDDLE	2 - DEPLOYED FRONT	2 - CLASS B	2 - CDL INTRASTATE ONLY	2 - MANUALLY OPERATING AN ELECTRONIC COMMUNICATION DEVICE (TEXTING, TYPING, DIALING)	2 - TEST REFUSED
3 - SUSPECTED MINOR INJURY	3 - FRONT - RIGHT SIDE	3 - DEPLOYED SIDE	3 - CLASS C	3 - CORRECTIVE LENSES	3 - TALKING ON HANDS-FREE COMMUNICATION DEVICE	3 - TEST GIVEN, CONTAMINATED SAMPLE / UNSABLE
4 - POSSIBLE INJURY	4 - SECOND - LEFT SIDE (MOTORCYCLE PASSENGER)	4 - DEPLOYED BOTH FRONT / SIDE	4 - REGULAR CLASS (OHIO = D)	4 - FARM WAIVER	4 - TALKING ON HAND-HELD COMMUNICATION DEVICE	4 - TEST GIVEN, RESULTS KNOWN
5 - NO APPARENT INJURY	5 - SECOND - MIDDLE	5 - NOT APPLICABLE	5 - M / C MOPED ONLY	5 - EXCEPT CLASS A BUS & CLASS B BUS	5 - OTHER ACTIVITY WITH AN ELECTRONIC DEVICE	5 - TEST GIVEN, RESULTS UNKNOWN
INJURED TAKEN BY		EJECTION		ALCOHOL TEST TYPE		
1 - NOT TRANSPORTED / TREATED AT SCENE	7 - THIRD - LEFT SIDE (MOTORCYCLE SIDE CAR)	1 - NOT EJECTED	H - HAZMAT	6 - PASSENGER	1 - NONE	
2 - EMS	8 - THIRD - MIDDLE	2 - PARTIALLY EJECTED	M - MOTORCYCLE	7 - OTHER DISTRACTION INSIDE THE VEHICLE	2 - BLOOD	
3 - POLICE	9 - THIRD - RIGHT SIDE	3 - TOTALLY EJECTED	P - PASSENGER	8 - OTHER DISTRACTIONS OUTSIDE THE VEHICLE	3 - URINE	
9 - OTHER / UNKNOWN	10 - SLEEPER SECTION OF TRUCK CAB	4 - NOT APPLICABLE	N - TANKER	9 - OTHER / UNKNOWN	4 - BREATH	
SAFETY EQUIPMENT		TRAPPED		DRUG TEST TYPE		
1 - NONE USED	11 - PASSENGER IN OTHER ENCLOSED CARGO AREA (NON-TRAILING UNIT, BUS, PICK-UP WITH CAP)	1 - NOT TRAPPED	Q - MOTOR SCOOTER	10 - LIMITED TO DAYLIGHT ONLY	5 - OTHER	
2 - SHOULDER BELT ONLY USED	12 - PASSENGER IN UNENCLOSED CARGO AREA	2 - EXTRICATED BY MECHANICAL MEANS	R - THREE-WHEEL MOTORCYCLE	11 - LIMITED TO EMPLOYMENT		
3 - LAP BELT ONLY USED	13 - TRAILING UNIT	3 - FREED BY NON-MECHANICAL MEANS	S - SCHOOL BUS	12 - LIMITED - OTHER	DRUG TEST RESULT(S)	
4 - SHOULDER & LAP BELT USED	14 - RIDING ON VEHICLE EXTERIOR (NON-TRAILING UNIT)		T - DOUBLE & TRIPLE TRAILERS	13 - MECHANICAL DEVICES (SPECIAL BRAKES, HAND CONTROLS, OR OTHER ADAPTIVE DEVICES)	1 - NONE	
5 - CHILD RESTRAINT SYSTEM - FORWARD FACING	15 - NON-MOTORIST		X - TANKER / HAZMAT	14 - MILITARY VEHICLES ONLY	2 - BLOOD	
6 - CHILD RESTRAINT SYSTEM - REAR FACING	99 - OTHER / UNKNOWN			15 - MOTOR VEHICLES WITHOUT AIR BRAKES	3 - URINE	
7 - BOOSTER SEAT				16 - OUTSIDE MIRROR	4 - OTHER	
8 - HELMET USED				17 - PROSTHETIC AID		
9 - PROTECTIVE PADS USED (ELBOWS, KNEES, ETC.)				18 - OTHER		
10 - REFLECTIVE CLOTHING					CONDITION	
11 - LIGHTING - PEDESTRIAN / BICYCLE ONLY					1 - APPARENTLY NORMAL	
99 - OTHER / UNKNOWN					2 - PHYSICAL IMPAIRMENT	
					3 - EMOTIONAL (E.G. DEPRESSED, ANGRY, DISTURBED)	
					4 - ILLNESS	
					5 - FELL ASLEEP, FAINTED, FATIGUED, ETC.	
					6 - UNDER THE INFLUENCE OF MEDICATIONS / DRUGS / ALCOHOL	
					9 - OTHER / UNKNOWN	
						1 - AMPHETAMINES
						2 - BARBITURATES
						3 - BENZODIAZEPINES
						4 - CANNABINOIDS
						5 - COCAINE
						6 - OPIATES / OPIOIDS
						7 - OTHER
						8 - NEGATIVE RESULTS

OHIO TRAFFIC CRASH REPORT

DIAGRAM / NARRATIVE CONTINUATION

LOCAL REPORT NUMBER 20250412	REPORTING AGENCY GARFIELD HEIGHTS	DATE OF CRASH M 02 D 25 Y 2025
IN COUNTY OF 18	CRASH LOCATION IR 480	
<p>Driver of Unit#1 stated , she was traveling east in the middle inside lane and listening to a pod cast. She then drifted into the inside lane. BWC</p>		
<p>Driver of Unit#2 stated, he was traveling in the middle outside lane and he felt a bump. BWC</p>		
<p>Trailer of Unit#2 ; Maine- 518 9578 , 2024 FB</p>		
OFFICER'S SIGNATURE X		BADGE NUMBER 037