

TRAFFIC CRASH REPORT

*DENOTES MANDATORY FIELD FOR SUPPLEMENT REPORT

LOCAL REPORT NUMBER *

2 | 0 | 2 | 5 | 0 | 2 | 4 | 0

- PHOTOS TAKEN OH-2 OH-3
 SECONDARY CRASH OH-1P OTHER
 Private Property

LOCAL INFORMATION

REPORTING AGENCY NAME *

GARFIELD HEIGHTS

NCIC *
0 | 1 | 8 | 2 | 0

HITSKIP
1 - Solved
2 - Unsolved
2

NUMBER OF UNITS
0 | 2

INITIALS IN EDDP
98 - ANIMAL
99 - UNKNOWN
0 | 1

COUNTY *
1 | 8

LOCALITY *
1

LOCATION: CITY, VILLAGE, TOWNSHIP *
GARFIELD HTS

CRASH DATE/TIME *
0 | 2 | 0 | 2 | 2 | 0 | 2 | 5 | 0 | 9 | 0 | 0

CRASH SEVERITY
5

1 - FATAL
2 - SERIOUS INJURY SUSPECTED
3 - MINOR INJURY SUSPECTED
4 - INJURY POSSIBLE
5 - PROPERTY DAMAGE ONLY

ROUTE TYPE
ROUTE NUMBER
PREFIX

1 - NORTH
2 - SOUTH
3 - EAST
4 - WEST
3

LOCATION ROAD NAME
115

ROAD TYPE
S | T

LATITUDE DECIMAL DEGREES
4 | 1 | 4 | 1 | 9 | 6 | 0 | 1

ROUTE TYPE
ROUTE NUMBER
PREFIX

1 - NORTH
2 - SOUTH
3 - EAST
4 - WEST

REFERENCE ROAD NAME (ROAD, MILEPOST, HOUSE #)
5219

ROAD TYPE

LONGITUDE DECIMAL DEGREES
8 | 1 | 6 | 0 | 3 | 3 | 5 | 0

REFERENCE POINT
1 - INTERSECTION
2 - MILE POST
3 - HOUSE #
3

DIRECTION
1 - NORTH
2 - SOUTH
3 - EAST
4 - WEST
1

ROUTE TYPE
IR - INTERSTATE ROUTE (TP)
US - FEDERAL US ROUTE
SR - STATE ROUTE
CR - NUMBERED COUNTY ROUTE
TR - NUMBERED TOWNSHIP ROUTE

ROAD TYPE
AL - ALLEY
AV - AVENUE
BL - BOULEVARD
CR - CIRCLE
CT - COURT
DR - DRIVE
HE - HEIGHTS
HW - HIGHWAY
LA - LANE
MP - MILEPOST
OV - OVAL
PK - PARKWAY
PI - PIKE
PL - PLACE
RD - ROAD
SQ - SQUARE
ST - STREET
TE - TERRACE
TL - TRAIL
WA - WAY

INTERSECTION RELATED
 WITHIN INTERSECTION OR ON APPROACH
 WITHIN INTERCHANGE AREA
NUMBER OF APPROACHES

DISTANCE
1 | 0

DISTANCE
1 - Miles
2 - Feet
3 - Yards
2

ROADWAY
 ROADWAY DIVIDED

LOCATION OF FIRST DAMAGE EVENT
0 | 1

1 - ON ROADWAY
2 - ON SHOULDER
3 - IN MEDIAN
4 - ON ROADSIDE
5 - ON GORE
6 - OUTSIDE TRAFFICWAY
7 - ON RAMP
8 - OFF RAMP
9 - CROSSOVER
10 - DRIVEWAY / ALLEY ACCESS
11 - RAILWAY GRADE CROSSING
12 - SHARED USE PATHS OR TRAILS
13 - BIKE LANE
14 - TOLL BOOTH
99 - OTHER / UNKNOWN

MANNER OF CRASH COLLISION/IMPACT
9

1 - NOT COLLISION BETWEEN TWO MOTOR VEHICLES IN TRANSPORT
2 - REAR-END
3 - HEAD-ON
4 - REAR-TO-REAR
5 - BACKING
6 - ANGLE
7 - SIDESWIPE, SAME DIRECTION
8 - SIDESWIPE, OPPOSITE DIRECTION
9 - OTHER / UNKNOWN

DIRECTION OF TRAVEL
1 - NORTH
2 - SOUTH
3 - EAST
4 - WEST

MEDIAN TYPE
1 - DIVIDED FLUSH MEDIAN (<4 FEET)
2 - DIVIDED FLUSH MEDIAN (24 FEET)
3 - DIVIDED, DEPRESSED MEDIAN
4 - DIVIDED, RAISED MEDIAN (ANY TYPE)
9 - OTHER / UNKNOWN

- WORK ZONE RELATED
 WORKERS PRESENT
 LAW ENFORCEMENT PRESENT
 ACTIVE SCHOOL ZONE

WORK ZONE TYPE
1 - LANE CLOSURE
2 - LANE SHIFT/CROSSOVER
3 - WORK ON SHOULDER
OR MEDIAN
4 - INTERMITTENT OR MOVING WORK
5 - OTHER

LOCATION OF CRASH IN WORK ZONE
1 - BEFORE THE 1ST WORK ZONE WARNING SIGN
2 - ADVANCE WARNING AREA
3 - TRANSITION AREA
4 - ACTIVITY AREA
5 - TERMINATION AREA

CONTOUR
1

1 - STRAIGHT LEVEL
2 - STRAIGHT GRADE
3 - CURVE LEVEL
4 - CURVE GRADE
9 - OTHER / UNKNOWN

CONDITIONS
1

1 - DRY
2 - WET
3 - SNOW
4 - ICE
5 - SAND, MUD, DIRT, OIL, GRAVEL
6 - WATER (STANDING, MOVING)
7 - SLUSH
9 - OTHER/UNKNOWN

SURFACE
2

1 - CONCRETE
2 - BLACKTOP, BITUMINOUS, ASPHALT
3 - BRICK/BLOCK
4 - SLAG, GRAVEL, STONE
5 - DIRT
9 - OTHER / UNKNOWN

LIGHT CONDITION
3

1 - DAYLIGHT
2 - DAWN/DUSK
3 - DARK - LIGHTED ROADWAY
4 - DARK - ROADWAY NOT LIGHTED
5 - DARK - UNKNOWN ROADWAY LIGHTING
9 - OTHER / UNKNOWN

WEATHER
2

1 - CLEAR
2 - CLOUDY
3 - FOG, SMOG, SMOKE
4 - RAIN
5 - SLEET, HAIL
6 - SNOW
7 - SEVERE CROSSWINDS
8 - BLOWING SAND, SOIL, DIRT, SNOW
9 - FREEZING RAIN OR FREEZING DRIZZLE
99 - OTHER / UNKNOWN

NARRATIVE

UNIT 2 WAS PARKED IN FRONT OF 5219 E. 115 ST.

UNIT 1 WAS GOING N/B ON E. 115 ST. AND STRUCK UNIT 2. UNIT 1 LEFT THE SCENE OF THE ACCIDENT.

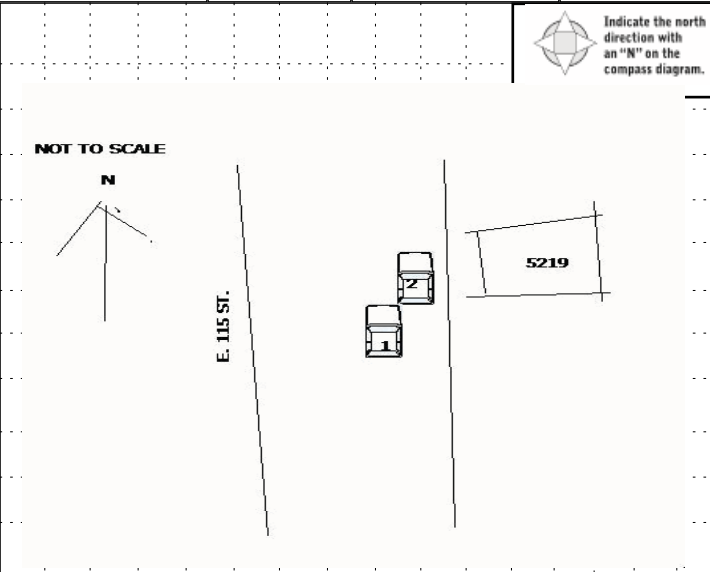

CRASH REPORTED DATE/TIME
0 | 2 | 0 | 2 | 2 | 0 | 2 | 5 | 0 | 9 | 4 | 7

DISPATCH DATE/TIME
0 | 2 | 0 | 2 | 2 | 0 | 2 | 5 | 0 | 9 | 4 | 8

ARRIVAL DATE/TIME
0 | 2 | 0 | 2 | 2 | 0 | 2 | 5 | 1 | 1 | 0 | 0

SCENE CLEARED DATE/TIME
0 | 2 | 0 | 2 | 2 | 0 | 2 | 5 | 1 | 1 | 0 | 1

REPORT TAKEN BY
 POLICE AGENCY
 MOTORIST

TOTAL TIME ROADWAY CLOSED
0

OTHER INVESTIGATION TIME
3 | 0

TOTAL MINUTES
5 | 2

OFFICER'S NAME *
P. Stockhausen

OFFICER'S BADGE NUMBER*
0 | 2 | 5

CHECKED BY OFFICER'S NAME*
D. Bailey

CHECKED BY OFFICER'S BADGE NUMBER*
L | 0 | 7

SUPPLEMENT
(CORRECTION = ADDITION)

OWNER

UNIT # 01 OWNER NAME: LAST, FIRST, MIDDLE () Same As Driver OWNER PHONE: INCLUDE AREA CODE () Same As Driver

OWNER ADDRESS: STREET, CITY, STATE, ZIP () Same As Driver

COMMERCIAL CARRIER: NAME, ADDRESS, CITY, STATE, ZIP COMMERCIAL CARRIER PHONE: INCLUDE AREA CODE

DAMAGE

DAMAGE SCALE

1 - NONE 3 - FUNCTIONAL DAMAGE
2 - MINOR DAMAGE 4 - DISABLING DAMAGE
9 - UNKNOWN

2

VEHICLE

LP STATE _____ LICENSE PLATE # _____ VEHICLE IDENTIFICATION # _____ VEHICLE YEAR _____ VEHICLE MAKE Other/Unknown

INSURANCE VERIFIED INSURANCE COMPANY _____ INSURANCE POLICY # _____ VEHICLE COLOR _____ VEHICLE MODEL Other/Unknown

TYPE OF USE: COMMERCIAL GOVERNMENT IN EMERGENCY RESPONSE

US DOT # _____ TOWED BY: COMPANY NAME _____

INTERLOCK DEVICE EQUIPPED HIT/SKIP UNIT # OCCUPANTS 01

VEHICLE WEIGHT GVWR/GCWR: 1 - <10K LBS. 2 - 10,001 - 26K LBS. 3 - >26K LBS.

HAZARDOUS MATERIAL: MATERIAL RELEASED CLASS # _____ PLACARD ID # _____ PLACARD

DAMAGED AREA(S)

INDICATE ALL THAT APPLY

- NO DAMAGE [0] - UNDERCARRIAGE [14]
 - TOP [13] - ALL AREAS [15]
 - UNIT NOT AT SCENE [16]

UNIT TYPE: 99

1 - PASSENGER CAR 7 - MOTORCYCLE 2-WHEELED 12 - GOLF CART 18 - LIMO (LIVERY VEHICLE) 23 - PEDESTRIAN SKATER
 2 - PASSENGER VAN (MINIVAN) 8 - MOTORCYCLE 3-WHEELED 13 - SNOWMOBILE 19 - BUS (16+ PASSENGERS) 24 - WHEELCHAIR (ANY TYPE)
 3 - SPORT UTILITY VEHICLE 9 - AUTOCYCLE 14 - SINGLE UNIT TRUCK 20 - OTHER VEHICLE 25 - OTHER NON-MOTORIST
 4 - PICK UP 10 - MOPED OR MOTORIZED BICYCLE 15 - SEMI-TRACTOR 21 - HEAVY EQUIPMENT 26 - BICYCLE
 5 - CARGO VAN 11 - ALL TERRAIN VEHICLE (ATV / UTV) 16 - FARM EQUIPMENT 22 - ANIMAL WITH RIDER OR ANIMAL-DRAWN VEHICLE 27 - TRAIN
 6 - VAN (9-15 SEATS) 17 - MOTORHOME

of TRAILING UNITS _____

WAS VEHICLE OPERATING IN AUTONOMOUS MODE WHEN CRASH OCCURRED? 0

1 - YES 2 - NO 9 - OTHER / UNKNOWN

AUTONOMOUS MODE LEVEL: 0 - NO AUTOMATION 1 - DRIVER ASSISTANCE 2 - PARTIAL AUTOMATION 3 - CONDITIONAL AUTOMATION 4 - HIGH AUTOMATION 5 - FULL AUTOMATION 9 - UNKNOWN

SPECIAL FUNCTION: 1 - NONE 2 - TAXI 3 - ELECTRONIC RIDE SHARING 4 - SCHOOL TRANSPORT 5 - BUS-TRANSIT/COMMUTER 6 - BUS - CHARTER/TOUR 7 - BUS - INTERCITY 8 - BUS - SHUTTLE 9 - BUS - OTHER 10 - AMBULANCE 11 - FIRE 12 - MILITARY 13 - POLICE 14 - PUBLIC UTILITY 15 - CONSTRUCTION EQUIPMENT 16 - FARM 17 - MOWING 18 - SNOW REMOVAL 19 - TOWING 20 - SAFETY SERVICE PATROL 21 - MAIL CARRIER 99 - OTHER UNKNOWN

CARGO BODY TYPE: 1 - NO CARGO BODY TYPE / NOT APPLICABLE 2 - BUS 3 - VEHICLE TOWING ANOTHER MOTOR VEHICLE 4 - LOGGING 5 - INTERMODAL CONTAINER CHASSIS 6 - CARGO VAN/ENCLOSED BOX 7 - GRAIN/CHIPS/GRAVEL 8 - POLE 9 - CARGO TANK 10 - FLAT BED 11 - DUMP 12 - CONCRETE MIXER 13 - AUTO TRANSPORTER 14 - GARBAGE/REFUSE 99 - OTHER / UNKNOWN

VEHICLE DEFECTS: 1 - TURN SIGNALS 2 - HEAD LAMPS 3 - TAIL LAMPS 4 - BRAKES 5 - STEERING 6 - TIRE BLOWOUT 7 - WORN OR SLICK TIRES 8 - TRAILER EQUIPMENT DEFECTIVE 9 - MOTOR TROUBLE 10 - DISABLED FROM PRIOR ACCIDENT 99 - OTHER / UNKNOWN

NON-MOTORIST LOCATION AT IMPACT: 1 - INTERSECTION - MARKED CROSSWALK 2 - INTERSECTION - UNMARKED CROSSWALK 3 - INTERSECTION - OTHER 4 - MIDBLOCK - MARKED CROSSWALK 5 - TRAVEL LANE-OTHER LOCATION 6 - BICYCLE LANE 7 - SHOULDER/ROADSIDE 8 - SIDEWALK 9 - MEDIAN/CROSSING ISLAND 10 - DRIVEWAY ACCESS 11 - SHARED USE PATHS OR TRAILS 12 - FIRST RESPONDER AT INCIDENT SCENE 99 - OTHER / UNKNOWN

ACTION: 3

1 - NON-CONTACT 2 - NON-COLLISION 3 - STRIKING 4 - STRUCK 5 - BOTH STRIKING & STRUCK 9 - OTHER / UNKNOWN

PRE-CRASH ACTION: 01

1 - STRAIGHT AHEAD 2 - BACKING 3 - CHANGING LANES 4 - OVERTAKING/PASSING 5 - MAKING RIGHT TURN 6 - MAKING LEFT TURN 7 - MAKING U-TURN 8 - ENTERING TRAFFIC LANE 9 - LEAVING TRAFFIC LANE 10 - PARKED 11 - SLOWING OR STOPPED IN TRAFFIC 12 - DRIVERLESS 13 - NEGOTIATING A CURVE 14 - ENTERING OR CROSSING SPECIFIED LOCATION 15 - WALKING, RUNNING, JOGGING, PLAYING 16 - WORKING 17 - PUSHING VEHICLE 18 - APPROACHING OR LEAVING VEHICLE 19 - STANDING 20 - OTHER NON-MOTORIST 21 - STANDING OUTSIDE DISABLED VEHICLE 99 - OTHER / UNKNOWN

INITIAL POINT OF CONTACT

01

0 - NO DAMAGE 1-12 - REFER TO UNIT DIAGRAM 13 - TOP 14 - UNDERCARRIAGE 15 - VEHICLE NOT AT SCENE 99 - UNKNOWN

CONTRIBUTING CIRCUMSTANCES: 99

1 - NONE 2 - FAILURE TO YIELD 3 - RAN RED LIGHT 4 - RAN STOP SIGN 5 - UNSAFE SPEED 6 - IMPROPER TURN 7 - LEFT OF CENTER 8 - FOLLOWING TOO CLOSE/ACDA 9 - IMPROPER LANE CHANGING 10 - IMPROPER PASSING 11 - DROVE OFF ROAD 12 - IMPROPER BACKING 13 - IMPROPER START FROM A PARKED POSITION 14 - STOPPED OR PARKED ILLEGALLY 15 - SWERVING TO AVOID 16 - WRONG WAY 17 - VISION OBSTRUCTION 18 - OPERATING DEFECTIVE EQUIPMENT 19 - LOAD SHIFTING/ FALLING/SPILLING 20 - IMPROPER CROSSING 21 - LYING IN ROADWAY 22 - NOT DISCERNABLE 23 - OPENING DOOR INTO ROADWAY 99 - OTHER IMPROPER ACTION

TRAFFIC

TRAFFICWAY FLOW: 2

1 - ONE-WAY 2 - TWO-WAY

TRAFFIC CONTROL: 6

1 - ROUNDABOUT 2 - SIGNAL 3 - FLASHER 4 - STOP SIGN 5 - YIELD SIGN 6 - NO CONTROL

EVENT(S)

SEQUENCE OF EVENTS

1 21

1 - OVERTURN/ROLLOVER 2 - FIRE/EXPLOSION 3 - IMMERSION 4 - JACKKNIFE 5 - CARGO / EQUIPMENT LOSS OR SHIFT

EVENTS

6 - EQUIPMENT FAILURE 7 - SEPARATION OF UNITS 8 - RAN OFF ROAD RIGHT 9 - RAN OFF ROAD LEFT 10 - CROSS MEDIAN 11 - CROSS CENTERLINE - OPPOSITE DIRECTION OF TRAVEL 12 - DOWNHILL RUNAWAY 13 - OTHER NON-COLLISION 14 - PEDESTRIAN 15 - PEDALCYCLE 16 - RAILWAY VEHICLE 17 - ANIMAL - FARM 18 - ANIMAL - DEER 19 - ANIMAL - OTHER 20 - MOTOR VEHICLE IN TRANSPORT 21 - PARKED MOTOR VEHICLE 22 - WORK ZONE MAINTENANCE EQUIPMENT 23 - STRUCK BY FALLING, SHIFTING CARGO OR ANYTHING SET IN MOTION BY A MOTOR VEHICLE 24 - OTHER MOVABLE OBJECT

COLLISION WITH FIXED OBJECT - STRUCK

25 - IMPACT ATTENUATOR / CRASH CUSHION 26 - BRIDGE OVERHEAD STRUCTURE 27 - BRIDGE PIER OR ABUTMENT 28 - BRIDGE PARAPET 29 - BRIDGE RAIL 30 - GUARDRAIL FACE 31 - GUARDRAIL END 32 - PORTABLE BARRIER 33 - MEDIAN CABLE BARRIER 34 - MEDIAN GUARDRAIL BARRIER 35 - MEDIAN CONCRETE BARRIER 36 - MEDIAN OTHER BARRIER 37 - TRAFFIC SIGN POST 38 - OVERHEAD SIGN POST 39 - LIGHT/LUMINARIES SUPPORT 40 - UTILITY POLE 41 - OTHER POST, POLE OR SUPPORT 42 - CULVERT 43 - CURB 44 - DITCH 45 - EMBANKMENT 46 - FENCE 47 - MAILBOX 48 - TREE 49 - FIRE HYDRANT 50 - WORKZONE MAINTENANCE EQUIPMENT 51 - WALL 52 - BUILDING 53 - TUNNEL 54 - OTHER FIXED OBJECT 99 - OTHER / UNKNOWN

FIRST HARMFUL EVENT: 1 MOST HARMFUL EVENT: 1

OF THROUGH LANES ON ROAD: 2

RAIL GRADE CROSSING: 1

1 - NOT INVOLVED 2 - INVOLVED - ACTIVE CROSSING 3 - INVOLVED - PASSIVE CROSSING

UNIT / NON-MOTORIST DIRECTION

FROM 2 TO 1

1 - NORTH 2 - SOUTH 3 - EAST 4 - WEST 5 - NORTHEAST 6 - NORTHWEST 7 - SOUTHEAST 8 - SOUTHWEST 9 - OTHER / UNKNOWN

UNIT SPEED: _____

POSTED SPEED: 25

DETECTED SPEED: 3

1 - STATED/ESTIMATED SPEED 2 - CALCULATED / EDR 3 - UNDETERMINED

OWNER INFORMATION

UNIT # 0 2 OWNER NAME: LAST, FIRST, MIDDLE () Same As Driver
ALLEN ZACHARY JAMES

OWNER PHONE: INCLUDE AREA CODE () Same As Driver

OWNER ADDRESS: STREET, CITY, STATE, ZIP () Same As Driver
1091 MURRAY AVE AKRON OH 44310

COMMERCIAL CARRIER: NAME, ADDRESS, CITY, STATE, ZIP

COMMERCIAL CARRIER PHONE: INCLUDE AREA CODE

DAMAGE

DAMAGE SCALE

1 - NONE
2 - MINOR DAMAGE
3 - FUNCTIONAL DAMAGE
4 - DISABLING DAMAGE
9 - UNKNOWN

3

VEHICLE INFORMATION

LP STATE OH LICENSE PLATE # KNN3752 VEHICLE IDENTIFICATION # 3N1A1B6AP7B1705853 VEHICLE YEAR 2011 VEHICLE MAKE Nissan

INSURANCE VERIFIED INSURANCE COMPANY PROGRESSIVE INSURANCE POLICY # 992521614 VEHICLE COLOR RED VEHICLE MODEL Sentra

TYPE OF USE: COMMERCIAL GOVERNMENT IN EMERGENCY RESPONSE

INTERLOCK DEVICE EQUIPPED HIT/SKIP UNIT # OCCUPANTS 0 0 US DOT # _____ TOWED BY: COMPANY NAME _____

HAZARDOUS MATERIAL: MATERIAL RELEASED CLASS # _____ PLACARD ID # _____

DAMAGED AREA(S)

INDICATE ALL THAT APPLY

NO DAMAGE [0] UNDERCARRIAGE [14]
 TOP [13] ALL AREAS [15]
 UNIT NOT AT SCENE [16]

VEHICLE TYPE

1 - PASSENGER CAR
2 - PASSENGER VAN (MINIVAN)
3 - SPORT UTILITY VEHICLE
4 - PICK UP
5 - CARGO VAN
6 - VAN (9-15 SEATS)
7 - MOTORCYCLE 2-WHEELED
8 - MOTORCYCLE 3-WHEELED
9 - AUTOCYCLE
10 - MOPED OR MOTORIZED BICYCLE
11 - ALL TERRAIN VEHICLE (ATV / UTV)
12 - GOLF CART
13 - SNOWMOBILE
14 - SINGLE UNIT TRUCK
15 - SEMI-TRACTOR
16 - FARM EQUIPMENT
17 - MOTORHOME
18 - LIMO (LIVERY VEHICLE)
19 - BUS (16+ PASSENGERS)
20 - OTHER VEHICLE
21 - HEAVY EQUIPMENT
22 - ANIMAL WITH RIDER OR ANIMAL-DRAWN VEHICLE
23 - PEDESTRIAN SKATER
24 - WHEELCHAIR (ANY TYPE)
25 - OTHER NON-MOTORIST
26 - BICYCLE
27 - TRAIN
99 - UNKNOWN OR HIT/SKIP

of TRAILING UNITS _____

WAS VEHICLE OPERATING IN AUTONOMOUS MODE WHEN CRASH OCCURRED? 2

1 - YES 2 - NO 9 - OTHER / UNKNOWN

AUTONOMOUS MODE LEVEL 0

0 - NO AUTOMATION
1 - DRIVER ASSISTANCE
2 - PARTIAL AUTOMATION
3 - CONDITIONAL AUTOMATION
4 - HIGH AUTOMATION
5 - FULL AUTOMATION
9 - UNKNOWN

SPECIAL FUNCTION 0 1

1 - NONE
2 - TAXI
3 - ELECTRONIC RIDE SHARING
4 - SCHOOL TRANSPORT
5 - BUS-TRANSIT/COMMUTER
6 - BUS - CHARTER/TOUR
7 - BUS - INTERCITY
8 - BUS - SHUTTLE
9 - BUS - OTHER
10 - AMBULANCE
11 - FIRE
12 - MILITARY
13 - POLICE
14 - PUBLIC UTILITY
15 - CONSTRUCTION EQUIPMENT
16 - FARM
17 - MOWING
18 - SNOW REMOVAL
19 - TOWING
20 - SAFETY SERVICE PATROL
21 - MAIL CARRIER
99 - OTHER UNKNOWN

CARGO BODY TYPE 0 1

1 - NO CARGO BODY TYPE / NOT APPLICABLE
2 - BUS
3 - VEHICLE TOWING ANOTHER MOTOR VEHICLE
4 - LOGGING
5 - INTERMODAL CONTAINER CHASSIS
6 - CARGO VAN/ENCLOSED BOX
7 - GRAIN/CHIPS/GRAVEL
8 - POLE
9 - CARGO TANK
10 - FLAT BED
11 - DUMP
12 - CONCRETE MIXER
13 - AUTO TRANSPORTER
14 - GARBAGE/REFUSE
99 - OTHER / UNKNOWN

VEHICLE DEFECTS

1 - TURN SIGNALS
2 - HEAD LAMPS
3 - TAIL LAMPS
4 - BRAKES
5 - STEERING
6 - TIRE BLOWOUT
7 - WORN OR SLICK TIRES
8 - TRAILER EQUIPMENT DEFECTIVE
9 - MOTOR TROUBLE
10 - DISABLED FROM PRIOR ACCIDENT
99 - OTHER / UNKNOWN

NON-MOTORIST LOCATION AT IMPACT 0 1

1 - INTERSECTION - MARKED CROSSWALK
2 - INTERSECTION - UNMARKED CROSSWALK
3 - INTERSECTION - OTHER
4 - MIDBLOCK - MARKED CROSSWALK
5 - TRAVEL LANE-OTHER LOCATION
6 - BICYCLE LANE
7 - SHOULDER/ROADSIDE
8 - SIDEWALK
9 - MEDIAN/CROSSING ISLAND
10 - DRIVEWAY ACCESS
11 - SHARED USE PATHS OR TRAILS
12 - FIRST RESPONDER AT INCIDENT SCENE
99 - OTHER / UNKNOWN

ACTION 4

1 - NON-CONTACT
2 - NON-COLLISION
3 - STRIKING
4 - STRUCK
5 - BOTH STRIKING & STRUCK
9 - OTHER / UNKNOWN
1 - STRAIGHT AHEAD
2 - BACKING
3 - CHANGING LANES
4 - OVERTAKING/PASSING
5 - MAKING RIGHT TURN
6 - MAKING LEFT TURN
7 - MAKING U-TURN
8 - ENTERING TRAFFIC LANE
9 - LEAVING TRAFFIC LANE
10 - PARKED
11 - SLOWING OR STOPPED IN TRAFFIC
12 - DRIVERLESS
13 - NEGOTIATING A CURVE
14 - ENTERING OR CROSSING SPECIFIED LOCATION
15 - WALKING, RUNNING, JOGGING, PLAYING
16 - WORKING
17 - PUSHING VEHICLE
18 - APPROACHING OR LEAVING VEHICLE
19 - STANDING
20 - OTHER NON-MOTORIST
21 - STANDING OUTSIDE DISABLED VEHICLE
99 - OTHER / UNKNOWN

INITIAL POINT OF CONTACT

0 7

0 - NO DAMAGE
1-12 - REFER TO UNIT DIAGRAM
13 - TOP
14 - UNDERCARRIAGE
15 - VEHICLE NOT AT SCENE
99 - UNKNOWN

CONTRIBUTING CIRCUMSTANCES 0 1

1 - NONE
2 - FAILURE TO YIELD
3 - RAN RED LIGHT
4 - RAN STOP SIGN
5 - UNSAFE SPEED
6 - IMPROPER TURN
7 - LEFT OF CENTER
8 - FOLLOWING TOO CLOSE/ACDA
9 - IMPROPER LANE CHANGING
10 - IMPROPER PASSING
11 - DROVE OFF ROAD
12 - IMPROPER BACKING
13 - IMPROPER START FROM A PARKED POSITION
14 - STOPPED OR PARKED ILLEGALLY
15 - SWERVING TO AVOID
16 - WRONG WAY
17 - VISION OBSTRUCTION
18 - OPERATING DEFECTIVE EQUIPMENT
19 - LOAD SHIFTING/ FALLING/SPILLING
20 - IMPROPER CROSSING
21 - LYING IN ROADWAY
22 - NOT DISCERNABLE
23 - OPENING DOOR INTO ROADWAY
99 - OTHER IMPROPER ACTION

TRAFFIC

TRAFFICWAY FLOW 2

1 - ONE-WAY
2 - TWO-WAY

TRAFFIC CONTROL 6

1 - ROUNDABOUT
2 - SIGNAL
3 - FLASHER
4 - STOP SIGN
5 - YIELD SIGN
6 - NO CONTROL

SEQUENCE OF EVENTS

EVENTS

1 2 0

1 - OVERTURN/ROLLOVER
2 - FIRE/EXPLOSION
3 - IMMERSION
4 - JACKKNIFE
5 - CARGO / EQUIPMENT LOSS OR SHIFT
6 - EQUIPMENT FAILURE
7 - SEPARATION OF UNITS
8 - RAN OFF ROAD RIGHT
9 - RAN OFF ROAD LEFT
10 - CROSS MEDIAN
11 - CROSS CENTERLINE - OPPOSITE DIRECTION OF TRAVEL
12 - DOWNHILL RUNAWAY
13 - OTHER NON-COLLISION
14 - PEDESTRIAN
15 - PEDALCYCLE
16 - RAILWAY VEHICLE
17 - ANIMAL - FARM
18 - ANIMAL - DEER
19 - ANIMAL - OTHER
20 - MOTOR VEHICLE IN TRANSPORT
21 - PARKED MOTOR VEHICLE
22 - WORK ZONE MAINTENANCE EQUIPMENT
23 - STRUCK BY FALLING, SHIFTING CARGO OR ANYTHING SET IN MOTION BY A MOTOR VEHICLE
24 - OTHER MOVABLE OBJECT

OF THROUGH LANES ON ROAD 2

RAIL GRADE CROSSING 1

1 - NOT INVOLVED
2 - INVOLVED - ACTIVE CROSSING
3 - INVOLVED - PASSIVE CROSSING

COLLISION WITH FIXED OBJECT - STRUCK

25 - IMPACT ATTENUATOR / CRASH CUSHION
26 - BRIDGE OVERHEAD STRUCTURE
27 - BRIDGE PIER OR ABUTMENT
28 - BRIDGE PARAPET
29 - BRIDGE RAIL
30 - GUARDRAIL FACE
31 - GUARDRAIL END
32 - PORTABLE BARRIER
33 - MEDIAN CABLE BARRIER
34 - MEDIAN GUARDRAIL BARRIER
35 - MEDIAN CONCRETE BARRIER
36 - MEDIAN OTHER BARRIER
37 - TRAFFIC SIGN POST
38 - OVERHEAD SIGN POST
39 - LIGHT/LUMINARIES SUPPORT
40 - UTILITY POLE
41 - OTHER POST, POLE OR SUPPORT
42 - CULVERT
43 - CURB
44 - DITCH
45 - EMBANKMENT
46 - FENCE
47 - MAILBOX
48 - TREE
49 - FIRE HYDRANT
50 - WORKZONE MAINTENANCE EQUIPMENT
51 - WALL
52 - BUILDING
53 - TUNNEL
54 - OTHER FIXED OBJECT
99 - OTHER / UNKNOWN

UNIT / NON-MOTORIST DIRECTION

FROM 2 TO 1

1 - NORTH
2 - SOUTH
3 - EAST
4 - WEST
5 - NORTHEAST
6 - NORTHWEST
7 - SOUTHEAST
8 - SOUTHWEST
9 - OTHER / UNKNOWN

FIRST HARMFUL EVENT 1

MOST HARMFUL EVENT 1

UNIT SPEED 0

POSTED SPEED 2 5

DETECTED SPEED 1

1 - STATED/ESTIMATED SPEED
2 - CALCULATED / EDR
3 - UNDETERMINED

MOTORIST / NON-MOTORIST

LOCAL REPORT NUMBER
2 0 2 5 0 2 4 0

UNIT # 0 1	NAME: LAST, FIRST, MIDDLE UNKNOWN UNKNOWN	DATE OF BIRTH	AGE	GENDER U
ADDRESS: STREET, CITY, STATE, ZIP UNKNOWN OH		CONTACT PHONE - INCLUDE AREA CODE		
INJURIES	INJURED TAKEN BY	EMS AGENCY (NAME)	INJURED TAKEN TO: MEDICAL FACILITY (NAME, CITY)	SAFETY EQUIPMENT USED
OL STATE	OPERATOR LICENSE NUMBER	OFFENSE CHARGED	LOCAL CODE	OFFENSE DESCRIPTION
OL CLASS	ENDORSEMENT SELECT UP TO 2	RESTRICTION SELECT UP TO 3	DRIVER DISTRACTED BY	ALCOHOL / DRUG SUSPECTED
DOT-COMPLIANT MC HELMET		SEATING POSITION	AIR BAG USAGE	EJECTION
TRAPPED		CITATION NUMBER		
ALCOHOL TEST		DRUG TEST(S)		
STATUS	TYPE	VALUE	STATUS	TYPE
RESULT SELECT UP TO 4				

UNIT #	NAME: LAST, FIRST, MIDDLE	DATE OF BIRTH	AGE	GENDER
ADDRESS: STREET, CITY, STATE, ZIP		CONTACT PHONE - INCLUDE AREA CODE		
INJURIES	INJURED TAKEN BY	EMS AGENCY (NAME)	INJURED TAKEN TO: MEDICAL FACILITY (NAME, CITY)	SAFETY EQUIPMENT USED
OL STATE	OPERATOR LICENSE NUMBER	OFFENSE CHARGED	LOCAL CODE	OFFENSE DESCRIPTION
OL CLASS	ENDORSEMENT SELECT UP TO 2	RESTRICTION SELECT UP TO 3	DRIVER DISTRACTED BY	ALCOHOL / DRUG SUSPECTED
DOT-COMPLIANT MC HELMET		SEATING POSITION	AIR BAG USAGE	EJECTION
TRAPPED		CITATION NUMBER		
ALCOHOL TEST		DRUG TEST(S)		
STATUS	TYPE	VALUE	STATUS	TYPE
RESULT SELECT UP TO 4				

UNIT #	NAME: LAST, FIRST, MIDDLE	DATE OF BIRTH	AGE	GENDER
ADDRESS: STREET, CITY, STATE, ZIP		CONTACT PHONE - INCLUDE AREA CODE		
INJURIES	INJURED TAKEN BY	EMS AGENCY (NAME)	INJURED TAKEN TO: MEDICAL FACILITY (NAME, CITY)	SAFETY EQUIPMENT USED
OL STATE	OPERATOR LICENSE NUMBER	OFFENSE CHARGED	LOCAL CODE	OFFENSE DESCRIPTION
OL CLASS	ENDORSEMENT SELECT UP TO 2	RESTRICTION SELECT UP TO 3	DRIVER DISTRACTED BY	ALCOHOL / DRUG SUSPECTED
DOT-COMPLIANT MC HELMET		SEATING POSITION	AIR BAG USAGE	EJECTION
TRAPPED		CITATION NUMBER		
ALCOHOL TEST		DRUG TEST(S)		
STATUS	TYPE	VALUE	STATUS	TYPE
RESULT SELECT UP TO 4				

INJURIES	SEATING POSITION	AIR BAG	OL CLASS	OL RESTRICTION(S)	DRIVER DISTRACTION	TEST STATUS
1 - FATAL	1 - FRONT - LEFT SIDE (MOTORCYCLE DRIVER)	1 - NOT DEPLOYED	1 - CLASS A	1 - ALCOHOL INTERLOCK DEVICE	1 - NOT DISTRACTED	1 - NONE GIVEN
2 - SUSPECTED SERIOUS INJURY	2 - FRONT - MIDDLE	2 - DEPLOYED FRONT	2 - CLASS B	2 - CDL INTRASTATE ONLY	2 - MANUALLY OPERATING AN ELECTRONIC COMMUNICATION DEVICE (TEXTING, TYPING, DIALING)	2 - TEST REFUSED
3 - SUSPECTED MINOR INJURY	3 - FRONT - RIGHT SIDE	3 - DEPLOYED SIDE	3 - CLASS C	3 - CORRECTIVE LENSES	3 - TALKING ON HANDS-FREE COMMUNICATION DEVICE	3 - TEST GIVEN, CONTAMINATED SAMPLE / UNUSABLE
4 - POSSIBLE INJURY	4 - SECOND - LEFT SIDE (MOTORCYCLE PASSENGER)	4 - DEPLOYED BOTH FRONT / SIDE	4 - REGULAR CLASS (OHIO = D)	4 - FARM WAIVER	4 - TALKING ON HAND-HELD COMMUNICATION DEVICE	4 - TEST GIVEN, RESULTS KNOWN
5 - NO APPARENT INJURY	5 - SECOND - MIDDLE	5 - NOT APPLICABLE	5 - M / C MOPED ONLY	5 - EXCEPT CLASS A BUS & CLASS B BUS	5 - OTHER ACTIVITY WITH AN ELECTRONIC DEVICE	5 - TEST GIVEN, RESULTS UNKNOWN
INJURED TAKEN BY		6 - SECOND - RIGHT SIDE	6 - NO VALID OL	6 - EXCEPT CLASS A & CLASS B BUS	6 - PASSENGER	ALCOHOL TEST TYPE
1 - NOT TRANSPORTED / TREATED AT SCENE	7 - THIRD - LEFT SIDE (MOTORCYCLE SIDE CAR)	9 - DEPLOYMENT UNKNOWN		7 - EXCEPT TRACTOR-TRAILER RESTRICTIONS	7 - OTHER DISTRACTION INSIDE THE VEHICLE	1 - NONE
2 - EMS	8 - THIRD - MIDDLE	EJECTION	OL ENDORSEMENT	8 - INTERMEDIATE LICENSE RESTRICTIONS	8 - OTHER DISTRACTIONS OUTSIDE THE VEHICLE	2 - BLOOD
3 - POLICE	9 - THIRD - RIGHT SIDE	1 - NOT EJECTED	H - HAZMAT	9 - LEARNER'S PERMIT RESTRICTIONS	9 - OTHER / UNKNOWN	3 - URINE
9 - OTHER / UNKNOWN	10 - SLEEPER SECTION OF TRUCK CAB	2 - PARTIALLY EJECTED	M - MOTORCYCLE	10 - LIMITED TO DAYLIGHT ONLY		4 - BREATH
SAFETY EQUIPMENT		3 - TOTALLY EJECTED	P - PASSENGER	11 - LIMITED TO EMPLOYMENT	CONDITION	5 - OTHER
1 - NONE USED	12 - PASSENGER IN UNENCLOSED CARGO AREA	4 - NOT APPLICABLE	N - TANKER	12 - LIMITED - OTHER	1 - APPARENTLY NORMAL	DRUG TEST TYPE
2 - SHOULDER BELT ONLY USED	13 - TRAILING UNIT	TRAPPED	Q - MOTOR SCOOTER	13 - MECHANICAL DEVICES (SPECIAL BRAKES, HAND CONTROLS, OR OTHER ADAPTIVE DEVICES)	2 - PHYSICAL IMPAIRMENT	1 - NONE
3 - LAP BELT ONLY USED	14 - RIDING ON VEHICLE EXTERIOR (NON-TRAILING UNIT)	1 - NOT TRAPPED	R - THREE-WHEEL MOTORCYCLE	14 - MILITARY VEHICLES ONLY	3 - EMOTIONAL (E.G. DEPRESSED, ANGRY, DISTURBED)	2 - BLOOD
4 - SHOULDER & LAP BELT USED	15 - NON-MOTORIST	2 - EXTRICATED BY MECHANICAL MEANS	S - SCHOOL BUS	15 - MOTOR VEHICLES WITHOUT AIR BRAKES	4 - ILLNESS	3 - URINE
5 - CHILD RESTRAINT SYSTEM - FORWARD FACING	99 - OTHER / UNKNOWN	3 - FREED BY NON-MECHANICAL MEANS	T - DOUBLE & TRIPLE TRAILERS	16 - OUTSIDE MIRROR	5 - FELL ASLEEP, FAINTED, FATIGUED, ETC.	4 - OTHER
6 - CHILD RESTRAINT SYSTEM - REAR FACING			X - TANKER / HAZMAT	17 - PROSTHETIC AID	6 - UNDER THE INFLUENCE OF MEDICATIONS / DRUGS / ALCOHOL	DRUG TEST RESULT(S)
7 - BOOSTER SEAT				18 - OTHER	9 - OTHER / UNKNOWN	1 - AMPHETAMINES
8 - HELMET USED			GENDER			2 - BARBITURATES
9 - PROTECTIVE PADS USED (ELBOWS, KNEES, ETC.)			F - FEMALE			3 - BENZODIAZEPINES
10 - REFLECTIVE CLOTHING			M - MALE			4 - CANNABINOIDS
11 - LIGHTING - PEDESTRIAN / BICYCLE ONLY			U - OTHER/UNKNOWN			5 - COCAINE
99 - OTHER / UNKNOWN						6 - OPIATES / OPIOIDS
						7 - OTHER
						8 - NEGATIVE RESULTS