

TRAFFIC CRASH REPORT

*DENOTES MANDATORY FIELD FOR SUPPLEMENT REPORT

LOCAL REPORT NUMBER *

2 | 0 | 2 | 4 | 3 | 1 | 9 | 7 |

PHOTOS TAKEN OH-2 OH-3
 SECONDARY CRASH OH-1P OTHER
 Private Property

LOCAL INFORMATION

REPORTING AGENCY NAME *

GARFIELD HEIGHTS

NCIC *
0 | 1 | 8 | 2 | 0

HITSKIP
1 - Solved
2 - Unsolved
2

NUMBER OF UNITS
0 | 2

INITIALS IN EDDP
98 - ANIMAL
99 - UNKNOWN
0 | 1

COUNTY *
1 | 8

LOCALITY *
1

LOCATION: CITY, VILLAGE, TOWNSHIP *
GARFIELD HTS

CRASH DATE/TIME *
1 | 1 | 2 | 2 | 2 | 0 | 2 | 4 | 1 | 8 | 0 | 6 |

CRASH SEVERITY
5

1 - FATAL
2 - SERIOUS INJURY SUSPECTED
3 - MINOR INJURY SUSPECTED
4 - INJURY POSSIBLE
5 - PROPERTY DAMAGE ONLY

ROUTE TYPE
R

ROUTE NUMBER
4 | 8 | 0

PREFIX
1 - NORTH
2 - SOUTH
3 - EAST
4 - WEST

LOCATION ROAD NAME

ROAD TYPE

ATTITUDE (NORMAL DEGREE)
4 | 1 | 4 | 1 | 2 | 7 | 5 | 2 |

ROUTE TYPE
S | R

ROUTE NUMBER
1 | 7

PREFIX
1 - NORTH
2 - SOUTH
3 - EAST
4 - WEST

REFERENCE ROAD NAME (ROAD, MILEPOST, HOUSE #)
GRANGER

ROAD TYPE
R | D

LONGITUDE (DECIMAL DEGREES)
8 | 1 | 6 | 1 | 5 | 8 | 2 | 8 |

REFERENCE POINT
1 - INTERSECTION
2 - MILE POST
3 - HOUSE #
1

DIRECTION
1 - NORTH
2 - SOUTH
3 - EAST
4 - WEST
3

ROUTE TYPE
IR - INTERSTATE ROUTE (TP)
US - FEDERAL US ROUTE
SR - STATE ROUTE
CR - NUMBERED COUNTY ROUTE
TR - NUMBERED TOWNSHIP ROUTE

ROAD TYPE
AL - ALLEY
AV - AVENUE
BL - BOULEVARD
CR - CIRCLE
CT - COURT
DR - DRIVE
HE - HEIGHTS
HW - HIGHWAY
LA - LANE
LA - LANE
MP - MILEPOST
OV - OVAL
PK - PARKWAY
PI - PIKE
PL - PLACE
RD - ROAD
SQ - SQUARE
ST - STREET
TE - TERRACE
TL - TRAIL
WA - WAY

INTERSECTION RELATED
 WITHIN INTERSECTION OR ON APPROACH
 WITHIN INTERCHANGE AREA
NUMBER OF APPROACHES

DISTANCE
0 | 2

DISTANCE
1

ROADWAY
 ROADWAY DIVIDED

LOCATION - FIRST AND SECOND EVENT
0 | 1

1 - ON ROADWAY
2 - ON SHOULDER
3 - IN MEDIAN
4 - ON ROADSIDE
5 - ON GORE
6 - OUTSIDE TRAFFICWAY
7 - ON RAMP
8 - OFF RAMP
9 - CROSSOVER
10 - DRIVEWAY / ALLEY ACCESS
11 - RAILWAY GRADE CROSSING
12 - SHARED USE PATHS OR TRAILS
13 - BIKE LANE
14 - TOLL BOOTH
99 - OTHER / UNKNOWN

MANNER OF CRASH COLLISION/IMPACT
2

1 - NOT COLLISION BETWEEN TWO MOTOR VEHICLES IN TRANSPORT
2 - REAR-END
3 - HEAD-ON
4 - REAR-TO-REAR
5 - BACKING
6 - ANGLE
7 - SIDESWIPE, SAME DIRECTION
8 - SIDESWIPE, OPPOSITE DIRECTION
9 - OTHER / UNKNOWN

DIRECTION OF TRAVEL
1 - NORTH
2 - SOUTH
3 - EAST
4 - WEST

MEDIAN TYPE
1 - DIVIDED FLUSH MEDIAN (<4 FEET)
2 - DIVIDED FLUSH MEDIAN (24 FEET)
3 - DIVIDED, DEPRESSED MEDIAN
4 - DIVIDED, RAISED MEDIAN (ANY TYPE)
9 - OTHER / UNKNOWN

WORK ZONE RELATED
 WORKERS PRESENT
 LAW ENFORCEMENT PRESENT
 ACTIVE SCHOOL ZONE

WORK ZONE TYPE
1 - LANE CLOSURE
2 - LANE SHIFT/CROSSOVER
3 - WORK ON SHOULDER
OR MEDIAN
4 - INTERMITTENT OR MOVING WORK
5 - OTHER

LOCATION OF CRASH IN WORK ZONE
1 - BEFORE THE 1ST WORK ZONE WARNING SIGN
2 - ADVANCE WARNING AREA
3 - TRANSITION AREA
4 - ACTIVITY AREA
5 - TERMINATION AREA

CONTOUR
1

1 - STRAIGHT LEVEL
2 - STRAIGHT GRADE
3 - CURVE LEVEL
4 - CURVE GRADE
9 - OTHER / UNKNOWN

CONDITIONS
2

1 - DRY
2 - WET
3 - SNOW
4 - ICE
5 - SAND, MUD, DIRT, OIL, GRAVEL
6 - WATER (STANDING, MOVING)
7 - SLUSH
9 - OTHER/UNKNOWN

SURFACE
2

1 - CONCRETE
2 - BLACKTOP, BITUMINOUS, ASPHALT
3 - BRICK/BLOCK
4 - SLAG, GRAVEL, STONE
5 - DIRT
9 - OTHER / UNKNOWN

LIGHT CONDITION
1

1 - DAYLIGHT
2 - DAWN/DUSK
3 - DARK - LIGHTED ROADWAY
4 - DARK - ROADWAY NOT LIGHTED
5 - DARK - UNKNOWN ROADWAY LIGHTING
9 - OTHER / UNKNOWN

WEATHER
4

1 - CLEAR
2 - CLOUDY
3 - FOG, SMOG, SMOKE
4 - RAIN
5 - SLEET, HAIL
6 - SNOW
7 - SEVERE CROSSWINDS
8 - BLOWING SAND, SOIL, DIRT, SNOW
9 - FREEZING RAIN OR FREEZING DRIZZLE
99 - OTHER / UNKNOWN

INDICATE THE NORTH DIRECTION WITH AN "N" ON THE COMPASS DIAGRAM.

UNIT 2 WAS TRAVELING W/B ON IR 480 AFTER GRANGER ON RAMP IN LANE 4. UNIT 1 WAS DIRECTLY BEHIND UNIT 2. UNIT 2 STATED THAT THE DRIVER OF UNIT 1 FAILED TO MAINTAIN ASSURED CLEARED DISTANCE AHEAD AND CAUSED THE ACCIDENT BY STRIKING UNIT 2 IN THE REAR WITH UNIT 1'S FRONT BUMPER. UNIT 1 LEFT THE SCENE WITHOUT STOPPING.

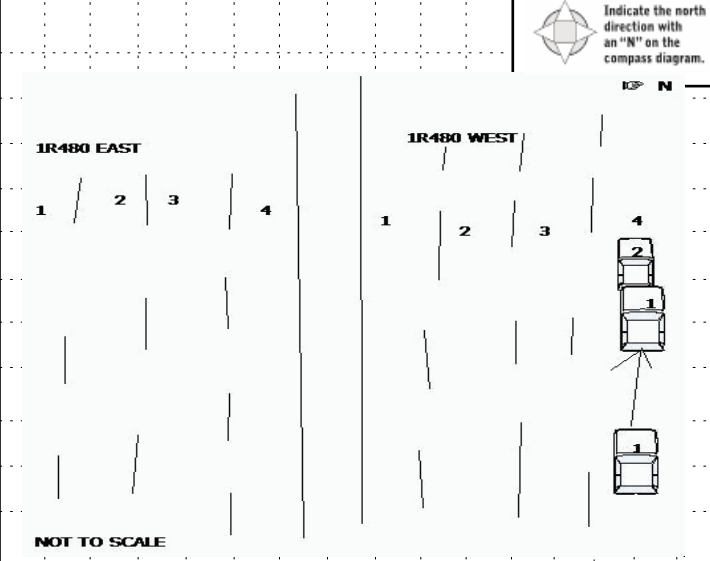

CRASH REPORTED DATE/TIME
1 | 1 | 2 | 2 | 2 | 0 | 2 | 4 | 1 | 1 | 8 | 0 | 6 |

DISPATCH DATE/TIME
1 | 1 | 2 | 2 | 2 | 0 | 2 | 4 | 1 | 1 | 8 | 2 | 9 |

ARRIVAL DATE/TIME
1 | 1 | 2 | 2 | 2 | 0 | 2 | 4 | 1 | 1 | 8 | 2 | 9 |

SCENE CLEARED DATE/TIME
1 | 1 | 2 | 2 | 2 | 0 | 2 | 4 | 1 | 1 | 8 | 4 | 6 |

REPORT TAKEN BY
 POLICE AGENCY
 MOTORIST

TOTAL TIME ROADWAY CLOSED
5 | 0

OTHER INVESTIGATION TIME
1 | 5

TOTAL MINUTES
6 | 5

OFFICER'S NAME *
L. Ajieng

OFFICER'S BADGE NUMBER*
0 | 2 | 7

CHECKED BY OFFICER'S NAME*
T. Baon

CHECKED BY OFFICER'S BADGE NUMBER*
S | 2 | 0

SUPPLEMENT
(CORRECTION = ADDITION)

UNIT # 01 OWNER NAME: LAST, FIRST, MIDDLE (Same As Driver) WILLIAMS AMY L
 OWNER ADDRESS: STREET, CITY, STATE, ZIP (Same As Driver) 4465 BROOKTON ROAD WARRENSVILLE HT OH 44128
 COMMERCIAL CARRIER: NAME, ADDRESS, CITY, STATE, ZIP COMMERCIAL CARRIER PHONE: INCLUDE AREA CODE

LP STATE OH LICENSE PLATE # ELITEHH VEHICLE IDENTIFICATION # 5N1DR3DJ2PC24419Z VEHICLE YEAR 2023 VEHICLE MAKE Nissan
 INSURANCE VERIFIED INSURANCE COMPANY PROGRESSIVE INSURANCE POLICY # 977047735 VEHICLE COLOR GRY VEHICLE MODEL Pathfinder
 TYPE OF USE: COMMERCIAL GOVERNMENT IN EMERGENCY RESPONSE US DOT # _____ TOWED BY: COMPANY NAME _____
 INTERLOCK DEVICE EQUIPPED HIT/SKIP UNIT # OCCUPANTS 01 VEHICLE WEIGHT GVWR/GVWR: 1- <10K LBS. 2- 10,001 - 26K LBS. 3- >26K LBS. HAZARDOUS MATERIAL: MATERIAL RELEASED CLASS # _____ PLACARD ID # _____

UNIT TYPE 01 1- PASSENGER CAR 7- MOTORCYCLE 2-WHEELED 12- GOLF CART 18- LIMO (LIVERY VEHICLE) 23- PEDESTRIAN SKATER
 2- PASSENGER VAN (MINIVAN) 8- MOTORCYCLE 3-WHEELED 13- SNOWMOBILE 19- BUS (16+ PASSENGERS) 24- WHEELCHAIR (ANY TYPE)
 3- SPORT UTILITY VEHICLE 9- AUTOCYCLE 14- SINGLE UNIT TRUCK 20- OTHER VEHICLE 25- OTHER NON-MOTORIST
 4- PICK UP 10- MOPED OR MOTORIZED BICYCLE 15- SEMI-TRACTOR 21- HEAVY EQUIPMENT 26- BICYCLE
 5- CARGO VAN 11- ALL TERRAIN VEHICLE (ATV / UTV) 16- FARM EQUIPMENT 22- ANIMAL WITH RIDER OR ANIMAL-DRAWN VEHICLE 27- TRAIN
 6- VAN (9-15 SEATS) 17- MOTORHOME 99- UNKNOWN OR HIT/SKIP

of TRAILING UNITS _____
 WAS VEHICLE OPERATING IN AUTONOMOUS MODE WHEN CRASH OCCURRED? 2 1- YES 2- NO 9- OTHER / UNKNOWN AUTONOMOUS MODE LEVEL: 0 0- NO AUTOMATION 1- DRIVER ASSISTANCE 2- PARTIAL AUTOMATION 3- CONDITIONAL AUTOMATION 4- HIGH AUTOMATION 5- FULL AUTOMATION 9- UNKNOWN

SPECIAL FUNCTION 01 1- NONE 6- BUS - CHARTER/TOUR 11- FIRE 16- FARM 21- MAIL CARRIER
 2- TAXI 7- BUS - INTERCITY 12- MILITARY 17- MOWING 22- OTHER UNKNOWN
 3- ELECTRONIC RIDE SHARING 8- BUS - SHUTTLE 13- POLICE 18- SNOW REMOVAL 23- OTHER UNKNOWN
 4- SCHOOL TRANSPORT 9- BUS - OTHER 14- PUBLIC UTILITY 19- TOWING
 5- BUS-TRANSIT/COMMUTER 10- AMBULANCE 15- CONSTRUCTION EQUIPMENT 20- SAFETY SERVICE PATROL

CARGO BODY TYPE 01 1- NO CARGO BODY TYPE / NOT APPLICABLE 3- VEHICLE TOWING ANOTHER MOTOR VEHICLE 5- INTERMODAL CONTAINER CHASSIS 8- POLE 12- CONCRETE MIXER
 2- BUS 4- LOGGING 6- CARGO VAN/ENCLOSED BOX 7- GRAIN/CHIPS/GRAVEL 9- CARGO TANK 10- FLAT BED 11- DUMP 13- AUTO TRANSPORTER
 14- GARBAGE/REFUSE 99- OTHER / UNKNOWN

VEHICLE DEFECTS 01 1- TURN SIGNALS 4- BRAKES 7- WORN OR SLICK TIRES 9- MOTOR TROUBLE 99- OTHER / UNKNOWN
 2- HEAD LAMPS 5- STEERING 8- TRAILER EQUIPMENT DEFECTIVE 10- DISABLED FROM PRIOR ACCIDENT
 3- TAIL LAMPS 6- TIRE BLOWOUT

NON-MOTORIST LOCATION AT IMPACT 01 1- INTERSECTION - MARKED CROSSWALK 3- INTERSECTION - OTHER 6- BICYCLE LANE 9- MEDIAN/CROSSING ISLAND 12- FIRST RESPONDER AT INCIDENT SCENE
 2- INTERSECTION - UNMARKED CROSSWALK 4- MIDBLOCK - MARKED CROSSWALK 7- SHOULDER/ROADSIDE 8- SIDEWALK 10- DRIVEWAY ACCESS 11- SHARED USE PATHS OR TRAILS 13- OTHER / UNKNOWN
 5- TRAVEL LANE-OTHER LOCATION

ACTION 3 1- NON-CONTACT 1- STRAIGHT AHEAD 7- MAKING U-TURN 13- NEGOTIATING A CURVE 18- APPROACHING OR LEAVING VEHICLE
 2- NON-COLLISION 2- BACKING 8- ENTERING TRAFFIC LANE 14- ENTERING OR CROSSING SPECIFIED LOCATION 19- STANDING
 3- STRIKING 3- CHANGING LANES 9- LEAVING TRAFFIC LANE 15- WALKING, RUNNING, JOGGING, PLAYING 20- OTHER NON-MOTORIST
 4- STRUCK 4- OVERTAKING/PASSING 10- PARKED 16- WORKING 21- STANDING OUTSIDE DISABLED VEHICLE
 5- BOTH STRIKING & STRUCK 5- MAKING RIGHT TURN 11- SLOWING OR STOPPED IN TRAFFIC 17- PUSHING VEHICLE 99- OTHER / UNKNOWN
 9- OTHER / UNKNOWN 6- MAKING LEFT TURN 12- DRIVERLESS

CONTRIBUTING CIRCUMSTANCES 08 1- NONE 7- LEFT OF CENTER 13- IMPROPER START FROM A PARKED POSITION 17- VISION OBSTRUCTION 21- LYING IN ROADWAY
 2- FAILURE TO YIELD 8- FOLLOWING TOO CLOSE/ACDA 14- STOPPED OR PARKED ILLEGALLY 18- OPERATING DEFECTIVE EQUIPMENT 22- NOT DISCERNABLE
 3- RAN RED LIGHT 9- IMPROPER LANE CHANGING 15- SWERVING TO AVOID 19- LOAD SHIFTING/ FALLING/SPILLING 23- OPENING DOOR INTO ROADWAY
 4- RAN STOP SIGN 10- IMPROPER PASSING 11- DROVE OFF ROAD 20- IMPROPER CROSSING 99- OTHER IMPROPER ACTION
 5- UNSAFE SPEED 12- IMPROPER BACKING 16- WRONG WAY

SEQUENCE OF EVENTS 20 1- OVERTURN/ROLLOVER 6- EQUIPMENT FAILURE 11- CROSS CENTERLINE - OPPOSITE DIRECTION OF TRAVEL 16- RAILWAY VEHICLE 22- WORK ZONE MAINTENANCE EQUIPMENT
 2- FIRE/EXPLOSION 7- SEPARATION OF UNITS 12- DOWNHILL RUNAWAY 17- ANIMAL - FARM 23- STRUCK BY FALLING, SHIFTING CARGO OR ANYTHING SET IN MOTION BY A MOTOR VEHICLE
 3- IMMERSION 8- RAN OFF ROAD RIGHT 13- OTHER NON-COLLISION 18- ANIMAL - DEER 24- OTHER MOVABLE OBJECT
 4- JACKKNIFE 9- RAN OFF ROAD LEFT 14- PEDESTRIAN 19- MOTOR VEHICLE IN TRANSPORT
 5- CARGO / EQUIPMENT LOSS OR SHIFT 10- CROSS MEDIAN 15- PEDALCYCLE 21- PARKED MOTOR VEHICLE

COLLISION WITH FIXED OBJECT - STRUCK 1 25- IMPACT ATTENUATOR / CRASH CUSHION 31- GUARDRAIL END 37- TRAFFIC SIGN POST 43- CURB 50- WORKZONE MAINTENANCE EQUIPMENT
 26- BRIDGE OVERHEAD STRUCTURE 32- PORTABLE BARRIER 38- OVERHEAD SIGN POST 44- DITCH 51- WALL
 27- BRIDGE PIER OR ABUTMENT 33- MEDIAN CABLE BARRIER 39- LIGHT/LUMINARIES SUPPORT 45- EMBANKMENT 52- BUILDING
 28- BRIDGE PARAPET 34- MEDIAN GUARDRAIL BARRIER 40- UTILITY POLE 46- FENCE 53- TUNNEL
 29- BRIDGE RAIL 35- MEDIAN CONCRETE BARRIER 41- OTHER POST, POLE OR SUPPORT 47- MAILBOX 54- OTHER FIXED OBJECT
 30- GUARDRAIL FACE 36- MEDIAN OTHER BARRIER 42- CULVERT 48- TREE 99- OTHER / UNKNOWN
 49- FIRE HYDRANT

FIRST HARMFUL EVENT 1 MOST HARMFUL EVENT 1

LOCAL REPORT NUMBER 20243197

DAMAGE 9 DAMAGE SCALE: 1- NONE 2- MINOR DAMAGE 3- FUNCTIONAL DAMAGE 4- DISABLING DAMAGE 9- UNKNOWN

DAMAGED AREA(S) INDICATE ALL THAT APPLY

- NO DAMAGE [0] - UNDERCARRIAGE [14]
 - TOP [13] - ALL AREAS [15]
 - UNIT NOT AT SCENE [16]

INITIAL POINT OF CONTACT 12 0- NO DAMAGE 14- UNDERCARRIAGE 15- VEHICLE NOT AT SCENE
 1-12- REFER TO UNIT DIAGRAM 99- UNKNOWN
 13- TOP

TRAFFIC TRAFFICWAY FLOW 1 1- ONE-WAY 2- TWO-WAY TRAFFIC CONTROL 6 1- ROUNDABOUT 4- STOP SIGN 2- SIGNAL 5- YIELD SIGN 3- FLASHER 6- NO CONTROL

OF THROUGH LANES ON ROAD 4 RAIL GRADE CROSSING 1 1- NOT INVOLVED 2- INVOLVED - ACTIVE CROSSING 3- INVOLVED - PASSIVE CROSSING

UNIT / NON-MOTORIST DIRECTION FROM 3 TO 4 1- NORTH 5- NORTHEAST 2- SOUTH 6- NORTHWEST 3- EAST 7- SOUTHEAST 4- WEST 8- SOUTHWEST 9- OTHER / UNKNOWN

UNIT SPEED 55 POSTED SPEED 60 DETECTED SPEED 1 1- STATED/ESTIMATED SPEED 2- CALCULATED / EDR 3- UNDETERMINED

OWNER

UNIT # 02 OWNER NAME: LAST, FIRST, MIDDLE () Same As Driver
JOHNSON SHERRIE JOAN

OWNER PHONE: INCLUDE AREA CODE () Same As Driver

OWNER ADDRESS: STREET, CITY, STATE, ZIP () Same As Driver
11409 DARLINGTON AVE GARFIELD HTS OH 44125

COMMERCIAL CARRIER: NAME, ADDRESS, CITY, STATE, ZIP
COMMERCIAL CARRIER PHONE: INCLUDE AREA CODE

DAMAGE

DAMAGE SCALE

1 - NONE
2 - MINOR DAMAGE
3 - FUNCTIONAL DAMAGE
4 - DISABLING DAMAGE
9 - UNKNOWN

2

VEHICLE

LP STATE OH LICENSE PLATE # JAJ5430 VEHICLE IDENTIFICATION # K1L4C1JASB4HB026786 VEHICLE YEAR 2017 VEHICLE MAKE Buick

INSURANCE VERIFIED INSURANCE COMPANY STATE FARM INSURANCE POLICY # 2480969-SFP-35 VEHICLE COLOR WHI VEHICLE MODEL Encore

TYPE OF USE: COMMERCIAL GOVERNMENT IN EMERGENCY RESPONSE

INTERLOCK DEVICE EQUIPPED HIT/SKIP UNIT # OCCUPANTS 02

US DOT # _____ TOWED BY: COMPANY NAME _____

VEHICLE WEIGHT GVWR/GVWR: 1- <10K LBS. 2- 10,001 - 26K LBS. 3- >26K LBS.

HAZARDOUS MATERIAL: MATERIAL RELEASED CLASS # _____ PLACARD ID # _____ PLACARD

DAMAGED AREA(S)
INDICATE ALL THAT APPLY

- NO DAMAGE [0] - UNDERCARRIAGE [14]
 - TOP [13] - ALL AREAS [15]
 - UNIT NOT AT SCENE [16]

UNIT TYPE: 01

1 - PASSENGER CAR 2 - PASSENGER VAN (MINIVAN) 3 - SPORT UTILITY VEHICLE 4 - PICK UP 5 - CARGO VAN 6 - VAN (9-15 SEATS) 7 - MOTORCYCLE 2-WHEELED 8 - MOTORCYCLE 3-WHEELED 9 - AUTOCYCLE 10 - MOPED OR MOTORIZED BICYCLE 11 - ALL TERRAIN VEHICLE (ATV / UTV) 12 - GOLF CART 13 - SNOWMOBILE 14 - SINGLE UNIT TRUCK 15 - SEMI-TRACTOR 16 - FARM EQUIPMENT 17 - MOTORHOME 18 - LIMO (LIVERY VEHICLE) 19 - BUS (16+ PASSENGERS) 20 - OTHER VEHICLE 21 - HEAVY EQUIPMENT 22 - ANIMAL WITH RIDER OR ANIMAL-DRAWN VEHICLE 23 - PEDESTRIAN SKATER 24 - WHEELCHAIR (ANY TYPE) 25 - OTHER NON-MOTORIST 26 - BICYCLE 27 - TRAIN 99 - UNKNOWN OR HIT/SKIP

of TRAILING UNITS _____

WAS VEHICLE OPERATING IN AUTONOMOUS MODE WHEN CRASH OCCURRED? 2

1 - YES 2 - NO 9 - OTHER / UNKNOWN

AUTONOMOUS MODE LEVEL: 0

0 - NO AUTOMATION 1 - DRIVER ASSISTANCE 2 - PARTIAL AUTOMATION 3 - CONDITIONAL AUTOMATION 4 - HIGH AUTOMATION 5 - FULL AUTOMATION 9 - UNKNOWN

SPECIAL FUNCTION 01

1 - NONE 2 - TAXI 3 - ELECTRONIC RIDE SHARING 4 - SCHOOL TRANSPORT 5 - BUS-TRANSIT/COMMUTER 6 - BUS - CHARTER/TOUR 7 - BUS - INTERCITY 8 - BUS - SHUTTLE 9 - BUS - OTHER 10 - AMBULANCE 11 - FIRE 12 - MILITARY 13 - POLICE 14 - PUBLIC UTILITY 15 - CONSTRUCTION EQUIPMENT 16 - FARM 17 - MOWING 18 - SNOW REMOVAL 19 - TOWING 20 - SAFETY SERVICE PATROL 21 - MAIL CARRIER 99 - OTHER UNKNOWN

CARGO BODY TYPE 01

1 - NO CARGO BODY TYPE / NOT APPLICABLE 2 - BUS 3 - VEHICLE TOWING ANOTHER MOTOR VEHICLE 4 - LOGGING 5 - INTERMODAL CONTAINER CHASSIS 6 - CARGO VAN/ENCLOSED BOX 7 - GRAIN/CHIPS/GRAVEL 8 - POLE 9 - CARGO TANK 10 - FLAT BED 11 - DUMP 12 - CONCRETE MIXER 13 - AUTO TRANSPORTER 14 - GARBAGE/REFUSE 99 - OTHER / UNKNOWN

VEHICLE DEFECTS

1 - TURN SIGNALS 2 - HEAD LAMPS 3 - TAIL LAMPS 4 - BRAKES 5 - STEERING 6 - TIRE BLOWOUT 7 - WORN OR SLICK TIRES 8 - TRAILER EQUIPMENT DEFECTIVE 9 - MOTOR TROUBLE 10 - DISABLED FROM PRIOR ACCIDENT 99 - OTHER / UNKNOWN

NON-MOTORIST LOCATION AT IMPACT 01

1 - INTERSECTION - MARKED CROSSWALK 2 - INTERSECTION - UNMARKED CROSSWALK 3 - INTERSECTION - OTHER 4 - MIDBLOCK - MARKED CROSSWALK 5 - TRAVEL LANE-OTHER LOCATION 6 - BICYCLE LANE 7 - SHOULDER/ROADSIDE 8 - SIDEWALK 9 - MEDIAN/CROSSING ISLAND 10 - DRIVEWAY ACCESS 11 - SHARED USE PATHS OR TRAILS 12 - FIRST RESPONDER AT INCIDENT SCENE 99 - OTHER / UNKNOWN

ACTION 4

1 - NON-CONTACT 2 - NON-COLLISION 3 - STRIKING 4 - STRUCK 5 - BOTH STRIKING & STRUCK 9 - OTHER / UNKNOWN 1 - STRAIGHT AHEAD 2 - BACKING 3 - CHANGING LANES 4 - OVERTAKING/PASSING 5 - MAKING RIGHT TURN 6 - MAKING LEFT TURN 7 - MAKING U-TURN 8 - ENTERING TRAFFIC LANE 9 - LEAVING TRAFFIC LANE 10 - PARKED 11 - SLOWING OR STOPPED IN TRAFFIC 12 - DRIVERLESS 13 - NEGOTIATING A CURVE 14 - ENTERING OR CROSSING SPECIFIED LOCATION 15 - WALKING, RUNNING, JOGGING, PLAYING 16 - WORKING 17 - PUSHING VEHICLE 18 - APPROACHING OR LEAVING VEHICLE 19 - STANDING 20 - OTHER NON-MOTORIST 21 - STANDING OUTSIDE DISABLED VEHICLE 99 - OTHER / UNKNOWN

INITIAL POINT OF CONTACT 06

0 - NO DAMAGE 1-12 - REFER TO UNIT DIAGRAM 13 - TOP 14 - UNDERCARRIAGE 15 - VEHICLE NOT AT SCENE 99 - UNKNOWN

CONTRIBUTING CIRCUMSTANCES 01

1 - NONE 2 - FAILURE TO YIELD 3 - RAN RED LIGHT 4 - RAN STOP SIGN 5 - UNSAFE SPEED 6 - IMPROPER TURN 7 - LEFT OF CENTER 8 - FOLLOWING TOO CLOSE/ACDA 9 - IMPROPER LANE CHANGING 10 - IMPROPER PASSING 11 - DROVE OFF ROAD 12 - IMPROPER BACKING 13 - IMPROPER START FROM A PARKED POSITION 14 - STOPPED OR PARKED ILLEGALLY 15 - SWERVING TO AVOID 16 - WRONG WAY 17 - VISION OBSTRUCTION 18 - OPERATING DEFECTIVE EQUIPMENT 19 - LOAD SHIFTING/ FALLING/SPILLING 20 - IMPROPER CROSSING 21 - LYING IN ROADWAY 22 - NOT DISCERNABLE 23 - OPENING DOOR INTO ROADWAY 99 - OTHER IMPROPER ACTION

TRAFFIC

TRAFFICWAY FLOW 1

1 - ONE-WAY 2 - TWO-WAY

TRAFFIC CONTROL 6

1 - ROUNDABOUT 2 - SIGNAL 3 - FLASHER 4 - STOP SIGN 5 - YIELD SIGN 6 - NO CONTROL

OF THROUGH LANES ON ROAD 4

RAIL GRADE CROSSING 1

1 - NOT INVOLVED 2 - INVOLVED - ACTIVE CROSSING 3 - INVOLVED - PASSIVE CROSSING

EVENT(S)

SEQUENCE OF EVENTS

1 20

1 - OVERTURN/ROLLOVER 2 - FIRE/EXPLOSION 3 - IMMERSION 4 - JACKKNIFE 5 - CARGO / EQUIPMENT LOSS OR SHIFT 6 - EQUIPMENT FAILURE 7 - SEPARATION OF UNITS 8 - RAN OFF ROAD RIGHT 9 - RAN OFF ROAD LEFT 10 - CROSS MEDIAN 11 - CROSS CENTERLINE - OPPOSITE DIRECTION OF TRAVEL 12 - DOWNHILL RUNAWAY 13 - OTHER NON-COLLISION 14 - PEDESTRIAN 15 - PEDALCYCLE 16 - RAILWAY VEHICLE 17 - ANIMAL - FARM 18 - ANIMAL - DEER 19 - ANIMAL - OTHER 20 - MOTOR VEHICLE IN TRANSPORT 21 - PARKED MOTOR VEHICLE 22 - WORK ZONE MAINTENANCE EQUIPMENT 23 - STRUCK BY FALLING, SHIFTING CARGO OR ANYTHING SET IN MOTION BY A MOTOR VEHICLE 24 - OTHER MOVABLE OBJECT

COLLISION WITH FIXED OBJECT - STRUCK

25 - IMPACT ATTENUATOR / CRASH CUSHION 26 - BRIDGE OVERHEAD STRUCTURE 27 - BRIDGE PIER OR ABUTMENT 28 - BRIDGE PARAPET 29 - BRIDGE RAIL 30 - GUARDRAIL FACE 31 - GUARDRAIL END 32 - PORTABLE BARRIER 33 - MEDIAN CABLE BARRIER 34 - MEDIAN GUARDRAIL BARRIER 35 - MEDIAN CONCRETE BARRIER 36 - MEDIAN OTHER BARRIER 37 - TRAFFIC SIGN POST 38 - OVERHEAD SIGN POST 39 - LIGHT/LUMINARIES SUPPORT 40 - UTILITY POLE 41 - OTHER POST, POLE OR SUPPORT 42 - CULVERT 43 - CURB 44 - DITCH 45 - EMBANKMENT 46 - FENCE 47 - MAILBOX 48 - TREE 49 - FIRE HYDRANT 50 - WORKZONE MAINTENANCE EQUIPMENT 51 - WALL 52 - BUILDING 53 - TUNNEL 54 - OTHER FIXED OBJECT 99 - OTHER / UNKNOWN

FIRST HARMFUL EVENT 1 **MOST HARMFUL EVENT** 1

UNIT / NON-MOTORIST DIRECTION

FROM 3 TO 4

1 - NORTH 2 - SOUTH 3 - EAST 4 - WEST 5 - NORTHEAST 6 - NORTHWEST 7 - SOUTHEAST 8 - SOUTHWEST 9 - OTHER / UNKNOWN

UNIT SPEED 0

POSTED SPEED 0

DETECTED SPEED

1 - STATED/ESTIMATED SPEED 2 - CALCULATED / EDR 3 - UNDETERMINED

MOTORIST / NON-MOTORIST

LOCAL REPORT NUMBER
2 0 2 4 3 1 9 7

UNIT # 0 1	NAME: LAST, FIRST, MIDDLE WILLIAMS AMY L		DATE OF BIRTH 1 2 1 9 1 9 7 0		AGE 5 3	GENDER F			
ADDRESS: STREET, CITY, STATE, ZIP 4465 BROOKTON ROAD WARRENSVILLE H' OH 44128				CONTACT PHONE - INCLUDE AREA CODE					
INJURIES 5	INJURED TAKEN BY	EMS AGENCY (NAME)	INJURED TAKEN TO: MEDICAL FACILITY (NAME, CITY)	SAFETY EQUIPMENT USED 0 4	<input type="checkbox"/> DOT-COMPLIANT MC HELMET	SEATING POSITION 0 1	AIR BAG USAGE 1	EJECTION 1	TRAPPED 1
OL STATE	OPERATOR LICENSE NUMBER	OFFENSE CHARGED	LOCAL CODE <input type="checkbox"/>	OFFENSE DESCRIPTION		CITATION NUMBER			
OL CLASS 4	ENDORSEMENT SELECT UP TO 2	RESTRICTION SELECT UP TO 3	DRIVER DISTRACTED BY 1	ALCOHOL / DRUG SUSPECTED <input type="checkbox"/> ALCOHOL <input type="checkbox"/> MARIJUANA <input type="checkbox"/> OTHER DRUG		CONDITION 1	ALCOHOL TEST STATUS TYPE VALUE STATUS TYPE RESULT SELECT UP TO 4		DRUG TEST(S)

UNIT # 0 2	NAME: LAST, FIRST, MIDDLE JOHNSON RICHARD		DATE OF BIRTH 0 7 0 4 1 9 6 3		AGE 6 1	GENDER M			
ADDRESS: STREET, CITY, STATE, ZIP 11409 DARLINGTON AVE GARFIELD HEIGHT OH 44125				CONTACT PHONE - INCLUDE AREA CODE					
INJURIES 5	INJURED TAKEN BY	EMS AGENCY (NAME)	INJURED TAKEN TO: MEDICAL FACILITY (NAME, CITY)	SAFETY EQUIPMENT USED 0 4	<input type="checkbox"/> DOT-COMPLIANT MC HELMET	SEATING POSITION 0 1	AIR BAG USAGE 1	EJECTION 1	TRAPPED 1
OL STATE	OPERATOR LICENSE NUMBER	OFFENSE CHARGED	LOCAL CODE <input type="checkbox"/>	OFFENSE DESCRIPTION		CITATION NUMBER			
OL CLASS 4	ENDORSEMENT SELECT UP TO 2	RESTRICTION SELECT UP TO 3	DRIVER DISTRACTED BY 1	ALCOHOL / DRUG SUSPECTED <input type="checkbox"/> ALCOHOL <input type="checkbox"/> MARIJUANA <input type="checkbox"/> OTHER DRUG		CONDITION 1	ALCOHOL TEST STATUS TYPE VALUE STATUS TYPE RESULT SELECT UP TO 4		DRUG TEST(S)

UNIT #	NAME: LAST, FIRST, MIDDLE		DATE OF BIRTH		AGE	GENDER			
ADDRESS: STREET, CITY, STATE, ZIP				CONTACT PHONE - INCLUDE AREA CODE					
INJURIES	INJURED TAKEN BY	EMS AGENCY (NAME)	INJURED TAKEN TO: MEDICAL FACILITY (NAME, CITY)	SAFETY EQUIPMENT USED	<input type="checkbox"/> DOT-COMPLIANT MC HELMET	SEATING POSITION	AIR BAG USAGE	EJECTION	TRAPPED
OL STATE	OPERATOR LICENSE NUMBER	OFFENSE CHARGED	LOCAL CODE	OFFENSE DESCRIPTION		CITATION NUMBER			
OL CLASS	ENDORSEMENT SELECT UP TO 2	RESTRICTION SELECT UP TO 3	DRIVER DISTRACTED BY	ALCOHOL / DRUG SUSPECTED		CONDITION	ALCOHOL TEST		DRUG TEST(S)

INJURIES	SEATING POSITION	AIR BAG	OL CLASS	OL RESTRICTION(S)	DRIVER DISTRACTION	TEST STATUS
1 - FATAL	1 - FRONT - LEFT SIDE (MOTORCYCLE DRIVER)	1 - NOT DEPLOYED	1 - CLASS A	1 - ALCOHOL INTERLOCK DEVICE	1 - NOT DISTRACTED	1 - NONE GIVEN
2 - SUSPECTED SERIOUS INJURY	2 - FRONT - MIDDLE	2 - DEPLOYED FRONT	2 - CLASS B	2 - CDL INTRASTATE ONLY	2 - MANUALLY OPERATING AN ELECTRONIC COMMUNICATION DEVICE (TEXTING, TYPING, DIALING)	2 - TEST REFUSED
3 - SUSPECTED MINOR INJURY	3 - FRONT - RIGHT SIDE	3 - DEPLOYED SIDE	3 - CLASS C	3 - CORRECTIVE LENSES	3 - TALKING ON HANDS-FREE COMMUNICATION DEVICE	3 - TEST GIVEN, CONTAMINATED SAMPLE / UNUSABLE
4 - POSSIBLE INJURY	4 - SECOND - LEFT SIDE (MOTORCYCLE PASSENGER)	4 - DEPLOYED BOTH FRONT / SIDE	4 - REGULAR CLASS (OHIO = D)	4 - FARM WAIVER	4 - TALKING ON HAND-HELD COMMUNICATION DEVICE	4 - TEST GIVEN, RESULTS KNOWN
5 - NO APPARENT INJURY	5 - SECOND - MIDDLE	5 - NOT APPLICABLE	5 - M / C MOPED ONLY	5 - EXCEPT CLASS A BUS & CLASS B BUS	5 - OTHER ACTIVITY WITH AN ELECTRONIC DEVICE	5 - TEST GIVEN, RESULTS UNKNOWN
INJURED TAKEN BY		6 - SECOND - RIGHT SIDE	6 - NO VALID OL	6 - EXCEPT CLASS A & CLASS B BUS	6 - PASSENGER	ALCOHOL TEST TYPE
1 - NOT TRANSPORTED / TREATED AT SCENE	7 - THIRD - LEFT SIDE (MOTORCYCLE SIDE CAR)	9 - DEPLOYMENT UNKNOWN		7 - EXCEPT TRACTOR-TRAILER RESTRICTIONS	7 - OTHER DISTRACTION INSIDE THE VEHICLE	1 - NONE
2 - EMS	8 - THIRD - MIDDLE	EJECTION	OL ENDORSEMENT	8 - INTERMEDIATE LICENSE RESTRICTIONS	8 - OTHER DISTRACTIONS OUTSIDE THE VEHICLE	2 - BLOOD
3 - POLICE	9 - THIRD - RIGHT SIDE	1 - NOT EJECTED	H - HAZMAT	9 - LEARNER'S PERMIT RESTRICTIONS	9 - OTHER / UNKNOWN	3 - URINE
9 - OTHER / UNKNOWN	10 - SLEEPER SECTION OF TRUCK CAB	2 - PARTIALLY EJECTED	M - MOTORCYCLE	10 - LIMITED TO DAYLIGHT ONLY		4 - BREATH
SAFETY EQUIPMENT		3 - TOTALLY EJECTED	P - PASSENGER	11 - LIMITED TO EMPLOYMENT		5 - OTHER
1 - NONE USED	12 - PASSENGER IN UNENCLOSED CARGO AREA	4 - NOT APPLICABLE	N - TANKER	12 - LIMITED - OTHER		DRUG TEST TYPE
2 - SHOULDER BELT ONLY USED	13 - TRAILING UNIT	TRAPPED	Q - MOTOR SCOOTER	13 - MECHANICAL DEVICES (SPECIAL BRAKES, HAND CONTROLS, OR OTHER ADAPTIVE DEVICES)	CONDITION	1 - NONE
3 - LAP BELT ONLY USED	14 - RIDING ON VEHICLE EXTERIOR (NON-TRAILING UNIT)	1 - NOT TRAPPED	R - THREE-WHEEL MOTORCYCLE	14 - MILITARY VEHICLES ONLY	1 - APPARENTLY NORMAL	2 - BLOOD
4 - SHOULDER & LAP BELT USED	15 - NON-MOTORIST	2 - EXTRICATED BY MECHANICAL MEANS	S - SCHOOL BUS	15 - MOTOR VEHICLES WITHOUT AIR BRAKES	2 - PHYSICAL IMPAIRMENT	3 - URINE
5 - CHILD RESTRAINT SYSTEM - FORWARD FACING	99 - OTHER / UNKNOWN	3 - FREED BY NON-MECHANICAL MEANS	T - DOUBLE & TRIPLE TRAILERS	16 - OUTSIDE MIRROR	3 - EMOTIONAL (E.G. DEPRESSED, ANGRY, DISTURBED)	4 - OTHER
6 - CHILD RESTRAINT SYSTEM - REAR FACING			X - TANKER / HAZMAT	17 - PROSTHETIC AID	4 - ILLNESS	DRUG TEST RESULT(S)
7 - BOOSTER SEAT				18 - OTHER	5 - FELL ASLEEP, FAINTED, FATIGUED, ETC.	1 - AMPHETAMINES
8 - HELMET USED			GENDER		6 - UNDER THE INFLUENCE OF MEDICATIONS / DRUGS / ALCOHOL	2 - BARBITURATES
9 - PROTECTIVE PADS USED (ELBOWS, KNEES, ETC.)			F - FEMALE		9 - OTHER / UNKNOWN	3 - BENZODIAZEPINES
10 - REFLECTIVE CLOTHING			M - MALE			4 - CANNABINOIDS
11 - LIGHTING - PEDESTRIAN / BICYCLE ONLY			U - OTHER/UNKNOWN			5 - COCAINE
99 - OTHER / UNKNOWN						6 - OPIATES / OPIOIDS
						7 - OTHER
						8 - NEGATIVE RESULTS

OCCUPANT / WITNESS ADDENDUM

LOCAL REPORT NUMBER
2 0 2 4 3 1 9 7

OCCUPANT	UNIT # 2	NAME: LAST, FIRST, MIDDLE JOHNSON SHERRIE JOAN			DATE OF BIRTH 1 1 2 1 1 9 6 6			AGE 5 8	GENDER F
	ADDRESS: STREET, CITY, STATE, ZIP 11409 DARLINGTON AVE GARFIELD HTS OH 44125				CONTACT PHONE - INCLUDE AREA CODE				
	INJURIES 5	INJURED TAKEN BY	EMS AGENCY (NAME)	INJURED TAKEN TO: MEDICAL FACILITY (NAME, CITY)	SAFETY EQUIPMENT USED 0 4	<input type="checkbox"/> DOT-COMPLIANT MC HELMET	SEATING POSITION 0 3	AIR BAG USAGE 1	EJECTION 1

OCCUPANT	UNIT #	NAME: LAST, FIRST, MIDDLE			DATE OF BIRTH			AGE	GENDER
	ADDRESS: STREET, CITY, STATE, ZIP				CONTACT PHONE - INCLUDE AREA CODE				
	INJURIES	INJURED TAKEN BY	EMS AGENCY (NAME)	INJURED TAKEN TO: MEDICAL FACILITY (NAME, CITY)	SAFETY EQUIPMENT USED	<input type="checkbox"/> DOT-COMPLIANT MC HELMET	SEATING POSITION	AIR BAG USAGE	EJECTION

OCCUPANT	UNIT #	NAME: LAST, FIRST, MIDDLE			DATE OF BIRTH			AGE	GENDER
	ADDRESS: STREET, CITY, STATE, ZIP				CONTACT PHONE - INCLUDE AREA CODE				
	INJURIES	INJURED TAKEN BY	EMS AGENCY (NAME)	INJURED TAKEN TO: MEDICAL FACILITY (NAME, CITY)	SAFETY EQUIPMENT USED	<input type="checkbox"/> DOT-COMPLIANT MC HELMET	SEATING POSITION	AIR BAG USAGE	EJECTION

OCCUPANT	UNIT #	NAME: LAST, FIRST, MIDDLE			DATE OF BIRTH			AGE	GENDER
	ADDRESS: STREET, CITY, STATE, ZIP				CONTACT PHONE - INCLUDE AREA CODE				
	INJURIES	INJURED TAKEN BY	EMS AGENCY (NAME)	INJURED TAKEN TO: MEDICAL FACILITY (NAME, CITY)	SAFETY EQUIPMENT USED	<input type="checkbox"/> DOT-COMPLIANT MC HELMET	SEATING POSITION	AIR BAG USAGE	EJECTION

INJURIES 1 - FATAL 2 - SUSPECTED SERIOUS INJURY 3 - SUSPECTED MINOR INJURY 4 - POSSIBLE INJURY 5 - NO APPARENT INJURY	SAFETY EQUIPMENT USED 1 - NONE USED - VEHICLE OCCUPANT 2 - SHOULDER BELT ONLY USED 3 - LAP BELT ONLY USED 4 - SHOULDER & LAP BELT USED 5 - CHILD RESTRAINT SYSTEM - FORWARD FACING 6 - CHILD RESTRAINT SYSTEM - REAR FACING 7 - BOOSTER SEAT 8 - HELMET USED 9 - PROTECTIVE PADS USED (ELBOWS, KNEES, ETC.) 10 - REFLECTIVE CLOTHING 11 - LIGHTING - PEDESTRIAN / BICYCLE ONLY 99 - OTHER / UNKNOWN	SEATING POSITION 1 - FRONT - LEFT SIDE (MOTORCYCLE DRIVER) 2 - FRONT - MIDDLE 3 - FRONT - RIGHT SIDE 4 - SECOND - LEFT SIDE (MOTORCYCLE PASSENGER) 5 - SECOND - MIDDLE 6 - SECOND - RIGHT SIDE 7 - THIRD - LEFT SIDE (MOTORCYCLE SIDE CAR) 8 - THIRD - MIDDLE 9 - THIRD - RIGHT SIDE 10 - SLEEPER SECTION OF TRUCK CAB 11 - PASSENGER IN OTHER ENCLOSED CARGO AREA (NON-TRAILING UNIT, BUS, PICK-UP WITH CAP) 12 - PASSENGER IN UNENCLOSED CARGO AREA 13 - TRAILING UNIT 14 - RIDING ON VEHICLE EXTERIOR (NON-TRAILING UNIT) 15 - NON-MOTORIST 99 - OTHER / UNKNOWN	AIR BAG USAGE 1 - NOT DEPLOYED 2 - DEPLOYED FRONT 3 - DEPLOYED SIDE 4 - DEPLOYED BOTH FRONT/SIDE 5 - NOT APPLICABLE 9 - DEPLOYMENT UNKNOWN
INJURED TAKEN BY 1 - NOT TRANSPORTED / TREATED AT SCENE 2 - EMS 3 - POLICE 9 - OTHER / UNKNOWN		EJECTION 1 - NOT EJECTED 2 - PARTIALLY EJECTED 3 - TOTALLY EJECTED 4 - NOT APPLICABLE	
GENDER F - FEMALE M - MALE U - OTHER/UNKNOWN		TRAPPED 1 - NOT TRAPPED 2 - EXTRICATED BY MECHANICAL MEANS 3 - FREED BY NON-MECHANICAL MEANS	

WITNESS	NAME: LAST, FIRST, MIDDLE	DATE OF BIRTH	AGE	GENDER
	ADDRESS: STREET, CITY, STATE, ZIP	CONTACT PHONE - INCLUDE AREA CODE		

WITNESS	NAME: LAST, FIRST, MIDDLE	DATE OF BIRTH	AGE	GENDER
	ADDRESS: STREET, CITY, STATE, ZIP	CONTACT PHONE - INCLUDE AREA CODE		

WITNESS	NAME: LAST, FIRST, MIDDLE	DATE OF BIRTH	AGE	GENDER
	ADDRESS: STREET, CITY, STATE, ZIP	CONTACT PHONE - INCLUDE AREA CODE		

OHIO TRAFFIC CRASH REPORT DIAGRAM / NARRATIVE CONTINUATION

LOCAL REPORT NUMBER 20243197	REPORTING AGENCY GARFIELD HEIGHTS	DATE OF CRASH M 11 D 22 Y 2024
IN COUNTY OF 18	CRASH LOCATION IR 480	
<p>AFTER SPEAKING WITH UNIT 1'S DRIVER, SHE ADMITTED BEING IN THE AREA OF THE ACCIDENT BUT DENIED TO HAVE STRUCK UNIT 2.</p>		
OFFICER'S SIGNATURE X		BADGE NUMBER 027