

# TRAFFIC CRASH REPORT

\*DENOTES MANDATORY FIELD FOR SUPPLEMENT REPORT

LOCAL REPORT NUMBER \*

2 | 0 | 2 | 4 | 2 | 9 | 7 | 9

- PHOTOS TAKEN     OH-2     OH-3  
 SECONDARY CRASH     OH-1P     OTHER  
 Private Property

LOCAL INFORMATION

GRANGER HILL

REPORTING AGENCY NAME \*

GARFIELD HEIGHTS

NCIC \*  
0 | 1 | 8 | 2 | 0

HITSKIP  
1 - Solved  
2 - Unsolved

NUMBER OF UNITS  
0 | 1

INITIALS EDDP  
98 - ANIMAL  
99 - UNKNOWN  
0 | 1

COUNTY \*  
1 | 8

LOCALITY \*  
1

LOCATION: CITY, VILLAGE, TOWNSHIP \*  
GARFIELD HTS

CRASH DATE/TIME \*  
1 | 0 | 2 | 8 | 2 | 0 | 2 | 4 | 2 | 2 | 4 | 2

CRASH SEVERITY  
3

1 - FATAL  
2 - SERIOUS INJURY SUSPECTED  
3 - MINOR INJURY SUSPECTED  
4 - INJURY POSSIBLE  
5 - PROPERTY DAMAGE ONLY

ROUTE TYPE  
ROUTE NUMBER  
PREFIX  
1 - NORTH  
2 - SOUTH  
3 - EAST  
4 - WEST

LOCATION ROAD NAME  
EAST 96TH

ROAD TYPE  
S | T  
LATITUDE DECIMAL DEGREES  
4 | 1 | 4 | 1 | 6 | 9 | 6 | 6

ROUTE TYPE  
ROUTE NUMBER  
PREFIX  
1 - NORTH  
2 - SOUTH  
3 - EAST  
4 - WEST

REFERENCE ROAD NAME (ROAD, MILEPOST, HOUSE #)  
GRANGER

ROAD TYPE  
R | D  
LONGITUDE DECIMAL DEGREES  
8 | 1 | 6 | 1 | 5 | 6 | 4 | 9

REFERENCE POINT  
1 - INTERSECTION  
2 - MILE POST  
3 - HOUSE #  
1

DIRECTION  
1 - NORTH  
2 - SOUTH  
3 - EAST  
4 - WEST  
3

ROUTE TYPE  
IR - INTERSTATE ROUTE (TP)  
US - FEDERAL US ROUTE  
SR - STATE ROUTE  
CR - NUMBERED COUNTY ROUTE  
TR - NUMBERED TOWNSHIP ROUTE

ROAD TYPE  
AL - ALLEY  
AV - AVENUE  
BL - BOULEVARD  
CR - CIRCLE  
CT - COURT  
DR - DRIVE  
HE - HEIGHTS

HW - HIGHWAY  
LA - LANE  
MP - MILEPOST  
OV - OVAL  
PK - PARKWAY  
PI - PIKE  
PL - PLACE

RD - ROAD  
SQ - SQUARE  
ST - STREET  
TE - TERRACE  
TL - TRAIL  
WA - WAY

INTERSECTION RELATED  
 WITHIN INTERSECTION OR ON APPROACH  
 WITHIN INTERCHANGE AREA  
NUMBER OF APPROACHES

DISTANCE  
1 - Miles  
2 - Feet  
3 - Yards  
1 | 0 | 0

DISTANCE  
1 - Miles  
2 - Feet  
3 - Yards  
2

ROADWAY  
 ROADWAY DIVIDED

LOCATION OF CRASH COLLISION/IMPACT EVENT  
1 - ON ROADWAY  
2 - ON SHOULDER  
3 - IN MEDIAN  
4 - ON ROADSIDE  
5 - ON GORE  
6 - OUTSIDE TRAFFICWAY  
7 - ON RAMP  
8 - OFF RAMP

9 - CROSSOVER  
10 - DRIVEWAY / ALLEY ACCESS  
11 - RAILWAY GRADE CROSSING  
12 - SHARED USE PATHS OR TRAILS  
13 - BIKE LANE  
14 - TOLL BOOTH  
99 - OTHER / UNKNOWN

MANNER OF CRASH COLLISION/IMPACT  
1 - NOT COLLISION BETWEEN TWO MOTOR VEHICLES IN TRANSPORT  
2 - REAR-END  
3 - HEAD-ON  
4 - REAR-TO-REAR  
5 - BACKING  
6 - ANGLE  
7 - SIDESWIPE, SAME DIRECTION  
8 - SIDESWIPE, OPPOSITE DIRECTION  
9 - OTHER / UNKNOWN

DIRECTION OF TRAVEL  
1 - NORTH  
2 - SOUTH  
3 - EAST  
4 - WEST

MEDIAN TYPE  
1 - DIVIDED FLUSH MEDIAN (<4 FEET)  
2 - DIVIDED FLUSH MEDIAN (24 FEET)  
3 - DIVIDED, DEPRESSED MEDIAN  
4 - DIVIDED, RAISED MEDIAN (ANY TYPE)  
9 - OTHER / UNKNOWN

WORK ZONE RELATED  
 WORKERS PRESENT  
 LAW ENFORCEMENT PRESENT  
 ACTIVE SCHOOL ZONE

WORK ZONE TYPE  
1 - LANE CLOSURE  
2 - LANE SHIFT/CROSSOVER  
3 - WORK ON SHOULDER  
OR MEDIAN  
4 - INTERMITTENT OR MOVING WORK  
5 - OTHER

LOCATION OF CRASH IN WORK ZONE  
1 - BEFORE THE 1ST WORK ZONE WARNING SIGN  
2 - ADVANCE WARNING AREA  
3 - TRANSITION AREA  
4 - ACTIVITY AREA  
5 - TERMINATION AREA

CONTOUR  
1

1 - STRAIGHT LEVEL  
2 - STRAIGHT GRADE  
3 - CURVE LEVEL  
4 - CURVE GRADE  
9 - OTHER / UNKNOWN

CONDITIONS  
1

1 - DRY  
2 - WET  
3 - SNOW  
4 - ICE  
5 - SAND, MUD, DIRT, OIL, GRAVEL  
6 - WATER (STANDING, MOVING)  
7 - SLUSH  
9 - OTHER/UNKNOWN

SURFACE  
2

1 - CONCRETE  
2 - BLACKTOP, BITUMINOUS, ASPHALT  
3 - BRICK/BLOCK  
4 - SLAG, GRAVEL, STONE  
5 - DIRT  
9 - OTHER / UNKNOWN

LIGHT CONDITION  
3

1 - DAYLIGHT  
2 - DAWN/DUSK  
3 - DARK - LIGHTED ROADWAY  
4 - DARK - ROADWAY NOT LIGHTED  
5 - DARK - UNKNOWN ROADWAY LIGHTING  
9 - OTHER / UNKNOWN

WEATHER  
1

1 - CLEAR  
2 - CLOUDY  
3 - FOG, SMOG, SMOKE  
4 - RAIN  
5 - SLEET, HAIL  
6 - SNOW  
7 - SEVERE CROSSWINDS  
8 - BLOWING SAND, SOIL, DIRT, SNOW  
9 - FREEZING RAIN OR FREEZING DRIZZLE  
99 - OTHER / UNKNOWN

NARRATIVE  
UNIT 1 WAS TRAVELING W/B ON GRANGER HILL WHEN A MECHANICAL ISSUES OCCURRED. UNIT 1 STRUCK A CURB LOST CONTROL AND ENDED UP ON ITS SIDE.

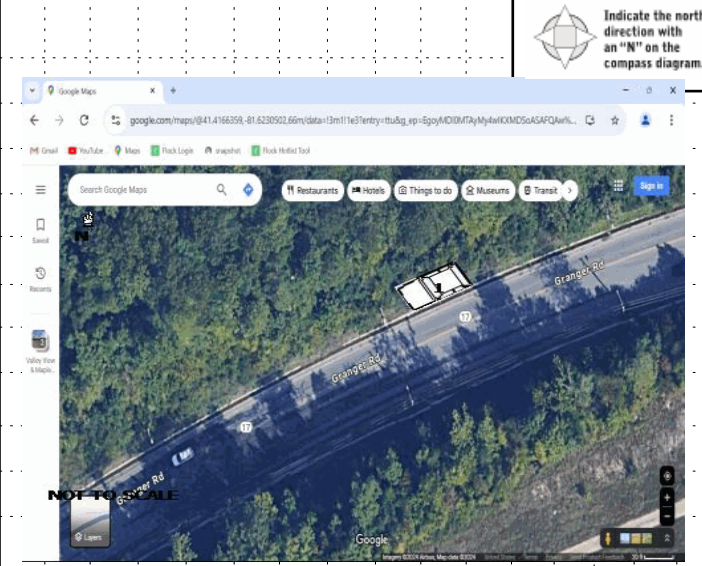

CRASH REPORTED DATE/TIME  
1 | 0 | 2 | 8 | 2 | 0 | 2 | 4 | 2 | 2 | 4 | 2

DISPATCH DATE/TIME  
1 | 0 | 2 | 8 | 2 | 0 | 2 | 4 | 2 | 2 | 4 | 2

ARRIVAL DATE/TIME  
1 | 0 | 2 | 8 | 2 | 0 | 2 | 4 | 2 | 2 | 4 | 3

SCENE CLEARED DATE/TIME  
1 | 0 | 2 | 8 | 2 | 0 | 2 | 4 | 2 | 3 | 1 | 0

REPORT TAKEN BY  
 POLICE AGENCY  
 MOTORIST

TOTAL TIME ROADWAY CLOSED  
0

OTHER INVESTIGATION TIME

TOTAL MINUTES  
2 | 7

OFFICER'S NAME \*  
Y. Ihiri

OFFICER'S BADGE NUMBER\*  
0 | 3 | 8

CHECKED BY OFFICER'S NAME\*  
D. Simia

CHECKED BY OFFICER'S BADGE NUMBER\*  
S | 2 | 3

SUPPLEMENT  
(CORRECTION - ADDITION)

UNIT # 01 OWNER NAME: LAST, FIRST, MIDDLE (  Same As Driver )  
**COLEMAN DIANE C**  
 OWNER ADDRESS: STREET, CITY, STATE, ZIP (  Same As Driver )  
**10917 PARK HEIGHTS AVE GARFIELD HTS OH 44125**  
 COMMERCIAL CARRIER: NAME, ADDRESS, CITY, STATE, ZIP  
 COMMERCIAL CARRIER PHONE: INCLUDE AREA CODE

LOCAL REPORT NUMBER  
20242979

**DAMAGE**  
**DAMAGE SCALE**  
 1 - NONE  
 2 - MINOR DAMAGE  
 3 - FUNCTIONAL DAMAGE  
 4 - DISABLING DAMAGE  
 9 - UNKNOWN  
3

LP STATE OH LICENSE PLATE # MCH6950 VEHICLE IDENTIFICATION # 1GKDS113S917220181959 VEHICLE YEAR 2007 VEHICLE MAKE GMC  
 INSURANCE VERIFIED INSURANCE COMPANY NATIONWIDE INSURANCE INSURANCE POLICY # 9234J156231 VEHICLE COLOR WHI VEHICLE MODEL Envoy  
 COMMERCIAL  GOVERNMENT  IN EMERGENCY RESPONSE US DOT # \_\_\_\_\_ TOWED BY: COMPANY NAME INTERSTATE  
 INTERLOCK DEVICE EQUIPPED  HIT/SKIP UNIT # OCCUPANTS 01 VEHICLE WEIGHT GVWR/GVWR 1- <10K LBS. 2- 10,001 - 26K LBS. 3- >26K LBS. HAZARDOUS MATERIAL  MATERIAL RELEASED CLASS # \_\_\_\_\_ PLACARD ID # \_\_\_\_\_  PLACARD

**DAMAGED AREA(S)**  
 INDICATE ALL THAT APPLY

- NO DAMAGE [0]  - UNDERCARRIAGE [14]  
 - TOP [13]  - ALL AREAS [15]  
 - UNIT NOT AT SCENE [16]

UNIT TYPE 01 # OF TRAILING UNITS \_\_\_\_\_  
 1 - PASSENGER CAR 7 - MOTORCYCLE 2-WHEELED 12 - GOLF CART 18 - LIMO (LIVERY VEHICLE) 23 - PEDESTRIAN SKATER  
 2 - PASSENGER VAN (MINIVAN) 8 - MOTORCYCLE 3-WHEELED 13 - SNOWMOBILE 19 - BUS (16+ PASSENGERS) 24 - WHEELCHAIR (ANY TYPE)  
 3 - SPORT UTILITY VEHICLE 9 - AUTOCYCLE 14 - SINGLE UNIT TRUCK 20 - OTHER VEHICLE 25 - OTHER NON-MOTORIST  
 4 - PICK UP 10 - MOPED OR MOTORIZED BICYCLE 15 - SEMI-TRACTOR 21 - HEAVY EQUIPMENT 26 - BICYCLE  
 5 - CARGO VAN 11 - ALL TERRAIN VEHICLE (ATV / UTV) 16 - FARM EQUIPMENT 22 - ANIMAL WITH RIDER OR ANIMAL-DRAWN VEHICLE 27 - TRAIN  
 6 - VAN (9-15 SEATS) 17 - MOTORHOME

WAS VEHICLE OPERATING IN AUTONOMOUS MODE WHEN CRASH OCCURRED? 2 AUTONOMOUS MODE LEVEL 0  
 1 - YES 2 - NO 9 - OTHER / UNKNOWN  
 0 - NO AUTOMATION 1 - DRIVER ASSISTANCE 3 - CONDITIONAL AUTOMATION 9 - UNKNOWN  
 1 - PARTIAL AUTOMATION 2 - PARTIAL AUTOMATION 4 - HIGH AUTOMATION 5 - FULL AUTOMATION

SPECIAL FUNCTION 01  
 1 - NONE 6 - BUS - CHARTER/TOUR 11 - FIRE 16 - FARM 21 - MAIL CARRIER  
 2 - TAXI 7 - BUS - INTERCITY 12 - MILITARY 17 - MOWING 22 - OTHER UNKNOWN  
 3 - ELECTRONIC RIDE SHARING 8 - BUS - SHUTTLE 13 - POLICE 18 - SNOW REMOVAL 23 - SCHOOL BUS  
 4 - SCHOOL TRANSPORT 9 - BUS - OTHER 14 - PUBLIC UTILITY 19 - TOWING 24 - GARBAGE/REFUSE  
 5 - BUS-TRANSIT/COMMUTER 10 - AMBULANCE 15 - CONSTRUCTION EQUIPMENT 20 - SAFETY SERVICE PATROL 25 - OTHER / UNKNOWN

CARGO BODY TYPE 01  
 1 - NO CARGO BODY TYPE / NOT APPLICABLE 3 - VEHICLE TOWING ANOTHER MOTOR VEHICLE 5 - INTERMODAL CONTAINER CHASSIS 8 - POLE 12 - CONCRETE MIXER  
 2 - BUS 4 - LOGGING 6 - CARGO VAN/ENCLOSED BOX 9 - CARGO TANK 13 - AUTO TRANSPORTER  
 7 - GRAIN/CHIPS/GRAVEL 10 - FLAT BED 14 - GARBAGE/REFUSE 15 - OTHER / UNKNOWN  
 11 - DUMP

VEHICLE DEFECTS 01  
 1 - TURN SIGNALS 4 - BRAKES 7 - WORN OR SLICK TIRES 9 - MOTOR TROUBLE 99 - OTHER / UNKNOWN  
 2 - HEAD LAMPS 5 - STEERING 8 - TRAILER EQUIPMENT DEFECTIVE 10 - DISABLED FROM PRIOR ACCIDENT  
 3 - TAIL LAMPS 6 - TIRE BLOWOUT

NON-MOTORIST LOCATION AT IMPACT 1 PRE-CRASH ACTION 01  
 1 - INTERSECTION - MARKED CROSSWALK 3 - INTERSECTION - OTHER 6 - BICYCLE LANE 9 - MEDIAN/CROSSING ISLAND 12 - FIRST RESPONDER AT INCIDENT SCENE  
 2 - INTERSECTION - UNMARKED CROSSWALK 4 - MIDBLOCK - MARKED CROSSWALK 7 - SHOULDER/ROADSIDE 10 - DRIVEWAY ACCESS 99 - OTHER / UNKNOWN  
 5 - TRAVEL LANE-OTHER LOCATION 8 - SIDEWALK 11 - SHARED USE PATHS OR TRAILS  
 1 - NON-CONTACT 2 - NON-COLLISION 3 - STRIKING 4 - STRUCK 5 - BOTH STRIKING & STRUCK 9 - OTHER / UNKNOWN  
 1 - STRAIGHT AHEAD 2 - BACKING 3 - CHANGING LANES 4 - OVERTAKING/PASSING 5 - MAKING RIGHT TURN 6 - MAKING LEFT TURN 7 - MAKING U-TURN 8 - ENTERING TRAFFIC LANE 9 - LEAVING TRAFFIC LANE 10 - PARKED 11 - SLOWING OR STOPPED IN TRAFFIC 12 - DRIVERLESS 13 - NEGOTIATING A CURVE 14 - ENTERING OR CROSSING SPECIFIED LOCATION 15 - WALKING, RUNNING, JOGGING, PLAYING 16 - WORKING 17 - PUSHING VEHICLE 18 - APPROACHING OR LEAVING VEHICLE 19 - STANDING 20 - OTHER NON-MOTORIST 21 - STANDING OUTSIDE DISABLED VEHICLE 99 - OTHER / UNKNOWN

**INITIAL POINT OF CONTACT**  
01 0 - NO DAMAGE 14 - UNDERCARRIAGE  
 1-12 - REFER TO UNIT DIAGRAM 15 - VEHICLE NOT AT SCENE  
 13 - TOP 99 - UNKNOWN

CONTRIBUTING CIRCUMSTANCES 01  
 1 - NONE 2 - FAILURE TO YIELD 3 - RAN RED LIGHT 4 - RAN STOP SIGN 5 - UNSAFE SPEED 6 - IMPROPER TURN 7 - LEFT OF CENTER 8 - FOLLOWING TOO CLOSE/ACDA 9 - IMPROPER LANE CHANGING 10 - IMPROPER PASSING 11 - DROVE OFF ROAD 12 - IMPROPER BACKING 13 - IMPROPER START FROM A PARKED POSITION 14 - STOPPED OR PARKED ILLEGALLY 15 - SWERVING TO AVOID 16 - WRONG WAY 17 - VISION OBSTRUCTION 18 - OPERATING DEFECTIVE EQUIPMENT 19 - LOAD SHIFTING/ FALLING/SPILLING 20 - IMPROPER CROSSING 21 - LYING IN ROADWAY 22 - NOT DISCERNABLE 23 - OPENING DOOR INTO ROADWAY 99 - OTHER IMPROPER ACTION

**TRAFFIC**  
**TRAFFICWAY FLOW** 2 1 - ONE-WAY 2 - TWO-WAY  
**TRAFFIC CONTROL** 6 1 - ROUNDABOUT 2 - SIGNAL 3 - FLASHER 4 - STOP SIGN 5 - YIELD SIGN 6 - NO CONTROL

**SEQUENCE OF EVENTS**  
 1 23 1 - OVERTURN/ROLLOVER 2 - FIRE/EXPLOSION 3 - IMMERSION 4 - JACKKNIFE 5 - CARGO / EQUIPMENT LOSS OR SHIFT  
 6 - EQUIPMENT FAILURE 7 - SEPARATION OF UNITS 8 - RAN OFF ROAD RIGHT 9 - RAN OFF ROAD LEFT 10 - CROSS MEDIAN  
 11 - CROSS CENTERLINE - OPPOSITE DIRECTION OF TRAVEL 12 - DOWNHILL RUNAWAY 13 - OTHER NON-COLLISION 14 - PEDESTRIAN 15 - PEDALCYCLE  
 16 - RAILWAY VEHICLE 17 - ANIMAL - FARM 18 - ANIMAL - DEER 19 - ANIMAL - OTHER 20 - MOTOR VEHICLE IN TRANSPORT 21 - PARKED MOTOR VEHICLE  
 22 - WORK ZONE MAINTENANCE EQUIPMENT 23 - STRUCK BY FALLING, SHIFTING CARGO OR ANYTHING SET IN MOTION BY A MOTOR VEHICLE 24 - OTHER MOVABLE OBJECT

# OF THROUGH LANES ON ROAD 02  
**RAIL GRADE CROSSING**  
 1 - NOT INVOLVED 2 - INVOLVED - ACTIVE CROSSING 3 - INVOLVED - PASSIVE CROSSING

**COLLISION WITH FIXED OBJECT - STRUCK**  
 25 - IMPACT ATTENUATOR / CRASH CUSHION 26 - BRIDGE OVERHEAD STRUCTURE 27 - BRIDGE PIER OR ABUTMENT 28 - BRIDGE PARAPET 29 - BRIDGE RAIL 30 - GUARDRAIL FACE 31 - GUARDRAIL END 32 - PORTABLE BARRIER 33 - MEDIAN CABLE BARRIER 34 - MEDIAN GUARDRAIL BARRIER 35 - MEDIAN CONCRETE BARRIER 36 - MEDIAN OTHER BARRIER 37 - TRAFFIC SIGN POST 38 - OVERHEAD SIGN POST 39 - LIGHT/LUMINARIES SUPPORT 40 - UTILITY POLE 41 - OTHER POST, POLE OR SUPPORT 42 - CULVERT 43 - CURB 44 - DITCH 45 - EMBANKMENT 46 - FENCE 47 - MAILBOX 48 - TREE 49 - FIRE HYDRANT 50 - WORKZONE MAINTENANCE EQUIPMENT 51 - WALL 52 - BUILDING 53 - TUNNEL 54 - OTHER FIXED OBJECT 99 - OTHER / UNKNOWN  
 FIRST HARMFUL EVENT 1 MOST HARMFUL EVENT 1

**UNIT / NON-MOTORIST DIRECTION**  
 FROM 3 TO 4  
 1 - NORTH 2 - SOUTH 3 - EAST 4 - WEST 5 - NORTHEAST 6 - NORTHWEST 7 - SOUTHEAST 8 - SOUTHWEST 9 - OTHER / UNKNOWN

**UNIT SPEED** 35  
**POSTED SPEED** 35  
**DETECTED SPEED** 1 1 - STATED/ESTIMATED SPEED 2 - CALCULATED / EDR 3 - UNDETERMINED

