

TRAFFIC CRASH REPORT

*DENOTES MANDATORY FIELD FOR SUPPLEMENT REPORT

LOCAL REPORT NUMBER *

2 | 0 | 2 | 4 | 2 | 3 | 0 | 0

PHOTOS TAKEN OH-2 OH-3
 SECONDARY CRASH OH-1P OTHER
 Private Property

LOCAL INFORMATION

REPORTING AGENCY NAME *

GARFIELD HEIGHTS

NCIC *
0 | 1 | 8 | 2 | 0

HITSKIP
1 - Solved
2 - Unsolved
1

NUMBER OF UNITS
0 | 2

UNIT IN ERROR
98 - ANIMAL
99 - UNKNOWN
0 | 2

COUNTY *
1 | 8

LOCALITY *
1

LOCATION: CITY, VILLAGE, TOWNSHIP *
GARFIELD HTS

CRASH DATE/TIME *
0 | 8 | 2 | 1 | 2 | 0 | 2 | 4 | 1 | 2 | 3 | 7

CRASH SEVERITY
5

1 - FATAL
2 - SERIOUS INJURY SUSPECTED
3 - MINOR INJURY SUSPECTED
4 - INJURY POSSIBLE
5 - PROPERTY DAMAGE ONLY

ROUTE TYPE
ROUTE NUMBER
PREFIX
3

LOCATION ROAD NAME
93

ROAD TYPE
S | T

LATTITUDE DECIMAL DEGREES
4 | 1 | 4 | 3 | 3 | 9 | 0 | 3

ROUTE TYPE
ROUTE NUMBER
PREFIX

REFERENCE ROAD NAME (ROAD, MILEPOST, HOUSE #)
4614

ROAD TYPE

LONGITUDE DECIMAL DEGREES
8 | 1 | 6 | 2 | 1 | 6 | 8 | 4

REFERENCE POINT
3

1 - INTERSECTION
2 - MILE POST
3 - HOUSE #

DIRECTION
1 - NORTH
2 - SOUTH
3 - EAST
4 - WEST

ROUTE TYPE
IR - INTERSTATE ROUTE (TP)
US - FEDERAL US ROUTE
SR - STATE ROUTE
CR - NUMBERED COUNTY ROUTE
TR - NUMBERED TOWNSHIP ROUTE

ROAD TYPE
AL - ALLEY
AV - AVENUE
BL - BOULEVARD
CR - CIRCLE
CT - COURT
DR - DRIVE
HE - HEIGHTS
HW - HIGHWAY
LA - LANE
MP - MILEPOST
OV - OVAL
PK - PARKWAY
PI - PIKE
PL - PLACE
RD - ROAD
SQ - SQUARE
ST - STREET
TE - TERRACE
TL - TRAIL
WA - WAY

INTERSECTION RELATED
 WITHIN INTERSECTION OR ON APPROACH
 WITHIN INTERCHANGE AREA
NUMBER OF APPROACHES

DISTANCE
1 - Miles
2 - Feet
3 - Yards

DISTANCE
1 - Miles
2 - Feet
3 - Yards

ROADWAY
 ROADWAY DIVIDED

LOCATION OF FIRST DAMAGE EVENT
0 | 1

1 - ON ROADWAY
2 - ON SHOULDER
3 - IN MEDIAN
4 - ON ROADSIDE
5 - ON GORE
6 - OUTSIDE TRAFFICWAY
7 - ON RAMP
8 - OFF RAMP
9 - CROSSOVER
10 - DRIVEWAY / ALLEY ACCESS
11 - RAILWAY GRADE CROSSING
12 - SHARED USE PATHS OR TRAILS
13 - BIKE LANE
14 - TOLL BOOTH
99 - OTHER / UNKNOWN

MANNER OF CRASH COLLISION/IMPACT
5

1 - NOT COLLISION BETWEEN TWO MOTOR VEHICLES IN TRANSPORT
2 - REAR-END
3 - HEAD-ON
4 - REAR-TO-REAR
5 - BACKING
6 - ANGLE
7 - SIDESWIPE, SAME DIRECTION
8 - SIDESWIPE, OPPOSITE DIRECTION
9 - OTHER / UNKNOWN

DIRECTION OF TRAVEL
1 - NORTH
2 - SOUTH
3 - EAST
4 - WEST

MEDIAN TYPE
1 - DIVIDED FLUSH MEDIAN (<4 FEET)
2 - DIVIDED FLUSH MEDIAN (24 FEET)
3 - DIVIDED, DEPRESSED MEDIAN
4 - DIVIDED, RAISED MEDIAN (ANY TYPE)
9 - OTHER / UNKNOWN

WORK ZONE RELATED
 WORKERS PRESENT
 LAW ENFORCEMENT PRESENT
 ACTIVE SCHOOL ZONE

WORK ZONE TYPE
1 - LANE CLOSURE
2 - LANE SHIFT/CROSSOVER
3 - WORK ON SHOULDER
OR MEDIAN
4 - INTERMITTENT OR MOVING WORK
5 - OTHER

LOCATION OF CRASH IN WORK ZONE
1 - BEFORE THE 1ST WORK ZONE WARNING SIGN
2 - ADVANCE WARNING AREA
3 - TRANSITION AREA
4 - ACTIVITY AREA
5 - TERMINATION AREA

CONTOUR
1

1 - STRAIGHT LEVEL
2 - STRAIGHT GRADE
3 - CURVE LEVEL
4 - CURVE GRADE
9 - OTHER / UNKNOWN

CONDITIONS
1

1 - DRY
2 - WET
3 - SNOW
4 - ICE
5 - SAND, MUD, DIRT, OIL, GRAVEL
6 - WATER (STANDING, MOVING)
7 - SLUSH
9 - OTHER/UNKNOWN

SURFACE
2

1 - CONCRETE
2 - BLACKTOP, BITUMINOUS, ASPHALT
3 - BRICK/BLOCK
4 - SLAG, GRAVEL, STONE
5 - DIRT
9 - OTHER / UNKNOWN

LIGHT CONDITION
1

1 - DAYLIGHT
2 - DAWN/DUSK
3 - DARK - LIGHTED ROADWAY
4 - DARK - ROADWAY NOT LIGHTED
5 - DARK - UNKNOWN ROADWAY LIGHTING
9 - OTHER / UNKNOWN

WEATHER
1

1 - CLEAR
2 - CLOUDY
3 - FOG, SMOG, SMOKE
4 - RAIN
5 - SLEET, HAIL
6 - SNOW
7 - SEVERE CROSSWINDS
8 - BLOWING SAND, SOIL, DIRT, SNOW
9 - FREEZING RAIN OR FREEZING DRIZZLE
99 - OTHER / UNKNOWN

INDICATE THE NORTH DIRECTION WITH AN "N" ON THE COMPASS DIAGRAM.

UNIT 1 WAS PARKED UNOCCUPIED IN FRONT OF 4614 E 93. UNIT 2 WAS BACKING N/B FROM DRIVEWAY AT 4614 E 93 IN ORDER TO TURN AROUND AND STRUCK THE RIGHT FRONT OF UNIT 1. UNIT 2 THEN FLED THE AREA. UNIT 1 OWNER OBSERVED THE LICENSE PLATE.

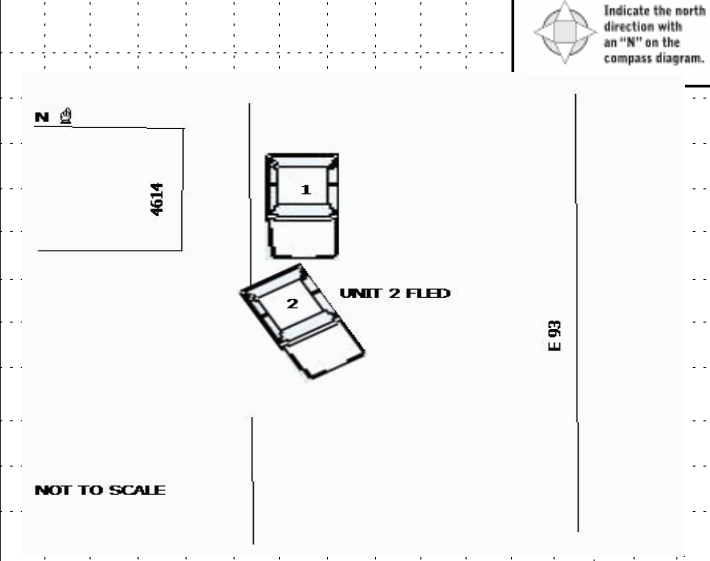

CRASH REPORTED DATE/TIME
0 | 8 | 2 | 1 | 2 | 0 | 2 | 4 | 1 | 2 | 3 | 7

DISPATCH DATE/TIME
0 | 8 | 2 | 1 | 2 | 0 | 2 | 4 | 1 | 2 | 3 | 9

ARRIVAL DATE/TIME
0 | 8 | 2 | 1 | 2 | 0 | 2 | 4 | 1 | 2 | 4 | 2

SCENE CLEARED DATE/TIME
0 | 8 | 2 | 1 | 2 | 0 | 2 | 4 | 1 | 2 | 5 | 1

REPORT TAKEN BY
 POLICE AGENCY
 MOTORIST

TOTAL TIME ROADWAY CLOSED
0

OTHER INVESTIGATION TIME
4 | 5

TOTAL MINUTES
5 | 4

OFFICER'S NAME *
B. Cwiklinski

OFFICER'S BADGE NUMBER *
0 | 0 | 9

CHECKED BY OFFICER'S NAME *
T. Baon

CHECKED BY OFFICER'S BADGE NUMBER *
S | 2 | 0

SUPPLEMENT
CORRECTION - ADDITION

UNIT # 01 OWNER NAME: LAST, FIRST, MIDDLE () Same As Driver
TAYLOR KIM BRIDGETTE RENEE
 OWNER PHONE: INCLUDE AREA CODE () Same As Driver
 OWNER ADDRESS: STREET, CITY, STATE, ZIP () Same As Driver
4614 E 93TH ST GARFIELD HTS OH 44125
 COMMERCIAL CARRIER: NAME, ADDRESS, CITY, STATE, ZIP
 COMMERCIAL CARRIER PHONE: INCLUDE AREA CODE

LP STATE OH LICENSE PLATE # KFS3247 VEHICLE IDENTIFICATION # 1G4PR5SK51D41911103 VEHICLE YEAR 2013 VEHICLE MAKE Buick
 INSURANCE VERIFIED INSURANCE COMPANY STATEFARM INSURANCE POLICY # UNK VEHICLE COLOR WHI VEHICLE MODEL Verano
 COMMERCIAL GOVERNMENT IN EMERGENCY RESPONSE US DOT # _____ TOWED BY: COMPANY NAME _____
 INTERLOCK DEVICE EQUIPPED HIT/SKIP UNIT # OCCUPANTS 00 VEHICLE WEIGHT GVWR/GVWR 1- <10K LBS. 2- 10,001 - 26K LBS. 3- >26K LBS. HAZARDOUS MATERIAL MATERIAL RELEASED CLASS # _____ PLACARD ID # _____
 PLACARD

UNIT TYPE 01 1- PASSENGER CAR 7- MOTORCYCLE 2-WHEELED 12- GOLF CART 18- LIMO (LIVERY VEHICLE) 23- PEDESTRIAN SKATER
 2- PASSENGER VAN (MINIVAN) 8- MOTORCYCLE 3-WHEELED 13- SNOWMOBILE 19- BUS (16+ PASSENGERS) 24- WHEELCHAIR (ANY TYPE)
 3- SPORT UTILITY VEHICLE 9- AUTOCYCLE 14- SINGLE UNIT TRUCK 20- OTHER VEHICLE 25- OTHER NON-MOTORIST
 4- PICK UP 10- MOPED OR MOTORIZED BICYCLE 15- SEMI-TRACTOR 21- HEAVY EQUIPMENT 26- BICYCLE
 5- CARGO VAN 11- ALL TERRAIN VEHICLE (ATV / UTV) 16- FARM EQUIPMENT 22- ANIMAL WITH RIDER OR ANIMAL-DRAWN VEHICLE 27- TRAIN
 6- VAN (9-15 SEATS) 17- MOTORHOME 16- FARM EQUIPMENT 99- UNKNOWN OR HIT/SKIP

WAS VEHICLE OPERATING IN AUTONOMOUS MODE WHEN CRASH OCCURRED? 2 1- YES 2- NO 9- OTHER / UNKNOWN AUTONOMOUS MODE LEVEL 0 0- NO AUTOMATION 1- DRIVER ASSISTANCE 3- CONDITIONAL AUTOMATION 9- UNKNOWN
 2- PARTIAL AUTOMATION 4- HIGH AUTOMATION 5- FULL AUTOMATION

SPECIAL FUNCTION 01 1- NONE 6- BUS - CHARTER/TOUR 11- FIRE 16- FARM 21- MAIL CARRIER
 2- TAXI 7- BUS - INTERCITY 12- MILITARY 17- MOWING 22- OTHER UNKNOWN
 3- ELECTRONIC RIDE SHARING 8- BUS - SHUTTLE 13- POLICE 18- SNOW REMOVAL 23- OTHER UNKNOWN
 4- SCHOOL TRANSPORT 9- BUS - OTHER 14- PUBLIC UTILITY 19- TOWING
 5- BUS-TRANSIT/COMMUTER 10- AMBULANCE 15- CONSTRUCTION EQUIPMENT 20- SAFETY SERVICE PATROL

CARGO BODY TYPE 01 1- NO CARGO BODY TYPE / NOT APPLICABLE 3- VEHICLE TOWING ANOTHER MOTOR VEHICLE 5- INTERMODAL CONTAINER CHASSIS 8- POLE 12- CONCRETE MIXER
 2- BUS 4- LOGGING 6- CARGO VAN/ENCLOSED BOX 7- GRAIN/CHIPS/GRAVEL 9- CARGO TANK 10- FLAT BED 13- AUTO TRANSPORTER
 14- GARBAGE/REFUSE 99- OTHER / UNKNOWN

VEHICLE DEFECTS 01 1- TURN SIGNALS 4- BRAKES 7- WORN OR SLICK TIRES 9- MOTOR TROUBLE 99- OTHER / UNKNOWN
 2- HEAD LAMPS 5- STEERING 8- TRAILER EQUIPMENT DEFECTIVE 10- DISABLED FROM PRIOR ACCIDENT
 3- TAIL LAMPS 6- TIRE BLOWOUT

NON-MOTORIST LOCATION AT IMPACT 01 1- INTERSECTION - MARKED CROSSWALK 3- INTERSECTION - OTHER 6- BICYCLE LANE 9- MEDIAN/CROSSING ISLAND 12- FIRST RESPONDER AT INCIDENT SCENE
 2- INTERSECTION - UNMARKED CROSSWALK 4- MIDBLOCK - MARKED CROSSWALK 7- SHOULDER/ROADSIDE 10- DRIVEWAY ACCESS 99- OTHER / UNKNOWN
 5- TRAVEL LANE-OTHER LOCATION 8- SIDEWALK 11- SHARED USE PATHS OR TRAILS

ACTION 4 1- NON-CONTACT 1- STRAIGHT AHEAD 7- MAKING U-TURN 13- NEGOTIATING A CURVE 18- APPROACHING OR LEAVING VEHICLE
 2- NON-COLLISION 2- BACKING 8- ENTERING TRAFFIC LANE 14- ENTERING OR CROSSING SPECIFIED LOCATION 19- STANDING
 3- STRIKING 3- CHANGING LANES 9- LEAVING TRAFFIC LANE 15- WALKING, RUNNING, JOGGING, PLAYING 20- OTHER NON-MOTORIST
 4- STRUCK 4- OVERTAKING/PASSING 10- PARKED 16- WORKING 21- STANDING OUTSIDE DISABLED VEHICLE
 5- BOTH STRIKING & STRUCK 5- MAKING RIGHT TURN 11- SLOWING OR STOPPED IN TRAFFIC 99- OTHER / UNKNOWN
 9- OTHER / UNKNOWN 6- MAKING LEFT TURN 12- DRIVERLESS 17- PUSHING VEHICLE

CONTRIBUTING CIRCUMSTANCES 01 1- NONE 7- LEFT OF CENTER 13- IMPROPER START FROM A PARKED POSITION 17- VISION OBSTRUCTION 21- LYING IN ROADWAY
 2- FAILURE TO YIELD 8- FOLLOWING TOO CLOSE/ACDA 14- STOPPED OR PARKED ILLEGALLY 18- OPERATING DEFECTIVE EQUIPMENT 22- NOT DISCERNABLE
 3- RAN RED LIGHT 9- IMPROPER LANE CHANGING 15- SWERVING TO AVOID 19- LOAD SHIFTING/ FALLING/SPILLING 23- OPENING DOOR INTO ROADWAY
 4- RAN STOP SIGN 10- IMPROPER PASSING 11- DROVE OFF ROAD 20- IMPROPER CROSSING 99- OTHER IMPROPER ACTION
 5- UNSAFE SPEED 12- IMPROPER BACKING 16- WRONG WAY

SEQUENCE OF EVENTS 1 20
 1- OVERTURN/ROLLOVER 6- EQUIPMENT FAILURE 11- CROSS CENTERLINE - OPPOSITE DIRECTION OF TRAVEL 16- RAILWAY VEHICLE 22- WORK ZONE MAINTENANCE EQUIPMENT
 2- FIRE/EXPLOSION 7- SEPARATION OF UNITS 12- DOWNHILL RUNAWAY 17- ANIMAL - FARM 23- STRUCK BY FALLING, SHIFTING CARGO OR ANYTHING SET IN MOTION BY A MOTOR VEHICLE
 3- IMMERSION 8- RAN OFF ROAD RIGHT 13- OTHER NON-COLLISION 18- ANIMAL - DEER 24- OTHER MOVABLE OBJECT
 4- JACKKNIFE 9- RAN OFF ROAD LEFT 14- PEDESTRIAN 19- ANIMAL - OTHER 25- OTHER FIXED OBJECT 99- OTHER / UNKNOWN
 5- CARGO / EQUIPMENT LOSS OR SHIFT 10- CROSS MEDIAN 15- PEDALCYCLE 21- PARKED MOTOR VEHICLE
 3
 COLLISION WITH FIXED OBJECT - STRUCK
 4
 25- IMPACT ATTENUATOR / CRASH CUSHION 31- GUARDRAIL END 37- TRAFFIC SIGN POST 43- CURB 50- WORKZONE MAINTENANCE EQUIPMENT
 26- BRIDGE OVERHEAD STRUCTURE 32- PORTABLE BARRIER 38- OVERHEAD SIGN POST 44- DITCH 51- WALL
 27- BRIDGE PIER OR ABUTMENT 33- MEDIAN CABLE BARRIER 39- LIGHT/LUMINARIES SUPPORT 45- EMBANKMENT 52- BUILDING
 28- BRIDGE PARAPET 34- MEDIAN GUARDRAIL BARRIER 40- UTILITY POLE 46- FENCE 53- TUNNEL
 29- BRIDGE RAIL 35- MEDIAN CONCRETE BARRIER 41- OTHER POST, POLE OR SUPPORT 47- MAILBOX 54- OTHER FIXED OBJECT 99- OTHER / UNKNOWN
 30- GUARDRAIL FACE 36- MEDIAN OTHER BARRIER 42- CULVERT 48- TREE 49- FIRE HYDRANT

FIRST HARMFUL EVENT 1 MOST HARMFUL EVENT 1

LOCAL REPORT NUMBER
20242300

DAMAGE
 DAMAGE SCALE
 1- NONE 3- FUNCTIONAL DAMAGE
 2- MINOR DAMAGE 4- DISABLING DAMAGE
 9- UNKNOWN
4

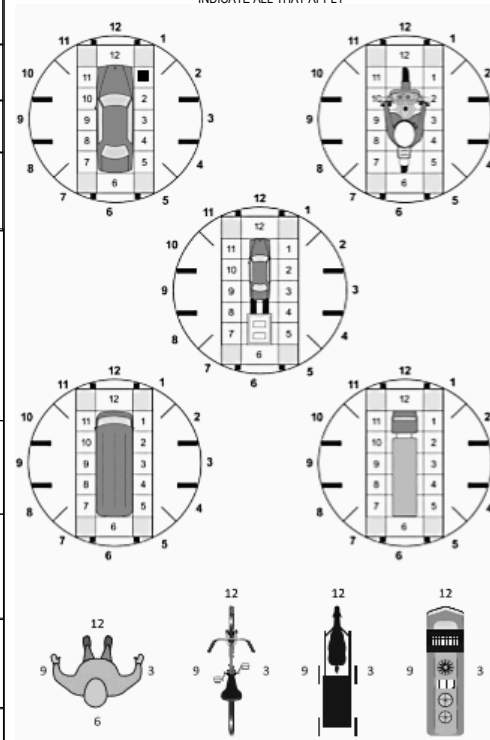
DAMAGED AREA(S)
 INDICATE ALL THAT APPLY

 - NO DAMAGE [0] - UNDERCARRIAGE [14]
 - TOP [13] - ALL AREAS [15]
 - UNIT NOT AT SCENE [16]

INITIAL POINT OF CONTACT
01 0- NO DAMAGE 14- UNDERCARRIAGE
 1-12- REFER TO UNIT DIAGRAM 15- VEHICLE NOT AT SCENE
 99- UNKNOWN
 13- TOP

TRAFFIC
 TRAFFICWAY FLOW 2 1- ONE-WAY 2- TWO-WAY
 TRAFFIC CONTROL 6 1- ROUNDABOUT 4- STOP SIGN
 2- SIGNAL 5- YIELD SIGN
 3- FLASHER 6- NO CONTROL

OF THROUGH LANES ON ROAD 2
 RAIL GRADE CROSSING 3 1- NOT INVOLVED 2- INVOLVED - ACTIVE CROSSING 3- INVOLVED - PASSIVE CROSSING

UNIT / NON-MOTORIST DIRECTION
 FROM 1 TO 2
 1- NORTH 5- NORTHEAST
 2- SOUTH 6- NORTHWEST
 3- EAST 7- SOUTHEAST
 4- WEST 8- SOUTHWEST
 9- OTHER / UNKNOWN

UNIT SPEED 0
 POSTED SPEED 25
 DETECTED SPEED 1 1- STATED/ESTIMATED SPEED 2- CALCULATED / EDR 3- UNDETERMINED

OWNER INFORMATION

UNIT # 02 OWNER NAME: LAST, FIRST, MIDDLE () Same As Driver
WILEY TONYA DENISE

OWNER PHONE: INCLUDE AREA CODE () Same As Driver

OWNER ADDRESS: STREET, CITY, STATE, ZIP () Same As Driver
11812 HASTINGS RD 201 GARFIELD HTS OH 44125

COMMERCIAL CARRIER: NAME, ADDRESS, CITY, STATE, ZIP

COMMERCIAL CARRIER PHONE: INCLUDE AREA CODE

DAMAGE

DAMAGE SCALE

1 - NONE
2 - MINOR DAMAGE
3 - FUNCTIONAL DAMAGE
4 - DISABLING DAMAGE
9 - UNKNOWN

2

VEHICLE IDENTIFICATION # 3C4PDC1A5J1T23397Z VEHICLE YEAR 2018 VEHICLE MAKE Dodge

LP STATE OH LICENSE PLATE # FATFACE

INSURANCE VERIFIED INSURANCE COMPANY STATEFARM INSURANCE POLICY # 4125568SFP35 VEHICLE COLOR BLK VEHICLE MODEL Durango

TYPE OF USE: COMMERCIAL GOVERNMENT IN EMERGENCY RESPONSE

INTERLOCK DEVICE EQUIPPED HIT/SKIP UNIT # OCCUPANTS 01

US DOT # _____ TOWED BY: COMPANY NAME _____

VEHICLE WEIGHT GVWR/GCWR: 1- <10K LBS. 2- 10,001 - 26K LBS. 3- >26K LBS.

HAZARDOUS MATERIAL: MATERIAL RELEASED CLASS # _____ PLACARD ID # _____ PLACARD

DAMAGED AREA(S)
INDICATE ALL THAT APPLY

1 - NO DAMAGE [0]
2 - TOP [13]
3 - UNDERCARRIAGE [14]
4 - ALL AREAS [15]
5 - UNIT NOT AT SCENE [16]

UNIT TYPE 03

1 - PASSENGER CAR 2 - PASSENGER VAN (MINIVAN) 3 - SPORT UTILITY VEHICLE 4 - PICK UP 5 - CARGO VAN 6 - VAN (9-15 SEATS) 7 - MOTORCYCLE 2-WHEELED 8 - MOTORCYCLE 3-WHEELED 9 - AUTOCYCLE 10 - MOPED OR MOTORIZED BICYCLE 11 - ALL TERRAIN VEHICLE (ATV / UTV) 12 - GOLF CART 13 - SNOWMOBILE 14 - SINGLE UNIT TRUCK 15 - SEMI-TRACTOR 16 - FARM EQUIPMENT 17 - MOTORHOME 18 - LIMO (LIVERY VEHICLE) 19 - BUS (16+ PASSENGERS) 20 - OTHER VEHICLE 21 - HEAVY EQUIPMENT 22 - ANIMAL WITH RIDER OR ANIMAL-DRAWN VEHICLE 23 - PEDESTRIAN SKATER 24 - WHEELCHAIR (ANY TYPE) 25 - OTHER NON-MOTORIST 26 - BICYCLE 27 - TRAIN 99 - UNKNOWN OR HIT/SKIP

of TRAILING UNITS _____

WAS VEHICLE OPERATING IN AUTONOMOUS MODE WHEN CRASH OCCURRED? 2

1 - YES 2 - NO 9 - OTHER / UNKNOWN

AUTONOMOUS MODE LEVEL 0

0 - NO AUTOMATION 1 - DRIVER ASSISTANCE 2 - PARTIAL AUTOMATION 3 - CONDITIONAL AUTOMATION 4 - HIGH AUTOMATION 5 - FULL AUTOMATION 9 - UNKNOWN

SPECIAL FUNCTION 01

1 - NONE 2 - TAXI 3 - ELECTRONIC RIDE SHARING 4 - SCHOOL TRANSPORT 5 - BUS-TRANSIT/COMMUTER 6 - BUS - CHARTER/TOUR 7 - BUS - INTERCITY 8 - BUS - SHUTTLE 9 - BUS - OTHER 10 - AMBULANCE 11 - FIRE 12 - MILITARY 13 - POLICE 14 - PUBLIC UTILITY 15 - CONSTRUCTION EQUIPMENT 16 - FARM 17 - MOWING 18 - SNOW REMOVAL 19 - TOWING 20 - SAFETY SERVICE PATROL 21 - MAIL CARRIER 99 - OTHER / UNKNOWN

CARGO BODY TYPE 01

1 - NO CARGO BODY TYPE / NOT APPLICABLE 2 - BUS 3 - VEHICLE TOWING ANOTHER MOTOR VEHICLE 4 - LOGGING 5 - INTERMODAL CONTAINER CHASSIS 6 - CARGO VAN/ENCLOSED BOX 7 - GRAIN/CHIPS/GRAVEL 8 - POLE 9 - CARGO TANK 10 - FLAT BED 11 - DUMP 12 - CONCRETE MIXER 13 - AUTO TRANSPORTER 14 - GARBAGE/REFUSE 99 - OTHER / UNKNOWN

VEHICLE DEFECTS

1 - TURN SIGNALS 2 - HEAD LAMPS 3 - TAIL LAMPS 4 - BRAKES 5 - STEERING 6 - TIRE BLOWOUT 7 - WORN OR SLICK TIRES 8 - TRAILER EQUIPMENT DEFECTIVE 9 - MOTOR TROUBLE 10 - DISABLED FROM PRIOR ACCIDENT 99 - OTHER / UNKNOWN

NON-MOTORIST LOCATION AT IMPACT

1 - INTERSECTION - MARKED CROSSWALK 2 - INTERSECTION - UNMARKED CROSSWALK 3 - INTERSECTION - OTHER 4 - MIDBLOCK - MARKED CROSSWALK 5 - TRAVEL LANE-OTHER LOCATION 6 - BICYCLE LANE 7 - SHOULDER/ROADSIDE 8 - SIDEWALK 9 - MEDIAN/CROSSING ISLAND 10 - DRIVEWAY ACCESS 11 - SHARED USE PATHS OR TRAILS 12 - FIRST RESPONDER AT INCIDENT SCENE 99 - OTHER / UNKNOWN

ACTION 3

1 - NON-CONTACT 2 - NON-COLLISION 3 - STRIKING 4 - STRUCK 5 - BOTH STRIKING & STRUCK 9 - OTHER / UNKNOWN

PRE-CRASH ACTION 02

1 - STRAIGHT AHEAD 2 - BACKING 3 - CHANGING LANES 4 - OVERTAKING/PASSING 5 - MAKING RIGHT TURN 6 - MAKING LEFT TURN 7 - MAKING U-TURN 8 - ENTERING TRAFFIC LANE 9 - LEAVING TRAFFIC LANE 10 - PARKED 11 - SLOWING OR STOPPED IN TRAFFIC 12 - DRIVERLESS 13 - NEGOTIATING A CURVE 14 - ENTERING OR CROSSING SPECIFIED LOCATION 15 - WALKING, RUNNING, JOGGING, PLAYING 16 - WORKING 17 - PUSHING VEHICLE 18 - APPROACHING OR LEAVING VEHICLE 19 - STANDING 20 - OTHER NON-MOTORIST 21 - STANDING OUTSIDE DISABLED VEHICLE 99 - OTHER / UNKNOWN

INITIAL POINT OF CONTACT

07

0 - NO DAMAGE 1-12 - REFER TO UNIT DIAGRAM 13 - TOP 14 - UNDERCARRIAGE 15 - VEHICLE NOT AT SCENE 99 - UNKNOWN

CONTRIBUTING CIRCUMSTANCES

12

1 - NONE 2 - FAILURE TO YIELD 3 - RAN RED LIGHT 4 - RAN STOP SIGN 5 - UNSAFE SPEED 6 - IMPROPER TURN 7 - LEFT OF CENTER 8 - FOLLOWING TOO CLOSE/ACDA 9 - IMPROPER LANE CHANGING 10 - IMPROPER PASSING 11 - DROVE OFF ROAD 12 - IMPROPER BACKING 13 - IMPROPER START FROM A PARKED POSITION 14 - STOPPED OR PARKED ILLEGALLY 15 - SWERVING TO AVOID 16 - WRONG WAY 17 - VISION OBSTRUCTION 18 - OPERATING DEFECTIVE EQUIPMENT 19 - LOAD SHIFTING/ FALLING/SPILLING 20 - IMPROPER CROSSING 21 - LYING IN ROADWAY 22 - NOT DISCERNABLE 23 - OPENING DOOR INTO ROADWAY 99 - OTHER IMPROPER ACTION

TRAFFIC

TRAFFICWAY FLOW 2

1 - ONE-WAY 2 - TWO-WAY

TRAFFIC CONTROL 6

1 - ROUNDABOUT 2 - SIGNAL 3 - FLASHER 4 - STOP SIGN 5 - YIELD SIGN 6 - NO CONTROL

SEQUENCE OF EVENTS

EVENTS

1 21

1 - OVERTURN/ROLLOVER 2 - FIRE/EXPLOSION 3 - IMMERSION 4 - JACKKNIFE 5 - CARGO / EQUIPMENT LOSS OR SHIFT 6 - EQUIPMENT FAILURE 7 - SEPARATION OF UNITS 8 - RAN OFF ROAD RIGHT 9 - RAN OFF ROAD LEFT 10 - CROSS MEDIAN 11 - CROSS CENTERLINE - OPPOSITE DIRECTION OF TRAVEL 12 - DOWNHILL RUNAWAY 13 - OTHER NON-COLLISION 14 - PEDESTRIAN 15 - PEDALCYCLE 16 - RAILWAY VEHICLE 17 - ANIMAL - FARM 18 - ANIMAL - DEER 19 - ANIMAL - OTHER 20 - MOTOR VEHICLE IN TRANSPORT 21 - PARKED MOTOR VEHICLE 22 - WORK ZONE MAINTENANCE EQUIPMENT 23 - STRUCK BY FALLING, SHIFTING CARGO OR ANYTHING SET IN MOTION BY A MOTOR VEHICLE 24 - OTHER MOVABLE OBJECT

COLLISION WITH FIXED OBJECT - STRUCK

25 - IMPACT ATTENUATOR / CRASH CUSHION 26 - BRIDGE OVERHEAD STRUCTURE 27 - BRIDGE PIER OR ABUTMENT 28 - BRIDGE PARAPET 29 - BRIDGE RAIL 30 - GUARDRAIL FACE 31 - GUARDRAIL END 32 - PORTABLE BARRIER 33 - MEDIAN CABLE BARRIER 34 - MEDIAN GUARDRAIL BARRIER 35 - MEDIAN CONCRETE BARRIER 36 - MEDIAN OTHER BARRIER 37 - TRAFFIC SIGN POST 38 - OVERHEAD SIGN POST 39 - LIGHT/LUMINARIES SUPPORT 40 - UTILITY POLE 41 - OTHER POST, POLE OR SUPPORT 42 - CULVERT 43 - CURB 44 - DITCH 45 - EMBANKMENT 46 - FENCE 47 - MAILBOX 48 - TREE 49 - FIRE HYDRANT 50 - WORKZONE MAINTENANCE EQUIPMENT 51 - WALL 52 - BUILDING 53 - TUNNEL 54 - OTHER FIXED OBJECT 99 - OTHER / UNKNOWN

FIRST HARMFUL EVENT 1 MOST HARMFUL EVENT 1

OF THROUGH LANES ON ROAD 2

RAIL GRADE CROSSING

2

1 - NOT INVOLVED 2 - INVOLVED - ACTIVE CROSSING 3 - INVOLVED - PASSIVE CROSSING

UNIT / NON-MOTORIST DIRECTION

FROM 2 TO 1

1 - NORTH 2 - SOUTH 3 - EAST 4 - WEST 5 - NORTHEAST 6 - NORTHWEST 7 - SOUTHEAST 8 - SOUTHWEST 9 - OTHER / UNKNOWN

UNIT SPEED 5

POSTED SPEED 25

DETECTED SPEED 1

1 - STATED/ESTIMATED SPEED 2 - CALCULATED / EDR 3 - UNDETERMINED

