

TRAFFIC CRASH REPORT

*DENOTES MANDATORY FIELD FOR SUPPLEMENT REPORT

LOCAL REPORT NUMBER *

2 | 0 | 2 | 3 | 3 | 3 | 8 | 1 |

- PHOTOS TAKEN OH-2 OH-3
 SECONDARY CRASH OH-1P OTHER
 Private Property

LOCAL INFORMATION

REPORTING AGENCY NAME *

GARFIELD HEIGHTS

NCIC *
0 | 1 | 8 | 2 | 0

HITSKIP
1 - Solved
2 - Unsolved

NUMBER OF UNITS
0 | 2

INITIALS IN EDDP
98 - ANIMAL
99 - UNKNOWN
9 | 9

COUNTY *
1 | 8

LOCALITY *
1

LOCATION: CITY, VILLAGE, TOWNSHIP *
GARFIELD HTS

CRASH DATE/TIME *
1 | 2 | 1 | 5 | 2 | 0 | 2 | 3 | 0 | 7 | 0 | 9

CRASH SEVERITY
5

1 - FATAL
2 - SERIOUS INJURY SUSPECTED
3 - MINOR INJURY SUSPECTED
4 - INJURY POSSIBLE
5 - PROPERTY DAMAGE ONLY

ROUTE TYPE
S | R

ROUTE NUMBER
1 | 4

PREFIX
1 - NORTH
2 - SOUTH
3 - EAST
4 - WEST

LOCATION ROAD NAME
Broadway

ROAD TYPE
R | D

LATITUDE DECIMAL DEGREES
4 | 1 | 4 | 2 | 8 | 4 | 9 | 5

ROUTE TYPE

ROUTE NUMBER

PREFIX
1 - NORTH
2 - SOUTH
3 - EAST
4 - WEST

REFERENCE ROAD NAME (ROAD, MILEPOST, HOUSE #)
13100

ROAD TYPE

LONGITUDE DECIMAL DEGREES
8 | 1 | 5 | 9 | 1 | 2 | 8 | 9

REFERENCE POINT
1 - INTERSECTION
2 - MILE POST
3 - HOUSE #
3

DIRECTION
1 - NORTH
2 - SOUTH
3 - EAST
4 - WEST

ROUTE TYPE
IR - INTERSTATE ROUTE (TP)
US - FEDERAL US ROUTE
SR - STATE ROUTE
CR - NUMBERED COUNTY ROUTE
TR - NUMBERED TOWNSHIP ROUTE

ROAD TYPE
AL - ALLEY
AV - AVENUE
BL - BOULEVARD
CR - CIRCLE
CT - COURT
DR - DRIVE
HE - HEIGHTS
HW - HIGHWAY
LA - LANE
MP - MILEPOST
OV - OVAL
PK - PARKWAY
PI - PIKE
PL - PLACE
RD - ROAD
SQ - SQUARE
ST - STREET
TE - TERRACE
TL - TRAIL
WA - WAY

INTERSECTION RELATED
 WITHIN INTERSECTION OR ON APPROACH
 WITHIN INTERCHANGE AREA

NUMBER OF APPROACHES

DISTANCE
1 - Miles
2 - Feet
3 - Yards

DISTANCE
1 - Miles
2 - Feet
3 - Yards

ROADWAY
 ROADWAY DIVIDED

LOCATION OF FIRST DAMAGE EVENT
0 | 1

1 - ON ROADWAY
2 - ON SHOULDER
3 - IN MEDIAN
4 - ON ROADSIDE
5 - ON GORE
6 - OUTSIDE TRAFFICWAY
7 - ON RAMP
8 - OFF RAMP
9 - CROSSOVER
10 - DRIVEWAY / ALLEY ACCESS
11 - RAILWAY GRADE CROSSING
12 - SHARED USE PATHS OR TRAILS
13 - BIKE LANE
14 - TOLL BOOTH
99 - OTHER / UNKNOWN

MANNER OF CRASH COLLISION/IMPACT
6

1 - NOT COLLISION BETWEEN TWO MOTOR VEHICLES IN TRANSPORT
2 - REAR-END
3 - HEAD-ON
4 - REAR-TO-REAR
5 - BACKING
6 - ANGLE
7 - SIDESWIPE, SAME DIRECTION
8 - SIDESWIPE, OPPOSITE DIRECTION
9 - OTHER / UNKNOWN

DIRECTION OF TRAVEL
1 - NORTH
2 - SOUTH
3 - EAST
4 - WEST

MEDIAN TYPE
1 - DIVIDED FLUSH MEDIAN (<4 FEET)
2 - DIVIDED FLUSH MEDIAN (24 FEET)
3 - DIVIDED, DEPRESSED MEDIAN
4 - DIVIDED, RAISED MEDIAN (ANY TYPE)
9 - OTHER / UNKNOWN

WORK ZONE RELATED
 WORKERS PRESENT
 LAW ENFORCEMENT PRESENT
 ACTIVE SCHOOL ZONE

WORK ZONE TYPE
1 - LANE CLOSURE
2 - LANE SHIFT/CROSSOVER
3 - WORK ON SHOULDER
4 - OR MEDIAN
5 - INTERMITTENT OR MOVING WORK
OTHER

LOCATION OF CRASH IN WORK ZONE
1 - BEFORE THE 1ST WORK ZONE WARNING SIGN
2 - ADVANCE WARNING AREA
3 - TRANSITION AREA
4 - ACTIVITY AREA
5 - TERMINATION AREA

CONTOUR
1

1 - STRAIGHT LEVEL
2 - STRAIGHT GRADE
3 - CURVE LEVEL
4 - CURVE GRADE
9 - OTHER / UNKNOWN

CONDITIONS
1

1 - DRY
2 - WET
3 - SNOW
4 - ICE
5 - SAND, MUD, DIRT, OIL, GRAVEL
6 - WATER (STANDING, MOVING)
7 - SLUSH
9 - OTHER/UNKNOWN

SURFACE
2

1 - CONCRETE
2 - BLACKTOP, BITUMINOUS, ASPHALT
3 - BRICK/BLOCK
4 - SLAG, GRAVEL, STONE
5 - DIRT
9 - OTHER / UNKNOWN

LIGHT CONDITION
2

1 - DAYLIGHT
2 - DAWN/DUSK
3 - DARK - LIGHTED ROADWAY
4 - DARK - ROADWAY NOT LIGHTED
5 - DARK - UNKNOWN ROADWAY LIGHTING
9 - OTHER / UNKNOWN

WEATHER
1

1 - CLEAR
2 - CLOUDY
3 - FOG, SMOG, SMOKE
4 - RAIN
5 - SLEET, HAIL
6 - SNOW
7 - SEVERE CROSSWINDS
8 - BLOWING SAND, SOIL, DIRT, SNOW
9 - FREEZING RAIN OR FREEZING DRIZZLE
99 - OTHER / UNKNOWN

11-20-15-20-23 10-7-09

11-20-15-20-23 10-7-09

11-20-15-20-23 10-7-10

11-20-15-20-23 10-7-59

CRASH REPORTED DATE/TIME

DISPATCH DATE/TIME

ARRIVAL DATE/TIME

SCENE CLEARED DATE/TIME

UNIT # 1 AND UNIT # 2 WERE TRAVELING NORTH NEAR 13100 SR 14 (BROADWAY) . AS A RESULT, THE LEFT FRONT OF UNIT # 1 AND THE RIGHT FRONT OF UNIT # 2 COLLIDED. BOTH UNITS WERE AT TYPE REST UPON ARRIVAL.

NOTE: DUE TO CONFLICTING STATEMENTS AND NO INDEPENDENT WITNESSES, NO CITATIONS WERE ISSUED ON SCENE. SEE OH-2: BWC

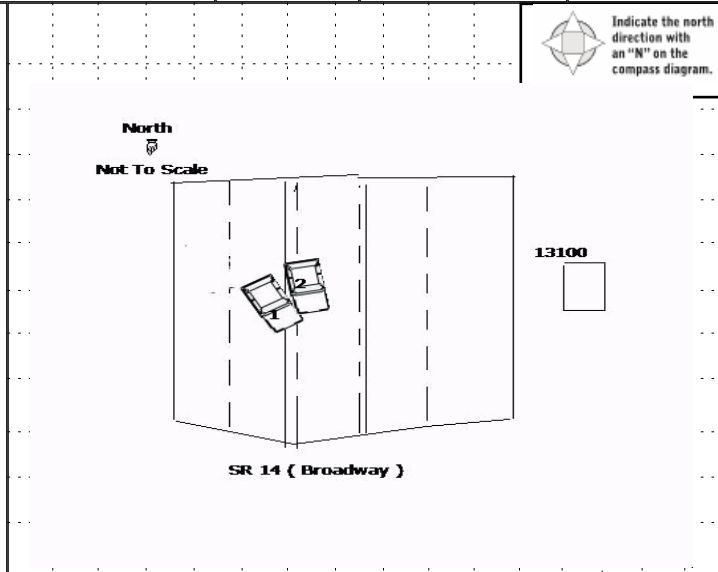

TOTAL TIME ROADWAY CLOSED
0

OTHER INVESTIGATION TIME

TOTAL MINUTES
4 | 9

OFFICER'S NAME *
R. Cramer

OFFICER'S BADGE NUMBER *
0 | 3 | 7

CHECKED BY OFFICER'S NAME *
M. Berdysz

CHECKED BY OFFICER'S BADGE NUMBER *
L | 1 | 4

REPORT TAKEN BY
 POLICE AGENCY
 MOTORIST

SUPPLEMENT
(CORRECTION = ADDITION)

OWNER INFORMATION: UNIT # 01, OWNER NAME: HECKMAN CHARLES MICHAEL, OWNER ADDRESS: 7883 CASTLE ROCK DR NE WARREN OH 44484

DAMAGE: DAMAGE SCALE 4, 1-NONE, 2-MINOR DAMAGE, 3-FUNCTIONAL DAMAGE, 4-DISABLING DAMAGE, 9-UNKNOWN

VEHICLE IDENTIFICATION: LP STATE OH, LICENSE PLATE # JVG8237, VEHICLE IDENTIFICATION # 5YJYJ3E1EB51NF20429Z, VEHICLE YEAR 2022, VEHICLE MAKE Tesla

DAMAGED AREA(S): INDICATE ALL THAT APPLY. Includes diagrams of vehicle front, rear, and side views with damage indicators.

INSURANCE: Erie, POLICY # Q076608629, VEHICLE COLOR BLU, VEHICLE MODEL Other/Unknw, TYPE OF USE: COMMERCIAL

VEHICLE TYPE: 1-PASSENGER CAR, 2-PASSENGER VAN (MINIVAN), 3-SPORT UTILITY VEHICLE, 4-PICK UP, 5-CARGO VAN, 6-VAN (9-15 SEATS)

VEHICLE WEIGHT: 1-≤10K LBS., 2-10,001-26K LBS., 3->26K LBS., OCCUPANTS: 01

VEHICLE DEFECTS: 1-TURN SIGNALS, 2-HEAD LAMPS, 3-TAIL LAMPS, 4-BRAKES, 5-STEERING, 6-TIRE BLOWOUT

ACTION: 1-NON-COLLISION, 2-NON-COLLISION, 3-STRIKING, 4-STUCK, 5-BOTH STRIKING & STRUCK, 9-OTHER / UNKNOWN

CONTRIBUTING CIRCUMSTANCES: 1-NONE, 2-FAILURE TO YIELD, 3-RAN RED LIGHT, 4-RAN STOP SIGN, 5-UNSAFE SPEED, 6-IMPROPER TURN

INITIAL POINT OF CONTACT: 1-NO DAMAGE, 1-12-REFER TO UNIT DIAGRAM, 13-TOP, 14-UNDERCARRIAGE, 15-VEHICLE NOT AT SCENE, 99-UNKNOWN

SEQUENCE OF EVENTS: 1-OVERTURN/ROLLOVER, 2-FIRE/EXPLOSION, 3-IMMERSION, 4-JACKKNIFE, 5-CARGO / EQUIPMENT LOSS OR SHIFT

TRAFFIC: TRAFFICWAY FLOW 2, TRAFFIC CONTROL 6, # OF THROUGH LANES ON ROAD 5

COLLISION WITH FIXED OBJECT - STRUCK: 25-IMPACT ATTENUATOR / CRASH CUSHION, 26-BRIDGE OVERHEAD STRUCTURE, 27-BRIDGE PIER OR ABUTMENT, 28-BRIDGE PARAPET, 29-BRIDGE RAIL, 30-GUARDRAIL FACE

RAIL GRADE CROSSING: 1-NOT INVOLVED, 2-INVOLVED - ACTIVE CROSSING, 3-INVOLVED - PASSIVE CROSSING

UNIT / NON-MOTORIST DIRECTION: FROM 2 TO 6, UNIT SPEED, POSTED SPEED 25, DETECTED SPEED

MOTORIST / NON-MOTORIST

LOCAL REPORT NUMBER
2 0 2 3 3 3 8 1

UNIT # 0 1	NAME: LAST, FIRST, MIDDLE HECKMAN CHARLES MICHAEL		DATE OF BIRTH 0 6 2 9 1 9 7 3		AGE	GENDER M				
ADDRESS: STREET, CITY, STATE, ZIP 7883 CASTLE ROCK DR NE WARREN OH 44484					CONTACT PHONE - INCLUDE AREA CODE					
INJURIES 5	INJURED TAKEN BY	EMS AGENCY (NAME)	INJURED TAKEN TO: MEDICAL FACILITY (NAME, CITY)	SAFETY EQUIPMENT USED 0 4	DOT-COMPLIANT MC HELMET	SEATING POSITION 0 1	AIR BAG USAGE 1	EJECTION 1	TRAPPED 1	
OL STATE	OPERATOR LICENSE NUMBER	OFFENSE CHARGED	LOCAL CODE	OFFENSE DESCRIPTION	CITATION NUMBER					
OL CLASS 4	ENDORSEMENT SELECT UP TO 2	RESTRICTION SELECT UP TO 3	DRIVER DISTRACTED BY 1	ALCOHOL / DRUG SUSPECTED <input type="checkbox"/> ALCOHOL <input type="checkbox"/> MARIJUANA <input type="checkbox"/> OTHER DRUG	CONDITION 1	ALCOHOL TEST STATUS 1 TYPE 1 VALUE	DRUG TEST(S) STATUS 1 TYPE 1 RESULT SELECT UP TO 4			

UNIT # 0 2	NAME: LAST, FIRST, MIDDLE STEWART TEYON ROMAINE		DATE OF BIRTH 0 1 1 9 1 9 9 9		AGE 24	GENDER M				
ADDRESS: STREET, CITY, STATE, ZIP 2826 E 127TH ST CLEVELAND OH 44120					CONTACT PHONE - INCLUDE AREA CODE					
INJURIES 5	INJURED TAKEN BY	EMS AGENCY (NAME)	INJURED TAKEN TO: MEDICAL FACILITY (NAME, CITY)	SAFETY EQUIPMENT USED 0 4	DOT-COMPLIANT MC HELMET	SEATING POSITION 0 1	AIR BAG USAGE 1	EJECTION 1	TRAPPED 1	
OL STATE	OPERATOR LICENSE NUMBER	OFFENSE CHARGED	LOCAL CODE	OFFENSE DESCRIPTION	CITATION NUMBER					
OL CLASS 4	ENDORSEMENT SELECT UP TO 2	RESTRICTION SELECT UP TO 3	DRIVER DISTRACTED BY 1	ALCOHOL / DRUG SUSPECTED <input type="checkbox"/> ALCOHOL <input type="checkbox"/> MARIJUANA <input type="checkbox"/> OTHER DRUG	CONDITION 1	ALCOHOL TEST STATUS 1 TYPE 1 VALUE	DRUG TEST(S) STATUS 1 TYPE 1 RESULT SELECT UP TO 4			

UNIT #	NAME: LAST, FIRST, MIDDLE		DATE OF BIRTH		AGE	GENDER				
ADDRESS: STREET, CITY, STATE, ZIP					CONTACT PHONE - INCLUDE AREA CODE					
INJURIES	INJURED TAKEN BY	EMS AGENCY (NAME)	INJURED TAKEN TO: MEDICAL FACILITY (NAME, CITY)	SAFETY EQUIPMENT USED	DOT-COMPLIANT MC HELMET	SEATING POSITION	AIR BAG USAGE	EJECTION	TRAPPED	
OL STATE	OPERATOR LICENSE NUMBER	OFFENSE CHARGED	LOCAL CODE	OFFENSE DESCRIPTION	CITATION NUMBER					
OL CLASS	ENDORSEMENT SELECT UP TO 2	RESTRICTION SELECT UP TO 3	DRIVER DISTRACTED BY	ALCOHOL / DRUG SUSPECTED ALCOHOL MARIJUANA OTHER DRUG	CONDITION	ALCOHOL TEST STATUS TYPE VALUE	DRUG TEST(S) STATUS TYPE RESULT SELECT UP TO 4			

INJURIES	SEATING POSITION	AIR BAG	OL CLASS	OL RESTRICTION(S)	DRIVER DISTRACTION	TEST STATUS
1 - FATAL	1 - FRONT - LEFT SIDE (MOTORCYCLE DRIVER)	1 - NOT DEPLOYED	1 - CLASS A	1 - ALCOHOL INTERLOCK DEVICE	1 - NOT DISTRACTED	1 - NONE GIVEN
2 - SUSPECTED SERIOUS INJURY	2 - FRONT - MIDDLE	2 - DEPLOYED FRONT	2 - CLASS B	2 - CDL INTRASTATE ONLY	2 - MANUALLY OPERATING AN ELECTRONIC COMMUNICATION DEVICE (TEXTING, TYPING, DIALING)	2 - TEST REFUSED
3 - SUSPECTED MINOR INJURY	3 - FRONT - RIGHT SIDE	3 - DEPLOYED SIDE	3 - CLASS C	3 - CORRECTIVE LENSES	3 - TALKING ON HANDS-FREE COMMUNICATION DEVICE	3 - TEST GIVEN, CONTAMINATED SAMPLE / UNUSABLE
4 - POSSIBLE INJURY	4 - SECOND - LEFT SIDE (MOTORCYCLE PASSENGER)	4 - DEPLOYED BOTH FRONT / SIDE	4 - REGULAR CLASS (OHIO = D)	4 - FARM WAIVER	4 - TALKING ON HAND-HELD COMMUNICATION DEVICE	4 - TEST GIVEN, RESULTS KNOWN
5 - NO APPARENT INJURY	5 - SECOND - MIDDLE	5 - NOT APPLICABLE	5 - M / C MOPED ONLY	5 - EXCEPT CLASS A BUS & CLASS B BUS	5 - OTHER ACTIVITY WITH AN ELECTRONIC DEVICE	5 - TEST GIVEN, RESULTS UNKNOWN
INJURED TAKEN BY		6 - SECOND - RIGHT SIDE	6 - NO VALID OL	6 - EXCEPT CLASS A & CLASS B BUS	6 - PASSENGER	ALCOHOL TEST TYPE
1 - NOT TRANSPORTED / TREATED AT SCENE	7 - THIRD - LEFT SIDE (MOTORCYCLE SIDE CAR)	7 - THIRD - LEFT SIDE (MOTORCYCLE SIDE CAR)	H - HAZMAT	7 - EXCEPT TRACTOR-TRAILER RESTRICTIONS	7 - OTHER DISTRACTION INSIDE THE VEHICLE	1 - NONE
2 - EMS	8 - THIRD - MIDDLE	8 - THIRD - MIDDLE	M - MOTORCYCLE	8 - INTERMEDIATE LICENSE RESTRICTIONS	8 - OTHER DISTRACTIONS OUTSIDE THE VEHICLE	2 - BLOOD
3 - POLICE	9 - THIRD - RIGHT SIDE	9 - THIRD - RIGHT SIDE	P - PASSENGER	9 - LEARNER'S PERMIT RESTRICTIONS	9 - OTHER / UNKNOWN	3 - URINE
9 - OTHER / UNKNOWN	10 - SLEEPER SECTION OF TRUCK CAB	10 - SLEEPER SECTION OF TRUCK CAB	N - TANKER	10 - LIMITED TO DAYLIGHT ONLY		4 - BREATH
SAFETY EQUIPMENT		11 - PASSENGER IN OTHER ENCLOSED CARGO AREA (NON-TRAILING UNIT, BUS, PICK-UP WITH CAP)	Q - MOTOR SCOOTER	11 - LIMITED TO EMPLOYMENT		5 - OTHER
1 - NONE USED	12 - PASSENGER IN UNENCLOSED CARGO AREA	12 - PASSENGER IN UNENCLOSED CARGO AREA	R - THREE-WHEEL MOTORCYCLE	12 - LIMITED - OTHER		DRUG TEST TYPE
2 - SHOULDER BELT ONLY USED	13 - TRAILING UNIT	13 - TRAILING UNIT	S - SCHOOL BUS	13 - MECHANICAL DEVICES (SPECIAL BRAKES, HAND CONTROLS, OR OTHER ADAPTIVE DEVICES)		1 - NONE
3 - LAP BELT ONLY USED	14 - RIDING ON VEHICLE EXTERIOR (NON-TRAILING UNIT)	14 - RIDING ON VEHICLE EXTERIOR (NON-TRAILING UNIT)	T - DOUBLE & TRIPLE TRAILERS	14 - MILITARY VEHICLES ONLY		2 - BLOOD
4 - SHOULDER & LAP BELT USED	15 - NON-MOTORIST	15 - NON-MOTORIST	X - TANKER / HAZMAT	15 - MOTOR VEHICLES WITHOUT AIR BRAKES		3 - URINE
5 - CHILD RESTRAINT SYSTEM - FORWARD FACING	99 - OTHER / UNKNOWN	99 - OTHER / UNKNOWN		16 - OUTSIDE MIRROR	CONDITION	4 - OTHER
6 - CHILD RESTRAINT SYSTEM - REAR FACING				17 - PROSTHETIC AID	1 - APPARENTLY NORMAL	DRUG TEST RESULT(S)
7 - BOOSTER SEAT				18 - OTHER	2 - PHYSICAL IMPAIRMENT	1 - AMPHETAMINES
8 - HELMET USED					3 - EMOTIONAL (E.G. DEPRESSED, ANGRY, DISTURBED)	2 - BARBITURATES
9 - PROTECTIVE PADS USED (ELBOWS, KNEES, ETC.)					4 - ILLNESS	3 - BENZODIAZEPINES
10 - REFLECTIVE CLOTHING					5 - FELL ASLEEP, FAINTED, FATIGUED, ETC.	4 - CANNABINOIDS
11 - LIGHTING - PEDESTRIAN / BICYCLE ONLY					6 - UNDER THE INFLUENCE OF MEDICATIONS / DRUGS / ALCOHOL	5 - COCAINE
99 - OTHER / UNKNOWN					9 - OTHER / UNKNOWN	6 - OPIATES / OPIOIDS
						7 - OTHER
						8 - NEGATIVE RESULTS

LOCAL REPORT NUMBER 20233381	REPORTING AGENCY GARFIELD HEIGHTS	DATE OF CRASH M 12 D 15 Y 2023
IN COUNTY OF 18	CRASH LOCATION SR 14	
<p>SR 14 (Broadway) had a road closure at E 131 due to a prior incident.</p>		
<p>Driver of Unit # 1 stated, he was traveling north and was in the inside lane. After coming to a stop, attempted to turn left, through the middle and southbound lanes. The other vehicle attempted to pass him in the middle lane (on the left).</p>		
<p>Driver of Unit # 2 stated, he was traveling north and was in the inside lane. The other vehicle attempted a U - turn from the outside lane and entered into the inside lane.</p>		
OFFICER'S SIGNATURE X		BADGE NUMBER 037