

TRAFFIC CRASH REPORT

*DENOTES MANDATORY FIELD FOR SUPPLEMENT REPORT

LOCAL REPORT NUMBER *

2 | 0 | 2 | 3 | 3 | 2 | 1 | 0

PHOTOS TAKEN OH-2 OH-3
 SECONDARY CRASH OH-1P OTHER
 Private Property

LOCAL INFORMATION

REPORTING AGENCY NAME *

GARFIELD HEIGHTS

NCIC *
0 | 1 | 8 | 2 | 0

HITSKIP
1 - Solved
2 - Unsolved
2

NUMBER OF UNITS
0 | 2

UNIT IN ERROR
98 - ANIMAL
99 - UNKNOWN
0 | 1

COUNTY *
1 | 8

LOCALITY *
1

LOCATION: CITY, VILLAGE, TOWNSHIP *
GARFIELD HTS

CRASH DATE/TIME *
1 | 1 | 2 | 9 | 2 | 0 | 2 | 3 | 0 | 6 | 2 | 9

CRASH SEVERITY
5

- 1 - FATAL
- 2 - SERIOUS INJURY SUSPECTED
- 3 - MINOR INJURY SUSPECTED
- 4 - INJURY POSSIBLE
- 5 - PROPERTY DAMAGE ONLY

ROUTE TYPE
S | R

ROUTE NUMBER
1 | 4

PREFIX
1 - NORTH
2 - SOUTH
3 - EAST
4 - WEST

LOCATION ROAD NAME
Broadway

ROAD TYPE
R | D

LATITUDE DECIMAL DEGREES
4 | 1 | 4 | 2 | 4 | 3 | 8 | 7

ROUTE TYPE

ROUTE NUMBER

PREFIX
1 - NORTH
2 - SOUTH
3 - EAST
4 - WEST

REFERENCE ROAD NAME (ROAD, MILEPOST, HOUSE #)
14218

ROAD TYPE

LONGITUDE DECIMAL DEGREES
8 | 1 | 5 | 8 | 3 | 1 | 7 | 7

REFERENCE POINT
3

- 1 - INTERSECTION
- 2 - MILE POST
- 3 - HOUSE #

DIRECTION
1 - NORTH
2 - SOUTH
3 - EAST
4 - WEST

ROUTE TYPE
IR - INTERSTATE ROUTE (TP)
US - FEDERAL US ROUTE
SR - STATE ROUTE
CR - NUMBERED COUNTY ROUTE
TR - NUMBERED TOWNSHIP ROUTE

ROAD TYPE
AL - ALLEY
AV - AVENUE
BL - BOULEVARD
CR - CIRCLE
CT - COURT
DR - DRIVE
HE - HEIGHTS
HW - HIGHWAY
LA - LANE
MP - MILEPOST
OV - OVAL
PK - PARKWAY
PI - PIKE
PL - PLACE
RD - ROAD
SQ - SQUARE
ST - STREET
TE - TERRACE
TL - TRAIL
WA - WAY

INTERSECTION RELATED
 WITHIN INTERSECTION OR ON APPROACH
 WITHIN INTERCHANGE AREA

NUMBER OF APPROACHES

DISTANCE
1 - Miles
2 - Feet
3 - Yards

DISTANCE
1 - Miles
2 - Feet
3 - Yards

ROADWAY
 ROADWAY DIVIDED

LOCATION OF FIRST DAMAGE EVENT
1 - ON ROADWAY
2 - ON SHOULDER
3 - IN MEDIAN
4 - ON ROADSIDE
5 - ON GORE
6 - OUTSIDE TRAFFICWAY
7 - ON RAMP
8 - OFF RAMP
9 - CROSSOVER
10 - DRIVEWAY / ALLEY ACCESS
11 - RAILWAY GRADE CROSSING
12 - SHARED USE PATHS OR TRAILS
13 - BIKE LANE
14 - TOLL BOOTH
99 - OTHER / UNKNOWN

MANNER OF CRASH COLLISION/IMPACT
1 - NOT COLLISION BETWEEN TWO MOTOR VEHICLES IN TRANSPORT
2 - REAR-END
3 - HEAD-ON
4 - REAR-TO-REAR
5 - BACKING
6 - ANGLE
7 - SIDESWIPE, SAME DIRECTION
8 - SIDESWIPE, OPPOSITE DIRECTION
9 - OTHER / UNKNOWN

DIRECTION OF TRAVEL
1 - NORTH
2 - SOUTH
3 - EAST
4 - WEST

MEDIAN TYPE
1 - DIVIDED FLUSH MEDIAN (<4 FEET)
2 - DIVIDED FLUSH MEDIAN (24 FEET)
3 - DIVIDED, DEPRESSED MEDIAN
4 - DIVIDED, RAISED MEDIAN (ANY TYPE)
9 - OTHER / UNKNOWN

WORK ZONE RELATED
 WORKERS PRESENT
 LAW ENFORCEMENT PRESENT
 ACTIVE SCHOOL ZONE

WORK ZONE TYPE
1 - LANE CLOSURE
2 - LANE SHIFT/CROSSOVER
3 - WORK ON SHOULDER
OR MEDIAN
4 - INTERMITTENT OR MOVING WORK
5 - OTHER

LOCATION OF CRASH IN WORK ZONE
1 - BEFORE THE 1ST WORK ZONE WARNING SIGN
2 - ADVANCE WARNING AREA
3 - TRANSITION AREA
4 - ACTIVITY AREA
5 - TERMINATION AREA

CONTOUR
1

- 1 - STRAIGHT LEVEL
- 2 - STRAIGHT GRADE
- 3 - CURVE LEVEL
- 4 - CURVE GRADE
- 9 - OTHER / UNKNOWN

CONDITIONS
4

- 1 - DRY
- 2 - WET
- 3 - SNOW
- 4 - ICE
- 5 - SAND, MUD, DIRT, OIL, GRAVEL
- 6 - WATER (STANDING, MOVING)
- 7 - SLUSH
- 9 - OTHER/UNKNOWN

SURFACE
2

- 1 - CONCRETE
- 2 - BLACKTOP, BITUMINOUS, ASPHALT
- 3 - BRICK/BLOCK
- 4 - SLAG, GRAVEL, STONE
- 5 - DIRT
- 9 - OTHER / UNKNOWN

LIGHT CONDITION
3

- 1 - DAYLIGHT
- 2 - DAWN/DUSK
- 3 - DARK - LIGHTED ROADWAY
- 4 - DARK - ROADWAY NOT LIGHTED
- 5 - DARK - UNKNOWN ROADWAY LIGHTING
- 9 - OTHER / UNKNOWN

WEATHER
1

- 1 - CLEAR
- 2 - CLOUDY
- 3 - FOG, SMOG, SMOKE
- 4 - RAIN
- 5 - SLEET, HAIL
- 6 - SNOW
- 7 - SEVERE CROSSWINDS
- 8 - BLOWING SAND, SOIL, DIRT, SNOW
- 9 - FREEZING RAIN OR FREEZING DRIZZLE
- 99 - OTHER / UNKNOWN

UNIT # 1 (NON CONTACT UNIT) WAS TRAVELING NORTH AT 14128 SR (14) BROADWAY IN THE INSIDE LANE. UNIT # 2 WAS TRAVELING SOUTH IN THE OUTSIDE LANE AT 14218 SR 14 (BROADWAY). UNIT # 1 MADE A LEFT TURN TOWARDS A DRIVEWAY INTO THE SOUTHBOUND LANES. AS A RESULT, UNIT # 2 TOOK EVASIVE ACTIONS INTO THE DRIVEWAY ON THE RIGHT. THE RIGHT FRONT COLLIDED WITH A UTILITY POLE AND ROTATED CLOCKWISE BACK ONTO BROADWAY. UNIT # 2 WAS AT FINAL REST FACING EAST AND UNIT # 1 LEFT SCENE.

SEE OH-2

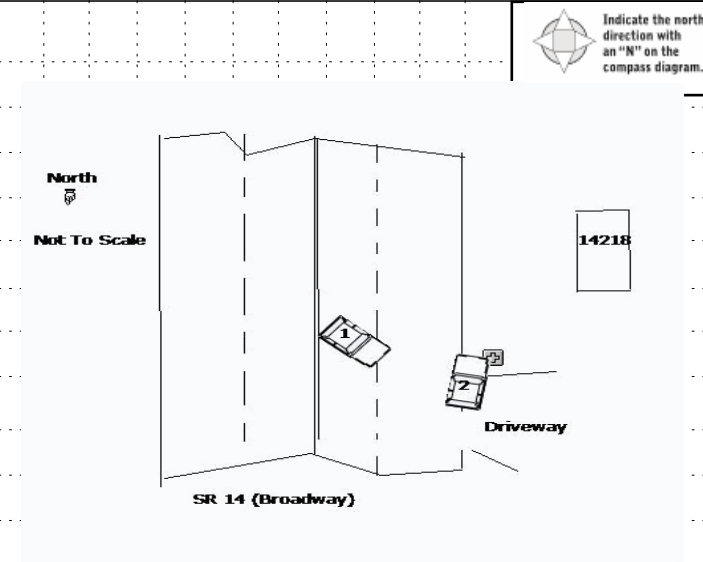

CRASH REPORTED DATE/TIME
1 | 1 | 2 | 9 | 2 | 0 | 2 | 3 | 0 | 6 | 2 | 9

DISPATCH DATE/TIME
1 | 1 | 2 | 9 | 2 | 0 | 2 | 3 | 0 | 6 | 3 | 0

ARRIVAL DATE/TIME
1 | 1 | 2 | 9 | 2 | 0 | 2 | 3 | 0 | 6 | 3 | 5

SCENE CLEARED DATE/TIME
1 | 1 | 2 | 9 | 2 | 0 | 2 | 3 | 0 | 7 | 4 | 8

REPORT TAKEN BY
 POLICE AGENCY
 MOTORIST

TOTAL TIME ROADWAY CLOSED
0

OTHER INVESTIGATION TIME

TOTAL MINUTES
7 | 3

OFFICER'S NAME *
R. Cramer

OFFICER'S BADGE NUMBER *
0 | 3 | 7

CHECKED BY OFFICER'S NAME *
T. Baon

CHECKED BY OFFICER'S BADGE NUMBER *
S | 2 | 0

SUPPLEMENT
(CORRECTION - ADDITION)

OWNER

UNIT # 0 1 OWNER NAME: LAST, FIRST, MIDDLE (Same As Driver) unknown
 OWNER PHONE: INCLUDE AREA CODE (Same As Driver) _____
 OWNER ADDRESS: STREET, CITY, STATE, ZIP (Same As Driver) _____ OH _____
 COMMERCIAL CARRIER: NAME, ADDRESS, CITY, STATE, ZIP _____
 COMMERCIAL CARRIER PHONE: INCLUDE AREA CODE _____

DAMAGE

DAMAGE SCALE

1 - NONE
2 - MINOR DAMAGE
3 - FUNCTIONAL DAMAGE
4 - DISABLING DAMAGE
9 - UNKNOWN

1

VEHICLE

LP STATE O H LICENSE PLATE # unknown VEHICLE IDENTIFICATION # _____ VEHICLE YEAR _____ VEHICLE MAKE _____
 INSURANCE VERIFIED INSURANCE COMPANY _____ INSURANCE POLICY # _____ VEHICLE COLOR _____ VEHICLE MODEL _____
 COMMERCIAL GOVERNMENT IN EMERGENCY RESPONSE US DOT # _____ TOWED BY: COMPANY NAME _____
 INTERLOCK DEVICE EQUIPPED HIT/SKIP UNIT # OCCUPANTS 0 1 VEHICLE WEIGHT GVWR/GCWR HAZARDOUS MATERIAL
 1 - <10K LBS. 2 - 10,001 - 26K LBS. 3 - >26K LBS. MATERIAL RELEASED CLASS # _____ PLACARD ID # _____
 PLACARD

DAMAGED AREA(S)
INDICATE ALL THAT APPLY

- NO DAMAGE [0] - UNDERCARRIAGE [14]
 - TOP [13] - ALL AREAS [15]
 - UNIT NOT AT SCENE [16]

UNIT TYPE 0 3

1 - PASSENGER CAR 7 - MOTORCYCLE 2-WHEELED 12 - GOLF CART 18 - LIMO (LIVERY VEHICLE) 23 - PEDESTRIANSKATER
 2 - PASSENGER VAN (MINIVAN) 8 - MOTORCYCLE 3-WHEELED 13 - SNOWMOBILE 19 - BUS (16+ PASSENGERS) 24 - WHEELCHAIR (ANY TYPE)
 3 - SPORT UTILITY VEHICLE 9 - AUTOCYCLE 14 - SINGLE UNIT TRUCK 20 - OTHER VEHICLE 25 - OTHER NON-MOTORIST
 4 - PICK UP 10 - MOPED OR MOTORIZED BICYCLE 15 - SEMI-TRACTOR 21 - HEAVY EQUIPMENT 26 - BICYCLE
 5 - CARGO VAN 11 - ALL TERRAIN VEHICLE (ATV / UTV) 16 - FARM EQUIPMENT 22 - ANIMAL WITH RIDER OR ANIMAL-DRAWN VEHICLE 27 - TRAIN
 6 - VAN (9-15 SEATS) 17 - MOTORHOME

of TRAILING UNITS _____

WAS VEHICLE OPERATING IN AUTONOMOUS MODE WHEN CRASH OCCURRED? 9 0 - NO AUTOMATION 3 - CONDITIONAL AUTOMATION 9 - UNKNOWN
 1 - YES 2 - NO 9 - OTHER / UNKNOWN 1 - DRIVER ASSISTANCE 4 - HIGH AUTOMATION 5 - FULL AUTOMATION 2 - PARTIAL AUTOMATION

SPECIAL FUNCTION 0 1

1 - NONE 6 - BUS - CHARTER/TOUR 11 - FIRE 16 - FARM 21 - MAIL CARRIER
 2 - TAXI 7 - BUS - INTERCITY 12 - MILITARY 17 - MOWING 22 - OTHER UNKNOWN
 3 - ELECTRONIC RIDE SHARING 8 - BUS - SHUTTLE 13 - POLICE 18 - SNOW REMOVAL 23 - SCHOOL BUS
 4 - SCHOOL TRANSPORT 9 - BUS - OTHER 14 - PUBLIC UTILITY 19 - TOWING 24 - GARBAGE/REFUSE
 5 - BUS-TRANSIT/COMMUTER 10 - AMBULANCE 15 - CONSTRUCTION EQUIPMENT 20 - SAFETY SERVICE PATROL

CARGO BODY TYPE 0 1

1 - NO CARGO BODY TYPE / NOT APPLICABLE 3 - VEHICLE TOWING ANOTHER MOTOR VEHICLE 5 - INTERMODAL CONTAINER CHASSIS 8 - POLE 12 - CONCRETE MIXER
 2 - BUS 4 - LOGGING 6 - CARGO VAN/ENCLOSED BOX 9 - CARGO TANK 13 - AUTO TRANSPORTER
 7 - GRAIN/CHIPS/GRAVEL 10 - FLAT BED 11 - DUMP 14 - GARBAGE/REFUSE 15 - OTHER / UNKNOWN

VEHICLE DEFECTS

1 - TURN SIGNALS 4 - BRAKES 7 - WORN OR SLICK TIRES 9 - MOTOR TROUBLE 99 - OTHER / UNKNOWN
 2 - HEAD LAMPS 5 - STEERING 8 - TRAILER EQUIPMENT DEFECTIVE 10 - DISABLED FROM PRIOR ACCIDENT
 3 - TAIL LAMPS 6 - TIRE BLOWOUT

NON-MOTORIST LOCATION AT IMPACT 1

1 - INTERSECTION - MARKED CROSSWALK 3 - INTERSECTION - OTHER 6 - BICYCLE LANE 9 - MEDIAN/CROSSING ISLAND 12 - FIRST RESPONDER AT INCIDENT SCENE
 2 - INTERSECTION - UNMARKED CROSSWALK 4 - MIDBLOCK - MARKED CROSSWALK 7 - SHOULDER/ROADSIDE 10 - DRIVEWAY ACCESS 99 - OTHER / UNKNOWN
 5 - TRAVEL LANE-OTHER LOCATION 8 - SIDEWALK 11 - SHARED USE PATHS OR TRAILS

ACTION 1 PRE-CRASH ACTION 0 6

1 - NON-CONTACT 1 - STRAIGHT AHEAD 7 - MAKING U-TURN 13 - NEGOTIATING A CURVE 18 - APPROACHING OR LEAVING VEHICLE
 2 - NON-COLLISION 2 - BACKING 8 - ENTERING TRAFFIC LANE 14 - ENTERING OR CROSSING SPECIFIED LOCATION 19 - STANDING
 3 - STRIKING 3 - CHANGING LANES 9 - LEAVING TRAFFIC LANE 15 - WALKING, RUNNING, JOGGING, PLAYING 20 - OTHER NON-MOTORIST
 4 - STRUCK 4 - OVERTAKING/PASSING 10 - PARKED 16 - WORKING 21 - STANDING OUTSIDE DISABLED VEHICLE
 5 - BOTH STRIKING & STRUCK 5 - MAKING RIGHT TURN 11 - SLOWING OR STOPPED IN TRAFFIC 99 - OTHER / UNKNOWN
 9 - OTHER / UNKNOWN 6 - MAKING LEFT TURN 12 - DRIVERLESS 17 - PUSHING VEHICLE

INITIAL POINT OF CONTACT

0 0 0 - NO DAMAGE 14 - UNDERCARRIAGE
 1-12 - REFER TO UNIT DIAGRAM 15 - VEHICLE NOT AT SCENE
 13 - TOP 99 - UNKNOWN

CONTRIBUTING CIRCUMSTANCES 0 2

1 - NONE 7 - LEFT OF CENTER 13 - IMPROPER START FROM A PARKED POSITION 17 - VISION OBSTRUCTION 21 - LYING IN ROADWAY
 2 - FAILURE TO YIELD 8 - FOLLOWING TOO CLOSE/ACDA 14 - STOPPED OR PARKED ILLEGALLY 18 - OPERATING DEFECTIVE EQUIPMENT 22 - NOT DISCERNABLE
 3 - RAN RED LIGHT 9 - IMPROPER LANE CHANGING 15 - SWERVING TO AVOID 19 - LOAD SHIFTING/ FALLING/SPILLING 23 - OPENING DOOR INTO ROADWAY
 4 - RAN STOP SIGN 10 - IMPROPER PASSING 16 - WRONG WAY 20 - IMPROPER CROSSING 99 - OTHER IMPROPER ACTION
 5 - UNSAFE SPEED 11 - DROVE OFF ROAD 12 - IMPROPER BACKING

TRAFFIC

TRAFFICWAY FLOW 2 TRAFFIC CONTROL 6

1 - ONE-WAY 1 - ROUNDABOUT 4 - STOP SIGN
 2 - TWO-WAY 2 - SIGNAL 5 - YIELD SIGN
 3 - FLASHER 6 - NO CONTROL

EVENT(S)

SEQUENCE OF EVENTS

1 9 9

1 - OVERTURN/ROLLOVER 6 - EQUIPMENT FAILURE 11 - CROSS CENTERLINE - OPPOSITE DIRECTION OF TRAVEL 16 - RAILWAY VEHICLE 22 - WORK ZONE MAINTENANCE EQUIPMENT
 2 - FIRE/EXPLOSION 7 - SEPARATION OF UNITS 12 - DOWNHILL RUNAWAY 17 - ANIMAL - FARM 23 - STRUCK BY FALLING, SHIFTING CARGO OR ANYTHING SET IN MOTION BY A MOTOR VEHICLE
 3 - IMMERSION 8 - RAN OFF ROAD RIGHT 13 - OTHER NON-COLLISION 18 - ANIMAL - DEER 24 - OTHER MOVABLE OBJECT
 4 - JACKKNIFE 9 - RAN OFF ROAD LEFT 14 - PEDESTRIAN 19 - ANIMAL - OTHER
 5 - CARGO / EQUIPMENT LOSS OR SHIFT 10 - CROSS MEDIAN 15 - PEDALCYCLE 20 - MOTOR VEHICLE IN TRANSPORT
 21 - PARKED MOTOR VEHICLE

OF THROUGH LANES ON ROAD 4 RAIL GRADE CROSSING 1

1 - NOT INVOLVED
 2 - INVOLVED - ACTIVE CROSSING
 3 - INVOLVED - PASSIVE CROSSING

COLLISION WITH FIXED OBJECT - STRUCK

25 - IMPACT ATTENUATOR / CRASH CUSHION 31 - GUARDRAIL END 37 - TRAFFIC SIGN POST 43 - CURB 50 - WORKZONE MAINTENANCE EQUIPMENT
 26 - BRIDGE OVERHEAD STRUCTURE 32 - PORTABLE BARRIER 38 - OVERHEAD SIGN POST 44 - DITCH 51 - WALL
 27 - BRIDGE PIER OR ABUTMENT 33 - MEDIAN CABLE BARRIER 39 - LIGHT/LUMINARIES SUPPORT 45 - EMBANKMENT 52 - BUILDING
 28 - BRIDGE PARAPET 34 - MEDIAN GUARDRAIL BARRIER 40 - UTILITY POLE 46 - FENCE 53 - TUNNEL
 29 - BRIDGE RAIL 35 - MEDIAN CONCRETE BARRIER 41 - OTHER POST, POLE OR SUPPORT 47 - MAILBOX 54 - OTHER FIXED OBJECT
 30 - GUARDRAIL FACE 36 - MEDIAN OTHER BARRIER 42 - CULVERT 48 - TREE 99 - OTHER / UNKNOWN
 49 - FIRE HYDRANT

FIRST HARMFUL EVENT 1 MOST HARMFUL EVENT 1

UNIT / NON-MOTORIST DIRECTION

FROM 2 TO 4

1 - NORTH 5 - NORTHEAST
 2 - SOUTH 6 - NORTHWEST
 3 - EAST 7 - SOUTHEAST
 4 - WEST 8 - SOUTHWEST
 9 - OTHER / UNKNOWN

UNIT SPEED 0 DETECTED SPEED 3

1 - STATED/ESTIMATED SPEED
 2 - CALCULATED / EDR
 3 - UNDETERMINED

POSTED SPEED 3 5

UNIT # 02 OWNER NAME: LAST, FIRST, MIDDLE (Same As Driver) FLORENCE MONET S
 OWNER PHONE: INCLUDE AREA CODE (Same As Driver)
 OWNER ADDRESS: STREET, CITY, STATE, ZIP (Same As Driver)
12611 THORNHURST AVE GARFIELD HTS OH 44105
 COMMERCIAL CARRIER: NAME, ADDRESS, CITY, STATE, ZIP
 COMMERCIAL CARRIER PHONE: INCLUDE AREA CODE

LOCAL REPORT NUMBER
20233210

LP STATE OH LICENSE PLATE # JAJ3080 VEHICLE IDENTIFICATION # 3V1V1B7A1X71L1M0919650 VEHICLE YEAR 2020 VEHICLE MAKE Volkswagen
 INSURANCE VERIFIED INSURANCE COMPANY Progressive INSURANCE POLICY # 968491419 VEHICLE COLOR WHI VEHICLE MODEL Other/Unknw
 COMMERCIAL GOVERNMENT IN EMERGENCY RESPONSE US DOT # _____ TOWED BY: COMPANY NAME Interstate
 INTERLOCK DEVICE EQUIPPED HIT/SKIP UNIT # OCCUPANTS 02 VEHICLE WEIGHT GVWR/GCWR HAZARDOUS MATERIAL
 1- <10K LBS. 2- 10,001 - 26K LBS. 3- >26K LBS. MATERIAL RELEASED CLASS # _____ PLACARD ID # _____
 PLACARD

DAMAGE
 DAMAGE SCALE
 1- NONE 2- MINOR DAMAGE 3- FUNCTIONAL DAMAGE 4- DISABLING DAMAGE
4 9- UNKNOWN

UNIT TYPE 03 # of TRAILING UNITS _____
 1- PASSENGER CAR 2- PASSENGER VAN (MINIVAN) 3- SPORT UTILITY VEHICLE 4- PICK UP 5- CARGO VAN 6- VAN (9-15 SEATS)
 7- MOTORCYCLE 2-WHEELED 8- MOTORCYCLE 3-WHEELED 9- AUTOCYCLE 10- MOPED OR MOTORIZED BICYCLE 11- ALL TERRAIN VEHICLE (ATV / UTV)
 12- GOLF CART 13- SNOWMOBILE 14- SINGLE UNIT TRUCK 15- SEMI-TRACTOR 16- FARM EQUIPMENT 17- MOTORHOME
 18- LIMO (LIVERY VEHICLE) 19- BUS (16+ PASSENGERS) 20- OTHER VEHICLE 21- HEAVY EQUIPMENT 22- ANIMAL WITH RIDER OR ANIMAL-DRAWN VEHICLE 23- PEDESTRIANSKATER 24- WHEELCHAIR (ANY TYPE) 25- OTHER NON-MOTORIST 26- BICYCLE 27- TRAIN 99- UNKNOWN OR HIT/SKIP
 WAS VEHICLE OPERATING IN AUTONOMOUS MODE WHEN CRASH OCCURRED? 2 0- NO AUTOMATION 1- DRIVER ASSISTANCE 2- PARTIAL AUTOMATION 3- CONDITIONAL AUTOMATION 4- HIGH AUTOMATION 5- FULL AUTOMATION 9- UNKNOWN
 1- YES 2- NO 9- OTHER / UNKNOWN AUTONOMOUS MODE LEVEL

DAMAGED AREA(S)
 INDICATE ALL THAT APPLY

 - NO DAMAGE [0] - UNDERCARRIAGE [14]
 - TOP [13] - ALL AREAS [15]
 - UNIT NOT AT SCENE [16]

SPECIAL FUNCTION 01 CARGO BODY TYPE 01 VEHICLE DEFECTS _____
 1- NONE 2- TAXI 3- ELECTRONIC RIDE SHARING 4- SCHOOL TRANSPORT 5- BUS-TRANSIT/COMMUTER 6- BUS-CHARTER/TOUR 7- BUS-INTERCITY 8- BUS-SHUTTLE 9- BUS-OTHER 10- AMBULANCE 11- FIRE 12- MILITARY 13- POLICE 14- PUBLIC UTILITY 15- CONSTRUCTION EQUIPMENT 16- FARM 17- MOWING 18- SNOW REMOVAL 19- TOWING 20- SAFETY SERVICE PATROL 21- MAIL CARRIER 99- OTHER UNKNOWN
 1- NO CARGO BODY TYPE / NOT APPLICABLE 2- BUS 3- VEHICLE TOWING ANOTHER MOTOR VEHICLE 4- LOGGING 5- INTERMODAL CONTAINER CHASSIS 6- CARGO VAN/ENCLOSED BOX 7- GRAIN/CHIPS/GRAVEL 8- POLE 9- CARGO TANK 10- FLAT BED 11- DUMP 12- CONCRETE MIXER 13- AUTO TRANSPORTER 14- GARBAGE/REFUSE 99- OTHER / UNKNOWN
 1- TURN SIGNALS 2- HEAD LAMPS 3- TAIL LAMPS 4- BRAKES 5- STEERING 6- TIRE BLOWOUT 7- WORN OR SLICK TIRES 8- TRAILER EQUIPMENT DEFECTIVE 9- MOTOR TROUBLE 10- DISABLED FROM PRIOR ACCIDENT 99- OTHER / UNKNOWN

NON-MOTORIST LOCATION AT IMPACT 3 ACTION 01 PRE-CRASH ACTION 01
 1- INTERSECTION - MARKED CROSSWALK 2- INTERSECTION - UNMARKED CROSSWALK 3- STRIKING 4- STRUCK 5- BOTH STRIKING & STRUCK 9- OTHER / UNKNOWN
 1- STRAIGHT AHEAD 2- BACKING 3- CHANGING LANES 4- OVERTAKING/PASSING 5- MAKING RIGHT TURN 6- MAKING LEFT TURN
 7- MAKING U-TURN 8- ENTERING TRAFFIC LANE 9- LEAVING TRAFFIC LANE 10- PARKED 11- SLOWING OR STOPPED IN TRAFFIC 12- DRIVERLESS
 13- NEGOTIATING A CURVE 14- ENTERING OR CROSSING SPECIFIED LOCATION 15- WALKING, RUNNING, JOGGING, PLAYING 16- WORKING 17- PUSHING VEHICLE
 18- APPROACHING OR LEAVING VEHICLE 19- STANDING 20- OTHER NON-MOTORIST 21- STANDING OUTSIDE DISABLED VEHICLE 99- OTHER / UNKNOWN

INITIAL POINT OF CONTACT
01 0- NO DAMAGE 1-12- REFER TO UNIT DIAGRAM 13- TOP 14- UNDERCARRIAGE 15- VEHICLE NOT AT SCENE 99- UNKNOWN

CONTRIBUTING CIRCUMSTANCES 01
 1- NONE 2- FAILURE TO YIELD 3- RAN RED LIGHT 4- RAN STOP SIGN 5- UNSAFE SPEED 6- IMPROPER TURN
 7- LEFT OF CENTER 8- FOLLOWING TOO CLOSE/ACDA 9- IMPROPER LANE CHANGING 10- IMPROPER PASSING 11- DROVE OFF ROAD 12- IMPROPER BACKING
 13- IMPROPER START FROM A PARKED POSITION 14- STOPPED OR PARKED ILLEGALLY 15- SWERVING TO AVOID 16- WRONG WAY
 17- VISION OBSTRUCTION 18- OPERATING DEFECTIVE EQUIPMENT 19- LOAD SHIFTING/ FALLING/SPILLING 20- IMPROPER CROSSING
 21- LYING IN ROADWAY 22- NOT DISCERNABLE 23- OPENING DOOR INTO ROADWAY 99- OTHER IMPROPER ACTION

TRAFFIC
 TRAFFICWAY FLOW 2 TRAFFIC CONTROL 6
 1- ONE-WAY 2- TWO-WAY 1- ROUNDABOUT 2- SIGNAL 3- FLASHER 4- STOP SIGN 5- YIELD SIGN 6- NO CONTROL
 # OF THROUGH LANES ON ROAD 4 RAIL GRADE CROSSING 1
 1- NOT INVOLVED 2- INVOLVED - ACTIVE CROSSING 3- INVOLVED - PASSIVE CROSSING

SEQUENCE OF EVENTS
 1 08 1- OVERTURN/ROLLOVER 2- FIRE/EXPLOSION 3- IMMERSION 4- JACKKNIFE 5- CARGO / EQUIPMENT LOSS OR SHIFT
 6- EQUIPMENT FAILURE 7- SEPARATION OF UNITS 8- RAN OFF ROAD RIGHT 9- RAN OFF ROAD LEFT 10- CROSS MEDIAN
 11- CROSS CENTERLINE - OPPOSITE DIRECTION OF TRAVEL 12- DOWNHILL RUNAWAY 13- OTHER NON-COLLISION 14- PEDESTRIAN 15- PEDALCYCLE
 16- RAILWAY VEHICLE 17- ANIMAL - FARM 18- ANIMAL - DEER 19- ANIMAL - OTHER 20- MOTOR VEHICLE IN TRANSPORT 21- PARKED MOTOR VEHICLE
 22- WORK ZONE MAINTENANCE EQUIPMENT 23- STRUCK BY FALLING, SHIFTING CARGO OR ANYTHING SET IN MOTION BY A MOTOR VEHICLE 24- OTHER MOVABLE OBJECT
 COLLISION WITH FIXED OBJECT - STRUCK
 25- IMPACT ATTENUATOR / CRASH CUSHION 26- BRIDGE OVERHEAD STRUCTURE 27- BRIDGE PIER OR ABUTMENT 28- BRIDGE PARAPET 29- BRIDGE RAIL 30- GUARDRAIL FACE
 31- GUARDRAIL END 32- PORTABLE BARRIER 33- MEDIAN CABLE BARRIER 34- MEDIAN GUARDRAIL BARRIER 35- MEDIAN CONCRETE BARRIER 36- MEDIAN OTHER BARRIER
 37- TRAFFIC SIGN POST 38- OVERHEAD SIGN POST 39- LIGHT/LUMINARIES SUPPORT 40- UTILITY POLE 41- OTHER POST, POLE OR SUPPORT 42- CULVERT
 43- CURB 44- DITCH 45- EMBANKMENT 46- FENCE 47- MAILBOX 48- TREE 49- FIRE HYDRANT
 50- WORKZONE MAINTENANCE EQUIPMENT 51- WALL 52- BUILDING 53- TUNNEL 54- OTHER FIXED OBJECT 99- OTHER / UNKNOWN
 FIRST HARMFUL EVENT 1 MOST HARMFUL EVENT 2

UNIT / NON-MOTORIST DIRECTION
 FROM 1 TO 2
 1- NORTH 2- SOUTH 3- EAST 4- WEST 5- NORTHEAST 6- NORTHWEST 7- SOUTHEAST 8- SOUTHWEST 9- OTHER / UNKNOWN
 UNIT SPEED _____ DETECTED SPEED 3
 1- STATED/ESTIMATED SPEED 2- CALCULATED / EDR 3- UNDETERMINED
 POSTED SPEED 35

MOTORIST / NON-MOTORIST

LOCAL REPORT NUMBER
2 0 2 3 3 2 1 0

UNIT # 0 1	NAME: LAST, FIRST, MIDDLE unknown	DATE OF BIRTH	AGE	GENDER F
ADDRESS: STREET, CITY, STATE, ZIP OH		CONTACT PHONE - INCLUDE AREA CODE		
INJURIES 5	INJURED TAKEN BY	EMS AGENCY (NAME)	INJURED TAKEN TO: MEDICAL FACILITY (NAME, CITY)	SAFETY EQUIPMENT USED 9 9
OL STATE	OPERATOR LICENSE NUMBER	OFFENSE CHARGED	LOCAL CODE	OFFENSE DESCRIPTION
OL CLASS	ENDORSEMENT SELECT UP TO 2	RESTRICTION SELECT UP TO 3	DRIVER DISTRACTED BY 9	ALCOHOL / DRUG SUSPECTED <input type="checkbox"/> ALCOHOL <input type="checkbox"/> MARIJUANA <input type="checkbox"/> OTHER DRUG
CONDITION 9	STATUS 1	ALCOHOL TEST TYPE 1	VALUE	STATUS 1
TRAPPED		SEATING POSITION 0 1	AIR BAG USAGE 9	EJECTION 1
CITATION NUMBER		DOT-COMPLIANT MC HELMET		

UNIT # 0 2	NAME: LAST, FIRST, MIDDLE FLORENCE MONET S	DATE OF BIRTH 1 1 1 0 1 9 9 3	AGE 3 0	GENDER F
ADDRESS: STREET, CITY, STATE, ZIP 12611 THORNHURST AVE GARFIELD HTS OH 44105		CONTACT PHONE - INCLUDE AREA CODE		
INJURIES 5	INJURED TAKEN BY	EMS AGENCY (NAME)	INJURED TAKEN TO: MEDICAL FACILITY (NAME, CITY)	SAFETY EQUIPMENT USED 0 4
OL STATE	OPERATOR LICENSE NUMBER	OFFENSE CHARGED	LOCAL CODE	OFFENSE DESCRIPTION
OL CLASS 4	ENDORSEMENT SELECT UP TO 2	RESTRICTION SELECT UP TO 3	DRIVER DISTRACTED BY 1	ALCOHOL / DRUG SUSPECTED <input type="checkbox"/> ALCOHOL <input type="checkbox"/> MARIJUANA <input type="checkbox"/> OTHER DRUG
CONDITION 1	STATUS 1	ALCOHOL TEST TYPE 1	VALUE	STATUS 1
TRAPPED		SEATING POSITION 0 1	AIR BAG USAGE 4	EJECTION 1
CITATION NUMBER		DOT-COMPLIANT MC HELMET		

UNIT #	NAME: LAST, FIRST, MIDDLE	DATE OF BIRTH	AGE	GENDER
ADDRESS: STREET, CITY, STATE, ZIP		CONTACT PHONE - INCLUDE AREA CODE		
INJURIES	INJURED TAKEN BY	EMS AGENCY (NAME)	INJURED TAKEN TO: MEDICAL FACILITY (NAME, CITY)	SAFETY EQUIPMENT USED
OL STATE	OPERATOR LICENSE NUMBER	OFFENSE CHARGED	LOCAL CODE	OFFENSE DESCRIPTION
OL CLASS	ENDORSEMENT SELECT UP TO 2	RESTRICTION SELECT UP TO 3	DRIVER DISTRACTED BY	ALCOHOL / DRUG SUSPECTED
CONDITION	STATUS	ALCOHOL TEST TYPE	VALUE	STATUS
TRAPPED		SEATING POSITION	AIR BAG USAGE	EJECTION
CITATION NUMBER		DOT-COMPLIANT MC HELMET		

INJURIES	SEATING POSITION	AIR BAG	OL CLASS	OL RESTRICTION(S)	DRIVER DISTRACTION	TEST STATUS
1 - FATAL	1 - FRONT - LEFT SIDE (MOTORCYCLE DRIVER)	1 - NOT DEPLOYED	1 - CLASS A	1 - ALCOHOL INTERLOCK DEVICE	1 - NOT DISTRACTED	1 - NONE GIVEN
2 - SUSPECTED SERIOUS INJURY	2 - FRONT - MIDDLE	2 - DEPLOYED FRONT	2 - CLASS B	2 - CDL INTRASTATE ONLY	2 - MANUALLY OPERATING AN ELECTRONIC COMMUNICATION DEVICE (TEXTING, TYPING, DIALING)	2 - TEST REFUSED
3 - SUSPECTED MINOR INJURY	3 - FRONT - RIGHT SIDE	3 - DEPLOYED SIDE	3 - CLASS C	3 - CORRECTIVE LENSES	3 - TALKING ON HANDS-FREE COMMUNICATION DEVICE	3 - TEST GIVEN, CONTAMINATED SAMPLE / UNUSABLE
4 - POSSIBLE INJURY	4 - SECOND - LEFT SIDE (MOTORCYCLE PASSENGER)	4 - DEPLOYED BOTH FRONT / SIDE	4 - REGULAR CLASS (OHIO = D)	4 - FARM WAIVER	4 - TALKING ON HAND-HELD COMMUNICATION DEVICE	4 - TEST GIVEN, RESULTS KNOWN
5 - NO APPARENT INJURY	5 - SECOND - MIDDLE	5 - NOT APPLICABLE	5 - M / C MOPED ONLY	5 - EXCEPT CLASS A BUS & CLASS B BUS	5 - OTHER ACTIVITY WITH AN ELECTRONIC DEVICE	5 - TEST GIVEN, RESULTS UNKNOWN
INJURED TAKEN BY		6 - SECOND - RIGHT SIDE	6 - NO VALID OL	6 - EXCEPT CLASS A & CLASS B BUS	6 - PASSENGER	ALCOHOL TEST TYPE
1 - NOT TRANSPORTED / TREATED AT SCENE	7 - THIRD - LEFT SIDE (MOTORCYCLE SIDE CAR)	9 - DEPLOYMENT UNKNOWN	H - HAZMAT	7 - EXCEPT TRACTOR-TRAILER	7 - OTHER DISTRACTION INSIDE THE VEHICLE	1 - NONE
2 - EMS	8 - THIRD - MIDDLE	EJECTION	M - MOTORCYCLE	8 - INTERMEDIATE LICENSE RESTRICTIONS	8 - OTHER DISTRACTIONS OUTSIDE THE VEHICLE	2 - BLOOD
3 - POLICE	9 - THIRD - RIGHT SIDE	1 - NOT EJECTED	P - PASSENGER	9 - LEARNER'S PERMIT RESTRICTIONS	9 - OTHER / UNKNOWN	3 - URINE
9 - OTHER / UNKNOWN	10 - SLEEPER SECTION OF TRUCK CAB	2 - PARTIALLY EJECTED	N - TANKER	10 - LIMITED TO DAYLIGHT ONLY		4 - BREATH
SAFETY EQUIPMENT		3 - TOTALLY EJECTED	Q - MOTOR SCOOTER	11 - LIMITED TO EMPLOYMENT		5 - OTHER
1 - NONE USED	12 - PASSENGER IN UNENCLOSED CARGO AREA	4 - NOT APPLICABLE	R - THREE-WHEEL MOTORCYCLE	12 - LIMITED - OTHER		DRUG TEST TYPE
2 - SHOULDER BELT ONLY USED	13 - TRAILING UNIT	TRAPPED	S - SCHOOL BUS	13 - MECHANICAL DEVICES (SPECIAL BRAKES, HAND CONTROLS, OR OTHER ADAPTIVE DEVICES)		1 - NONE
3 - LAP BELT ONLY USED	14 - RIDING ON VEHICLE EXTERIOR (NON-TRAILING UNIT)	1 - NOT TRAPPED	T - DOUBLE & TRIPLE TRAILERS	14 - MILITARY VEHICLES ONLY		2 - BLOOD
4 - SHOULDER & LAP BELT USED	15 - NON-MOTORIST	2 - EXTRICATED BY MECHANICAL MEANS	X - TANKER / HAZMAT	15 - MOTOR VEHICLES WITHOUT AIR BRAKES		3 - URINE
5 - CHILD RESTRAINT SYSTEM - FORWARD FACING	99 - OTHER / UNKNOWN	3 - FREED BY NON-MECHANICAL MEANS		16 - OUTSIDE MIRROR	CONDITION	4 - OTHER
6 - CHILD RESTRAINT SYSTEM - REAR FACING				17 - PROSTHETIC AID	1 - APPARENTLY NORMAL	
7 - BOOSTER SEAT				18 - OTHER	2 - PHYSICAL IMPAIRMENT	
8 - HELMET USED					3 - EMOTIONAL (E.G. DEPRESSED, ANGRY, DISTURBED)	
9 - PROTECTIVE PADS USED (ELBOWS, KNEES, ETC.)					4 - ILLNESS	
10 - REFLECTIVE CLOTHING					5 - FELL ASLEEP, FAINTED, FATIGUED, ETC.	
11 - LIGHTING - PEDESTRIAN / BICYCLE ONLY					6 - UNDER THE INFLUENCE OF MEDICATIONS / DRUGS / ALCOHOL	
99 - OTHER / UNKNOWN					9 - OTHER / UNKNOWN	
			GENDER			DRUG TEST RESULT(S)
			F - FEMALE			1 - AMPHETAMINES
			M - MALE			2 - BARBITURATES
			U - OTHER/UNKNOWN			3 - BENZODIAZEPINES
						4 - CANNABINOIDS
						5 - COCAINE
						6 - OPIATES / OPIOIDS
						7 - OTHER
						8 - NEGATIVE RESULTS

OCCUPANT / WITNESS ADDENDUM

LOCAL REPORT NUMBER									
2	0	2	3	3	2	1	0		

OCCUPANT	UNIT #	NAME: LAST, FIRST, MIDDLE				DATE OF BIRTH				AGE	GENDER
	2	Miller Azar'rie				0 9 1 1 2 0 1 1				1 2	F
	ADDRESS: STREET, CITY, STATE, ZIP					CONTACT PHONE - INCLUDE AREA CODE					
12611 Thornhurst GARFIELD HTS OH 44125											
INJURIES	INJURED TAKEN BY	EMS AGENCY (NAME)	INJURED TAKEN TO: MEDICAL FACILITY (NAME, CITY)	SAFETY EQUIPMENT USED		<input type="checkbox"/> DOT-COMPLIANT MC HELMET	SEATING POSITION	AIR BAG USAGE	EJECTION	TRAPPED	
5				0 1		<input type="checkbox"/>	0 6	1	1	1	
UNIT #	NAME: LAST, FIRST, MIDDLE				DATE OF BIRTH				AGE	GENDER	
ADDRESS: STREET, CITY, STATE, ZIP					CONTACT PHONE - INCLUDE AREA CODE						
INJURIES	INJURED TAKEN BY	EMS AGENCY (NAME)	INJURED TAKEN TO: MEDICAL FACILITY (NAME, CITY)	SAFETY EQUIPMENT USED		DOT-COMPLIANT MC HELMET	SEATING POSITION	AIR BAG USAGE	EJECTION	TRAPPED	

INJURIES 1 - FATAL 2 - SUSPECTED SERIOUS INJURY 3 - SUSPECTED MINOR INJURY 4 - POSSIBLE INJURY 5 - NO APPARENT INJURY	SAFETY EQUIPMENT USED 1 - NONE USED - VEHICLE OCCUPANT 2 - SHOULDER BELT ONLY USED 3 - LAP BELT ONLY USED 4 - SHOULDER & LAP BELT USED 5 - CHILD RESTRAINT SYSTEM - FORWARD FACING 6 - CHILD RESTRAINT SYSTEM - REAR FACING 7 - BOOSTER SEAT 8 - HELMET USED 9 - PROTECTIVE PADS USED (ELBOWS, KNEES, ETC.) 10 - REFLECTIVE CLOTHING 11 - LIGHTING - PEDESTRIAN / BICYCLE ONLY 99 - OTHER / UNKNOWN	SEATING POSITION 1 - FRONT - LEFT SIDE (MOTORCYCLE DRIVER) 2 - FRONT - MIDDLE 3 - FRONT - RIGHT SIDE 4 - SECOND - LEFT SIDE (MOTORCYCLE PASSENGER) 5 - SECOND - MIDDLE 6 - SECOND - RIGHT SIDE 7 - THIRD - LEFT SIDE (MOTORCYCLE SIDE CAR) 8 - THIRD - MIDDLE 9 - THIRD - RIGHT SIDE 10 - SLEEPER SECTION OF TRUCK CAB 11 - PASSENGER IN OTHER ENCLOSED CARGO AREA (NON-TRAILING UNIT, BUS, PICK-UP WITH CAP) 12 - PASSENGER IN UNENCLOSED CARGO AREA 13 - TRAILING UNIT 14 - RIDING ON VEHICLE EXTERIOR (NON-TRAILING UNIT) 15 - NON-MOTORIST 99 - OTHER / UNKNOWN	AIR BAG USAGE 1 - NOT DEPLOYED 2 - DEPLOYED FRONT 3 - DEPLOYED SIDE 4 - DEPLOYED BOTH FRONT/SIDE 5 - NOT APPLICABLE 9 - DEPLOYMENT UNKNOWN
INJURED TAKEN BY 1 - NOT TRANSPORTED / TREATED AT SCENE 2 - EMS 3 - POLICE 9 - OTHER / UNKNOWN		EJECTION 1 - NOT EJECTED 2 - PARTIALLY EJECTED 3 - TOTALLY EJECTED 4 - NOT APPLICABLE	
GENDER F - FEMALE M - MALE U - OTHER/UNKNOWN		TRAPPED 1 - NOT TRAPPED 2 - EXTRICATED BY MECHANICAL MEANS 3 - FREED BY NON-MECHANICAL MEANS	

WITNESS	NAME: LAST, FIRST, MIDDLE	DATE OF BIRTH	AGE	GENDER
	ADDRESS: STREET, CITY, STATE, ZIP	CONTACT PHONE - INCLUDE AREA CODE		
WITNESS	NAME: LAST, FIRST, MIDDLE	DATE OF BIRTH	AGE	GENDER
	ADDRESS: STREET, CITY, STATE, ZIP	CONTACT PHONE - INCLUDE AREA CODE		
WITNESS	NAME: LAST, FIRST, MIDDLE	DATE OF BIRTH	AGE	GENDER
	ADDRESS: STREET, CITY, STATE, ZIP	CONTACT PHONE - INCLUDE AREA CODE		

LOCAL REPORT NUMBER 20233210	REPORTING AGENCY GARFIELD HEIGHTS	DATE OF CRASH M 11 D 29 Y 2023
IN COUNTY OF 18	CRASH LOCATION SR 14	
<p>Note: Possible video surveillance at 14218 Broadway</p> <p>The Illuminating Company</p> <p>11517 Fruitland Ct</p> <p>Cleveland Oh 44102</p> <p>800 633 4766</p> <p>Damaged pole #813124</p>		
OFFICER'S SIGNATURE X		BADGE NUMBER 037