

TRAFFIC CRASH REPORT

*DENOTES MANDATORY FIELD FOR SUPPLEMENT REPORT

LOCAL REPORT NUMBER *

2 | 0 | 2 | 3 | 3 | 1 | 5 | 2

- PHOTOS TAKEN OH-2 OH-3
 SECONDARY CRASH OH-1P OTHER
 Private Property

LOCAL INFORMATION

REPORTING AGENCY NAME *

GARFIELD HEIGHTS

NCIC *
0 | 1 | 8 | 2 | 0

HITSKIP
1 - Solved
2 - Unsolved

NUMBER OF UNITS
0 | 1

UNIT IN ERROR
98 - ANIMAL
99 - UNKNOWN

COUNTY *
1 | 8

LOCALITY *
1

LOCATION: CITY, VILLAGE, TOWNSHIP *
GARFIELD HEIGHTS

CRASH DATE/TIME *
1 | 1 | 2 | 3 | 2 | 0 | 2 | 3 | 0 | 4 | 1 | 7

CRASH SEVERITY
5

1 - FATAL
2 - SERIOUS INJURY SUSPECTED
3 - MINOR INJURY SUSPECTED
4 - INJURY POSSIBLE
5 - PROPERTY DAMAGE ONLY

ROUTE TYPE
ROUTE NUMBER

PREFIX
1 - NORTH
2 - SOUTH
3 - EAST
4 - WEST

LOCATION ROAD NAME
EAST 131

ROAD TYPE
S | T

LATITUDE DECIMAL DEGREES
4 | 1 | . | 4 | 3 | 5 | 1 | 6

ROUTE TYPE
ROUTE NUMBER

PREFIX
1 - NORTH
2 - SOUTH
3 - EAST
4 - WEST

REFERENCE ROAD NAME (ROAD, MILEPOST, HOUSE #)
4578 EAST 131

ROAD TYPE

LONGITUDE DECIMAL DEGREES
- 8 | 1 | . | 5 | 9 | 2 | 1 | 1

REFERENCE POINT
1 - INTERSECTION
2 - MILE POST
3 - HOUSE #

3

DIRECTION
1 - NORTH
2 - SOUTH
3 - EAST
4 - WEST

3

ROUTE TYPE
IR - INTERSTATE ROUTE (TP)
US - FEDERAL US ROUTE
SR - STATE ROUTE
CR - NUMBERED COUNTY ROUTE
TR - NUMBERED TOWNSHIP ROUTE

ROAD TYPE
AL - ALLEY
AV - AVENUE
BL - BOULEVARD
CR - CIRCLE
CT - COURT
DR - DRIVE
HE - HEIGHTS
HW - HIGHWAY
LA - LANE
LA - LANE
MP - MILEPOST
OV - OVAL
PK - PARKWAY
PI - PIKE
PL - PLACE
RD - ROAD
SQ - SQUARE
ST - STREET
TE - TERRACE
TL - TRAIL
WA - WAY

INTERSECTION RELATED
 WITHIN INTERSECTION OR ON APPROACH
 WITHIN INTERCHANGE AREA

NUMBER OF APPROACHES

DISTANCE
1 - Miles
2 - Feet
3 - Yards

5 | 0

DISTANCE
1 - Miles
2 - Feet
3 - Yards

2

ROADWAY
 ROADWAY DIVIDED

LOCATION - FIRST AND SECOND EVENT
1 - ON ROADWAY
2 - ON SHOULDER
3 - IN MEDIAN
4 - ON ROADSIDE
5 - ON GORE
6 - OUTSIDE
7 - ON RAMP
8 - OFF RAMP
9 - CROSSOVER
10 - DRIVEWAY / ALLEY ACCESS
11 - RAILWAY GRADE CROSSING
12 - SHARED USE PATHS OR TRAILS
13 - BIKE LANE
14 - TOLL BOOTH
99 - OTHER / UNKNOWN

0 | 1

MANNER OF CRASH COLLISION/IMPACT
1 - NOT COLLISION BETWEEN TWO MOTOR VEHICLES IN TRANSPORT
2 - REAR-END
3 - HEAD-ON
4 - REAR-TO-REAR
5 - BACKING
6 - ANGLE
7 - SIDESWIPE, SAME DIRECTION
8 - SIDESWIPE, OPPOSITE DIRECTION
9 - OTHER / UNKNOWN

1

DIRECTION OF TRAVEL
1 - NORTH
2 - SOUTH
3 - EAST
4 - WEST

MEDIAN TYPE
1 - DIVIDED FLUSH MEDIAN (<4 FEET)
2 - DIVIDED FLUSH MEDIAN (24 FEET)
3 - DIVIDED, DEPRESSIONED MEDIAN
4 - DIVIDED, RAISED MEDIAN (ANY TYPE)
9 - OTHER / UNKNOWN

- WORK ZONE RELATED
 WORKERS PRESENT
 LAW ENFORCEMENT PRESENT
 ACTIVE SCHOOL ZONE

WORK ZONE TYPE
1 - LANE CLOSURE
2 - LANE SHIFT/CROSSOVER
3 - WORK ON SHOULDER
OR MEDIAN
4 - INTERMITTENT OR MOVING WORK
5 - OTHER

LOCATION OF CRASH IN WORK ZONE
1 - BEFORE THE 1ST WORK ZONE WARNING SIGN
2 - ADVANCE WARNING AREA
3 - TRANSITION AREA
4 - ACTIVITY AREA
5 - TERMINATION AREA

CONTOUR
1

1 - STRAIGHT LEVEL
2 - STRAIGHT GRADE
3 - CURVE LEVEL
4 - CURVE GRADE
9 - OTHER / UNKNOWN

CONDITIONS
2

1 - DRY
2 - WET
3 - SNOW
4 - ICE
5 - SAND, MUD, DIRT, OIL, GRAVEL
6 - WATER (STANDING, MOVING)
7 - SLUSH
9 - OTHER/UNKNOWN

SURFACE
2

1 - CONCRETE
2 - BLACKTOP, BITUMINOUS, ASPHALT
3 - BRICK/BLOCK
4 - SLAG, GRAVEL, STONE
5 - DIRT
9 - OTHER / UNKNOWN

LIGHT CONDITION
3

1 - DAYLIGHT
2 - DAWN/DUSK
3 - DARK - LIGHTED ROADWAY
4 - DARK - ROADWAY NOT LIGHTED
5 - DARK - UNKNOWN ROADWAY LIGHTING
9 - OTHER / UNKNOWN

WEATHER
1

1 - CLEAR
2 - CLOUDY
3 - FOG, SMOG, SMOKE
4 - RAIN
5 - SLEET, HAIL
6 - SNOW
7 - SEVERE CROSSWINDS
8 - BLOWING SAND, SOIL, DIRT, SNOW
9 - FREEZING RAIN OR FREEZING DRIZZLE
99 - OTHER / UNKNOWN

NARRATIVE

UNIT ONE STATED SHE WAS TRAVELING N/B ON EAST 131 WHEN A UNKNOWN VEHICLE CUT IN FRONT OF HER AT ALVIN AVE. UNIT 1 TRIED TO SWERVE TO AVOID STRIKING THE OTHER VEHICLE AND LOST CONTROL.. UNIT 1 STRUCK A POLE CAUSING MINIMAL DAMAGE.. UNIT ONE WAS CITED FOR FAILURE TO CONTROL.

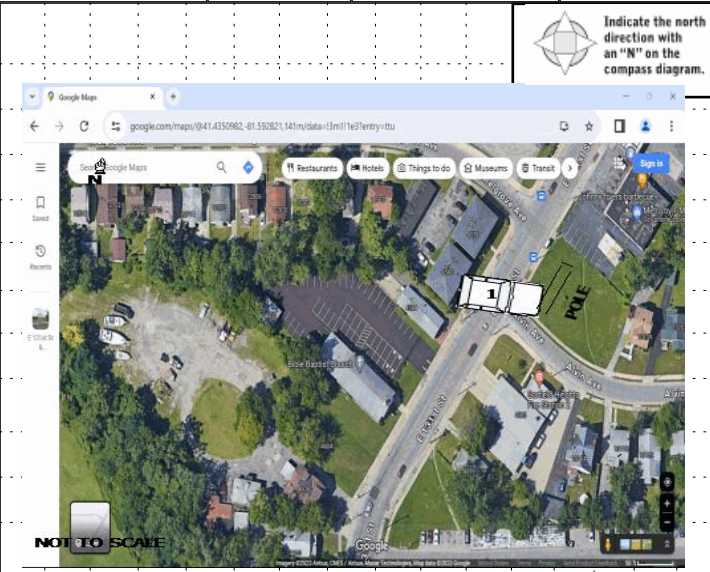

CRASH REPORTED DATE/TIME
1 | 1 | 2 | 3 | 2 | 0 | 2 | 3 | 0 | 4 | 1 | 7

DISPATCH DATE/TIME
1 | 1 | 2 | 3 | 2 | 0 | 2 | 3 | 0 | 4 | 1 | 8

ARRIVAL DATE/TIME
1 | 1 | 2 | 3 | 2 | 0 | 2 | 3 | 0 | 4 | 2 | 0

SCENE CLEARED DATE/TIME
1 | 1 | 2 | 3 | 2 | 0 | 2 | 3 | 0 | 4 | 4 | 0

REPORT TAKEN BY
 POLICE AGENCY
 MOTORIST

TOTAL TIME ROADWAY CLOSED
0

OTHER INVESTIGATION TIME
0

TOTAL MINUTES
2 | 0

OFFICER'S NAME *
Y. Ihiri

OFFICER'S BADGE NUMBER*
0 | 3 | 8

CHECKED BY OFFICER'S NAME*
V. Walker

CHECKED BY OFFICER'S BADGE NUMBER*
L | 1 | 5

SUPPLEMENT
(CORRECTION - ADDITION)

UNIT # 01 OWNER NAME: LAST, FIRST, MIDDLE (Same As Driver)
STEWART NICHOLE NEHRUOANA
 OWNER PHONE: INCLUDE AREA CODE (Same As Driver)
 OWNER ADDRESS: STREET, CITY, STATE, ZIP (Same As Driver)
12917 HOY AVE CLEVELAND OH 44105
 COMMERCIAL CARRIER: NAME, ADDRESS, CITY, STATE, ZIP
 COMMERCIAL CARRIER PHONE: INCLUDE AREA CODE

LP STATE OH LICENSE PLATE # R283874 VEHICLE IDENTIFICATION # 5N1A1EMV4GC821605 VEHICLE YEAR 2016 VEHICLE MAKE Nissan
 INSURANCE VERIFIED INSURANCE COMPANY FOUNDERS INSURANCE POLICY # ITOH307925 VEHICLE COLOR RED VEHICLE MODEL Rogue
 COMMERCIAL GOVERNMENT IN EMERGENCY RESPONSE US DOT # _____ TOWED BY: COMPANY NAME INTERSTATE
 INTERLOCK DEVICE EQUIPPED HIT/SKIP UNIT # OCCUPANTS 01 VEHICLE WEIGHT GVWR/GVWR HAZARDOUS MATERIAL
 1- <10K LBS. 2- 10,001 - 26K LBS. 3- >26K LBS. MATERIAL RELEASED CLASS # _____ PLACARD ID # _____
 PLACARD

UNIT TYPE 01 # of TRAILING UNITS _____
 1 - PASSENGER CAR 7 - MOTORCYCLE 2-WHEELED 12 - GOLF CART 18 - LIMO (LIVERY VEHICLE) 23 - PEDESTRIAN SKATER
 2 - PASSENGER VAN (MINIVAN) 8 - MOTORCYCLE 3-WHEELED 13 - SNOWMOBILE 19 - BUS (16+ PASSENGERS) 24 - WHEELCHAIR (ANY TYPE)
 3 - SPORT UTILITY VEHICLE 9 - AUTOCYCLE 14 - SINGLE UNIT TRUCK 20 - OTHER VEHICLE 25 - OTHER NON-MOTORIST
 4 - PICK UP 10 - MOPED OR MOTORIZED BICYCLE 15 - SEMI-TRACTOR 21 - HEAVY EQUIPMENT 26 - BICYCLE
 5 - CARGO VAN 11 - ALL TERRAIN VEHICLE (ATV / UTV) 16 - FARM EQUIPMENT 22 - ANIMAL WITH RIDER OR ANIMAL-DRAWN VEHICLE 27 - TRAIN
 6 - VAN (9-15 SEATS) 17 - MOTORHOME 16 - FARM EQUIPMENT 99 - UNKNOWN OR HIT/SKIP

WAS VEHICLE OPERATING IN AUTONOMOUS MODE WHEN CRASH OCCURRED? 2 AUTONOMOUS MODE LEVEL 0
 1 - YES 2 - NO 9 - OTHER / UNKNOWN
 0 - NO AUTOMATION 1 - DRIVER ASSISTANCE 3 - CONDITIONAL AUTOMATION 9 - UNKNOWN
 1 - DRIVER ASSISTANCE 2 - PARTIAL AUTOMATION 4 - HIGH AUTOMATION 5 - FULL AUTOMATION
 SPECIAL FUNCTION 01
 1 - NONE 6 - BUS - CHARTER/TOUR 11 - FIRE 16 - FARM 21 - MAIL CARRIER
 2 - TAXI 7 - BUS - INTERCITY 12 - MILITARY 17 - MOWING 99 - OTHER UNKNOWN
 3 - ELECTRONIC RIDE SHARING 8 - BUS - SHUTTLE 13 - POLICE 18 - SNOW REMOVAL
 4 - SCHOOL TRANSPORT 9 - BUS - OTHER 14 - PUBLIC UTILITY 19 - TOWING
 5 - BUS-TRANSIT/COMMUTER 10 - AMBULANCE 15 - CONSTRUCTION EQUIPMENT 20 - SAFETY SERVICE PATROL

CARGO BODY TYPE 01
 1 - NO CARGO BODY TYPE / NOT APPLICABLE 3 - VEHICLE TOWING ANOTHER MOTOR VEHICLE 5 - INTERMODAL CONTAINER CHASSIS 8 - POLE 12 - CONCRETE MIXER
 2 - BUS 4 - LOGGING 6 - CARGO VAN/ENCLOSED BOX 9 - CARGO TANK 13 - AUTO TRANSPORTER
 7 - GRAIN/CHIPS/GRAVEL 10 - FLAT BED 14 - GARBAGE/REFUSE 99 - OTHER / UNKNOWN
 VEHICLE DEFECTS
 1 - TURN SIGNALS 4 - BRAKES 7 - WORN OR SLICK TIRES 9 - MOTOR TROUBLE 99 - OTHER / UNKNOWN
 2 - HEAD LAMPS 5 - STEERING 8 - TRAILER EQUIPMENT DEFECTIVE 10 - DISABLED FROM PRIOR ACCIDENT
 3 - TAIL LAMPS 6 - TIRE BLOWOUT

NON-MOTORIST LOCATION AT IMPACT 3 PRE-CRASH ACTION 01
 1 - INTERSECTION - MARKED CROSSWALK 3 - INTERSECTION - OTHER 6 - BICYCLE LANE 9 - MEDIAN/CROSSING ISLAND 12 - FIRST RESPONDER AT INCIDENT SCENE
 2 - INTERSECTION - UNMARKED CROSSWALK 4 - MIDBLOCK - MARKED CROSSWALK 7 - SHOULDER/ROADSIDE 10 - DRIVEWAY ACCESS 99 - OTHER / UNKNOWN
 5 - TRAVEL LANE-OTHER LOCATION 8 - SIDEWALK 11 - SHARED USE PATHS OR TRAILS
 ACTION 3
 1 - NON-CONTACT 1 - STRAIGHT AHEAD 7 - MAKING U-TURN 13 - NEGOTIATING A CURVE 18 - APPROACHING OR LEAVING VEHICLE
 2 - NON-COLLISION 2 - BACKING 8 - ENTERING TRAFFIC LANE 14 - ENTERING OR CROSSING SPECIFIED LOCATION 19 - STANDING
 3 - STRIKING 3 - CHANGING LANES 9 - LEAVING TRAFFIC LANE 15 - WALKING, RUNNING, JOGGING, PLAYING 20 - OTHER NON-MOTORIST
 4 - STRUCK 4 - OVERTAKING/PASSING 10 - PARKED 16 - WORKING 21 - STANDING OUTSIDE DISABLED VEHICLE
 5 - BOTH STRIKING & STRUCK 5 - MAKING RIGHT TURN IN TRAFFIC 99 - OTHER / UNKNOWN
 9 - OTHER / UNKNOWN 6 - MAKING LEFT TURN 12 - DRIVERLESS 17 - PUSHING VEHICLE

CONTRIBUTING CIRCUMSTANCES 01
 1 - NONE 7 - LEFT OF CENTER 13 - IMPROPER START FROM A PARKED POSITION 17 - VISION OBSTRUCTION 22 - LYING IN ROADWAY
 2 - FAILURE TO YIELD 8 - FOLLOWING TOO CLOSE/ACDA 14 - STOPPED OR PARKED ILLEGALLY 18 - OPERATING DEFECTIVE EQUIPMENT 21 - NOT DISCERNABLE
 3 - RAN RED LIGHT 9 - IMPROPER LANE CHANGING 15 - SWERVING TO AVOID 19 - LOAD SHIFTING/ FALLING/SPILLING 23 - OPENING DOOR INTO ROADWAY
 4 - RAN STOP SIGN 10 - IMPROPER PASSING 11 - DROVE OFF ROAD 20 - IMPROPER CROSSING 99 - OTHER IMPROPER ACTION
 5 - UNSAFE SPEED 12 - IMPROPER BACKING 16 - WRONG WAY

SEQUENCE OF EVENTS
 1 23 1 - OVERTURN/ROLLOVER 6 - EQUIPMENT FAILURE 11 - CROSS CENTERLINE - OPPOSITE DIRECTION OF TRAVEL 16 - RAILWAY VEHICLE 22 - WORK ZONE MAINTENANCE EQUIPMENT
 2 1 2 - FIRE/EXPLOSION 7 - SEPARATION OF UNITS 12 - DOWNHILL RUNAWAY 17 - ANIMAL - FARM 23 - STRUCK BY FALLING, SHIFTING CARGO OR ANYTHING SET IN MOTION BY A MOTOR VEHICLE
 3 1 3 - IMMERSION 8 - RAN OFF ROAD RIGHT 13 - OTHER NON-COLLISION 18 - ANIMAL - DEER 24 - OTHER MOVABLE OBJECT
 4 1 4 - JACKKNIFE 9 - RAN OFF ROAD LEFT 14 - PEDESTRIAN 19 - ANIMAL - OTHER 50 - WORKZONE MAINTENANCE EQUIPMENT
 5 1 5 - CARGO / EQUIPMENT LOSS OR SHIFT 10 - CROSS MEDIAN 15 - PEDALCYCLE 20 - MOTOR VEHICLE IN TRANSPORT 51 - WALL
 6 1 6 - IMPROPER TURN 11 - DROVE OFF ROAD 12 - IMPROPER BACKING 21 - PARKED MOTOR VEHICLE 52 - BUILDING
 53 - TUNNEL
 54 - OTHER FIXED OBJECT
 99 - OTHER / UNKNOWN
 COLLISION WITH FIXED OBJECT - STRUCK
 25 - IMPACT ATTENUATOR / CRASH CUSHION 31 - GUARDRAIL END 37 - TRAFFIC SIGN POST 43 - CURB 50 - WORKZONE MAINTENANCE EQUIPMENT
 26 - BRIDGE OVERHEAD STRUCTURE 32 - PORTABLE BARRIER 38 - OVERHEAD SIGN POST 44 - DITCH 51 - WALL
 27 - BRIDGE PIER OR ABUTMENT 33 - MEDIAN CABLE BARRIER 39 - LIGHT/LUMINARIES SUPPORT 45 - EMBANKMENT 52 - BUILDING
 28 - BRIDGE PARAPET 34 - MEDIAN GUARDRAIL BARRIER 40 - UTILITY POLE 46 - FENCE 53 - TUNNEL
 29 - BRIDGE RAIL 35 - MEDIAN CONCRETE BARRIER 41 - OTHER POST, POLE OR SUPPORT 47 - MAILBOX 54 - OTHER FIXED OBJECT
 30 - GUARDRAIL FACE 36 - MEDIAN OTHER BARRIER 42 - CULVERT 48 - TREE 99 - OTHER / UNKNOWN
 49 - FIRE HYDRANT
 FIRST HARMFUL EVENT 1 MOST HARMFUL EVENT 1

LOCAL REPORT NUMBER
20233152

DAMAGE
 DAMAGE SCALE
 1 - NONE 2 - MINOR DAMAGE 3 - FUNCTIONAL DAMAGE 4 - DISABLING DAMAGE
4 9 - UNKNOWN

DAMAGED AREA(S)
 INDICATE ALL THAT APPLY

 - NO DAMAGE [0] - UNDERCARRIAGE [14]
 - TOP [13] - ALL AREAS [15]
 - UNIT NOT AT SCENE [16]

INITIAL POINT OF CONTACT
01
 0 - NO DAMAGE 14 - UNDERCARRIAGE
 1-12 - REFER TO UNIT DIAGRAM 15 - VEHICLE NOT AT SCENE
 99 - UNKNOWN
 13 - TOP

TRAFFIC
 TRAFFICWAY FLOW 2 TRAFFIC CONTROL 6
 1 - ONE-WAY 1 - ROUNDABOUT 4 - STOP SIGN
 2 - TWO-WAY 2 - SIGNAL 5 - YIELD SIGN
 3 - FLASHER 6 - NO CONTROL

OF THROUGH LANES ON ROAD 02 RAIL GRADE CROSSING
 1 - NOT INVOLVED
 2 - INVOLVED - ACTIVE CROSSING
 3 - INVOLVED - PASSIVE CROSSING

UNIT / NON-MOTORIST DIRECTION
 FROM 2 TO 1
 1 - NORTH 5 - NORTHEAST
 2 - SOUTH 6 - NORTHWEST
 3 - EAST 7 - SOUTHEAST
 4 - WEST 8 - SOUTHWEST
 9 - OTHER / UNKNOWN

UNIT SPEED _____ DETECTED SPEED _____
 POSTED SPEED _____
 1 - STATED/ESTIMATED SPEED
 2 - CALCULATED / EDR
 3 - UNDETERMINED

MOTORIST / NON-MOTORIST

LOCAL REPORT NUMBER
2 0 2 3 3 1 5 2

UNIT # 0 1	NAME: LAST, FIRST, MIDDLE STEWART NICHOLE NEHRUOANA	DATE OF BIRTH 0 6 2 3 1 9 7 6	AGE 4 7	GENDER F
ADDRESS: STREET, CITY, STATE, ZIP 12917 HOY AVE CLEVELAND OH 44105		CONTACT PHONE - INCLUDE AREA CODE		
INJURIES 5	INJURED TAKEN BY	EMS AGENCY (NAME)	INJURED TAKEN TO: MEDICAL FACILITY (NAME, CITY)	SAFETY EQUIPMENT USED 0 2
OL STATE	OPERATOR LICENSE NUMBER	OFFENSE CHARGED	LOCAL CODE	OFFENSE DESCRIPTION
OL CLASS 4	ENDORSEMENT SELECT UP TO 2	RESTRICTION SELECT UP TO 3	DRIVER DISTRACTED BY 1	ALCOHOL / DRUG SUSPECTED ALCOHOL MARIJUANA OTHER DRUG
CONDITION 1		ALCOHOL TEST STATUS 1		DRUG TEST(S) STATUS 1

UNIT #	NAME: LAST, FIRST, MIDDLE	DATE OF BIRTH	AGE	GENDER
ADDRESS: STREET, CITY, STATE, ZIP		CONTACT PHONE - INCLUDE AREA CODE		
INJURIES	INJURED TAKEN BY	EMS AGENCY (NAME)	INJURED TAKEN TO: MEDICAL FACILITY (NAME, CITY)	SAFETY EQUIPMENT USED
OL STATE	OPERATOR LICENSE NUMBER	OFFENSE CHARGED	LOCAL CODE	OFFENSE DESCRIPTION
OL CLASS	ENDORSEMENT SELECT UP TO 2	RESTRICTION SELECT UP TO 3	DRIVER DISTRACTED BY	ALCOHOL / DRUG SUSPECTED ALCOHOL MARIJUANA OTHER DRUG
CONDITION		ALCOHOL TEST STATUS		DRUG TEST(S) STATUS

UNIT #	NAME: LAST, FIRST, MIDDLE	DATE OF BIRTH	AGE	GENDER
ADDRESS: STREET, CITY, STATE, ZIP		CONTACT PHONE - INCLUDE AREA CODE		
INJURIES	INJURED TAKEN BY	EMS AGENCY (NAME)	INJURED TAKEN TO: MEDICAL FACILITY (NAME, CITY)	SAFETY EQUIPMENT USED
OL STATE	OPERATOR LICENSE NUMBER	OFFENSE CHARGED	LOCAL CODE	OFFENSE DESCRIPTION
OL CLASS	ENDORSEMENT SELECT UP TO 2	RESTRICTION SELECT UP TO 3	DRIVER DISTRACTED BY	ALCOHOL / DRUG SUSPECTED ALCOHOL MARIJUANA OTHER DRUG
CONDITION		ALCOHOL TEST STATUS		DRUG TEST(S) STATUS

INJURIES	SEATING POSITION	AIR BAG	OL CLASS	OL RESTRICTION(S)	DRIVER DISTRACTION	TEST STATUS
1 - FATAL	1 - FRONT - LEFT SIDE (MOTORCYCLE DRIVER)	1 - NOT DEPLOYED	1 - CLASS A	1 - ALCOHOL INTERLOCK DEVICE	1 - NOT DISTRACTED	1 - NONE GIVEN
2 - SUSPECTED SERIOUS INJURY	2 - FRONT - MIDDLE	2 - DEPLOYED FRONT	2 - CLASS B	2 - CDL INTRASTATE ONLY	2 - MANUALLY OPERATING AN ELECTRONIC COMMUNICATION DEVICE (TEXTING, TYPING, DIALING)	2 - TEST REFUSED
3 - SUSPECTED MINOR INJURY	3 - FRONT - RIGHT SIDE	3 - DEPLOYED SIDE	3 - CLASS C	3 - CORRECTIVE LENSES	3 - TALKING ON HANDS-FREE COMMUNICATION DEVICE	3 - TEST GIVEN, CONTAMINATED SAMPLE / UNSABLE
4 - POSSIBLE INJURY	4 - SECOND - LEFT SIDE (MOTORCYCLE PASSENGER)	4 - DEPLOYED BOTH FRONT / SIDE	4 - REGULAR CLASS (OHIO = D)	4 - FARM WAIVER	4 - TALKING ON HAND-HELD COMMUNICATION DEVICE	4 - TEST GIVEN, RESULTS KNOWN
5 - NO APPARENT INJURY	5 - SECOND - MIDDLE	5 - NOT APPLICABLE	5 - M / C MOPED ONLY	5 - EXCEPT CLASS A BUS & CLASS B BUS	5 - OTHER ACTIVITY WITH AN ELECTRONIC DEVICE	5 - TEST GIVEN, RESULTS UNKNOWN
INJURED TAKEN BY		6 - SECOND - RIGHT SIDE	6 - NO VALID OL	7 - EXCEPT TRACTOR-TRAILER	6 - PASSENGER	ALCOHOL TEST TYPE
1 - NOT TRANSPORTED / TREATED AT SCENE	7 - THIRD - LEFT SIDE (MOTORCYCLE SIDE CAR)	9 - DEPLOYMENT UNKNOWN	EJECTION	8 - INTERMEDIATE LICENSE RESTRICTIONS	7 - OTHER DISTRACTION INSIDE THE VEHICLE	1 - NONE
2 - EMS	8 - THIRD - MIDDLE		H - HAZMAT	9 - LEARNER'S PERMIT RESTRICTIONS	8 - OTHER DISTRACTIONS OUTSIDE THE VEHICLE	2 - BLOOD
3 - POLICE	9 - THIRD - RIGHT SIDE		M - MOTORCYCLE	10 - LIMITED TO DAYLIGHT ONLY	9 - OTHER / UNKNOWN	3 - URINE
9 - OTHER / UNKNOWN	10 - SLEEPER SECTION OF TRUCK CAB		P - PASSENGER	11 - LIMITED TO EMPLOYMENT		4 - BREATH
SAFETY EQUIPMENT			N - TANKER	12 - LIMITED - OTHER		5 - OTHER
1 - NONE USED	12 - PASSENGER IN UNENCLOSED CARGO AREA		Q - MOTOR SCOOTER	13 - MECHANICAL DEVICES (SPECIAL BRAKES, HAND CONTROLS, OR OTHER ADAPTIVE DEVICES)		
2 - SHOULDER BELT ONLY USED	13 - TRAILING UNIT	TRAPPED	R - THREE-WHEEL MOTORCYCLE	14 - MILITARY VEHICLES ONLY	CONDITION	
3 - LAP BELT ONLY USED	14 - RIDING ON VEHICLE EXTERIOR (NON-TRAILING UNIT)	1 - NOT TRAPPED	S - SCHOOL BUS	15 - MOTOR VEHICLES WITHOUT AIR BRAKES	1 - APPARENTLY NORMAL	
4 - SHOULDER & LAP BELT USED	15 - NON-MOTORIST	2 - EXTRICATED BY MECHANICAL MEANS	T - DOUBLE & TRIPLE TRAILERS	16 - OUTSIDE MIRROR	2 - PHYSICAL IMPAIRMENT	
5 - CHILD RESTRAINT SYSTEM - FORWARD FACING	99 - OTHER / UNKNOWN	3 - FREED BY NON-MECHANICAL MEANS	X - TANKER / HAZMAT	17 - PROSTHETIC AID	3 - EMOTIONAL (E.G. DEPRESSED, ANGRY, DISTURBED)	
6 - CHILD RESTRAINT SYSTEM - REAR FACING				18 - OTHER	4 - ILLNESS	DRUG TEST TYPE
7 - BOOSTER SEAT					5 - FELL ASLEEP, FAINTED, FATIGUED, ETC.	1 - NONE
8 - HELMET USED					6 - UNDER THE INFLUENCE OF MEDICATIONS / DRUGS / ALCOHOL	2 - BLOOD
9 - PROTECTIVE PADS USED (ELBOWS, KNEES, ETC.)					9 - OTHER / UNKNOWN	3 - URINE
10 - REFLECTIVE CLOTHING						4 - OTHER
11 - LIGHTING - PEDESTRIAN / BICYCLE ONLY						
99 - OTHER / UNKNOWN						
			GENDER			DRUG TEST RESULT(S)
			F - FEMALE			1 - AMPHETAMINES
			M - MALE			2 - BARBITURATES
			U - OTHER/UNKNOWN			3 - BENZODIAZEPINES
						4 - CANNABINOIDS
						5 - COCAINE
						6 - OPIATES / OPIOIDS
						7 - OTHER
						8 - NEGATIVE RESULTS