

# TRAFFIC CRASH REPORT

\*DENOTES MANDATORY FIELD FOR SUPPLEMENT REPORT

LOCAL REPORT NUMBER \*

2 | 0 | 2 | 3 | 3 | 0 | 9 | 2 | | | |

- PHOTOS TAKEN     OH-2     OH-3  
 SECONDARY CRASH     OH-1P     OTHER  
 Private Property

LOCAL INFORMATION

REPORTING AGENCY NAME \*

GARFIELD HEIGHTS

NCIC \*  
0 | 1 | 8 | 2 | 0

HITSKIP  
1 - Solved  
2 - Unsolved

NUMBER OF UNITS  
0 | 1

UNIT IN ERROR  
98 - ANIMAL  
99 - UNKNOWN  
0 | 1

COUNTY \*  
1 | 8

LOCALITY \*  
1

LOCATION: CITY, VILLAGE, TOWNSHIP \*  
GARFIELD HTS

CRASH DATE/TIME \*  
1 | 1 | 1 | 5 | 2 | 0 | 2 | 3 | | 0 | 7 | 4 | 5 |

CRASH SEVERITY  
5

1 - FATAL  
2 - SERIOUS INJURY SUSPECTED  
3 - MINOR INJURY SUSPECTED  
4 - INJURY POSSIBLE  
5 - PROPERTY DAMAGE ONLY

ROUTE TYPE  
| | | |

ROUTE NUMBER  
| | | | | | | |

PREFIX  
| |

1 - NORTH  
2 - SOUTH  
3 - EAST  
4 - WEST

LOCATION ROAD NAME  
E 98

ROAD TYPE  
S | T

LATITUDE DECIMAL DEGREES  
4 | 1 | | . 4 | 1 | 9 | 5 | 1 | 2 |

ROUTE TYPE  
| | | |

ROUTE NUMBER  
| | | | | | | |

PREFIX  
| |

1 - NORTH  
2 - SOUTH  
3 - EAST  
4 - WEST

REFERENCE ROAD NAME (ROAD, MILEPOST, HOUSE #)  
5226

ROAD TYPE  
| | | |

LONGITUDE DECIMAL DEGREES  
- 8 | 1 | | . 6 | 1 | 6 | 6 | 7 | 1 |

REFERENCE POINT  
1 - INTERSECTION  
2 - MILE POST  
3 - HOUSE #  
3

DIRECTION  
1 - NORTH  
2 - SOUTH  
3 - EAST  
4 - WEST

ROUTE TYPE  
IR - INTERSTATE ROUTE (TP)  
US - FEDERAL US ROUTE  
SR - STATE ROUTE  
CR - NUMBERED COUNTY ROUTE  
TR - NUMBERED TOWNSHIP ROUTE

ROAD TYPE  
AL - ALLEY  
AV - AVENUE  
BL - BOULEVARD  
CR - CIRCLE  
CT - COURT  
DR - DRIVE  
HE - HEIGHTS  
HW - HIGHWAY  
LA - LANE  
LA - LANE  
MP - MILEPOST  
OV - OVAL  
PK - PARKWAY  
PI - PIKE  
PL - PLACE  
RD - ROAD  
SQ - SQUARE  
ST - STREET  
TE - TERRACE  
TL - TRAIL  
WA - WAY

INTERSECTION RELATED  
 WITHIN INTERSECTION OR ON APPROACH  
 WITHIN INTERCHANGE AREA

DISTANCE  
1 - Miles  
2 - Feet  
3 - Yards

DISTANCE  
1 - Miles  
2 - Feet  
3 - Yards

ROADWAY  
 ROADWAY DIVIDED

LOCATION - FIRST AND SECOND EVENT  
1 - ON ROADWAY  
2 - ON SHOULDER  
3 - IN MEDIAN  
4 - ON ROADSIDE  
5 - ON GORE  
6 - OUTSIDE  
7 - ON RAMP  
8 - OFF RAMP  
9 - CROSSOVER  
10 - DRIVEWAY / ALLEY ACCESS  
11 - RAILWAY GRADE CROSSING  
12 - SHARED USE PATHS OR TRAILS  
13 - BIKE LANE  
14 - TOLL BOOTH  
99 - OTHER / UNKNOWN

MANNER OF CRASH COLLISION/IMPACT  
1 - NOT COLLISION BETWEEN TWO MOTOR VEHICLES IN TRANSPORT  
2 - REAR-END  
3 - HEAD-ON  
4 - REAR-TO-REAR  
5 - BACKING  
6 - ANGLE  
7 - SIDESWIPE, SAME DIRECTION  
8 - SIDESWIPE, OPPOSITE DIRECTION  
9 - OTHER / UNKNOWN

DIRECTION OF TRAVEL  
1 - NORTH  
2 - SOUTH  
3 - EAST  
4 - WEST

MEDIAN TYPE  
1 - DIVIDED FLUSH MEDIAN (<4 FEET)  
2 - DIVIDED FLUSH MEDIAN (≥4 FEET)  
3 - DIVIDED, DEPRESSED MEDIAN  
4 - DIVIDED, RAISED MEDIAN (ANY TYPE)  
9 - OTHER / UNKNOWN

WORK ZONE RELATED  
 WORKERS PRESENT  
 LAW ENFORCEMENT PRESENT  
 ACTIVE SCHOOL ZONE

WORK ZONE TYPE  
1 - LANE CLOSURE  
2 - LANE SHIFT/CROSSOVER  
3 - WORK ON SHOULDER  
4 - INTERMITTENT OR MOVING WORK  
5 - OTHER

LOCATION OF CRASH IN WORK ZONE  
1 - BEFORE THE 1ST WORK ZONE WARNING SIGN  
2 - ADVANCE WARNING AREA  
3 - TRANSITION AREA  
4 - ACTIVITY AREA  
5 - TERMINATION AREA

CONTOUR  
1

1 - STRAIGHT LEVEL GRADE  
2 - STRAIGHT GRADE  
3 - CURVE LEVEL  
4 - CURVE GRADE  
9 - OTHER / UNKNOWN

CONDITIONS  
9

1 - DRY  
2 - WET  
3 - SNOW  
4 - ICE  
5 - SAND, MUD, DIRT, OIL, GRAVEL  
6 - WATER (STANDING, MOVING)  
7 - SLUSH  
9 - OTHER/UNKNOWN

SURFACE  
2

1 - CONCRETE  
2 - BLACKTOP, BITUMINOUS, ASPHALT  
3 - BRICK/BLOCK  
4 - SLAG, GRAVEL, STONE  
5 - DIRT  
9 - OTHER / UNKNOWN

LIGHT CONDITION  
1

1 - DAYLIGHT  
2 - DAWN/DUSK  
3 - DARK - LIGHTED ROADWAY  
4 - DARK - ROADWAY NOT LIGHTED  
5 - DARK - UNKNOWN ROADWAY LIGHTING  
9 - OTHER / UNKNOWN

WEATHER  
1

1 - CLEAR  
2 - CLOUDY  
3 - FOG, SMOG, SMOKE  
4 - RAIN  
5 - SLEET, HAIL  
6 - SNOW  
7 - SEVERE CROSSWINDS  
8 - BLOWING SAND, SOIL, DIRT, SNOW  
9 - FREEZING RAIN OR FREEZING DRIZZLE  
99 - OTHER / UNKNOWN

CONTOUR  
1

1 - STRAIGHT LEVEL GRADE  
2 - STRAIGHT GRADE  
3 - CURVE LEVEL  
4 - CURVE GRADE  
9 - OTHER / UNKNOWN

CONDITIONS  
9

1 - DRY  
2 - WET  
3 - SNOW  
4 - ICE  
5 - SAND, MUD, DIRT, OIL, GRAVEL  
6 - WATER (STANDING, MOVING)  
7 - SLUSH  
9 - OTHER/UNKNOWN

SURFACE  
2

1 - CONCRETE  
2 - BLACKTOP, BITUMINOUS, ASPHALT  
3 - BRICK/BLOCK  
4 - SLAG, GRAVEL, STONE  
5 - DIRT  
9 - OTHER / UNKNOWN

NARRATIVE

UNIT 1 WAS EXITING THE PARKING LOT OF 5226 E 98 ST WHEN A STEEL PLATE IN THE ROADWAY CAUGHT THE FRONT END OF UNIT 1 CAUSING DAMAGE TO UNIT 1.

NOTE: THE AREA OF 5226 E 98 ST IS A ACTIVE WORK ZONE WITH MANY WORK BARRELS AND METAL PLATES ON THE ROADWAY.

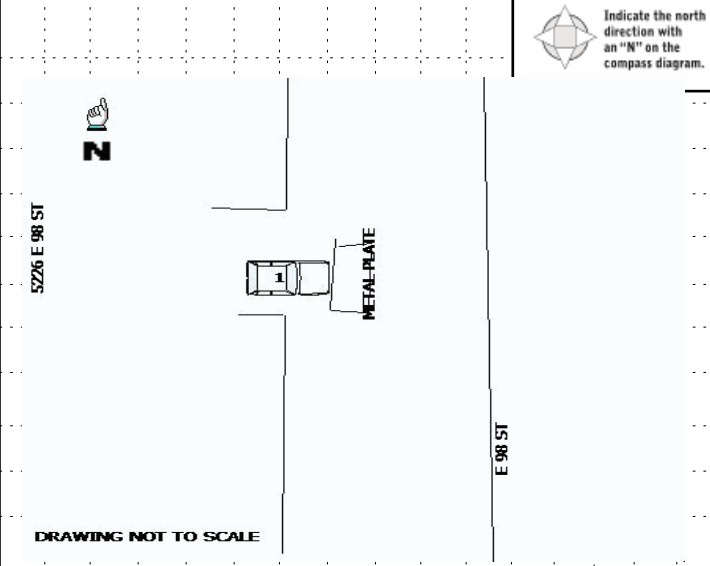

CRASH REPORTED DATE/TIME  
1 | 1 | 1 | 5 | 2 | 0 | 2 | 3 | | 1 | 1 | 3 | 2 | 9 |

DISPATCH DATE/TIME  
1 | 1 | 1 | 5 | 2 | 0 | 2 | 3 | | 1 | 3 | 3 | 0 |

ARRIVAL DATE/TIME  
1 | 1 | 1 | 5 | 2 | 0 | 2 | 3 | | 1 | 1 | 3 | 3 | 2 |

SCENE CLEARED DATE/TIME  
| | | | | | | | | | | | |

REPORT TAKEN BY  
 POLICE AGENCY  
 MOTORIST

TOTAL TIME ROADWAY CLOSED  
0

OTHER INVESTIGATION TIME  
| | | | | | | |

TOTAL MINUTES  
| | | | | | | |

OFFICER'S NAME \*  
J. Marks

OFFICER'S BADGE NUMBER\*  
R | P | T | 1 | | | |

CHECKED BY OFFICER'S NAME\*  
T. Baon

CHECKED BY OFFICER'S BADGE NUMBER\*  
S | 2 | 0 | | | |

SUPPLEMENT  
(CORRECTION - ADDITION)

OWNER INFORMATION

UNIT # 0 1 OWNER NAME: LAST, FIRST, MIDDLE (  Same As Driver )  
**SOLOMON VICTORIA LYNN**

OWNER PHONE: INCLUDE AREA CODE (  Same As Driver )

OWNER ADDRESS: STREET, CITY, STATE, ZIP (  Same As Driver )  
**5226 E 98TH ST APT GARFIELD HTS OH 44125**

COMMERCIAL CARRIER: NAME, ADDRESS, CITY, STATE, ZIP

COMMERCIAL CARRIER PHONE: INCLUDE AREA CODE

DAMAGE

DAMAGE SCALE

1 - NONE  
2 - MINOR DAMAGE  
3 - FUNCTIONAL DAMAGE  
4 - DISABLING DAMAGE  
9 - UNKNOWN

3

VEHICLE IDENTIFICATION # 1 N 4 B L 4 F W 0 M N 3 0 6 3 4 3

VEHICLE YEAR 2 0 2 1 VEHICLE MAKE Nissan

INSURANCE VERIFIED  INSURANCE COMPANY CINCINNATI INS INSURANCE POLICY # 07A011157130 VEHICLE COLOR BLK VEHICLE MODEL Altima

TYPE OF USE:  COMMERCIAL  GOVERNMENT  IN EMERGENCY RESPONSE

US DOT # \_\_\_\_\_ TOWED BY: COMPANY NAME \_\_\_\_\_

INTERLOCK DEVICE EQUIPPED  HIT/SKIP UNIT  # OCCUPANTS 0 1

VEHICLE WEIGHT GVWR/GCWR: 1 - ≤10K LBS. 2 - 10,001 - 26K LBS. 3 - >26K LBS.

HAZARDOUS MATERIAL:  MATERIAL RELEASED CLASS # \_\_\_\_\_ PLACARD ID # \_\_\_\_\_

DAMAGED AREA(S)  
INDICATE ALL THAT APPLY

INITIAL POINT OF CONTACT

1 - NO DAMAGE [0]  14 - UNDERCARRIAGE [14]   
 13 - TOP [13]  15 - VEHICLE NOT AT SCENE   
 99 - OTHER / UNKNOWN  99 - UNKNOWN [99]

UNIT TYPE 0 1

1 - PASSENGER CAR 7 - MOTORCYCLE 2-WHEELED 12 - GOLF CART 18 - LIMO (LIVERY VEHICLE) 23 - PEDESTRIANSKATER  
 2 - PASSENGER VAN (MINIVAN) 8 - MOTORCYCLE 3-WHEELED 13 - SNOWMOBILE 19 - BUS (16+ PASSENGERS) 24 - WHEELCHAIR (ANY TYPE)  
 3 - SPORT UTILITY VEHICLE 9 - AUTOCYCLE 14 - SINGLE UNIT TRUCK 20 - OTHER VEHICLE 25 - OTHER NON-MOTORIST  
 4 - PICK UP 10 - MOPED OR MOTORIZED BICYCLE 15 - SEMI-TRACTOR 21 - HEAVY EQUIPMENT 26 - BICYCLE  
 5 - CARGO VAN 11 - ALL TERRAIN VEHICLE (ATV / UTV) 16 - FARM EQUIPMENT 22 - ANIMAL WITH RIDER OR ANIMAL-DRAWN VEHICLE 27 - TRAIN  
 6 - VAN (9-15 SEATS) 17 - MOTORHOME

# of TRAILING UNITS \_\_\_\_\_

WAS VEHICLE OPERATING IN AUTONOMOUS MODE WHEN CRASH OCCURRED? 2

1 - YES 2 - NO 9 - OTHER / UNKNOWN

AUTONOMOUS MODE LEVEL 0

0 - NO AUTOMATION 1 - DRIVER ASSISTANCE 3 - CONDITIONAL AUTOMATION 9 - UNKNOWN  
 2 - PARTIAL AUTOMATION 4 - HIGH AUTOMATION 5 - FULL AUTOMATION

SPECIAL FUNCTION 0 1

1 - NONE 6 - BUS - CHARTER/TOUR 11 - FIRE 16 - FARM 21 - MAIL CARRIER  
 2 - TAXI 7 - BUS - INTERCITY 12 - MILITARY 17 - MOWING 99 - OTHER UNKNOWN  
 3 - ELECTRONIC RIDE SHARING 8 - BUS - SHUTTLE 13 - POLICE 18 - SNOW REMOVAL  
 4 - SCHOOL TRANSPORT 9 - BUS - OTHER 14 - PUBLIC UTILITY 19 - TOWING  
 5 - BUS-TRANSIT/COMMUTER 10 - AMBULANCE 15 - CONSTRUCTION EQUIPMENT 20 - SAFETY SERVICE PATROL

CARGO BODY TYPE 0 1

1 - NO CARGO BODY TYPE / NOT APPLICABLE 3 - VEHICLE TOWING ANOTHER MOTOR VEHICLE 5 - INTERMODAL CONTAINER CHASSIS 8 - POLE 12 - CONCRETE MIXER  
 2 - BUS 4 - LOGGING 6 - CARGO VAN/ENCLOSED BOX 9 - CARGO TANK 13 - AUTO TRANSPORTER  
 7 - GRAIN/CHIPS/GRAVEL 10 - FLAT BED 14 - GARBAGE/REFUSE 99 - OTHER / UNKNOWN  
 11 - DUMP

VEHICLE DEFECTS

1 - TURN SIGNALS 4 - BRAKES 7 - WORN OR SLICK TIRES 9 - MOTOR TROUBLE 99 - OTHER / UNKNOWN  
 2 - HEAD LAMPS 5 - STEERING 8 - TRAILER EQUIPMENT DEFECTIVE 10 - DISABLED FROM PRIOR ACCIDENT  
 3 - TAIL LAMPS 6 - TIRE BLOWOUT

NON-MOTORIST LOCATION AT IMPACT 3

1 - INTERSECTION - MARKED CROSSWALK 3 - INTERSECTION - OTHER 6 - BICYCLE LANE 9 - MEDIAN/CROSSING ISLAND 12 - FIRST RESPONDER AT INCIDENT SCENE  
 2 - INTERSECTION - UNMARKED CROSSWALK 4 - MIDBLOCK - MARKED CROSSWALK 7 - SHOULDER/ROADSIDE 10 - DRIVEWAY ACCESS 99 - OTHER / UNKNOWN  
 5 - TRAVEL LANE-OTHER LOCATION 8 - SIDEWALK 11 - SHARED USE PATHS OR TRAILS

ACTION 0 1

1 - NON-CONTACT 1 - STRAIGHT AHEAD 7 - MAKING U-TURN 13 - NEGOTIATING A CURVE 18 - APPROACHING OR LEAVING VEHICLE  
 2 - NON-COLLISION 2 - BACKING 8 - ENTERING TRAFFIC LANE 14 - ENTERING OR CROSSING SPECIFIED LOCATION 19 - STANDING  
 3 - STRIKING 3 - CHANGING LANES 9 - LEAVING TRAFFIC LANE 15 - WALKING, RUNNING, JOGGING, PLAYING 20 - OTHER NON-MOTORIST  
 4 - STRUCK 4 - OVERTAKING/PASSING 10 - PARKED 16 - WORKING 21 - STANDING OUTSIDE DISABLED VEHICLE  
 5 - BOTH STRIKING & STRUCK 5 - MAKING RIGHT TURN 11 - SLOWING OR STOPPED IN TRAFFIC 99 - OTHER / UNKNOWN  
 9 - OTHER / UNKNOWN 6 - MAKING LEFT TURN 12 - DRIVERLESS 17 - PUSHING VEHICLE

CONTRIBUTING CIRCUMSTANCES 2 2

1 - NONE 7 - LEFT OF CENTER 13 - IMPROPER START FROM A PARKED POSITION 17 - VISION OBSTRUCTION 21 - LYING IN ROADWAY  
 2 - FAILURE TO YIELD 8 - FOLLOWING TOO CLOSE/ACDA 14 - STOPPED OR PARKED ILLEGALLY 18 - OPERATING DEFECTIVE EQUIPMENT 22 - NOT DISCERNABLE  
 3 - RAN RED LIGHT 9 - IMPROPER LANE CHANGING 15 - SWERVING TO AVOID 19 - LOAD SHIFTING/ FALLING/SPILLING 23 - OPENING DOOR INTO ROADWAY  
 4 - RAN STOP SIGN 10 - IMPROPER PASSING 16 - WRONG WAY 20 - IMPROPER CROSSING 99 - OTHER IMPROPER ACTION  
 5 - UNSAFE SPEED 11 - DROVE OFF ROAD 12 - IMPROPER BACKING

INITIAL POINT OF CONTACT

0 - NO DAMAGE  
 1-12 - REFER TO UNIT DIAGRAM  
 13 - TOP  
 14 - UNDERCARRIAGE  
 15 - VEHICLE NOT AT SCENE  
 99 - UNKNOWN

SEQUENCE OF EVENTS

EVENTS

1 2 4

1 - OVERTURN/ROLLOVER 6 - EQUIPMENT FAILURE 11 - CROSS CENTERLINE - OPPOSITE DIRECTION OF TRAVEL 16 - RAILWAY VEHICLE 22 - WORK ZONE MAINTENANCE EQUIPMENT  
 2 - FIRE/EXPLOSION 7 - SEPARATION OF UNITS 12 - DOWNHILL RUNAWAY 17 - ANIMAL - FARM 23 - STRUCK BY FALLING, SHIFTING CARGO OR ANYTHING SET IN MOTION BY A MOTOR VEHICLE  
 3 - IMMERSION 8 - RAN OFF ROAD RIGHT 13 - OTHER NON-COLLISION 18 - ANIMAL - DEER 24 - OTHER MOVABLE OBJECT  
 4 - JACKKNIFE 9 - RAN OFF ROAD LEFT 14 - PEDESTRIAN 19 - ANIMAL - OTHER 25 - WORKZONE MAINTENANCE EQUIPMENT  
 5 - CARGO / EQUIPMENT LOSS OR SHIFT 10 - CROSS MEDIAN 15 - PEDALCYCLE 20 - MOTOR VEHICLE IN TRANSPORT 51 - WALL  
 26 - BRIDGE OVERHEAD STRUCTURE 31 - GUARDRAIL END 37 - TRAFFIC SIGN POST 43 - CURB 52 - BUILDING  
 27 - BRIDGE PIER OR ABUTMENT 32 - PORTABLE BARRIER 38 - OVERHEAD SIGN POST 44 - DITCH 53 - TUNNEL  
 28 - BRIDGE PARAPET 33 - MEDIAN CABLE BARRIER 39 - LIGHT/LUMINARIES SUPPORT 45 - EMBANKMENT 54 - OTHER FIXED OBJECT  
 29 - BRIDGE RAIL 34 - MEDIAN GUARDRAIL BARRIER 40 - UTILITY POLE 46 - FENCE 99 - OTHER / UNKNOWN  
 30 - GUARDRAIL FACE 35 - MEDIAN CONCRETE BARRIER 41 - OTHER POST, POLE OR SUPPORT 47 - MAILBOX 48 - TREE  
 36 - MEDIAN OTHER BARRIER 42 - CULVERT 49 - FIRE HYDRANT

COLLISION WITH FIXED OBJECT - STRUCK

25 - IMPACT ATTENUATOR / CRASH CUSHION 31 - GUARDRAIL END 37 - TRAFFIC SIGN POST 43 - CURB 50 - WORKZONE MAINTENANCE EQUIPMENT  
 26 - BRIDGE OVERHEAD STRUCTURE 32 - PORTABLE BARRIER 38 - OVERHEAD SIGN POST 44 - DITCH 51 - WALL  
 27 - BRIDGE PIER OR ABUTMENT 33 - MEDIAN CABLE BARRIER 39 - LIGHT/LUMINARIES SUPPORT 45 - EMBANKMENT 52 - BUILDING  
 28 - BRIDGE PARAPET 34 - MEDIAN GUARDRAIL BARRIER 40 - UTILITY POLE 46 - FENCE 53 - TUNNEL  
 29 - BRIDGE RAIL 35 - MEDIAN CONCRETE BARRIER 41 - OTHER POST, POLE OR SUPPORT 47 - MAILBOX 54 - OTHER FIXED OBJECT  
 30 - GUARDRAIL FACE 36 - MEDIAN OTHER BARRIER 42 - CULVERT 48 - TREE 99 - OTHER / UNKNOWN

FIRST HARMFUL EVENT 1 MOST HARMFUL EVENT 1

TRAFFIC

TRAFFICWAY FLOW 2

1 - ONE-WAY  
2 - TWO-WAY

TRAFFIC CONTROL 6

1 - ROUNDABOUT 4 - STOP SIGN  
2 - SIGNAL 5 - YIELD SIGN  
3 - FLASHER 6 - NO CONTROL

# OF THROUGH LANES ON ROAD 2

RAIL GRADE CROSSING 1

1 - NOT INVOLVED  
2 - INVOLVED - ACTIVE CROSSING  
3 - INVOLVED - PASSIVE CROSSING

UNIT / NON-MOTORIST DIRECTION

FROM 4 TO 3

1 - NORTH 5 - NORTHEAST  
2 - SOUTH 6 - NORTHWEST  
3 - EAST 7 - SOUTHEAST  
4 - WEST 8 - SOUTHWEST  
9 - OTHER / UNKNOWN

UNIT SPEED 5

DETECTED SPEED 1

1 - STATED/ESTIMATED SPEED  
2 - CALCULATED / EDR  
3 - UNDETERMINED

POSTED SPEED 2 5

# MOTORIST / NON-MOTORIST

LOCAL REPORT NUMBER  
2 0 2 3 3 0 9 2

UNIT # 0 1	NAME: LAST, FIRST, MIDDLE SOLOMON VICTORIA LYNN		DATE OF BIRTH 0 6 1 0 1 9 6 1		AGE 6 2	GENDER F					
ADDRESS: STREET, CITY, STATE, ZIP 5226 E 98TH ST APT GARFIELD HTS OH 44125				CONTACT PHONE - INCLUDE AREA CODE							
INJURIES 5	INJURED TAKEN BY	EMS AGENCY (NAME)	INJURED TAKEN TO: MEDICAL FACILITY (NAME, CITY)	SAFETY EQUIPMENT USED 0 4	DOT-COMPLIANT MC HELMET	SEATING POSITION 0 1	AIR BAG USAGE 1	EJECTION 1	TRAPPED 1		
OL STATE	OPERATOR LICENSE NUMBER	OFFENSE CHARGED	LOCAL CODE	OFFENSE DESCRIPTION	CITATION NUMBER						
OL CLASS 4	ENDORSEMENT SELECT UP TO 2	RESTRICTION SELECT UP TO 3	DRIVER DISTRACTED BY 1	ALCOHOL / DRUG SUSPECTED <input type="checkbox"/> ALCOHOL <input type="checkbox"/> MARIJUANA <input type="checkbox"/> OTHER DRUG	CONDITION 1	STATUS 1	ALCOHOL TEST TYPE 1	VALUE	STATUS 1	TYPE 1	DRUG TEST(S) RESULT SELECT UP TO 4

UNIT #	NAME: LAST, FIRST, MIDDLE		DATE OF BIRTH		AGE	GENDER					
ADDRESS: STREET, CITY, STATE, ZIP				CONTACT PHONE - INCLUDE AREA CODE							
INJURIES	INJURED TAKEN BY	EMS AGENCY (NAME)	INJURED TAKEN TO: MEDICAL FACILITY (NAME, CITY)	SAFETY EQUIPMENT USED	DOT-COMPLIANT MC HELMET	SEATING POSITION	AIR BAG USAGE	EJECTION	TRAPPED		
OL STATE	OPERATOR LICENSE NUMBER	OFFENSE CHARGED	LOCAL CODE	OFFENSE DESCRIPTION	CITATION NUMBER						
OL CLASS	ENDORSEMENT SELECT UP TO 2	RESTRICTION SELECT UP TO 3	DRIVER DISTRACTED BY	ALCOHOL / DRUG SUSPECTED <input type="checkbox"/> ALCOHOL <input type="checkbox"/> MARIJUANA <input type="checkbox"/> OTHER DRUG	CONDITION	STATUS	ALCOHOL TEST TYPE	VALUE	STATUS	TYPE	DRUG TEST(S) RESULT SELECT UP TO 4

UNIT #	NAME: LAST, FIRST, MIDDLE		DATE OF BIRTH		AGE	GENDER					
ADDRESS: STREET, CITY, STATE, ZIP				CONTACT PHONE - INCLUDE AREA CODE							
INJURIES	INJURED TAKEN BY	EMS AGENCY (NAME)	INJURED TAKEN TO: MEDICAL FACILITY (NAME, CITY)	SAFETY EQUIPMENT USED	DOT-COMPLIANT MC HELMET	SEATING POSITION	AIR BAG USAGE	EJECTION	TRAPPED		
OL STATE	OPERATOR LICENSE NUMBER	OFFENSE CHARGED	LOCAL CODE	OFFENSE DESCRIPTION	CITATION NUMBER						
OL CLASS	ENDORSEMENT SELECT UP TO 2	RESTRICTION SELECT UP TO 3	DRIVER DISTRACTED BY	ALCOHOL / DRUG SUSPECTED <input type="checkbox"/> ALCOHOL <input type="checkbox"/> MARIJUANA <input type="checkbox"/> OTHER DRUG	CONDITION	STATUS	ALCOHOL TEST TYPE	VALUE	STATUS	TYPE	DRUG TEST(S) RESULT SELECT UP TO 4

INJURIES	SEATING POSITION	AIR BAG	OL CLASS	OL RESTRICTION(S)	DRIVER DISTRACTION	TEST STATUS
1 - FATAL	1 - FRONT - LEFT SIDE (MOTORCYCLE DRIVER)	1 - NOT DEPLOYED	1 - CLASS A	1 - ALCOHOL INTERLOCK DEVICE	1 - NOT DISTRACTED	1 - NONE GIVEN
2 - SUSPECTED SERIOUS INJURY	2 - FRONT - MIDDLE	2 - DEPLOYED FRONT	2 - CLASS B	2 - CDL INTRASTATE ONLY	2 - MANUALLY OPERATING AN ELECTRONIC COMMUNICATION DEVICE (TEXTING, TYPING, DIALING)	2 - TEST REFUSED
3 - SUSPECTED MINOR INJURY	3 - FRONT - RIGHT SIDE	3 - DEPLOYED SIDE	3 - CLASS C	3 - CORRECTIVE LENSES	3 - TALKING ON HANDS-FREE COMMUNICATION DEVICE	3 - TEST GIVEN, CONTAMINATED SAMPLE / UNUSABLE
4 - POSSIBLE INJURY	4 - SECOND - LEFT SIDE (MOTORCYCLE PASSENGER)	4 - DEPLOYED BOTH FRONT / SIDE	4 - REGULAR CLASS (OHIO = D)	4 - FARM WAIVER	4 - TALKING ON HAND-HELD COMMUNICATION DEVICE	4 - TEST GIVEN, RESULTS KNOWN
5 - NO APPARENT INJURY	5 - SECOND - MIDDLE	5 - NOT APPLICABLE	5 - M / C MOPED ONLY	5 - EXCEPT CLASS A BUS & CLASS B BUS	5 - OTHER ACTIVITY WITH AN ELECTRONIC DEVICE	5 - TEST GIVEN, RESULTS UNKNOWN
<b>INJURED TAKEN BY</b>		6 - SECOND - RIGHT SIDE	6 - NO VALID OL	6 - EXCEPT CLASS A & CLASS B BUS	6 - PASSENGER	<b>ALCOHOL TEST TYPE</b>
1 - NOT TRANSPORTED / TREATED AT SCENE	7 - THIRD - LEFT SIDE (MOTORCYCLE SIDE CAR)	7 - THIRD - LEFT SIDE (MOTORCYCLE SIDE CAR)	H - HAZMAT	7 - EXCEPT TRACTOR-TRAILER RESTRICTIONS	7 - OTHER DISTRACTION INSIDE THE VEHICLE	1 - NONE
2 - EMS	8 - THIRD - MIDDLE	8 - THIRD - MIDDLE	M - MOTORCYCLE	8 - INTERMEDIATE LICENSE RESTRICTIONS	8 - OTHER DISTRACTIONS OUTSIDE THE VEHICLE	2 - BLOOD
3 - POLICE	9 - THIRD - RIGHT SIDE	9 - THIRD - RIGHT SIDE	P - PASSENGER	9 - LEARNER'S PERMIT RESTRICTIONS	9 - OTHER / UNKNOWN	3 - URINE
9 - OTHER / UNKNOWN	10 - SLEEPER SECTION OF TRUCK CAB	10 - SLEEPER SECTION OF TRUCK CAB	N - TANKER	10 - LIMITED TO DAYLIGHT ONLY		4 - BREATH
<b>SAFETY EQUIPMENT</b>		11 - PASSENGER IN OTHER ENCLOSED CARGO AREA (NON-TRAILING UNIT, BUS, PICK-UP WITH CAP)	Q - MOTOR SCOOTER	11 - LIMITED TO EMPLOYMENT		5 - OTHER
1 - NONE USED	12 - PASSENGER IN UNENCLOSED CARGO AREA	12 - PASSENGER IN UNENCLOSED CARGO AREA	R - THREE-WHEEL MOTORCYCLE	12 - LIMITED - OTHER		<b>DRUG TEST TYPE</b>
2 - SHOULDER BELT ONLY USED	13 - TRAILING UNIT	13 - TRAILING UNIT	S - SCHOOL BUS	13 - MECHANICAL DEVICES (SPECIAL BRAKES, HAND CONTROLS, OR OTHER ADAPTIVE DEVICES)		1 - NONE
3 - LAP BELT ONLY USED	14 - RIDING ON VEHICLE EXTERIOR (NON-TRAILING UNIT)	14 - RIDING ON VEHICLE EXTERIOR (NON-TRAILING UNIT)	T - DOUBLE & TRIPLE TRAILERS	14 - MILITARY VEHICLES ONLY		2 - BLOOD
4 - SHOULDER & LAP BELT USED	15 - NON-MOTORIST	15 - NON-MOTORIST	X - TANKER / HAZMAT	15 - MOTOR VEHICLES WITHOUT AIR BRAKES		3 - URINE
5 - CHILD RESTRAINT SYSTEM - FORWARD FACING	99 - OTHER / UNKNOWN	99 - OTHER / UNKNOWN		16 - OUTSIDE MIRROR	<b>CONDITION</b>	4 - OTHER
6 - CHILD RESTRAINT SYSTEM - REAR FACING				17 - PROSTHETIC AID	1 - APPARENTLY NORMAL	<b>DRUG TEST RESULT(S)</b>
7 - BOOSTER SEAT				18 - OTHER	2 - PHYSICAL IMPAIRMENT	1 - AMPHETAMINES
8 - HELMET USED					3 - EMOTIONAL (E.G. DEPRESSED, ANGRY, DISTURBED)	2 - BARBITURATES
9 - PROTECTIVE PADS USED (ELBOWS, KNEES, ETC.)					4 - ILLNESS	3 - BENZODIAZEPINES
10 - REFLECTIVE CLOTHING					5 - FELL ASLEEP, FAINTED, FATIGUED, ETC.	4 - CANNABINOIDS
11 - LIGHTING - PEDESTRIAN / BICYCLE ONLY					6 - UNDER THE INFLUENCE OF MEDICATIONS / DRUGS / ALCOHOL	5 - COCAINE
99 - OTHER / UNKNOWN					9 - OTHER / UNKNOWN	6 - OPIATES / OPIOIDS
						7 - OTHER
						8 - NEGATIVE RESULTS