

# TRAFFIC CRASH REPORT

\*DENOTES MANDATORY FIELD FOR SUPPLEMENT REPORT

LOCAL REPORT NUMBER \*

2 | 0 | 2 | 3 | 2 | 0 | 3 | 7 |

- PHOTOS TAKEN  OH-2  OH-3  
 SECONDARY CRASH  OH-1P  OTHER  
 Private Property

LOCAL INFORMATION

REPORTING AGENCY NAME \*

GARFIELD HEIGHTS

NCIC \*  
0 | 1 | 8 | 2 | 0

HITSKIP  
1 - Solved  
2 - Unsolved

NUMBER OF UNITS  
0 | 2

INITIALS EDDP  
98 - ANIMAL  
99 - UNKNOWN  
0 | 1

COUNTY \*  
1 | 8

LOCALITY \*  
1

LOCATION: CITY, VILLAGE, TOWNSHIP \*  
GARFIELD HTS

CRASH DATE/TIME \*  
0 | 8 | 0 | 1 | 2 | 0 | 2 | 3 | 1 | 3 | 1 | 8 |

CRASH SEVERITY  
5  
1 - FATAL  
2 - SERIOUS INJURY SUSPECTED  
3 - MINOR INJURY SUSPECTED  
4 - INJURY POSSIBLE  
5 - PROPERTY DAMAGE ONLY

ROUTE TYPE  
ROUTE NUMBER  
PREFIX

LOCATION ROAD NAME  
100 Th

ROAD TYPE  
LATITUDE DECIMAL DEGREES  
4 | 1 | 4 | 1 | 9 | 3 | 0 | 2 |

ROUTE TYPE  
ROUTE NUMBER  
PREFIX

REFERENCE ROAD NAME (ROAD, MILEPOST, HOUSE #)  
5237

ROAD TYPE  
LONGITUDE DECIMAL DEGREES  
8 | 1 | 6 | 1 | 4 | 6 | 1 | 7 |

REFERENCE POINT  
3

DIRECTION  
3 - EAST  
4 - WEST

ROUTE TYPE  
IR - INTERSTATE ROUTE (TP)  
US - FEDERAL US ROUTE  
SR - STATE ROUTE  
CR - NUMBERED COUNTY ROUTE  
TR - NUMBERED TOWNSHIP ROUTE

ROAD TYPE  
AL - ALLEY  
AV - AVENUE  
BL - BOULEVARD  
CR - CIRCLE  
CT - COURT  
DR - DRIVE  
HE - HEIGHTS  
HW - HIGHWAY  
LA - LANE  
MP - MILEPOST  
OV - OVAL  
PK - PARKWAY  
PI - PIKE  
PL - PLACE  
RD - ROAD  
SQ - SQUARE  
ST - STREET  
TE - TERRACE  
TL - TRAIL  
WA - WAY

INTERSECTION RELATED  
 WITHIN INTERSECTION OR ON APPROACH  
 WITHIN INTERCHANGE AREA  
NUMBER OF APPROACHES

DISTANCE  
1 - Miles  
2 - Feet  
3 - Yards

DISTANCE  
1 - Miles  
2 - Feet  
3 - Yards

ROADWAY  
 ROADWAY DIVIDED

LOCATION OF CRASH COLLISION/IMPACT EVENT  
0 | 1  
1 - ON ROADWAY  
2 - ON SHOULDER  
3 - IN MEDIAN  
4 - ON ROADSIDE  
5 - ON GORE  
6 - OUTSIDE TRAFFICWAY  
7 - ON RAMP  
8 - OFF RAMP  
9 - CROSSOVER  
10 - DRIVEWAY / ALLEY ACCESS  
11 - RAILWAY GRADE CROSSING  
12 - SHARED USE PATHS OR TRAILS  
13 - BIKE LANE  
14 - TOLL BOOTH  
99 - OTHER / UNKNOWN

MANNER OF CRASH COLLISION/IMPACT  
5  
1 - NOT COLLISION BETWEEN TWO MOTOR VEHICLES IN TRANSPORT  
2 - REAR-END  
3 - HEAD-ON  
4 - REAR-TO-REAR  
5 - BACKING  
6 - ANGLE  
7 - SIDESWIPE, SAME DIRECTION  
8 - SIDESWIPE, OPPOSITE DIRECTION  
9 - OTHER / UNKNOWN

DIRECTION OF TRAVEL  
1 - NORTH  
2 - SOUTH  
3 - EAST  
4 - WEST

MEDIAN TYPE  
1 - DIVIDED FLUSH MEDIAN (<4 FEET)  
2 - DIVIDED FLUSH MEDIAN (24 FEET)  
3 - DIVIDED, DEPRESSED MEDIAN  
4 - DIVIDED, RAISED MEDIAN (ANY TYPE)  
9 - OTHER / UNKNOWN

- WORK ZONE RELATED  
 WORKERS PRESENT  
 LAW ENFORCEMENT PRESENT  
 ACTIVE SCHOOL ZONE

WORK ZONE TYPE  
1 - LANE CLOSURE  
2 - LANE SHIFT/CROSSOVER  
3 - WORK ON SHOULDER  
4 - IN MEDIAN  
5 - INTERMITTENT OR MOVING WORK  
OTHER

LOCATION OF CRASH IN WORK ZONE  
1 - BEFORE THE 1ST WORK ZONE WARNING SIGN  
2 - ADVANCE WARNING AREA  
3 - TRANSITION AREA  
4 - ACTIVITY AREA  
5 - TERMINATION AREA

CONTOUR  
2  
1 - STRAIGHT LEVEL  
2 - STRAIGHT GRADE  
3 - CURVE LEVEL  
4 - CURVE GRADE  
9 - OTHER / UNKNOWN

CONDITIONS  
1  
1 - DRY  
2 - WET  
3 - SNOW  
4 - ICE  
5 - SAND, MUD, DIRT, OIL, GRAVEL  
6 - WATER (STANDING, MOVING)  
7 - SLUSH  
9 - OTHER/UNKNOWN

SURFACE  
1  
1 - CONCRETE  
2 - BLACKTOP, BITUMINOUS, ASPHALT  
3 - BRICK/BLOCK  
4 - SLAG, GRAVEL, STONE  
5 - DIRT  
9 - OTHER / UNKNOWN

LIGHT CONDITION  
1  
1 - DAYLIGHT  
2 - DAWN/DUSK  
3 - DARK - LIGHTED ROADWAY  
4 - DARK - ROADWAY NOT LIGHTED  
5 - DARK - UNKNOWN ROADWAY LIGHTING  
9 - OTHER / UNKNOWN

WEATHER  
2  
1 - CLEAR  
2 - CLOUDY  
3 - FOG, SMOG, SMOKE  
4 - RAIN  
5 - SLEET, HAIL  
6 - SNOW  
7 - SEVERE CROSSWINDS  
8 - BLOWING SAND, SOIL, DIRT, SNOW  
9 - FREEZING RAIN OR FREEZING DRIZZLE  
99 - OTHER / UNKNOWN

NARRATIVE  
UNIT # 1 WAS TRAVELING NORTH NEAR 5233 E 100 TH ST. UNIT # 2 WAS DIRECTLY BEHIND UNIT # 1. UNIT # 1 BACKED TOWARDS 5237 E 100 TH ST IN A SOUTHERN DIRECTION. AS A RESULT, THE BACK OF UNIT # 1 COLLIDED WITH THE FRONT OF UNIT # 2. UNIT # 1 WAS PARKED FACING NORTH NEAR 5233 E 100 TH AND UNIT # 2 WAS AT FINAL REST UPON ARRIVAL.

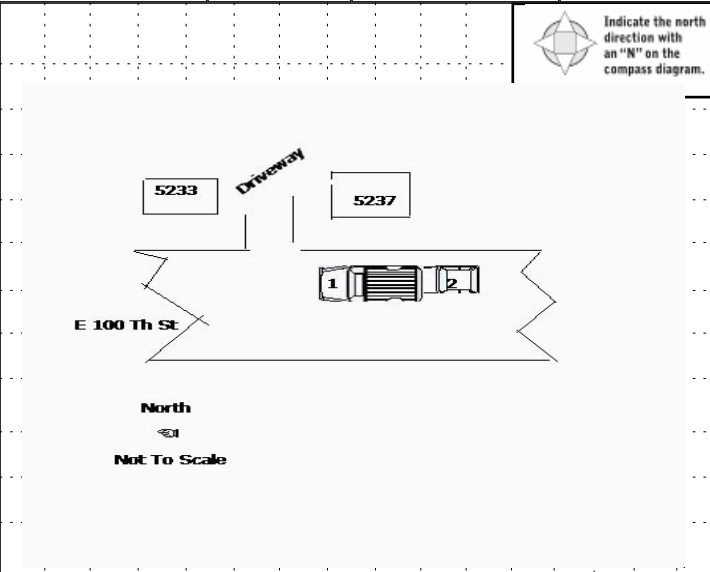

CRASH REPORTED DATE/TIME  
0 | 8 | 0 | 1 | 2 | 0 | 2 | 3 | 1 | 3 | 1 | 8 |

DISPATCH DATE/TIME  
0 | 8 | 0 | 1 | 2 | 0 | 2 | 3 | 1 | 3 | 1 | 9 |

ARRIVAL DATE/TIME  
0 | 8 | 0 | 1 | 2 | 0 | 2 | 3 | 1 | 3 | 3 | 1 |

SCENE CLEARED DATE/TIME  
0 | 8 | 0 | 1 | 2 | 0 | 2 | 3 | 1 | 3 | 4 | 7 |

REPORT TAKEN BY  
 POLICE AGENCY  
 MOTORIST

TOTAL TIME ROADWAY CLOSED  
0

OTHER INVESTIGATION TIME  
3 | 0

TOTAL MINUTES  
4 | 6

OFFICER'S NAME \*  
R. Cramer  
OFFICER'S BADGE NUMBER \*  
0 | 3 | 7

CHECKED BY OFFICER'S NAME \*  
T. Baon  
CHECKED BY OFFICER'S BADGE NUMBER \*  
S | 2 | 0

SUPPLEMENT  
CORRECTION - ADDITION

**UNIT #** 01 **OWNER NAME:** LAST, FIRST, MIDDLE ( ) Same As Driver  
**Kimble Recycling and Disposal**

**OWNER PHONE:** INCLUDE AREA CODE ( ) Same As Driver

**OWNER ADDRESS:** STREET, CITY, STATE, ZIP ( ) Same As Driver  
3596 SR 39 NW Dover OH 44622

**COMMERCIAL CARRIER:** NAME, ADDRESS, CITY, STATE, ZIP  
Kimble 3596 SR 39 NW Dover OH 44622

**COMMERCIAL CARRIER PHONE:** INCLUDE AREA CODE

**LP STATE** OH **LICENSE PLATE #** PLT8198 **VEHICLE IDENTIFICATION #** 1M2LR21G321NM0015839 **VEHICLE YEAR** 2022 **VEHICLE MAKE** Mack

**INSURANCE VERIFIED**  **INSURANCE COMPANY** Employers **INSURANCE POLICY #** 5e6848023 **VEHICLE COLOR** WHI **VEHICLE MODEL** Other/Unknw

**TYPE OF USE**  
 COMMERCIAL  GOVERNMENT  IN EMERGENCY RESPONSE

**US DOT #** 881676 **TOWED BY:** COMPANY NAME

**INTERLOCK DEVICE EQUIPPED**  **HIT/SKIP UNIT**  **# OCCUPANTS** 01 **VEHICLE WEIGHT GVWR/GCWR** 3 **HAZARDOUS MATERIAL**  
 MATERIAL RELEASED  PLACARD **CLASS #** **PLACARD ID #**

**UNIT TYPE** 14  
1 - PASSENGER CAR 7 - MOTORCYCLE 2-WHEELED 12 - GOLF CART 18 - LIMO (LIVERY VEHICLE) 23 - PEDESTRIAN SKATER  
2 - PASSENGER VAN (MINIVAN) 8 - MOTORCYCLE 3-WHEELED 13 - SNOWMOBILE 19 - BUS (16+ PASSENGERS) 24 - WHEELCHAIR (ANY TYPE)  
3 - SPORT UTILITY VEHICLE 9 - AUTOCYCLE 14 - SINGLE UNIT TRUCK 20 - OTHER VEHICLE 25 - OTHER NON-MOTORIST  
4 - PICK UP 10 - MOPED OR MOTORIZED BICYCLE 15 - SEMI-TRACTOR 21 - HEAVY EQUIPMENT 26 - BICYCLE  
5 - CARGO VAN 11 - ALL TERRAIN VEHICLE (ATV / UTV) 16 - FARM EQUIPMENT 22 - ANIMAL WITH RIDER OR ANIMAL-DRAWN VEHICLE 27 - TRAIN  
6 - VAN (9-15 SEATS) 17 - MOTORHOME 16 - FARM EQUIPMENT 99 - UNKNOWN OR HIT/SKIP

**# of TRAILING UNITS**

**WAS VEHICLE OPERATING IN AUTONOMOUS MODE WHEN CRASH OCCURRED?** 2  
1 - YES 2 - NO 9 - OTHER / UNKNOWN

**AUTONOMOUS MODE LEVEL**  
0 - NO AUTOMATION 1 - DRIVER ASSISTANCE 2 - PARTIAL AUTOMATION 3 - CONDITIONAL AUTOMATION 4 - HIGH AUTOMATION 5 - FULL AUTOMATION 9 - UNKNOWN

**SPECIAL FUNCTION** 99  
1 - NONE 2 - TAXI 3 - ELECTRONIC RIDE SHARING 4 - SCHOOL TRANSPORT 5 - BUS-TRANSIT/COMMUTER 6 - BUS - CHARTER/TOUR 7 - BUS - INTERCITY 8 - BUS - SHUTTLE 9 - BUS - OTHER 10 - AMBULANCE 11 - FIRE 12 - MILITARY 13 - POLICE 14 - PUBLIC UTILITY 15 - CONSTRUCTION EQUIPMENT 16 - FARM 17 - MOWING 18 - SNOW REMOVAL 19 - TOWING 20 - SAFETY SERVICE PATROL 21 - MAIL CARRIER 99 - OTHER UNKNOWN

**CARGO BODY TYPE** 14  
1 - NO CARGO BODY TYPE / NOT APPLICABLE 2 - BUS 3 - VEHICLE TOWING ANOTHER MOTOR VEHICLE 4 - LOGGING 5 - INTERMODAL CONTAINER CHASSIS 6 - CARGO VAN/ENCLOSED BOX 7 - GRAIN/CHIPS/GRAVEL 8 - POLE 9 - CARGO TANK 10 - FLAT BED 11 - DUMP 12 - CONCRETE MIXER 13 - AUTO TRANSPORTER 14 - GARBAGE/REFUSE 99 - OTHER / UNKNOWN

**VEHICLE DEFECTS**  
1 - TURN SIGNALS 2 - HEAD LAMPS 3 - TAIL LAMPS 4 - BRAKES 5 - STEERING 6 - TIRE BLOWOUT 7 - WORN OR SLICK TIRES 8 - TRAILER EQUIPMENT DEFECTIVE 9 - MOTOR TROUBLE 10 - DISABLED FROM PRIOR ACCIDENT 99 - OTHER / UNKNOWN

**NON-MOTORIST LOCATION AT IMPACT**  
1 - INTERSECTION - MARKED CROSSWALK 2 - INTERSECTION - UNMARKED CROSSWALK 3 - INTERSECTION - OTHER 4 - MIDBLOCK - MARKED CROSSWALK 5 - TRAVEL LANE-OTHER LOCATION 6 - BICYCLE LANE 7 - SHOULDER/ROADSIDE 8 - SIDEWALK 9 - MEDIAN/CROSSING ISLAND 10 - DRIVEWAY ACCESS 11 - SHARED USE PATHS OR TRAILS 12 - FIRST RESPONDER AT INCIDENT SCENE 99 - OTHER / UNKNOWN

**ACTION** 3  
1 - NON-CONTACT 2 - NON-COLLISION 3 - STRIKING 4 - STRUCK 5 - BOTH STRIKING & STRUCK 9 - OTHER / UNKNOWN  
1 - STRAIGHT AHEAD 2 - BACKING 3 - CHANGING LANES 4 - OVERTAKING/PASSING 5 - MAKING RIGHT TURN 6 - MAKING LEFT TURN 7 - LEFT OF CENTER 8 - FOLLOWING TOO CLOSE/ACDA 9 - IMPROPER LANE CHANGING 10 - IMPROPER PASSING 11 - DROVE OFF ROAD 12 - IMPROPER BACKING 13 - MAKING U-TURN 14 - ENTERING TRAFFIC LANE 15 - LEAVING TRAFFIC LANE 16 - PARKED 17 - SLOWING OR STOPPED IN TRAFFIC 12 - DRIVERLESS 13 - NEGOTIATING A CURVE 14 - ENTERING OR CROSSING SPECIFIED LOCATION 15 - WALKING, RUNNING, JOGGING, PLAYING 16 - WORKING 17 - PUSHING VEHICLE 18 - APPROACHING OR LEAVING VEHICLE 19 - STANDING 20 - OTHER NON-MOTORIST 21 - STANDING OUTSIDE DISABLED VEHICLE 99 - OTHER / UNKNOWN

**CONTRIBUTING CIRCUMSTANCES** 12  
1 - NONE 2 - FAILURE TO YIELD 3 - RAN RED LIGHT 4 - RAN STOP SIGN 5 - UNSAFE SPEED 6 - IMPROPER TURN 7 - IMPROPER START FROM A PARKED POSITION 14 - STOPPED OR PARKED ILLEGALLY 15 - SWERVING TO AVOID 16 - WRONG WAY 17 - VISION OBSTRUCTION 18 - OPERATING DEFECTIVE EQUIPMENT 19 - LOAD SHIFTING/ FALLING/SPILLING 20 - IMPROPER CROSSING 21 - LYING IN ROADWAY 22 - NOT DISCERNABLE 23 - OPENING DOOR INTO ROADWAY 99 - OTHER IMPROPER ACTION

**SEQUENCE OF EVENTS**  
1 2 0  
1 - OVERTURN/ROLLOVER 2 - FIRE/EXPLOSION 3 - IMMERSION 4 - JACKKNIFE 5 - CARGO / EQUIPMENT LOSS OR SHIFT 6 - EQUIPMENT FAILURE 7 - SEPARATION OF UNITS 8 - RAN OFF ROAD RIGHT 9 - RAN OFF ROAD LEFT 10 - CROSS MEDIAN 11 - CROSS CENTERLINE - OPPOSITE DIRECTION OF TRAVEL 12 - DOWNHILL RUNAWAY 13 - OTHER NON-COLLISION 14 - PEDESTRIAN 15 - PEDALCYCLE 16 - RAILWAY VEHICLE 17 - ANIMAL - FARM 18 - ANIMAL - DEER 19 - ANIMAL - OTHER 20 - MOTOR VEHICLE IN TRANSPORT 21 - PARKED MOTOR VEHICLE 22 - WORK ZONE MAINTENANCE EQUIPMENT 23 - STRUCK BY FALLING, SHIFTING CARGO OR ANYTHING SET IN MOTION BY A MOTOR VEHICLE 24 - OTHER MOVABLE OBJECT

**COLLISION WITH FIXED OBJECT - STRUCK**  
25 - IMPACT ATTENUATOR / CRASH CUSHION 26 - BRIDGE OVERHEAD STRUCTURE 27 - BRIDGE PIER OR ABUTMENT 28 - BRIDGE PARAPET 29 - BRIDGE RAIL 30 - GUARDRAIL FACE 31 - GUARDRAIL END 32 - PORTABLE BARRIER 33 - MEDIAN CABLE BARRIER 34 - MEDIAN GUARDRAIL BARRIER 35 - MEDIAN CONCRETE BARRIER 36 - MEDIAN OTHER BARRIER 37 - TRAFFIC SIGN POST 38 - OVERHEAD SIGN POST 39 - LIGHT/LUMINARIES SUPPORT 40 - UTILITY POLE 41 - OTHER POST, POLE OR SUPPORT 42 - CULVERT 43 - CURB 44 - DITCH 45 - EMBANKMENT 46 - FENCE 47 - MAILBOX 48 - TREE 49 - FIRE HYDRANT 50 - WORKZONE MAINTENANCE EQUIPMENT 51 - WALL 52 - BUILDING 53 - TUNNEL 54 - OTHER FIXED OBJECT 99 - OTHER / UNKNOWN

**FIRST HARMFUL EVENT** 1 **MOST HARMFUL EVENT** 1

**LOCAL REPORT NUMBER**  
20232037

**DAMAGE**  
**DAMAGE SCALE**  
1 - NONE 2 - MINOR DAMAGE 3 - FUNCTIONAL DAMAGE 4 - DISABLING DAMAGE 9 - UNKNOWN

**DAMAGED AREA(S)**  
INDICATE ALL THAT APPLY

- NO DAMAGE [0]  - UNDERCARRIAGE [14]  - TOP [13]  - ALL AREAS [15]  - UNIT NOT AT SCENE [16]

**INITIAL POINT OF CONTACT**  
06  
0 - NO DAMAGE 1-12 - REFER TO UNIT DIAGRAM 13 - TOP 14 - UNDERCARRIAGE 15 - VEHICLE NOT AT SCENE 99 - UNKNOWN

**TRAFFIC**  
**TRAFFICWAY FLOW** 2  
1 - ONE-WAY 2 - TWO-WAY  
**TRAFFIC CONTROL** 6  
1 - ROUNDABOUT 2 - SIGNAL 3 - FLASHER 4 - STOP SIGN 5 - YIELD SIGN 6 - NO CONTROL

**# OF THROUGH LANES ON ROAD** 2  
**RAIL GRADE CROSSING** 1  
1 - NOT INVOLVED 2 - INVOLVED - ACTIVE CROSSING 3 - INVOLVED - PASSIVE CROSSING

**UNIT / NON-MOTORIST DIRECTION**  
FROM 1 TO 2  
1 - NORTH 2 - SOUTH 3 - EAST 4 - WEST 5 - NORTHEAST 6 - NORTHWEST 7 - SOUTHEAST 8 - SOUTHWEST 9 - OTHER / UNKNOWN

**UNIT SPEED** 2  
**POSTED SPEED** 0  
**DETECTED SPEED**  
1 - STATED/ESTIMATED SPEED 2 - CALCULATED / EDR 3 - UNDETERMINED

OWNER INFORMATION

UNIT # 02 OWNER NAME: LAST, FIRST, MIDDLE (  Same As Driver )  
**PICOULT GREGORY W**

OWNER PHONE: INCLUDE AREA CODE (  Same As Driver )

OWNER ADDRESS: STREET, CITY, STATE, ZIP (  Same As Driver )  
**917 HEMLOCK LN SAGAMORE HLS OH 44067**

COMMERCIAL CARRIER: NAME, ADDRESS, CITY, STATE, ZIP

COMMERCIAL CARRIER PHONE: INCLUDE AREA CODE

DAMAGE

DAMAGE SCALE

1 - NONE  
2 - MINOR DAMAGE  
3 - FUNCTIONAL DAMAGE  
4 - DISABLING DAMAGE  
9 - UNKNOWN

2

VEHICLE IDENTIFICATION

LP STATE OH LICENSE PLATE # 584XKN VEHICLE IDENTIFICATION # 5NPE34A1F51H468215 VEHICLE YEAR 2017 VEHICLE MAKE Hyundai

INSURANCE VERIFIED  INSURANCE COMPANY State Farm INSURANCE POLICY # 1821370sfp35 VEHICLE COLOR BLU VEHICLE MODEL Sonata

TYPE OF USE:  COMMERCIAL  GOVERNMENT  IN EMERGENCY RESPONSE

INTERLOCK DEVICE EQUIPPED  HIT/SKIP UNIT  # OCCUPANTS 02

US DOT # \_\_\_\_\_ TOWED BY: COMPANY NAME \_\_\_\_\_

VEHICLE WEIGHT GVWR/GCWR: 1- <10K LBS. 2- 10,001 - 26K LBS. 3- >26K LBS.

HAZARDOUS MATERIAL:  MATERIAL RELEASED CLASS # \_\_\_\_\_ PLACARD ID # \_\_\_\_\_  PLACARD

DAMAGED AREA(S)

INDICATE ALL THAT APPLY

1 - NO DAMAGE [0]  2 - UNDERCARRIAGE [14]   
3 - TOP [13]  4 - ALL AREAS [15]   
5 - UNIT NOT AT SCENE [16]

UNIT TYPE

1 - PASSENGER CAR 7 - MOTORCYCLE 2-WHEELED 12 - GOLF CART 18 - LIMO (LIVERY VEHICLE) 23 - PEDESTRIAN SKATER  
2 - PASSENGER VAN (MINIVAN) 8 - MOTORCYCLE 3-WHEELED 13 - SNOWMOBILE 19 - BUS (16+ PASSENGERS) 24 - WHEELCHAIR (ANY TYPE)  
3 - SPORT UTILITY VEHICLE 9 - AUTOCYCLE 14 - SINGLE UNIT TRUCK 20 - OTHER VEHICLE 25 - OTHER NON-MOTORIST  
4 - PICK UP 10 - MOPED OR MOTORIZED BICYCLE 15 - SEMI-TRACTOR 21 - HEAVY EQUIPMENT 26 - BICYCLE  
5 - CARGO VAN 11 - ALL TERRAIN VEHICLE (ATV / UTV) 16 - FARM EQUIPMENT 22 - ANIMAL WITH RIDER OR ANIMAL-DRAWN VEHICLE 27 - TRAIN  
6 - VAN (9-15 SEATS) 17 - MOTORHOME

# of TRAILING UNITS \_\_\_\_\_

WAS VEHICLE OPERATING IN AUTONOMOUS MODE WHEN CRASH OCCURRED? 2

1 - YES 2 - NO 9 - OTHER / UNKNOWN

AUTONOMOUS MODE LEVEL: 0 - NO AUTOMATION 1 - DRIVER ASSISTANCE 2 - PARTIAL AUTOMATION 3 - CONDITIONAL AUTOMATION 4 - HIGH AUTOMATION 5 - FULL AUTOMATION 9 - UNKNOWN

SPECIAL FUNCTION

1 - NONE 6 - BUS - CHARTER/TOUR 11 - FIRE 16 - FARM 21 - MAIL CARRIER  
2 - TAXI 7 - BUS - INTERCITY 12 - MILITARY 17 - MOWING 22 - OTHER UNKNOWN  
3 - ELECTRONIC RIDE SHARING 8 - BUS - SHUTTLE 13 - POLICE 18 - SNOW REMOVAL 23 - SCHOOL BUS  
4 - SCHOOL TRANSPORT 9 - BUS - OTHER 14 - PUBLIC UTILITY 19 - TOWING 24 - GARBAGE/REFUSE  
5 - BUS-TRANSIT/COMMUTER 10 - AMBULANCE 15 - CONSTRUCTION EQUIPMENT 20 - SAFETY SERVICE PATROL 25 - OTHER UNKNOWN

CARGO BODY TYPE

1 - NO CARGO BODY TYPE / NOT APPLICABLE 3 - VEHICLE TOWING ANOTHER MOTOR VEHICLE 5 - INTERMODAL CONTAINER CHASSIS 8 - POLE 12 - CONCRETE MIXER  
2 - BUS 4 - LOGGING 6 - CARGO VAN/ENCLOSED BOX 7 - GRAIN/CHIPS/GRAVEL 9 - CARGO TANK 10 - FLAT BED 11 - DUMP 13 - AUTO TRANSPORTER  
14 - GARBAGE/REFUSE 99 - OTHER / UNKNOWN

VEHICLE DEFECTS

1 - TURN SIGNALS 4 - BRAKES 7 - WORN OR SLICK TIRES 9 - MOTOR TROUBLE 99 - OTHER / UNKNOWN  
2 - HEAD LAMPS 5 - STEERING 8 - TRAILER EQUIPMENT DEFECTIVE 10 - DISABLED FROM PRIOR ACCIDENT

NON-MOTORIST LOCATION AT IMPACT

1 - INTERSECTION - MARKED CROSSWALK 3 - INTERSECTION - OTHER 6 - BICYCLE LANE 9 - MEDIAN/CROSSING ISLAND 12 - FIRST RESPONDER AT INCIDENT SCENE  
2 - INTERSECTION - UNMARKED CROSSWALK 4 - MIDBLOCK - MARKED CROSSWALK 7 - SHOULDER/ROADSIDE 10 - DRIVEWAY ACCESS 99 - OTHER / UNKNOWN  
3 - UNMARKED CROSSWALK 5 - TRAVEL LANE-OTHER LOCATION 8 - SIDEWALK 11 - SHARED USE PATHS OR TRAILS

ACTION

1 - NON-CONTACT 1 - STRAIGHT AHEAD 7 - MAKING U-TURN 13 - NEGOTIATING A CURVE 18 - APPROACHING OR LEAVING VEHICLE  
2 - NON-COLLISION 2 - BACKING 8 - ENTERING TRAFFIC LANE 14 - ENTERING OR CROSSING SPECIFIED LOCATION 19 - STANDING  
3 - STRIKING 3 - CHANGING LANES 9 - LEAVING TRAFFIC LANE 15 - WALKING, RUNNING, JOGGING, PLAYING 20 - OTHER NON-MOTORIST  
4 - STRUCK 4 - OVERTAKING/PASSING 10 - PARKED 16 - WORKING 21 - STANDING OUTSIDE DISABLED VEHICLE  
5 - BOTH STRIKING & STRUCK 5 - MAKING RIGHT TURN IN TRAFFIC 17 - PUSHING VEHICLE 99 - OTHER / UNKNOWN  
9 - OTHER / UNKNOWN 6 - MAKING LEFT TURN 12 - DRIVERLESS

INITIAL POINT OF CONTACT

1 - NO DAMAGE  
1-12 - REFER TO UNIT DIAGRAM  
13 - TOP  
14 - UNDERCARRIAGE  
15 - VEHICLE NOT AT SCENE  
99 - UNKNOWN

CONTRIBUTING CIRCUMSTANCES

1 - NONE 7 - LEFT OF CENTER 13 - IMPROPER START FROM A PARKED POSITION 17 - VISION OBSTRUCTION 21 - LYING IN ROADWAY  
2 - FAILURE TO YIELD 8 - FOLLOWING TOO CLOSE/ACDA 14 - STOPPED OR PARKED ILLEGALLY 18 - OPERATING DEFECTIVE EQUIPMENT 22 - NOT DISCERNABLE  
3 - RAN RED LIGHT 9 - IMPROPER LANE CHANGING 15 - SWERVING TO AVOID 19 - LOAD SHIFTING/ FALLING/SPILLING 23 - OPENING DOOR INTO ROADWAY  
4 - RAN STOP SIGN 10 - IMPROPER PASSING 11 - DROVE OFF ROAD 20 - IMPROPER CROSSING 99 - OTHER IMPROPER ACTION  
5 - UNSAFE SPEED 12 - IMPROPER BACKING 16 - WRONG WAY

TRAFFIC

TRAFFICWAY FLOW

1 - ONE-WAY  
2 - TWO-WAY

TRAFFIC CONTROL

1 - ROUNDABOUT 4 - STOP SIGN  
2 - SIGNAL 5 - YIELD SIGN  
3 - FLASHER 6 - NO CONTROL

SEQUENCE OF EVENTS

EVENTS

1 - OVERTURN/ROLLOVER 6 - EQUIPMENT FAILURE 11 - CROSS CENTERLINE - OPPOSITE DIRECTION OF TRAVEL 16 - RAILWAY VEHICLE 22 - WORK ZONE MAINTENANCE EQUIPMENT  
2 - FIRE/EXPLOSION 7 - SEPARATION OF UNITS 12 - DOWNHILL RUNAWAY 17 - ANIMAL - FARM 23 - STRUCK BY FALLING, SHIFTING CARGO OR ANYTHING SET IN MOTION BY A MOTOR VEHICLE  
3 - IMMERSION 8 - RAN OFF ROAD RIGHT 13 - OTHER NON-COLLISION 18 - ANIMAL - DEER 24 - OTHER MOVABLE OBJECT  
4 - JACKKNIFE 9 - RAN OFF ROAD LEFT 14 - PEDESTRIAN 19 - ANIMAL - OTHER 25 - OTHER FIXED OBJECT  
5 - CARGO / EQUIPMENT LOSS OR SHIFT 10 - CROSS MEDIAN 15 - PEDALCYCLE 20 - MOTOR VEHICLE IN TRANSPORT 99 - OTHER / UNKNOWN  
6 - IMPROPER TURN 11 - DROVE OFF ROAD 12 - IMPROPER BACKING 16 - WRONG WAY

COLLISION WITH FIXED OBJECT - STRUCK

25 - IMPACT ATTENUATOR / CRASH CUSHION 31 - GUARDRAIL END 37 - TRAFFIC SIGN POST 43 - CURB 50 - WORKZONE MAINTENANCE EQUIPMENT  
26 - BRIDGE OVERHEAD STRUCTURE 32 - PORTABLE BARRIER 38 - OVERHEAD SIGN POST 44 - DITCH 51 - WALL  
27 - BRIDGE PIER OR ABUTMENT 33 - MEDIAN CABLE BARRIER 39 - LIGHT/LUMINARIES SUPPORT 45 - EMBANKMENT 52 - BUILDING  
28 - BRIDGE PARAPET 34 - MEDIAN GUARDRAIL BARRIER 40 - UTILITY POLE 46 - FENCE 53 - TUNNEL  
29 - BRIDGE RAIL 35 - MEDIAN CONCRETE BARRIER 41 - OTHER POST, POLE OR SUPPORT 47 - MAILBOX 54 - OTHER FIXED OBJECT  
30 - GUARDRAIL FACE 36 - MEDIAN OTHER BARRIER 42 - CULVERT 48 - TREE 99 - OTHER / UNKNOWN 49 - FIRE HYDRANT

FIRST HARMFUL EVENT 1 MOST HARMFUL EVENT 1

# OF THROUGH LANES ON ROAD 2

RAIL GRADE CROSSING

1 - NOT INVOLVED  
2 - INVOLVED - ACTIVE CROSSING  
3 - INVOLVED - PASSIVE CROSSING

UNIT / NON-MOTORIST DIRECTION

FROM 2 TO 1

1 - NORTH 5 - NORTHEAST  
2 - SOUTH 6 - NORTHWEST  
3 - EAST 7 - SOUTHEAST  
4 - WEST 8 - SOUTHWEST  
9 - OTHER / UNKNOWN

UNIT SPEED 0

POSTED SPEED 25

DETECTED SPEED

1 - STATED/ESTIMATED SPEED  
2 - CALCULATED / EDR  
3 - UNDETERMINED



# OCCUPANT / WITNESS ADDENDUM

LOCAL REPORT NUMBER
2   0   2   3   2   0   3   7

OCCUPANT	UNIT # <b>2</b>	NAME: LAST, FIRST, MIDDLE <b>PICOULT KAREN S</b>	DATE OF BIRTH <b>05011948</b>	AGE <b>75</b>	GENDER <b>F</b>
	ADDRESS: STREET, CITY, STATE, ZIP <b>917 HEMLOCK LN SAGAMORE HILLS OH 44067 2248</b>			CONTACT PHONE - INCLUDE AREA CODE	
	INJURIES <b>5</b>	INJURED TAKEN BY	EMS AGENCY (NAME)	INJURED TAKEN TO: MEDICAL FACILITY (NAME, CITY)	SAFETY EQUIPMENT USED <b>04</b>

OCCUPANT	UNIT #	NAME: LAST, FIRST, MIDDLE	DATE OF BIRTH	AGE	GENDER
	ADDRESS: STREET, CITY, STATE, ZIP			CONTACT PHONE - INCLUDE AREA CODE	
	INJURIES	INJURED TAKEN BY	EMS AGENCY (NAME)	INJURED TAKEN TO: MEDICAL FACILITY (NAME, CITY)	SAFETY EQUIPMENT USED

OCCUPANT	UNIT #	NAME: LAST, FIRST, MIDDLE	DATE OF BIRTH	AGE	GENDER
	ADDRESS: STREET, CITY, STATE, ZIP			CONTACT PHONE - INCLUDE AREA CODE	
	INJURIES	INJURED TAKEN BY	EMS AGENCY (NAME)	INJURED TAKEN TO: MEDICAL FACILITY (NAME, CITY)	SAFETY EQUIPMENT USED

OCCUPANT	UNIT #	NAME: LAST, FIRST, MIDDLE	DATE OF BIRTH	AGE	GENDER
	ADDRESS: STREET, CITY, STATE, ZIP			CONTACT PHONE - INCLUDE AREA CODE	
	INJURIES	INJURED TAKEN BY	EMS AGENCY (NAME)	INJURED TAKEN TO: MEDICAL FACILITY (NAME, CITY)	SAFETY EQUIPMENT USED

<b>INJURIES</b> 1 - FATAL 2 - SUSPECTED SERIOUS INJURY 3 - SUSPECTED MINOR INJURY 4 - POSSIBLE INJURY 5 - NO APPARENT INJURY	<b>SAFETY EQUIPMENT USED</b> 1 - NONE USED - VEHICLE OCCUPANT 2 - SHOULDER BELT ONLY USED 3 - LAP BELT ONLY USED 4 - SHOULDER & LAP BELT USED 5 - CHILD RESTRAINT SYSTEM - FORWARD FACING 6 - CHILD RESTRAINT SYSTEM - REAR FACING 7 - BOOSTER SEAT 8 - HELMET USED 9 - PROTECTIVE PADS USED (ELBOWS, KNEES, ETC.) 10 - REFLECTIVE CLOTHING 11 - LIGHTING - PEDESTRIAN / BICYCLE ONLY 99 - OTHER / UNKNOWN	<b>SEATING POSITION</b> 1 - FRONT - LEFT SIDE (MOTORCYCLE DRIVER) 2 - FRONT - MIDDLE 3 - FRONT - RIGHT SIDE 4 - SECOND - LEFT SIDE (MOTORCYCLE PASSENGER) 5 - SECOND - MIDDLE 6 - SECOND - RIGHT SIDE 7 - THIRD - LEFT SIDE (MOTORCYCLE SIDE CAR) 8 - THIRD - MIDDLE 9 - THIRD - RIGHT SIDE 10 - SLEEPER SECTION OF TRUCK CAB 11 - PASSENGER IN OTHER ENCLOSED CARGO AREA (NON-TRAILING UNIT, BUS, PICK-UP WITH CAP) 12 - PASSENGER IN UNENCLOSED CARGO AREA 13 - TRAILING UNIT 14 - RIDING ON VEHICLE EXTERIOR (NON-TRAILING UNIT) 15 - NON-MOTORIST 99 - OTHER / UNKNOWN	<b>AIR BAG USAGE</b> 1 - NOT DEPLOYED 2 - DEPLOYED FRONT 3 - DEPLOYED SIDE 4 - DEPLOYED BOTH FRONT/SIDE 5 - NOT APPLICABLE 9 - DEPLOYMENT UNKNOWN
<b>INJURED TAKEN BY</b> 1 - NOT TRANSPORTED / TREATED AT SCENE 2 - EMS 3 - POLICE 9 - OTHER / UNKNOWN		<b>EJECTION</b> 1 - NOT EJECTED 2 - PARTIALLY EJECTED 3 - TOTALLY EJECTED 4 - NOT APPLICABLE	
<b>GENDER</b> F - FEMALE M - MALE U - OTHER/UNKNOWN		<b>TRAPPED</b> 1 - NOT TRAPPED 2 - EXTRICATED BY MECHANICAL MEANS 3 - FREED BY NON-MECHANICAL MEANS	

WITNESS	NAME: LAST, FIRST, MIDDLE	DATE OF BIRTH	AGE	GENDER
	ADDRESS: STREET, CITY, STATE, ZIP	CONTACT PHONE - INCLUDE AREA CODE		

WITNESS	NAME: LAST, FIRST, MIDDLE	DATE OF BIRTH	AGE	GENDER
	ADDRESS: STREET, CITY, STATE, ZIP	CONTACT PHONE - INCLUDE AREA CODE		

WITNESS	NAME: LAST, FIRST, MIDDLE	DATE OF BIRTH	AGE	GENDER
	ADDRESS: STREET, CITY, STATE, ZIP	CONTACT PHONE - INCLUDE AREA CODE		

# OHIO TRAFFIC CRASH REPORT

## DIAGRAM / NARRATIVE CONTINUATION

LOCAL REPORT NUMBER 20232037	REPORTING AGENCY GARFIELD HEIGHTS	DATE OF CRASH M 08   D 01   Y 2023
IN COUNTY OF 18	CRASH LOCATION 3 100 Th ST	
<p>The driver of Unit # 1 stated, he thinks the other vehicle pulled up behind him.</p>		
<p>The driver of Unit # 2 stated, he was stopped waiting on the truck. It had backed from 5233 E 100 Th to 5237 E 100 Th St. He was not able to move out of the way and did not see the parked car in front of the garbage truck. BWC</p>		
OFFICER'S SIGNATURE <b>X</b>		BADGE NUMBER 037