

TRAFFIC CRASH REPORT

*DENOTES MANDATORY FIELD FOR SUPPLEMENT REPORT

LOCAL REPORT NUMBER *

2 | 0 | 2 | 3 | 1 | 9 | 0 | 2 | | | |

- PHOTOS TAKEN OH-2 OH-3
 SECONDARY CRASH OH-1P OTHER
 Private Property

LOCAL INFORMATION

REPORTING AGENCY NAME *

GARFIELD HEIGHTS

NCIC *
0 | 1 | 8 | 2 | 0

HITSKIP
1 - Solved
2 - Unsolved

NUMBER OF UNITS
0 | 2

INITIALS AND EDDP
99 - ANIMAL
99 - UNKNOWN

COUNTY *
1 | 8

LOCALITY *
1

LOCATION: CITY, VILLAGE, TOWNSHIP *
GARFIELD HTS

CRASH DATE/TIME *
0 | 7 | 1 | 8 | 2 | 0 | 2 | 3 | | 1 | 0 | 4 | 4 |

CRASH SEVERITY
5

1 - FATAL
2 - SERIOUS INJURY SUSPECTED
3 - MINOR INJURY SUSPECTED
4 - INJURY POSSIBLE
5 - PROPERTY DAMAGE ONLY

ROUTE TYPE
| | | |

ROUTE NUMBER
| | | | | | | |

PREFIX
| |

1 - NORTH
2 - SOUTH
3 - EAST
4 - WEST

LOCATION ROAD NAME
Turney

ROAD TYPE
R | D

LATITUDE DECIMAL DEGREES
4 | 1 | | 4 | 1 | 1 | 0 | 2 | 6 |

ROUTE TYPE
| | | |

ROUTE NUMBER
| | | | | | | |

PREFIX
| |

1 - NORTH
2 - SOUTH
3 - EAST
4 - WEST

REFERENCE ROAD NAME (ROAD, MILEPOST, HOUSE #)
Woodward

ROAD TYPE
A | V

LONGITUDE DECIMAL DEGREES
8 | 1 | | 6 | 0 | 1 | 3 | 4 | 3 |

REFERENCE POINT
1 - INTERSECTION
2 - MILE POST
3 - HOUSE #
1

DIRECTION
1 - NORTH
2 - SOUTH
3 - EAST
4 - WEST

ROUTE TYPE
IR - INTERSTATE ROUTE (TP)
US - FEDERAL US ROUTE
SR - STATE ROUTE
CR - NUMBERED COUNTY ROUTE
TR - NUMBERED TOWNSHIP ROUTE

INTERSECTION RELATED
 WITHIN INTERSECTION OR ON APPROACH
 WITHIN INTERCHANGE AREA

NUMBER OF APPROACHES
| |

DISTANCE
1 - Miles
2 - Feet
3 - Yards

DISTANCE
1 - Miles
2 - Feet
3 - Yards

ROAD TYPE
AL - ALLEY
AV - AVENUE
BL - BOULEVARD
CR - CIRCLE
CT - COURT
DR - DRIVE
HE - HEIGHTS

ROAD TYPE
HW - HIGHWAY
LA - LANE
MP - MILEPOST
OV - OVAL
PK - PARKWAY
PI - PIKE
PL - PLACE

ROADWAY
 ROADWAY DIVIDED

LOCATION OF FIRST DAMAGE EVENT
0 | 1

1 - ON ROADWAY
2 - ON SHOULDER
3 - IN MEDIAN
4 - ON ROADSIDE
5 - ON GORE
6 - OUTSIDE TRAFFICWAY
7 - ON RAMP
8 - OFF RAMP

9 - CROSSOVER
10 - DRIVEWAY / ALLEY ACCESS
11 - RAILWAY GRADE CROSSING
12 - SHARED USE PATHS OR TRAILS
13 - BIKE LANE
14 - TOLL BOOTH
99 - OTHER / UNKNOWN

MANNER OF CRASH COLLISION/IMPACT
8

1 - NOT COLLISION BETWEEN TWO MOTOR VEHICLES IN TRANSPORT
2 - REAR-END
3 - HEAD-ON
4 - REAR-TO-REAR
5 - BACKING
6 - ANGLE
7 - SIDESWIPE, SAME DIRECTION
8 - SIDESWIPE, OPPOSITE DIRECTION
9 - OTHER / UNKNOWN

DIRECTION OF TRAVEL
| |

1 - NORTH
2 - SOUTH
3 - EAST
4 - WEST

MEDIAN TYPE
| |

1 - DIVIDED FLUSH MEDIAN (<4 FEET)
2 - DIVIDED FLUSH MEDIAN (24 FEET)
3 - DIVIDED, DEPRESSED MEDIAN
4 - DIVIDED, RAISED MEDIAN (ANY TYPE)
9 - OTHER / UNKNOWN

- WORK ZONE RELATED
 WORKERS PRESENT
 LAW ENFORCEMENT PRESENT
 ACTIVE SCHOOL ZONE

WORK ZONE TYPE
1 - LANE CLOSURE
2 - LANE SHIFT/CROSSOVER
3 - WORK ON SHOULDER
OR MEDIAN
4 - INTERMITTENT OR MOVING WORK
5 - OTHER

LOCATION OF CRASH IN WORK ZONE
1 - BEFORE THE 1ST WORK ZONE WARNING SIGN
2 - ADVANCE WARNING AREA
3 - TRANSITION AREA
4 - ACTIVITY AREA
5 - TERMINATION AREA

CONTOUR
1

1 - STRAIGHT LEVEL
2 - STRAIGHT GRADE
3 - CURVE LEVEL
4 - CURVE GRADE
9 - OTHER / UNKNOWN

CONDITIONS
1

1 - DRY
2 - WET
3 - SNOW
4 - ICE
5 - SAND, MUD, DIRT, OIL, GRAVEL
6 - WATER (STANDING, MOVING)
7 - SLUSH
9 - OTHER/UNKNOWN

SURFACE
2

1 - CONCRETE
2 - BLACKTOP, BITUMINOUS, ASPHALT
3 - BRICK/BLOCK
4 - SLAG, GRAVEL, STONE
5 - DIRT
9 - OTHER / UNKNOWN

LIGHT CONDITION
1

1 - DAYLIGHT
2 - DAWN/DUSK
3 - DARK - LIGHTED ROADWAY
4 - DARK - ROADWAY NOT LIGHTED
5 - DARK - UNKNOWN ROADWAY LIGHTING
9 - OTHER / UNKNOWN

WEATHER
3

1 - CLEAR
2 - CLOUDY
3 - FOG, SMOG, SMOKE
4 - RAIN
5 - SLEET, HAIL
6 - SNOW
7 - SEVERE CROSSWINDS
8 - BLOWING SAND, SOIL, DIRT, SNOW
9 - FREEZING RAIN OR FREEZING DRIZZLE
99 - OTHER / UNKNOWN

CONTOUR
1

1 - STRAIGHT LEVEL
2 - STRAIGHT GRADE
3 - CURVE LEVEL
4 - CURVE GRADE
9 - OTHER / UNKNOWN

CONDITIONS
1

1 - DRY
2 - WET
3 - SNOW
4 - ICE
5 - SAND, MUD, DIRT, OIL, GRAVEL
6 - WATER (STANDING, MOVING)
7 - SLUSH
9 - OTHER/UNKNOWN

SURFACE
2

1 - CONCRETE
2 - BLACKTOP, BITUMINOUS, ASPHALT
3 - BRICK/BLOCK
4 - SLAG, GRAVEL, STONE
5 - DIRT
9 - OTHER / UNKNOWN

NARRATIVE

UNIT # 1 WAS TRAVELING NORTH ON TURNEY RD NEAR WOODWARD AVE IN THE INSIDE LANE. UNIT # 2 WAS TRAVELING SOUTH ON TURNEY RD NEAR WOODWARD AVE IN THE INSIDE LANE. UNKNOWN ACTIONS TOOK PLACE.. UNIT # 1 LEFT THE SCENE. UNIT # 2 CAME TO THE STATE TO FILE A REPORT. DRIVER OF UNIT # 1 AND OWNER RESPONDED TO STATION ON DATE OF REPORT.

NOTE:SEE OH-2

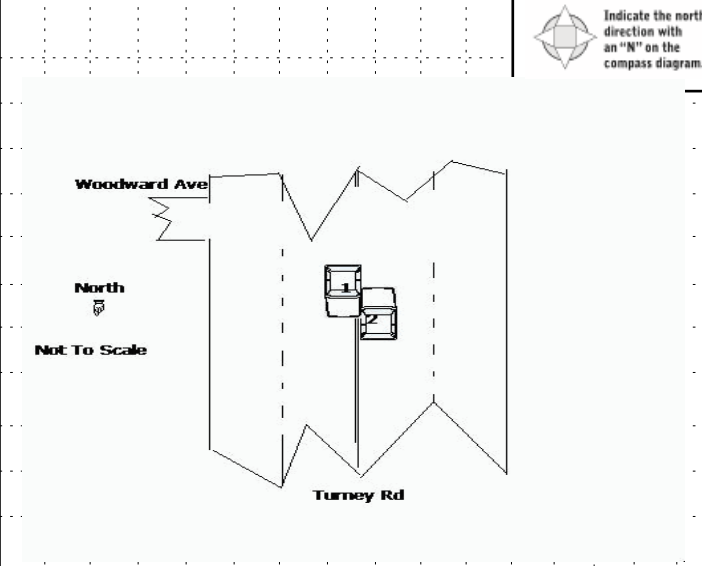

CRASH REPORTED DATE/TIME
0 | 7 | 1 | 8 | 2 | 0 | 2 | 3 | | 1 | 0 | 4 | 4 |

DISPATCH DATE/TIME
0 | 7 | 1 | 8 | 2 | 0 | 2 | 3 | | 1 | 0 | 4 | 7 |

ARRIVAL DATE/TIME
0 | 7 | 1 | 8 | 2 | 0 | 2 | 3 | | 1 | 1 | 0 | 2 |

SCENE CLEARED DATE/TIME
0 | 7 | 1 | 8 | 2 | 0 | 2 | 3 | | 1 | 1 | 1 | 7 |

REPORT TAKEN BY
 POLICE AGENCY
 MOTORIST

TOTAL TIME ROADWAY CLOSED
0

OTHER INVESTIGATION TIME
5 | 0

TOTAL MINUTES
6 | 5

OFFICER'S NAME *
R. Cramer

OFFICER'S BADGE NUMBER*
0 | 3 | 7

CHECKED BY OFFICER'S NAME*
T. Baon

CHECKED BY OFFICER'S BADGE NUMBER*
S | 2 | 0

SUPPLEMENT
(CORRECTION = ADDITION)

UNIT # 0 1 OWNER NAME: LAST, FIRST, MIDDLE () Same As Driver
SINGH JASDEEP

OWNER PHONE: INCLUDE AREA CODE () Same As Driver

OWNER ADDRESS: STREET, CITY, STATE, ZIP () Same As Driver
12125 VALLEY LANE DR 201 GARFIELD HTS OH 44125

COMMERCIAL CARRIER: NAME, ADDRESS, CITY, STATE, ZIP

COMMERCIAL CARRIER PHONE: INCLUDE AREA CODE

DAMAGE

DAMAGE SCALE

1 - NONE
2 - MINOR DAMAGE
3 - FUNCTIONAL DAMAGE
4 - DISABLING DAMAGE
9 - UNKNOWN

1

LP STATE OH LICENSE PLATE # JMK9754 VEHICLE IDENTIFICATION # JJTDBL4L0E09J049371 VEHICLE YEAR 2009 VEHICLE MAKE Toyota

INSURANCE VERIFIED INSURANCE COMPANY Astate Auto INSURANCE POLICY # 10006449874 VEHICLE COLOR RED VEHICLE MODEL Corolla

TYPE OF USE: COMMERCIAL GOVERNMENT IN EMERGENCY RESPONSE

INTERLOCK DEVICE EQUIPPED HIT/SKIP UNIT # OCCUPANTS 0 1

US DOT # _____ TOWED BY: COMPANY NAME _____

HAZARDOUS MATERIAL: MATERIAL RELEASED CLASS # _____ PLACARD ID # _____

DAMAGED AREA(S)
INDICATE ALL THAT APPLY

■ - NO DAMAGE [0] □ - UNDERCARRIAGE [14]
□ - TOP [13] □ - ALL AREAS [15]
□ - UNIT NOT AT SCENE [16]

UNIT TYPE: 1 - PASSENGER CAR, 2 - PASSENGER VAN (MINIVAN), 3 - SPORT UTILITY VEHICLE, 4 - PICK UP, 5 - CARGO VAN, 6 - VAN (9-15 SEATS), 7 - MOTORCYCLE 2-WHEELED, 8 - MOTORCYCLE 3-WHEELED, 9 - AUTOCYCLE, 10 - MOPED OR MOTORIZED BICYCLE, 11 - ALL TERRAIN VEHICLE (ATV / UTV), 12 - GOLF CART, 13 - SNOWMOBILE, 14 - SINGLE UNIT TRUCK, 15 - SEMI-TRACTOR, 16 - FARM EQUIPMENT, 17 - MOTORHOME, 18 - LIMO (LIVERY VEHICLE), 19 - BUS (16+ PASSENGERS), 20 - OTHER VEHICLE, 21 - HEAVY EQUIPMENT, 22 - ANIMAL WITH RIDER OR ANIMAL-DRAWN VEHICLE, 23 - PEDESTRIANSKATER, 24 - WHEELCHAIR (ANY TYPE), 25 - OTHER NON-MOTORIST, 26 - BICYCLE, 27 - TRAIN, 99 - UNKNOWN OR HIT/SKIP

of TRAILING UNITS _____

WAS VEHICLE OPERATING IN AUTONOMOUS MODE WHEN CRASH OCCURRED? 2

1 - YES 2 - NO 9 - OTHER / UNKNOWN

AUTONOMOUS MODE LEVEL: 0 - NO AUTOMATION, 1 - DRIVER ASSISTANCE, 2 - PARTIAL AUTOMATION, 3 - CONDITIONAL AUTOMATION, 4 - HIGH AUTOMATION, 5 - FULL AUTOMATION, 9 - UNKNOWN

SPECIAL FUNCTION: 1 - NONE, 2 - TAXI, 3 - ELECTRONIC RIDE SHARING, 4 - SCHOOL TRANSPORT, 5 - BUS-TRANSIT/COMMUTER, 6 - BUS - CHARTER/TOUR, 7 - BUS - INTERCITY, 8 - BUS - SHUTTLE, 9 - BUS - OTHER, 10 - AMBULANCE, 11 - FIRE, 12 - MILITARY, 13 - POLICE, 14 - PUBLIC UTILITY, 15 - CONSTRUCTION EQUIPMENT, 16 - FARM, 17 - MOWING, 18 - SNOW REMOVAL, 19 - TOWING, 20 - SAFETY SERVICE PATROL, 21 - MAIL CARRIER, 99 - OTHER UNKNOWN

CARGO BODY TYPE: 1 - NO CARGO BODY TYPE / NOT APPLICABLE, 2 - BUS, 3 - VEHICLE TOWING ANOTHER MOTOR VEHICLE, 4 - LOGGING, 5 - INTERMODAL CONTAINER CHASSIS, 6 - CARGO VAN/ENCLOSED BOX, 7 - GRAIN/CHIPS/GRAVEL, 8 - POLE, 9 - CARGO TANK, 10 - FLAT BED, 11 - DUMP, 12 - CONCRETE MIXER, 13 - AUTO TRANSPORTER, 14 - GARBAGE/REFUSE, 99 - OTHER / UNKNOWN

VEHICLE DEFECTS: 1 - TURN SIGNALS, 2 - HEAD LAMPS, 3 - TAIL LAMPS, 4 - BRAKES, 5 - STEERING, 6 - TIRE BLOWOUT, 7 - WORN OR SLICK TIRES, 8 - TRAILER EQUIPMENT DEFECTIVE, 9 - MOTOR TROUBLE, 10 - DISABLED FROM PRIOR ACCIDENT, 99 - OTHER / UNKNOWN

NON-MOTORIST LOCATION AT IMPACT: 1 - INTERSECTION - MARKED CROSSWALK, 2 - INTERSECTION - UNMARKED CROSSWALK, 3 - INTERSECTION - OTHER, 4 - MIDBLOCK - MARKED CROSSWALK, 5 - TRAVEL LANE-OTHER LOCATION, 6 - BICYCLE LANE, 7 - SHOULDER/ROADSIDE, 8 - SIDEWALK, 9 - MEDIAN/CROSSING ISLAND, 10 - DRIVEWAY ACCESS, 11 - SHARED USE PATHS OR TRAILS, 12 - FIRST RESPONDER AT INCIDENT SCENE, 99 - OTHER / UNKNOWN

ACTION: 1 - NON-CONTACT, 2 - NON-COLLISION, 3 - STRIKING, 4 - STRUCK, 5 - BOTH STRIKING & STRUCK, 9 - OTHER / UNKNOWN, 1 - STRAIGHT AHEAD, 2 - BACKING, 3 - CHANGING LANES, 4 - OVERTAKING/PASSING, 5 - MAKING RIGHT TURN, 6 - MAKING LEFT TURN, 7 - MAKING U-TURN, 8 - ENTERING TRAFFIC LANE, 9 - LEAVING TRAFFIC LANE, 10 - PARKED, 11 - SLOWING OR STOPPED IN TRAFFIC, 12 - DRIVERLESS, 13 - NEGOTIATING A CURVE, 14 - ENTERING OR CROSSING SPECIFIED LOCATION, 15 - WALKING, RUNNING, JOGGING, PLAYING, 16 - WORKING, 17 - PUSHING VEHICLE, 18 - APPROACHING OR LEAVING VEHICLE, 19 - STANDING, 20 - OTHER NON-MOTORIST, 21 - STANDING OUTSIDE DISABLED VEHICLE, 99 - OTHER / UNKNOWN

INITIAL POINT OF CONTACT: 0 - NO DAMAGE, 1-12 - REFER TO UNIT DIAGRAM, 13 - TOP, 14 - UNDERCARRIAGE, 15 - VEHICLE NOT AT SCENE, 99 - UNKNOWN

CONTRIBUTING CIRCUMSTANCES: 1 - NONE, 2 - FAILURE TO YIELD, 3 - RAN RED LIGHT, 4 - RAN STOP SIGN, 5 - UNSAFE SPEED, 6 - IMPROPER TURN, 7 - LEFT OF CENTER, 8 - FOLLOWING TOO CLOSE/ACDA, 9 - IMPROPER LANE CHANGING, 10 - IMPROPER PASSING, 11 - DROVE OFF ROAD, 12 - IMPROPER BACKING, 13 - IMPROPER START FROM A PARKED POSITION, 14 - STOPPED OR PARKED ILLEGALLY, 15 - SWERVING TO AVOID, 16 - WRONG WAY, 17 - VISION OBSTRUCTION, 18 - OPERATING DEFECTIVE EQUIPMENT, 19 - LOAD SHIFTING/ FALLING/SPILLING, 20 - IMPROPER CROSSING, 21 - LYING IN ROADWAY, 22 - NOT DISCERNABLE, 23 - OPENING DOOR INTO ROADWAY, 99 - OTHER IMPROPER ACTION

TRAFFIC

TRAFFICWAY FLOW: 2 1 - ONE-WAY, 2 2 - TWO-WAY

TRAFFIC CONTROL: 6 1 - ROUNDABOUT, 6 2 - SIGNAL, 6 3 - FLASHER, 4 - STOP SIGN, 5 - YIELD SIGN, 6 - NO CONTROL

EVENT(S)

SEQUENCE OF EVENTS: 1 2 0

EVENTS: 1 - OVERTURN/ROLLOVER, 2 - FIRE/EXPLOSION, 3 - IMMERSION, 4 - JACKKNIFE, 5 - CARGO / EQUIPMENT LOSS OR SHIFT, 6 - EQUIPMENT FAILURE, 7 - SEPARATION OF UNITS, 8 - RAN OFF ROAD RIGHT, 9 - RAN OFF ROAD LEFT, 10 - CROSS MEDIAN, 11 - CROSS CENTERLINE - OPPOSITE DIRECTION OF TRAVEL, 12 - DOWNHILL RUNAWAY, 13 - OTHER NON-COLLISION, 14 - PEDESTRIAN, 15 - PEDALCYCLE, 16 - RAILWAY VEHICLE, 17 - ANIMAL - FARM, 18 - ANIMAL - DEER, 19 - ANIMAL - OTHER, 20 - MOTOR VEHICLE IN TRANSPORT, 21 - PARKED MOTOR VEHICLE, 22 - WORK ZONE MAINTENANCE EQUIPMENT, 23 - STRUCK BY FALLING, SHIFTING CARGO OR ANYTHING SET IN MOTION BY A MOTOR VEHICLE, 24 - OTHER MOVABLE OBJECT

COLLISION WITH FIXED OBJECT - STRUCK

25 - IMPACT ATTENUATOR / CRASH CUSHION, 26 - BRIDGE OVERHEAD STRUCTURE, 27 - BRIDGE PIER OR ABUTMENT, 28 - BRIDGE PARAPET, 29 - BRIDGE RAIL, 30 - GUARDRAIL FACE, 31 - GUARDRAIL END, 32 - PORTABLE BARRIER, 33 - MEDIAN CABLE BARRIER, 34 - MEDIAN GUARDRAIL BARRIER, 35 - MEDIAN CONCRETE BARRIER, 36 - MEDIAN OTHER BARRIER, 37 - TRAFFIC SIGN POST, 38 - OVERHEAD SIGN POST, 39 - LIGHT/LUMINARIES SUPPORT, 40 - UTILITY POLE, 41 - OTHER POST, POLE OR SUPPORT, 42 - CULVERT, 43 - CURB, 44 - DITCH, 45 - EMBANKMENT, 46 - FENCE, 47 - MAILBOX, 48 - TREE, 49 - FIRE HYDRANT, 50 - WORKZONE MAINTENANCE EQUIPMENT, 51 - WALL, 52 - BUILDING, 53 - TUNNEL, 54 - OTHER FIXED OBJECT, 99 - OTHER / UNKNOWN

FIRST HARMFUL EVENT: 1 MOST HARMFUL EVENT: 1

OF THROUGH LANES ON ROAD: 4

RAIL GRADE CROSSING: 1 1 - NOT INVOLVED, 1 2 - INVOLVED - ACTIVE CROSSING, 1 3 - INVOLVED - PASSIVE CROSSING

UNIT / NON-MOTORIST DIRECTION

FROM 2 TO 1

1 - NORTH, 2 - SOUTH, 3 - EAST, 4 - WEST, 5 - NORTHEAST, 6 - NORTHWEST, 7 - SOUTHEAST, 8 - SOUTHWEST, 9 - OTHER / UNKNOWN

UNIT SPEED: 3 0

POSTED SPEED: 2 5

DETECTED SPEED: 1 1 - STATED/ESTIMATED SPEED, 2 - CALCULATED / EDR, 3 - UNDETERMINED

UNIT # 02 OWNER NAME: LAST, FIRST, MIDDLE (Same As Driver)
MCKENZIE DASIAH ASIAH MERCEDEZE
 OWNER PHONE: INCLUDE AREA CODE (Same As Driver)
 OWNER ADDRESS: STREET, CITY, STATE, ZIP (Same As Driver)
12800 Eastwood GARFIELD HTS OH 44125
 COMMERCIAL CARRIER: NAME, ADDRESS, CITY, STATE, ZIP
 COMMERCIAL CARRIER PHONE: INCLUDE AREA CODE

LOCAL REPORT NUMBER
20231902

LP STATE OH LICENSE PLATE # JSY3916 VEHICLE IDENTIFICATION # 1C4R1JFBG91HC65181Z VEHICLE YEAR 2017 VEHICLE MAKE Jeep
 INSURANCE VERIFIED INSURANCE COMPANY _____ INSURANCE POLICY # _____ VEHICLE COLOR GRY VEHICLE MODEL Other/Unknw
 COMMERCIAL GOVERNMENT IN EMERGENCY RESPONSE US DOT # _____ TOWED BY: COMPANY NAME _____
 INTERLOCK DEVICE EQUIPPED HIT/SKIP UNIT # OCCUPANTS 01 VEHICLE WEIGHT GVWR/GVWR HAZARDOUS MATERIAL
 1- <10K LBS. 2- 10,001 - 26K LBS. 3- >26K LBS. MATERIAL RELEASED CLASS # _____ PLACARD ID # _____
 PLACARD

DAMAGE
 DAMAGE SCALE
 1- NONE 2- MINOR DAMAGE 3- FUNCTIONAL DAMAGE 4- DISABLING DAMAGE
2 9- UNKNOWN

UNIT TYPE 03 # of TRAILING UNITS _____
 1- PASSENGER CAR 7- MOTORCYCLE 2-WHEELED 12- GOLF CART 18- LIMO (LIVERY VEHICLE) 23- PEDESTRIAN SKATER
 2- PASSENGER VAN (MINIVAN) 8- MOTORCYCLE 3-WHEELED 13- SNOWMOBILE 19- BUS (16+ PASSENGERS) 24- WHEELCHAIR (ANY TYPE)
 3- SPORT UTILITY VEHICLE 9- AUTOCYCLE 14- SINGLE UNIT TRUCK 20- OTHER VEHICLE 25- OTHER NON-MOTORIST
 4- PICK UP 10- MOPED OR MOTORIZED BICYCLE 15- SEMI-TRACTOR 21- HEAVY EQUIPMENT 26- BICYCLE
 5- CARGO VAN 11- ALL TERRAIN VEHICLE (ATV / UTV) 16- FARM EQUIPMENT 22- ANIMAL WITH RIDER OR ANIMAL-DRAWN VEHICLE 27- TRAIN
 6- VAN (9-15 SEATS) 17- MOTORHOME 99- UNKNOWN OR HIT/SKIP

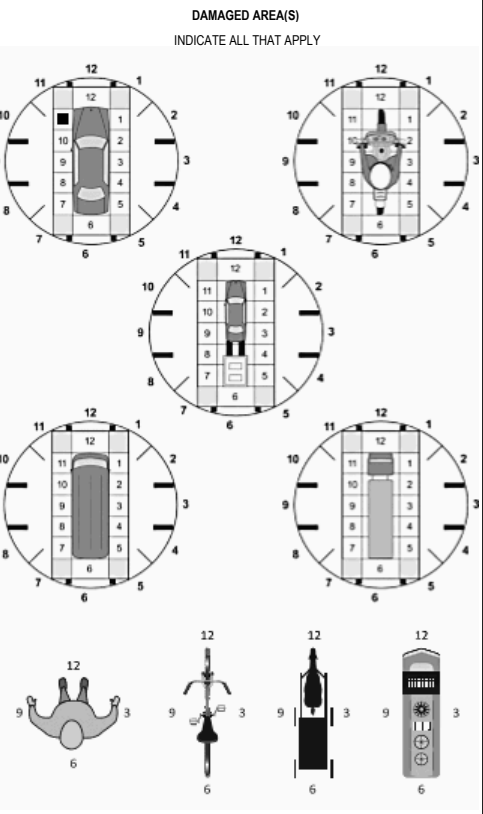

WAS VEHICLE OPERATING IN AUTONOMOUS MODE WHEN CRASH OCCURRED? 2 AUTONOMOUS MODE LEVEL 0
 1- YES 2- NO 9- OTHER / UNKNOWN
 0- NO AUTOMATION 1- DRIVER ASSISTANCE 3- CONDITIONAL AUTOMATION 9- UNKNOWN
 1- PARTIAL AUTOMATION 2- PARTIAL AUTOMATION 4- HIGH AUTOMATION 5- FULL AUTOMATION

SPECIAL FUNCTION 01 CARGO BODY TYPE 01
 1- NONE 2- TAXI 3- ELECTRONIC RIDE SHARING 4- SCHOOL TRANSPORT 5- BUS-TRANSIT/COMMUTER 6- BUS-CHARTER/TOUR 7- BUS-INTERCITY 8- BUS-SHUTTLE 9- BUS-OTHER 10- AMBULANCE 11- FIRE 12- MILITARY 13- POLICE 14- PUBLIC UTILITY 15- CONSTRUCTION EQUIPMENT 16- FARM 17- MOWING 18- SNOW REMOVAL 19- TOWING 20- SAFETY SERVICE PATROL 21- MAIL CARRIER 99- OTHER UNKNOWN
 1- NO CARGO BODY TYPE / NOT APPLICABLE 2- BUS 3- VEHICLE TOWING ANOTHER MOTOR VEHICLE 4- LOGGING 5- INTERMODAL CONTAINER CHASSIS 6- CARGO VAN/ENCLOSED BOX 7- GRAIN/CHIPS/GRAVEL 8- POLE 9- CARGO TANK 10- FLAT BED 11- DUMP 12- CONCRETE MIXER 13- AUTO TRANSPORTER 14- GARBAGE/REFUSE 99- OTHER / UNKNOWN

VEHICLE DEFECTS 01
 1- TURN SIGNALS 2- HEAD LAMPS 3- TAIL LAMPS 4- BRAKES 5- STEERING 6- TIRE BLOWOUT 7- WORN OR SLICK TIRES 8- TRAILER EQUIPMENT DEFECTIVE 9- MOTOR TROUBLE 10- DISABLED FROM PRIOR ACCIDENT 99- OTHER / UNKNOWN

NON-MOTORIST LOCATION AT IMPACT 01 ACTION 4 PRE-CRASH ACTION 01
 1- INTERSECTION - MARKED CROSSWALK 2- INTERSECTION - UNMARKED CROSSWALK 3- INTERSECTION - OTHER 4- MIDBLOCK - MARKED CROSSWALK 5- TRAVEL LANE-OTHER LOCATION 6- BICYCLE LANE 7- SHOULDER/ROADSIDE 8- SIDEWALK 9- MEDIAN/CROSSING ISLAND 10- DRIVEWAY ACCESS 11- SHARED USE PATHS OR TRAILS 12- FIRST RESPONDER AT INCIDENT SCENE 99- OTHER / UNKNOWN
 1- NON-CONTACT 2- NON-COLLISION 3- STRIKING 4- STRUCK 5- BOTH STRIKING & STRUCK 9- OTHER / UNKNOWN 1- STRAIGHT AHEAD 2- BACKING 3- CHANGING LANES 4- OVERTAKING/PASSING 5- MAKING RIGHT TURN 6- MAKING LEFT TURN 7- MAKING U-TURN 8- ENTERING TRAFFIC LANE 9- LEAVING TRAFFIC LANE 10- PARKED 11- SLOWING OR STOPPED IN TRAFFIC 12- DRIVERLESS 13- NEGOTIATING A CURVE 14- ENTERING OR CROSSING SPECIFIED LOCATION 15- WALKING, RUNNING, JOGGING, PLAYING 16- WORKING 17- PUSHING VEHICLE 18- APPROACHING OR LEAVING VEHICLE 19- STANDING 20- OTHER NON-MOTORIST 21- STANDING OUTSIDE DISABLED VEHICLE 99- OTHER / UNKNOWN

INITIAL POINT OF CONTACT 11
 0- NO DAMAGE 1-12- REFER TO UNIT DIAGRAM 13- TOP 14- UNDERCARRIAGE 15- VEHICLE NOT AT SCENE 99- UNKNOWN

CONTRIBUTING CIRCUMSTANCES 01
 1- NONE 2- FAILURE TO YIELD 3- RAN RED LIGHT 4- RAN STOP SIGN 5- UNSAFE SPEED 6- IMPROPER TURN 7- LEFT OF CENTER 8- FOLLOWING TOO CLOSE/ACDA 9- IMPROPER LANE CHANGING 10- IMPROPER PASSING 11- DROVE OFF ROAD 12- IMPROPER BACKING 13- IMPROPER START FROM A PARKED POSITION 14- STOPPED OR PARKED ILLEGALLY 15- SWERVING TO AVOID 16- WRONG WAY 17- VISION OBSTRUCTION 18- OPERATING DEFECTIVE EQUIPMENT 19- LOAD SHIFTING/ FALLING/SPILLING 20- IMPROPER CROSSING 21- LYING IN ROADWAY 22- NOT DISCERNABLE 23- OPENING DOOR INTO ROADWAY 99- OTHER IMPROPER ACTION

TRAFFIC
 TRAFFICWAY FLOW 2 TRAFFIC CONTROL 6
 1- ONE-WAY 2- TWO-WAY 1- ROUNDABOUT 2- SIGNAL 3- FLASHER 4- STOP SIGN 5- YIELD SIGN 6- NO CONTROL

EVENT(S)
 SEQUENCE OF EVENTS
 1 20 2 _____ 3 _____
 1- OVERTURN/ROLLOVER 2- FIRE/EXPLOSION 3- IMMERSION 4- JACKKNIFE 5- CARGO / EQUIPMENT LOSS OR SHIFT 6- EQUIPMENT FAILURE 7- SEPARATION OF UNITS 8- RAN OFF ROAD RIGHT 9- RAN OFF ROAD LEFT 10- CROSS MEDIAN 11- CROSS CENTERLINE - OPPOSITE DIRECTION OF TRAVEL 12- DOWNHILL RUNAWAY 13- OTHER NON-COLLISION 14- PEDESTRIAN 15- PEDALCYCLE 16- RAILWAY VEHICLE 17- ANIMAL - FARM 18- ANIMAL - DEER 19- ANIMAL - OTHER 20- MOTOR VEHICLE IN TRANSPORT 21- PARKED MOTOR VEHICLE 22- WORK ZONE MAINTENANCE EQUIPMENT 23- STRUCK BY FALLING, SHIFTING CARGO OR ANYTHING SET IN MOTION BY A MOTOR VEHICLE 24- OTHER MOVABLE OBJECT
 COLLISION WITH FIXED OBJECT - STRUCK
 25- IMPACT ATTENUATOR / CRASH CUSHION 26- BRIDGE OVERHEAD STRUCTURE 27- BRIDGE PIER OR ABUTMENT 28- BRIDGE PARAPET 29- BRIDGE RAIL 30- GUARDRAIL FACE 31- GUARDRAIL END 32- PORTABLE BARRIER 33- MEDIAN CABLE BARRIER 34- MEDIAN GUARDRAIL BARRIER 35- MEDIAN CONCRETE BARRIER 36- MEDIAN OTHER BARRIER 37- TRAFFIC SIGN POST 38- OVERHEAD SIGN POST 39- LIGHT/LUMINARIES SUPPORT 40- UTILITY POLE 41- OTHER POST, POLE OR SUPPORT 42- CULVERT 43- CURB 44- DITCH 45- EMBANKMENT 46- FENCE 47- MAILBOX 48- TREE 49- FIRE HYDRANT 50- WORKZONE MAINTENANCE EQUIPMENT 51- WALL 52- BUILDING 53- TUNNEL 54- OTHER FIXED OBJECT 99- OTHER / UNKNOWN
 FIRST HARMFUL EVENT 1 MOST HARMFUL EVENT 1

TRAFFIC
 # OF THROUGH LANES ON ROAD 4 RAIL GRADE CROSSING 1
 1- NOT INVOLVED 2- INVOLVED - ACTIVE CROSSING 3- INVOLVED - PASSIVE CROSSING
 UNIT / NON-MOTORIST DIRECTION
 FROM 1 TO 2
 1- NORTH 2- SOUTH 3- EAST 4- WEST 5- NORTHEAST 6- NORTHWEST 7- SOUTHEAST 8- SOUTHWEST 9- OTHER / UNKNOWN
 UNIT SPEED 25 POSTED SPEED 25
 DETECTED SPEED 1
 1- STATED/ESTIMATED SPEED 2- CALCULATED / EDR 3- UNDETERMINED

MOTORIST / NON-MOTORIST

LOCAL REPORT NUMBER
2 0 2 3 1 9 0 2

UNIT # 0 1	NAME: LAST, FIRST, MIDDLE KAUR MANJIT	DATE OF BIRTH 1 2 1 2 1 9 5 7	AGE 6 5	GENDER F
ADDRESS: STREET, CITY, STATE, ZIP 12125 VALLEY LANE DR 201 GARFIELD HTS OH 44125		CONTACT PHONE - INCLUDE AREA CODE		
INJURIES 5	INJURED TAKEN BY	EMS AGENCY (NAME)	INJURED TAKEN TO: MEDICAL FACILITY (NAME, CITY)	SAFETY EQUIPMENT USED 0 4
OL STATE	OPERATOR LICENSE NUMBER	OFFENSE CHARGED	LOCAL CODE	OFFENSE DESCRIPTION
OL CLASS 4	ENDORSEMENT SELECT UP TO 2	RESTRICTION SELECT UP TO 3	DRIVER DISTRACTED BY 1	ALCOHOL / DRUG SUSPECTED ALCOHOL OTHER DRUG
CONDITION 9	STATUS 1	ALCOHOL TEST TYPE 1	VALUE	STATUS 1
DRUG TEST(S) TYPE 1		RESULT SELECT UP TO 4		

UNIT # 0 2	NAME: LAST, FIRST, MIDDLE MCKENZIE DASIAH ASIAH MERCEDEZE	DATE OF BIRTH 0 7 1 4 2 0 0 3	AGE 2 0	GENDER F
ADDRESS: STREET, CITY, STATE, ZIP 12800 Eastwood GARFIELD HTS OH 44125		CONTACT PHONE - INCLUDE AREA CODE		
INJURIES 5	INJURED TAKEN BY	EMS AGENCY (NAME)	INJURED TAKEN TO: MEDICAL FACILITY (NAME, CITY)	SAFETY EQUIPMENT USED 0 4
OL STATE	OPERATOR LICENSE NUMBER	OFFENSE CHARGED	LOCAL CODE	OFFENSE DESCRIPTION
OL CLASS 4	ENDORSEMENT SELECT UP TO 2	RESTRICTION SELECT UP TO 3	DRIVER DISTRACTED BY 1	ALCOHOL / DRUG SUSPECTED ALCOHOL OTHER DRUG
CONDITION 1	STATUS 1	ALCOHOL TEST TYPE 1	VALUE	STATUS 1
DRUG TEST(S) TYPE 1		RESULT SELECT UP TO 4		

UNIT #	NAME: LAST, FIRST, MIDDLE	DATE OF BIRTH	AGE	GENDER
ADDRESS: STREET, CITY, STATE, ZIP		CONTACT PHONE - INCLUDE AREA CODE		
INJURIES	INJURED TAKEN BY	EMS AGENCY (NAME)	INJURED TAKEN TO: MEDICAL FACILITY (NAME, CITY)	SAFETY EQUIPMENT USED
OL STATE	OPERATOR LICENSE NUMBER	OFFENSE CHARGED	LOCAL CODE	OFFENSE DESCRIPTION
OL CLASS	ENDORSEMENT SELECT UP TO 2	RESTRICTION SELECT UP TO 3	DRIVER DISTRACTED BY	ALCOHOL / DRUG SUSPECTED
CONDITION	STATUS	ALCOHOL TEST TYPE	VALUE	STATUS
DRUG TEST(S) TYPE		RESULT SELECT UP TO 4		

INJURIES	SEATING POSITION	AIR BAG	OL CLASS	OL RESTRICTION(S)	DRIVER DISTRACTION	TEST STATUS
1 - FATAL	1 - FRONT - LEFT SIDE (MOTORCYCLE DRIVER)	1 - NOT DEPLOYED	1 - CLASS A	1 - ALCOHOL INTERLOCK DEVICE	1 - NOT DISTRACTED	1 - NONE GIVEN
2 - SUSPECTED SERIOUS INJURY	2 - FRONT - MIDDLE	2 - DEPLOYED FRONT	2 - CLASS B	2 - CDL INTRASTATE ONLY	2 - MANUALLY OPERATING AN ELECTRONIC COMMUNICATION DEVICE (TEXTING, TYPING, DIALING)	2 - TEST REFUSED
3 - SUSPECTED MINOR INJURY	3 - FRONT - RIGHT SIDE	3 - DEPLOYED SIDE	3 - CLASS C	3 - CORRECTIVE LENSES	3 - TALKING ON HANDS-FREE COMMUNICATION DEVICE	3 - TEST GIVEN, CONTAMINATED SAMPLE / UNSABLE
4 - POSSIBLE INJURY	4 - SECOND - LEFT SIDE (MOTORCYCLE PASSENGER)	4 - DEPLOYED BOTH FRONT / SIDE	4 - REGULAR CLASS (OHIO = D)	4 - FARM WAIVER	4 - TALKING ON HAND-HELD COMMUNICATION DEVICE	4 - TEST GIVEN, RESULTS KNOWN
5 - NO APPARENT INJURY	5 - SECOND - MIDDLE	5 - NOT APPLICABLE	5 - M / C MOPED ONLY	5 - EXCEPT CLASS A BUS & CLASS B BUS	5 - OTHER ACTIVITY WITH AN ELECTRONIC DEVICE	5 - TEST GIVEN, RESULTS UNKNOWN
INJURED TAKEN BY		EJECTION		ALCOHOL TEST TYPE		
1 - NOT TRANSPORTED / TREATED AT SCENE	7 - THIRD - LEFT SIDE (MOTORCYCLE SIDE CAR)	1 - NOT EJECTED	H - HAZMAT	6 - PASSENGER	6 - PASSENGER	1 - NONE
2 - EMS	8 - THIRD - MIDDLE	2 - PARTIALLY EJECTED	M - MOTORCYCLE	7 - OTHER DISTRACTION INSIDE THE VEHICLE	7 - OTHER DISTRACTION INSIDE THE VEHICLE	2 - BLOOD
3 - POLICE	9 - THIRD - RIGHT SIDE	3 - TOTALLY EJECTED	P - PASSENGER	8 - OTHER DISTRACTIONS OUTSIDE THE VEHICLE	8 - OTHER DISTRACTIONS OUTSIDE THE VEHICLE	3 - URINE
9 - OTHER / UNKNOWN	10 - SLEEPER SECTION OF TRUCK CAB	4 - NOT APPLICABLE	N - TANKER	9 - OTHER / UNKNOWN	9 - OTHER / UNKNOWN	4 - BREATH
SAFETY EQUIPMENT		TRAPPED		CONDITION		5 - OTHER
1 - NONE USED	12 - PASSENGER IN UNENCLOSED CARGO AREA	1 - NOT TRAPPED	Q - MOTOR SCOOTER	1 - APPARENTLY NORMAL	1 - APPARENTLY NORMAL	
2 - SHOULDER BELT ONLY USED	13 - TRAILING UNIT	2 - EXTRICATED BY MECHANICAL MEANS	R - THREE-WHEEL MOTORCYCLE	2 - PHYSICAL IMPAIRMENT	2 - PHYSICAL IMPAIRMENT	
3 - LAP BELT ONLY USED	14 - RIDING ON VEHICLE EXTERIOR (NON-TRAILING UNIT)	3 - FREED BY NON-MECHANICAL MEANS	S - SCHOOL BUS	3 - EMOTIONAL (E.G. DEPRESSED, ANGRY, DISTURBED)	3 - EMOTIONAL (E.G. DEPRESSED, ANGRY, DISTURBED)	
4 - SHOULDER & LAP BELT USED	15 - NON-MOTORIST		T - DOUBLE & TRIPLE TRAILERS	4 - ILLNESS	4 - ILLNESS	
5 - CHILD RESTRAINT SYSTEM - FORWARD FACING	99 - OTHER / UNKNOWN		X - TANKER / HAZMAT	5 - FELL ASLEEP, FAINTED, FATIGUED, ETC.	5 - FELL ASLEEP, FAINTED, FATIGUED, ETC.	
6 - CHILD RESTRAINT SYSTEM - REAR FACING				6 - UNDER THE INFLUENCE OF MEDICATIONS / DRUGS / ALCOHOL	6 - UNDER THE INFLUENCE OF MEDICATIONS / DRUGS / ALCOHOL	
7 - BOOSTER SEAT				7 - OTHER / UNKNOWN	7 - OTHER / UNKNOWN	
8 - HELMET USED						
9 - PROTECTIVE PADS USED (ELBOWS, KNEES, ETC.)						
10 - REFLECTIVE CLOTHING						
11 - LIGHTING - PEDESTRIAN / BICYCLE ONLY						
99 - OTHER / UNKNOWN						
		GENDER		DRUG TEST TYPE		1 - NONE
		F - FEMALE		2 - BLOOD		2 - BLOOD
		M - MALE		3 - URINE		3 - URINE
		U - OTHER/UNKNOWN		4 - OTHER		4 - OTHER
				DRUG TEST RESULT(S)		1 - AMPHETAMINES
						2 - BARBITURATES
						3 - BENZODIAZEPINES
						4 - CANNABINOIDS
						5 - COCAINE
						6 - OPIATES / OPIOIDS
						7 - OTHER
						8 - NEGATIVE RESULTS

LOCAL REPORT NUMBER 20231902	REPORTING AGENCY GARFIELD HEIGHTS	DATE OF CRASH M 07 D 18 Y 2023
IN COUNTY OF 18	CRASH LOCATION	
<p>Driver of Unit # 2 stated, the other vehicle appeared to be swerving on approach. It then crossed the double yellow line in southbound lane and side swiped the left front of her vehicle. The other car continued, was over taken, and contact was attempted with other driver. A picture was taken of the vehicle and provided to police.</p> <p>This officer made contact via phone with owner of Unit #1. Owner advised, family member had vehicle and they would respond to station. The owner would assist with a language barrier.</p> <p>This officer observed Unit # 1 and made contact with the driver. No damaged was observed to Unit # 1. The driver of Unit # 1 stated (with assistance of nephew), they made no contact with any other vehicles. Another car pulled up on her and the driver was yelling. After being concerned for safety, left the scene / area.</p> <p>At time of report, there was no independent witnesses. BWC</p>		
OFFICER'S SIGNATURE X		BADGE NUMBER 037