

TRAFFIC CRASH REPORT

*DENOTES MANDATORY FIELD FOR S

LOCAL REPORT NUMBER *

2 0 2 3 0 5 3 5

PHOTOS TAKEN OH-2 OH-3
 SECONDARY CRASH OH-1P OTHER
 Private Property

LOCAL INFORMATION

REPORTING AGENCY NAME *

GARFIELD HEIGHTS

NCIC *

0 1 8 2 0

HIT/SKIP
1 - Solved
2 - Unsolved

NUMBER OF UNITS
0 2

UNIT IN ERROR
98 - ANIMAL
99 - UNKNOWN
9 9

COUNTY * 1 8
 LOCALITY * 1
 1 - CITY *
 2 - VILLAGE *
 3 - TOWNSHIP *

LOCATION: CITY, VILLAGE, TOWNSHIP *
 GARFIELD HTS

CRASH DATE/TIME *
 0 2 2 3 2 0 2 3 1 1 1 1

CRASH SEVERITY
 1 - FATAL
 2 - SERIOUS INJURY SUSPECTED
 3 - MINOR INJURY SUSPECTED
 4 - INJURY POSSIBLE
 5 - PROPERTY DAMAGE ONLY
 5

ROUTE TYPE S R
 ROUTE NUMBER 1 4

PREFIX
 1 - NORTH
 2 - SOUTH
 3 - EAST
 4 - WEST

LOCATION ROAD NAME
 Broadway

ROAD TYPE R D

LATITUDE DECIMAL DEGREES
 4 1 . 4 2 8 2 3 5

ROUTE TYPE
 ROUTE NUMBER

PREFIX
 1 - NORTH
 2 - SOUTH
 3 - EAST
 4 - WEST

REFERENCE ROAD NAME (ROAD, MILEPOST, HOUSE #)
 13505

ROAD TYPE

LONGITUDE DECIMAL DEGREES
 8 1 . 5 8 7 5 5 2

REFERENCE POINT
 1 - INTERSECTION
 2 - MILE POST
 3 - HOUSE #
 3

DIRECTION
 1 - NORTH
 2 - SOUTH
 3 - EAST
 4 - WEST

ROUTE TYPE
 IR - INTERSTATE ROUTE (TP)
 US - FEDERAL US ROUTE
 SR - STATE ROUTE
 CR - NUMBERED COUNTY ROUTE
 TR - NUMBERED TOWNSHIP ROUTE

ROAD TYPE
 AL - ALLEY
 AV - AVENUE
 BL - BOULEVARD
 CR - CIRCLE
 CT - COURT
 DR - DRIVE
 HE - HEIGHTS

INTERSECTION RELATED
 WITHIN INTERSECTION OR ON APPROACH
 WITHIN INTERCHANGE AREA

NUMBER OF APPROACHES

DISTANCE FROM REFERENCE
 DISTANCE UNIT OF MEASURE
 1 - Miles
 2 - Feet
 3 - Yards

DIRECTION

ROAD TYPE
 HW - HIGHWAY
 LA - LANE
 MP - MILEPOST
 OV - OVAL
 PK - PARKWAY
 PI - PIKE
 PL - PLACE
 RD - ROAD
 SQ - SQUARE
 ST - STREET
 TE - TERRACE
 TL - TRAIL
 WA - WAY

ROADWAY
 ROADWAY DIVIDED

LOCATION OF FIRST HARMFUL EVE
 0 6
 1 - ON ROADWAY
 2 - ON SHOULDER
 3 - IN MEDIAN
 4 - ON ROADSIDE
 5 - ON GORE
 6 - OUTSIDE TRAFFICWAY
 7 - ON RAMP
 8 - OFF RAMP

MANNER OF CRASH COLLISION/IMPACT
 1
 1 - NOT COLLISION BETWEEN TWO MOTOR VEHICLES IN TRANSPORT
 2 - REAR-END
 3 - HEAD-ON
 4 - REAR-TO-REAR
 5 - BACKING
 6 - ANGLE
 7 - SIDESWIPE, SAME DIRECTION
 8 - SIDESWIPE, OPPOSITE DIRECTION
 9 - OTHER / UNKNOWN

DIRECTION OF TRAVEL
 1 - NORTH
 2 - SOUTH
 3 - EAST
 4 - WEST

MEDIAN TYPE
 1 - DIVIDED FLUSH MEDIAN (<4 FEET)
 2 - DIVIDED FLUSH MEDIAN (4 FEET)
 3 - DIVIDED, DEPRESSED MEDIAN
 4 - DIVIDED, RAISED MEDIAN (ANY TYPE)
 9 - OTHER / UNKNOWN

WORK ZONE RELATED
 WORKERS PRESENT
 LAW ENFORCEMENT PRESENT
 ACTIVE SCHOOL ZONE

WORK ZONE TYPE
 1 - LANE CLOSURE
 2 - LANE SHIFT/CROSSOVER
 3 - WORK ON SHOULDER OR MEDIAN
 4 - INTERMITTENT OR MOVING WORK
 5 - OTHER

LOCATION OF CRASH IN WORK ZONE
 1 - BEFORE THE 1ST WORK ZONE WARNING SIGN
 2 - ADVANCE WARNING AREA
 3 - TRANSITION AREA
 4 - ACTIVITY AREA
 5 - TERMINATION AREA

CONTOUR
 3
 1 - STRAIGHT LEVEL
 2 - STRAIGHT GRADE
 3 - CURVE LEVEL
 4 - CURVE GRADE
 9 - OTHER / UNKNOWN

CONDITIONS
 1
 1 - DRY
 2 - WET
 3 - SNOW
 4 - ICE
 5 - SAND, MUD, DIRT, OIL, GRAVEL
 6 - WATER (STANDING, MOVING)
 7 - SLUSH
 9 - OTHER/UNKNOWN

SURFACE
 2
 1 - CONCRETE
 2 - BLACKTOP, BITUMINOUS, ASPHALT
 3 - BRICK/BLOCK
 4 - SLAG, GRAVEL, STONE
 5 - DIRT
 9 - OTHER / UNKNOWN

LIGHT CONDITION
 1
 1 - DAYLIGHT
 2 - DAWN/DUSK
 3 - DARK - LIGHTED ROADWAY
 4 - DARK - ROADWAY NOT LIGHTED
 5 - DARK - UNKNOWN ROADWAY LIGHTING
 9 - OTHER / UNKNOWN

WEATHER
 1
 1 - CLEAR
 2 - CLOUDY
 3 - FOG, SMOG, SMOKE
 4 - RAIN
 5 - SLEET, HAIL
 6 - SNOW
 7 - SEVERE CROSSWINDS
 8 - BLOWING SAND, SOIL, DIRT, SNOW
 9 - FREEZING RAIN OR FREEZING DRIZZLE
 99 - OTHER / UNKNOWN

WEATHER

CONTOUR

CONDITIONS

SURFACE

NARRATIVE
 UNIT # 1 (NON-CONTACT) WAS TRAVELING WEST IN THE INSIDE LANE NEAR 13505 SR 14 (BROADWAY). UNIT # 2 (NON-CONTACT) WAS TRAVELING WEST IN THE OUTSIDE LANE NEAR 13505 SR 14 (BROADWAY). UNIT # 2 TOOK EVASIVE ACTION TO THE RIGHT. AS A RESULT, UNIT # 1 COLLIDED WITH A CURB AND WENT OFF ROAD TO THE RIGHT. VEHICLES WERE STOPPED FACING WEST AT 13213 SR 14 (BROADWAY) UPON ARRIVAL.
 NOTE: SEE OH-2

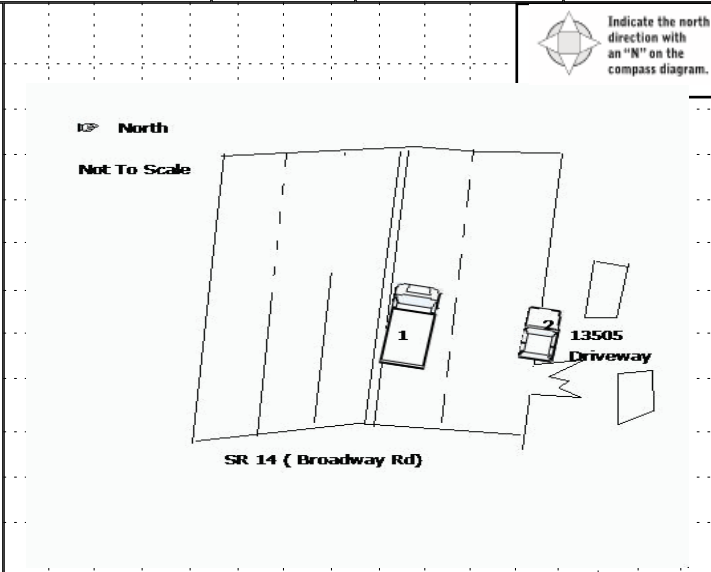

CRASH REPORTED DATE/TIME
 0 2 2 3 2 0 2 3 1 1 1 1

DISPATCH DATE/TIME
 0 2 2 3 2 0 2 3 1 1 1 3

ARRIVAL DATE/TIME
 0 2 2 3 2 0 2 3 1 1 1 2 0

SCENE CLEARED DATE/TIME
 0 2 2 3 2 0 2 3 1 1 2 3

REPORT TAKEN BY
 POLICE AGENCY
 MOTORIST

TOTAL TIME ROADWAY CLOSED
 0
 OTHER INVESTIGATION TIME

TOTAL MINUTES
 6 3
 OFFICER'S NAME *
 R. Cramer

OFFICER'S BADGE NUMBER *
 0 3 7

CHECKED BY OFFICER'S NAME *
 D. Bailey
 CHECKED BY OFFICER'S BADGE NUMBER *
 L 0 7

SUPPLEMENT (CORRECTION OR ADDITION TO A EXISTING REPORT SENT TO ODDS)

UNIT # 01 **OWNER NAME:** LAST, FIRST, MIDDLE () Same As Driver
A DUIE PYLE INC
OWNER PHONE: INCLUDE AREA CODE () Same As Driver
OWNER ADDRESS: STREET, CITY, STATE, ZIP () Same As Driver
650 W ESTON 564 W CHESTER PA 19381
COMMERCIAL CARRIER: NAME, ADDRESS, CITY, STATE, ZIP
A DUIE PYLE INC 650 W ESTON WCHESTER PA 19381
COMMERCIAL CARRIER PHONE: INCLUDE AREA CODE

LP STATE PA **LICENSE PLATE #** AG89128 **VEHICLE IDENTIFICATION #** 3AK1B1CYD251L1DLW91001 **VEHICLE YEAR** 2020 **VEHICLE MAKE** Freightliner
INSURANCE VERIFIED **INSURANCE COMPANY** United ire **INSURANCE POLICY #** 133-7528277 **VEHICLE COLOR** ONG **VEHICLE MODEL** Other/Unknow
COMMERCIAL **GOVERNMENT** **EMERGENCY RESPONSE** **US DOT #** 113594 **TOWED BY:** COMPANY NAME
INTERLOCK DEVICE EQUIPPED **HIT/SKIP UNIT** **# OCCUPANTS** 01 **VEHICLE WEIGHT GVWR/GCWR** 3 **HAZARDOUS MATERIAL** MATERIAL RELEASED **CLASS #** **PLACARD**

UNIT TYPE 15 **# OF TRAILING UNITS** 1
 1 - PASSENGER CAR 7 - MOTORCYCLE 2-WHEEL 12 - GOLF CART 18 - LIMO (LIVERY VEHICLE) 23 - PEDESTRIAN/SKATER
 2 - PASSENGER VAN (MINIVAN) ED 13 - SNOWMOBILE 19 - BUS (16+ PASSENGERS) 24 - WHEELCHAIR (ANY TYPE)
 3 - SPORT UTILITY VEHICLE 8 - MOTORCYCLE 3-WHEEL 14 - SINGLE UNIT TRUCK 20 - OTHER VEHICLE 25 - OTHER NON- MOTORIST
 4 - PICK UP ED 15 - SEMI-TRACTOR 21 - HEAVY EQUIPMENT 26 - BICYCLE
 5 - CARGO VAN 9 - AUTOCYCLE 16 - FARM EQUIPMENT 22 - ANIMAL WITH RIDER OR ANIMAL-DRAWN VEHICLE 27 - TRAIN
 6 - VAN (9-15 SEATS) 10 - MOPED OR MOTORIZED BICYCLE 17 - MOTORHOME 99 - UNKNOWN OR HIT/SKIP

WAS VEHICLE OPERATING IN AUTONOMOUS MODE WHEN CRASH OCCURRED? 2 **AUTONOMOUS MODE LEVEL** 0
 1 - YES 2 - NO 9 - OTHER / UNKNOWN
 0 - NO AUTOMATION 1 - DRIVER ASSISTANCE 3 - CONDITIONAL AUTOMATION 9 - UNKNOWN
 1 - NONE 6 - BUS - CHARTER/TOUR 11 - FIRE 16 - FARM 21 - MAIL CARRIER
 2 - TAXI 7 - BUS - INTERCITY 12 - MILITARY 17 - MOWING 99 - OTHER / UNKNOWN
 3 - ELECTRONIC RIDE SHARING 8 - BUS - SHUTTLE 13 - POLICE 18 - SNOW REMOVAL
 4 - SCHOOL TRANSPORT 9 - BUS - OTHER 14 - PUBLIC UTILITY 20 - SAFETY SERVICE PATROL
 5 - BUS-TRANSIT/COMMUTER 10 - AMBULANCE 15 - CONSTRUCTION EQUIPMENT

SPECIAL FUNCTION 01 **CARGO BODY TYPE** 01
 1 - NO CARGO BODY TYPE / NOT APPLICABLE 3 - VEHICLE TOWING ANOTHER MOTOR VEHICLE 5 - INTERMODAL CONTAINER CHASSIS 8 - POLE 12 - CONCRETE MIXER
 2 - BUS 4 - LOGGING 6 - CARGO VAN/ENCLOSED BOX 9 - CARGO TANK 13 - AUTO TRANSPORTER
 7 - GRAIN/CHIPS/GRAVEL 10 - FLAT BED 14 - GARBAGE/REFUSE 99 - OTHER / UNKNOWN
VEHICLE DEFECTS 1 - TURN SIGNALS 4 - BRAKES 7 - WORN OR SLICK TIRES 9 - MOTOR TROUBLE 99 - OTHER / UNKNOWN
 2 - HEAD LAMPS 5 - STEERING 8 - TRAILER EQUIPMENT DEFECTIVE 10 - DISABLED FROM PRIOR ACCIDENT
 3 - TAIL LAMPS 6 - TIRE BLOWOUT

NON-MOTORIST LOCATION AT IMPACT 2 **ACTION** 2 **PRE-CRASH ACTION** 01
 1 - INTERSECTION - MARKED CROSSWALK 3 - INTERSECTION - OTHER 6 - BICYCLE LANE 9 - MEDIAN/CROSSING ISLAND 12 - FIRST RESPONDER AT INCIDENT SCENE
 2 - INTERSECTION - UNMARKED CROSSWALK 4 - MIDLICK - MARKED CROSSWALK 7 - SHOULDER/ROADSIDE 10 - DRIVEWAY ACCESS 99 - OTHER / UNKNOWN
 5 - TRAVEL LANE-OTHER LOCATION 8 - SIDEWALK 11 - SHARED USE PATHS OR TRAILS

CONTRIBUTING CIRCUMSTANCES 22 **SEQUENCE OF EVENTS** 113
 1 - NONE 7 - LEFT OF CENTER 13 - IMPROPER START FROM A PARKED POSITION 17 - VISION OBSTRUCTION 21 - LYING IN ROADWAY
 2 - FAILURE TO YIELD 8 - FOLLOWING TOO CLOSE/ACDA 14 - ENTERING OR CROSSING SPECIFIED LOCATION 22 - NOT DISCERNABLE
 3 - RAN RED LIGHT 9 - IMPROPER LANE CHANGING 15 - WALKING, RUNNING, JOGGING, PLAYING 23 - OPENING DOOR INTO ROADWAY
 4 - RAN STOP SIGN 10 - IMPROPER PASSING 16 - WORKING IN TRAFFIC 99 - OTHER IMPROPER ACTION
 5 - UNSAFE SPEED 11 - DROVE OFF ROAD 17 - PUSHING VEHICLE
 6 - IMPROPER TURN 12 - IMPROPER BACKING 18 - APPROACHING OR LEAVING VEHICLE 19 - STANDING 20 - OTHER NON-MOTORIST 21 - STANDING OUTSIDE DISABLED VEHICLE 99 - OTHER / UNKNOWN

EVENT(S) 113 **COLLISION WITH FIXED OBJECT - STRUCK** 25
 1 - OVERTURN/ROLLOVER 6 - EQUIPMENT FAILURE 11 - CROSS CENTERLINE - OPPOSITE DIRECTION OF TRAVEL 16 - RAILWAY VEHICLE 22 - WORK ZONE MAINTENANCE EQUIPMENT
 2 - FIRE/EXPLOSION 7 - SEPARATION OF UNITS 12 - DOWNHILL RUNAWAY 17 - ANIMAL - FARM 18 - ANIMAL - DEER 19 - ANIMAL - OTHER 20 - MOTOR VEHICLE IN TRANSPORT 21 - PARKED MOTOR VEHICLE 24 - OTHER MOVABLE OBJECT
 3 - IMMERSION 8 - RAN OFF ROAD RIGHT 9 - RAN OFF ROAD LEFT 10 - CROSS MEDIAN 13 - OTHER NON-COLLISION 14 - PEDESTRIAN 23 - STRUCK BY FALLING, SHIFTING CARGO OR ANYTHING SET IN MOTION BY A MOTOR VEHICLE
 4 - JACKKNIFE 5 - CARGO / EQUIPMENT LOSS OR SHIFT 15 - SWERING TO AVOID 16 - WRONG WAY 20 - IMPROPER CROSSING

SEQUENCE OF EVENTS 113 **COLLISION WITH FIXED OBJECT - STRUCK** 25
 25 - IMPACT ATTENUATOR / CRASH CUSHION 31 - GUARDRAIL END 37 - TRAFFIC SIGN POST 43 - CURB 50 - WORKZONE MAINTENANCE EQUIPMENT 51 - WALL 52 - BUILDING 53 - TUNNEL 54 - OTHER FIXED OBJECT 99 - OTHER / UNKNOWN
 26 - BRIDGE OVERHEAD STRUCTURE 32 - PORTABLE BARRIER 38 - OVERHEAD SIGN POST 44 - DITCH 45 - EMBANKMENT 46 - FENCE 47 - MAILBOX 48 - TREE 49 - FIRE HYDRANT
 27 - BRIDGE PIER OR ABUTMENT 33 - MEDIAN CABLE BARRIER 39 - LIGHT/LUMINARIES SUPPORT 40 - UTILITY POLE 41 - OTHER POST, POLE OR SUPPORT 42 - CULVERT

SEQUENCE OF EVENTS 113 **COLLISION WITH FIXED OBJECT - STRUCK** 25
 28 - BRIDGE PARAPET 29 - BRIDGE RAIL 30 - GUARDRAIL FACE 34 - MEDIAN GUARDRAIL BARRIER 35 - MEDIAN CONCRETE BARRIER 36 - MEDIAN OTHER BARRIER

FIRST HARMFUL EVENT 1 **MOST HARMFUL EVENT** 1

LOCAL REPORT 20230535

DAMAGE
DAMAGE SCALE 1
 1 - NONE 2 - MINOR DAMAGE 3 - FUNCTIONAL DAMAGE 4 - DISABLING DAMAGE 9 - UNKNOWN

DAMAGED AREA(S) INDICATE ALL THAT APPLY

 - NO DAMAGE [0] - UNDERCARRIAGE [14]
 - TOP [13] - ALL AREAS [15]
 - UNIT NOT AT SCENE [16]

INITIAL POINT OF CONTACT 00
 0 - NO DAMAGE 14 - UNDERCARRIAGE
 1-12 - REFER TO UNIT DIAGRAM 15 - VEHICLE NOT AT SCENE
 13 - TOP

TRAFFIC
TRAFFICWAY FLOW 2 **TRAFFIC CONTROL** 6
 1 - ONE-WAY 2 - TWO-WAY
 1 - ROUNDABOUT 2 - SIGNAL 3 - FLASHER 4 - STOP SIGN 5 - YIELD SIGN 6 - NO CONTROL

OF THROUGH LANES ON ROAD 5 **RAIL GRADE CROSSING** 1
 1 - NOT INVOLVED 2 - INVOLVED - ACTIVE CROSSING 3 - INVOLVED - PASSIVE CROSSING

UNIT / NON-MOTORIST DIRECTION
 FROM 3 TO 4
 1 - NORTH 2 - SOUTH 3 - EAST 4 - WEST 5 - NORTHEAST 6 - NORTHWEST 7 - SOUTHEAST 8 - SOUTHWEST 9 - OTHER / UNKNOWN

UNIT SPEED 0 **DETECTED SPEED** 3
 1 - STATED/ESTIMATED SPEED 2 - CALCULATED / EDR 3 - UNDETERMINED
POSTED SPEED 25

UNIT # 0 2	OWNER NAME: LAST, FIRST, MIDDLE ALEXANDER DAVID JAYVON (Same As Driver)	OWNER PHONE: INCLUDE AREA CODE (Same As Driver)
OWNER ADDRESS: STREET, CITY, STATE, ZIP 191 ELDRED AVE BEDFORD OH 44146 (Same As Driver)		
COMMERCIAL CARRIER: NAME, ADDRESS, CITY, STATE, ZIP		COMMERCIAL CARRIER PHONE: INCLUDE AREA CODE

LP STATE OH	LICENSE PLATE # JXW7110	VEHICLE IDENTIFICATION # JTJHCJK21621X82024719	VEHICLE YEAR 2008	VEHICLE MAKE Lexus
<input type="checkbox"/> INSURANCE VERIFIED	INSURANCE COMPANY	INSURANCE POLICY #	VEHICLE COLOR WHI	VEHICLE MODEL IS
<input type="checkbox"/> COMMERCIAL	<input type="checkbox"/> GOVERNMENT	<input type="checkbox"/> EMERGENCY RESPONSE	US DOT #	
<input type="checkbox"/> INTERLOCK DEVICE EQUIPPED	<input type="checkbox"/> HIT/SKIP UNIT	# OCCUPANTS 0 1	VEHICLE WEIGHT GVWR/GCWR 1 - <10K LBS. 2 - 10,001 - 26K LBS. 3 - >26K LBS.	
TYPE OF USE		TOWED BY: COMPANY NAME		
<input type="checkbox"/> HAZARDOUS MATERIAL		<input type="checkbox"/> MATERIAL <input type="checkbox"/> RELEASED		

UNIT TYPE 0 1	1 - PASSENGER CAR 2 - PASSENGER VAN (MINIVAN) 3 - SPORT UTILITY VEHICLE 4 - PICK UP 5 - CARGO VAN 6 - VAN (9-15 SEATS)	7 - MOTORCYCLE 2-WHEEL 8 - MOTORCYCLE 3-WHEEL 9 - AUTOCYCLE 10 - MOPED OR MOTORIZED BICYCLE 11 - ALL TERRAIN VEHICLE	12 - GOLF CART 13 - SNOWMOBILE 14 - SINGLE UNIT TRUCK 15 - SEMI-TRACTOR 16 - FARM EQUIPMENT 17 - MOTORHOME	18 - LIMO (LIVERY VEHICLE) 19 - BUS (16+ PASSENGERS) 20 - OTHER VEHICLE 21 - HEAVY EQUIPMENT 22 - ANIMAL WITH RIDER OR ANIMAL-DRAWN VEHICLE	23 - PEDESTRIAN/SKATER 24 - WHEELCHAIR (ANY TYPE) 25 - OTHER NON- MOTORIST 26 - BICYCLE 27 - TRAIN 99 - UNKNOWN OR HIT/SKIP
# OF TRAILING UNITS					

WAS VEHICLE OPERATING IN AUTONOMOUS MODE WHEN CRASH OCCURRED? 2	1 - YES 2 - NO 9 - OTHER / UNKNOWN	AUTONOMOUS MODE LEVEL 0	0 - NO AUTOMATION 1 - DRIVER ASSISTANCE 2 - PARTIAL AUTOMATION	3 - CONDITIONAL AUTOMATION 4 - HIGH AUTOMATION 5 - FULL AUTOMATION	9 - UNKNOWN
---	------------------------------------	-----------------------------------	--	--	-------------

SPECIAL FUNCTION 0 1	1 - NONE 2 - TAXI 3 - ELECTRONIC RIDE SHARING 4 - SCHOOL TRANSPORT 5 - BUS-TRANSIT/COMMUTER	6 - BUS - CHARTER/TOUR 7 - BUS - INTERCITY 8 - BUS - SHUTTLE 9 - BUS - OTHER 10 - AMBULANCE	11 - FIRE 12 - MILITARY 13 - POLICE 14 - PUBLIC UTILITY 15 - CONSTRUCTION EQUIPMENT	16 - FARM 17 - MOWING 18 - SNOW REMOVAL 19 - TOWING 20 - SAFETY SERVICE PATROL	21 - MAIL CARRIER 99 - OTHER / UNKNOWN
--------------------------------	---	---	---	--	---

CARGO BODY TYPE 0 1	1 - NO CARGO BODY TYPE / NOT APPLICABLE 2 - BUS	3 - VEHICLE TOWING ANOTHER MOTOR VEHICLE 4 - LOGGING	5 - INTERMODAL CONTAINER CHASSIS 6 - CARGO VAN/ENCLOSED BOX 7 - GRAIN/CHIPS/GRAVEL	8 - POLE 9 - CARGO TANK 10 - FLAT BED 11 - DUMP	12 - CONCRETE MIXER 13 - AUTO TRANSPORTER 14 - GARBAGE/REFUSE 99 - OTHER / UNKNOWN
-------------------------------	--	---	--	--	---

VEHICLE DEFECTS 0 1	1 - TURN SIGNALS 2 - HEAD LAMPS 3 - TAIL LAMPS	4 - BRAKES 5 - STEERING 6 - TIRE BLOWOUT	7 - WORN OR SLICK TIRES 8 - TRAILER EQUIPMENT DEFECTIVE	9 - MOTOR TROUBLE 10 - DISABLED FROM PRIOR ACCIDENT	99 - OTHER / UNKNOWN
-------------------------------	--	--	--	--	----------------------

NON-MOTORIST LOCATION AT IMPACT 0 1	1 - INTERSECTION - MARKED CROSSWALK 2 - INTERSECTION - UNMARKED CROSSWALK	3 - INTERSECTION - OTHER 4 - MIDLINER - MARKED CROSSWALK 5 - TRAVEL LANE-OTHER LOCATION	6 - BICYCLE LANE 7 - SHOULDER/ROADSIDE 8 - SIDEWALK	9 - MEDIAN/CROSSING ISLAND 10 - DRIVEWAY ACCESS 11 - SHARED USE PATHS OR TRAILS	12 - FIRST RESPONDER AT INCIDENT SCENE 99 - OTHER / UNKNOWN
---	--	---	---	---	--

ACTION 2	1 - NON-CONTACT 2 - NON-COLLISION 3 - STRIKING 4 - STRUCK 5 - BOTH STRIKING & STRUCK 9 - OTHER / UNKNOWN	1 - STRAIGHT AHEAD 2 - BACKING 3 - CHANGING LANES 4 - OVERTAKING/PASSING 5 - MAKING RIGHT TURN 6 - MAKING LEFT TURN	7 - MAKING U-TURN 8 - ENTERING TRAFFIC LANE 9 - LEAVING TRAFFIC LANE 10 - PARKED 11 - SLOWING OR STOPPED IN TRAFFIC 12 - DRIVERLESS	13 - NEGOTIATING A CURVE 14 - ENTERING OR CROSSING SPECIFIED LOCATION 15 - WALKING, RUNNING, JOGGING, PLAYING 16 - WORKING 17 - PUSHING VEHICLE	18 - APPROACHING OR LEAVING VEHICLE 19 - STANDING 20 - OTHER NON-MOTORIST 21 - STANDING OUTSIDE DISABLED VEHICLE 99 - OTHER / UNKNOWN
--------------------	---	--	--	---	---

CONTRIBUTING CIRCUMSTANCES 1 5	1 - NONE 2 - FAILURE TO YIELD 3 - RAN RED LIGHT 4 - RAN STOP SIGN 5 - UNSAFE SPEED 6 - IMPROPER TURN	7 - LEFT OF CENTER 8 - FOLLOWING TOO CLOSE/ACDA 9 - IMPROPER LANE CHANGING 10 - IMPROPER PASSING 11 - DROVE OFF ROAD 12 - IMPROPER BACKING	13 - IMPROPER START FROM A PARKED POSITION 14 - STOPPED OR PARKED ILLEGALLY 15 - SWERVING TO AVOID 16 - WRONG WAY	17 - VISION OBSTRUCTION 18 - OPERATING DEFECTIVE EQUIPMENT 19 - LOAD SHIFTING/ FALLING/SPILLING 20 - IMPROPER CROSSING	21 - LYING IN ROADWAY 22 - NOT DISCERNABLE 23 - OPENING DOOR INTO ROADWAY 99 - OTHER IMPROPER ACTION
--	---	---	--	---	---

SEQUENCE OF EVENTS	EVENTS
1 1 3	1 - OVERTURN/ROLLOVER 2 - FIRE/EXPLOSION 3 - IMMERSION 4 - JACKKNIFE 5 - CARGO / EQUIPMENT LOSS OR SHIFT
2 4 3	6 - EQUIPMENT FAILURE 7 - SEPARATION OF UNITS 8 - RAN OFF ROAD RIGHT 9 - RAN OFF ROAD LEFT 10 - CROSS MEDIAN
3 0 8	11 - CROSS CENTERLINE - OPPOSITE DIRECTION OF TRAVEL 12 - DOWNHILL RUNAWAY 13 - OTHER NON-COLLISION 14 - PEDESTRIAN 15 - PEDALCYCLE

COLLISION WITH FIXED OBJECT - STRUCK					
4	25 - IMPACT ATTENUATOR / CRASH CUSHION 26 - BRIDGE OVERHEAD STRUCTURE 27 - BRIDGE PIER OR ABUTMENT 28 - BRIDGE PARAPET 29 - BRIDGE RAIL 30 - GUARDRAIL FACE	31 - GUARDRAIL END 32 - PORTABLE BARRIER 33 - MEDIAN CABLE BARRIER 34 - MEDIAN GUARDRAIL BARRIER 35 - MEDIAN CONCRETE BARRIER 36 - MEDIAN OTHER BARRIER	37 - TRAFFIC SIGN POST 38 - OVERHEAD SIGN POST 39 - LIGHT/LUMINARIES SUPPORT 40 - UTILITY POLE 41 - OTHER POST, POLE OR SUPPORT 42 - CULVERT	43 - CURB 44 - DITCH 45 - EMBANKMENT 46 - FENCE 47 - MAILBOX 48 - TREE 49 - FIRE HYDRANT	50 - WORKZONE MAINTENANCE EQUIPMENT 51 - WALL 52 - BUILDING 53 - TUNNEL 54 - OTHER FIXED OBJECT 99 - OTHER / UNKNOWN

FIRST HARMFUL EVENT 1	MOST HARMFUL EVENT 2
---------------------------------	--------------------------------

LOCAL REPORT 2 0 2 3 0 5 3 5
DAMAGE
DAMAGE SCALE 2
1 - NONE 2 - MINOR DAMAGE 3 - FUNCTIONAL DAMAGE 4 - DISABLING DAMAGE 9 - UNKNOWN
DAMAGED AREA(S) INDICATE ALL THAT APPLY
<input type="checkbox"/> - NO DAMAGE [0] <input type="checkbox"/> - UNDERCARRIAGE [14] <input type="checkbox"/> - TOP [13] <input type="checkbox"/> - ALL AREAS [15] <input type="checkbox"/> - UNIT NOT AT SCENE [16]

INITIAL POINT OF CONTACT 0 2	0 - NO DAMAGE 1-12 - REFER TO UNIT DIAGRAM 13 - TOP 14 - UNDERCARRIAGE 15 - VEHICLE NOT AT SCENE
--	--

TRAFFIC	
TRAFFICWAY FLOW 2	TRAFFIC CONTROL 6
1 - ONE-WAY 2 - TWO-WAY	1 - ROUNDABOUT 2 - SIGNAL 3 - FLASHER 4 - STOP SIGN 5 - YIELD SIGN 6 - NO CONTROL

# OF THROUGH LANES ON ROAD 5	RAIL GRADE CROSSING 1
	1 - NOT INVOLVED 2 - INVOLVED - ACTIVE CROSSING 3 - INVOLVED - PASSIVE CROSSING

UNIT / NON-MOTORIST DIRECTION	
FROM 3 TO 4	1 - NORTH 2 - SOUTH 3 - EAST 4 - WEST 5 - NORTHEAST 6 - NORTHWEST 7 - SOUTHEAST 8 - SOUTHWEST 9 - OTHER / UNKNOWN

UNIT SPEED 2 5	DETECTED SPEED 1
POSTED SPEED 2 5	1 - STATED/ESTIMATED SPEED 2 - CALCULATED / EDR 3 - UNDETERMINED



MOTORIST / NON-MOTORIST

LOCAL REPORT NUMBER									
2	0	2	3	0	5	3	5		

MOTORIST / NON-MOTORIST	UNIT # 01	NAME: LAST, FIRST, MIDDLE WILLIAMS CHRISTOPHER B	DATE OF BIRTH 06251986	AGE	GENDER M						
ADDRESS: STREET, CITY, STATE, ZIP 669 PATTERSON AVE AKRON OH 44310			CONTACT PHONE - INCLUDE AREA CODE								
INJURIES 5	INJURED TAKEN BY	EMS AGENCY (NAME)	INJURED TAKEN TO: MEDICAL FACILITY (NAME, CITY)	SAFETY EQUIPMENT USED 04	DOT-COMPLIANT MC HELMET	SEATING POSITION 01	AIR BAG USAGE 1	EJECTION 1	TRAPPED 1		
OL STATE	OPERATOR LICENSE NUMBER	OFFENSE CHARGED	LOCAL CODE	OFFENSE DESCRIPTION	CITATION NUMBER						
OL CLASS 1	ENDORSEMENT SELECT UP TO 2	RESTRICTION SELECT UP TO 3	DRIVER DISTRACTED BY 1	ALCOHOL / DRUG SUSPECTED <input type="checkbox"/> ALCOHOL <input type="checkbox"/> MARIJUANA <input type="checkbox"/> OTHER DRUG	CONDITION 1	STATUS 1	ALCOHOL TEST TYPE 1	VALUE	STATUS 1	DRUG TEST(S) TYPE 1	RESULT SELECT UP TO 4

MOTORIST / NON-MOTORIST	UNIT # 02	NAME: LAST, FIRST, MIDDLE ALEXANDER DAVID JAYVON	DATE OF BIRTH 10212002	AGE	GENDER M						
ADDRESS: STREET, CITY, STATE, ZIP 191 ELDRED AVE BEDFORD OH 44146			CONTACT PHONE - INCLUDE AREA CODE								
INJURIES 5	INJURED TAKEN BY	EMS AGENCY (NAME)	INJURED TAKEN TO: MEDICAL FACILITY (NAME, CITY)	SAFETY EQUIPMENT USED 04	DOT-COMPLIANT MC HELMET	SEATING POSITION 01	AIR BAG USAGE 1	EJECTION 1	TRAPPED 1		
OL STATE	OPERATOR LICENSE NUMBER	OFFENSE CHARGED	LOCAL CODE	OFFENSE DESCRIPTION	CITATION NUMBER						
OL CLASS 4	ENDORSEMENT SELECT UP TO 2	RESTRICTION SELECT UP TO 3	DRIVER DISTRACTED BY 1	ALCOHOL / DRUG SUSPECTED <input type="checkbox"/> ALCOHOL <input type="checkbox"/> MARIJUANA <input type="checkbox"/> OTHER DRUG	CONDITION 1	STATUS 1	ALCOHOL TEST TYPE 1	VALUE	STATUS 1	DRUG TEST(S) TYPE 1	RESULT SELECT UP TO 4

MOTORIST / NON-MOTORIST	UNIT #	NAME: LAST, FIRST, MIDDLE	DATE OF BIRTH	AGE	GENDER					
ADDRESS: STREET, CITY, STATE, ZIP			CONTACT PHONE - INCLUDE AREA CODE							
INJURIES	INJURED TAKEN BY	EMS AGENCY (NAME)	INJURED TAKEN TO: MEDICAL FACILITY (NAME, CITY)	SAFETY EQUIPMENT USED	DOT-COMPLIANT MC HELMET	SEATING POSITION	AIR BAG USAGE	EJECTION	TRAPPED	
OL STATE	OPERATOR LICENSE NUMBER	OFFENSE CHARGED	LOCAL CODE	OFFENSE DESCRIPTION	CITATION NUMBER					
OL CLASS	ENDORSEMENT SELECT UP TO 2	RESTRICTION SELECT UP TO 3	DRIVER DISTRACTED BY	ALCOHOL / DRUG SUSPECTED ALCOHOL MARIJUANA OTHER DRUG	CONDITION	STATUS	ALCOHOL TEST TYPE VALUE STATUS TYPE	DRUG TEST(S) RESULT SELECT UP TO 4		

INJURIES	SEATING POSITION	AIR BAG	OL CLASS	OL RESTRICTION(S)	DRIVER DISTRACTION	TEST STATUS
1 - FATAL	1 - FRONT - LEFT SIDE (MOTORCYCLE DRIVER)	1 - NOT DEPLOYED	1 - CLASS A	1 - ALCOHOL INTERLOCK DEVICE	1 - NOT DISTRACTED	1 - NONE GIVEN
2 - SUSPECTED SERIOUS INJURY	2 - FRONT - MIDDLE	2 - DEPLOYED FRONT	2 - CLASS B	2 - CDL INTRASTATE ONLY	2 - MANUALLY OPERATING AN ELECTRONIC COMMUNICATION DEVICE (TEXTING, TYPING, DIALING)	2 - TEST REFUSED
3 - SUSPECTED MINOR INJURY	3 - FRONT - RIGHT SIDE	3 - DEPLOYED SIDE	3 - CLASS C	3 - CORRECTIVE LENSES	3 - TALKING ON HANDS-FREE COMMUNICATION DEVICE	3 - TEST GIVEN, CONTAMINATED SAMPLE / UNUSABLE
4 - POSSIBLE INJURY	4 - SECOND - LEFT SIDE (MOTORCYCLE PASSENGER)	4 - DEPLOYED BOTH FRONT / SIDE	4 - REGULAR CLASS (OHIO = D)	4 - FARM WAIVER	4 - TALKING ON HAND-HELD COMMUNICATION DEVICE	4 - TEST GIVEN, RESULTS KNOWN
5 - NO APPARENT INJURY	5 - SECOND - MIDDLE	5 - NOT APPLICABLE	5 - M / C MOPED ONLY	5 - EXCEPT CLASS A BUS	5 - OTHER ACTIVITY WITH AN ELECTRONIC DEVICE	5 - TEST GIVEN, RESULTS UNKNOWN
	6 - SECOND - RIGHT SIDE	9 - DEPLOYMENT UNKNOWN	6 - NO VALID OL	6 - EXCEPT CLASS A & CLASS B BUS	6 - PASSENGER	
INJURED TAKEN BY	7 - THIRD - LEFT SIDE (MOTORCYCLE SIDE CAR)			7 - EXCEPT TRACTOR-TRAILER	7 - OTHER DISTRACTION INSIDE THE VEHICLE	ALCOHOL TEST TYPE
1 - NOT TRANSPORTED / TREATED AT SCENE	8 - THIRD - MIDDLE	EJECTION	OL ENDORSEMENT	8 - INTERMEDIATE LICENSE RESTRICTIONS	8 - OTHER DISTRACTIONS OUTSIDE THE VEHICLE	1 - NONE
2 - EMS	9 - THIRD - RIGHT SIDE	1 - NOT EJECTED	H - HAZMAT	9 - LEARNER'S PERMIT RESTRICTIONS	9 - OTHER / UNKNOWN	2 - BLOOD
3 - POLICE	10 - SLEEPER SECTION OF TRUCK CAB	2 - PARTIALLY EJECTED	M - MOTORCYCLE	10 - LIMITED TO DAYLIGHT ONLY		3 - URINE
9 - OTHER / UNKNOWN	11 - PASSENGER IN OTHER ENCLOSED CARGO AREA (NON-TRAILING UNIT, BUS, PICK-UP WITH CAP)	3 - TOTALLY EJECTED	P - PASSENGER	11 - LIMITED TO EMPLOYMENT		4 - BREATH
SAFETY EQUIPMENT	12 - PASSENGER IN UNENCLOSED CARGO AREA	4 - NOT APPLICABLE	N - TANKER	12 - LIMITED - OTHER		5 - OTHER
1 - NONE USED	13 - TRAILING UNIT	TRAPPED	Q - MOTOR SCOOTER	13 - MECHANICAL DEVICES (SPECIAL BRAKES, HAND CONTROLS, OR OTHER ADAPTIVE DEVICES)		
2 - SHOULDER BELT ONLY USED	14 - RIDING ON VEHICLE EXTERIOR (NON-TRAILING UNIT)	1 - NOT TRAPPED	R - THREE-WHEEL	14 - MILITARY VEHICLES ONLY	CONDITION	DRUG TEST TYPE
3 - LAP BELT ONLY USED	15 - NON-MOTORIST	2 - EXTRICATED BY MECHANICAL MEANS	MOTORCYCLE	15 - MOTOR VEHICLES WITHOUT AIR BRAKES	1 - APPARENTLY NORMAL	1 - NONE
4 - SHOULDER & LAP BELT USED	99 - OTHER / UNKNOWN	3 - FREED BY NON-MECHANICAL MEANS	S - SCHOOL BUS	16 - OUTSIDE MIRROR	2 - PHYSICAL IMPAIRMENT	2 - BLOOD
5 - CHILD RESTRAINT SYSTEM - FORWARD FACING			T - DOUBLE & TRIPLE TRAILERS	17 - PROSTHETIC AID	3 - EMOTIONAL (E.G. DEPRESSED, ANGRY, DISTURBED)	3 - URINE
6 - CHILD RESTRAINT SYSTEM - REAR FACING			X - TANKER / HAZMAT	18 - OTHER	4 - ILLNESS	4 - OTHER
7 - BOOSTER SEAT					9 - OTHER / UNKNOWN	
8 - HELMET USED			GENDER			DRUG TEST RESULT(S)
9 - PROTECTIVE PADS USED (ELBOWS, KNEES, ETC.)			F - FEMALE			1 - AMPHETAMINES
10 - REFLECTIVE CLOTHING			M - MALE			2 - BARBITURATES
11 - LIGHTING - PEDESTRIAN / BICYCLE ONLY			U - OTHER/UNKNOWN			3 - BENZODIAZEPINES
99 - OTHER / UNKNOWN						4 - CANNABINOIDS
						5 - COCAINE
						6 - OPIATES / OPIOIDS
						7 - OTHER
						8 - NEGATIVE RESULTS

OHIO TRAFFIC CRASH REPORT DIAGRAM / NARRATIVE CONTINUATION

LOCAL REPORT NUMBER 20230535	REPORTING AGENCY GARFIELD HEIGHTS	DATE OF CRASH M 02 D 23 Y 2023
IN COUNTY OF 18	CRASH LOCATION SR 14	
<p>Driver of Unit # 1 stated, other vehicle stopped in front of him and flagged him over..</p> <p>Does not believe he was involved with other vehicle.</p> <p>Driver of Unit # 2 stated, the truck went into his lane and he needed to take evasive action. He forced off the road so he would not be struck.</p> <p>Due to conflicting statements and no independent witnesses, no citations were issued on scene.</p>		
OFFICER'S SIGNATURE X		BADGE NUMBER 037