

# TRAFFIC CRASH REPORT

\*DENOTES MANDATORY FIELD FOR S

LOCAL REPORT NUMBER \*

2 0 2 3 0 4 7 9

PHOTOS TAKEN     OH-2     OH-3  
 SECONDARY CRASH     OH-1P     OTHER  
 Private Property

LOCAL INFORMATION

REPORTING AGENCY NAME \*

GARFIELD HEIGHTS

NCIC \*

0 1 8 2 0

HIT/SKIP  
1 - Solved  
2 - Unsolved

NUMBER OF UNITS  
0 1

UNIT IN ERROR  
98 - ANIMAL  
99 - UNKNOWN  
0 1

COUNTY \*    LOCALITY \*  
1 8    1

LOCATION: CITY, VILLAGE, TOWNSHIP \*  
GARFIELD HTS

CRASH DATE/TIME \*  
0 2 1 7 2 0 2 3 | 1 7 5 6

CRASH SEVERITY  
5  
1 - FATAL  
2 - SERIOUS INJURY SUSPECTED  
3 - MINOR INJURY SUSPECTED  
4 - INJURY POSSIBLE  
5 - PROPERTY DAMAGE ONLY

ROUTE TYPE    ROUTE NUMBER    PREFIX  
| | |    | | | | | | | |    3

1 - NORTH  
2 - SOUTH  
3 - EAST  
4 - WEST

LOCATION ROAD NAME  
93rd

ROAD TYPE  
S T

LATITUDE DECIMAL DEGREES  
4 1 | . 4 2 7 8 8 0

ROUTE TYPE    ROUTE NUMBER    PREFIX  
| | |    | | | | | | | |    |

1 - NORTH  
2 - SOUTH  
3 - EAST  
4 - WEST

REFERENCE ROAD NAME (ROAD, MILEPOST, HOUSE #)  
4835

ROAD TYPE  
| | |

LONGITUDE DECIMAL DEGREES  
- 8 1 | . 6 2 1 0 2 0

REFERENCE POINT  
3  
1 - INTERSECTION  
2 - MILE POST  
3 - HOUSE #

DIRECTION  
1 - NORTH  
2 - SOUTH  
3 - EAST  
4 - WEST

ROUTE TYPE  
IR - INTERSTATE ROUTE (TP)  
US - FEDERAL US ROUTE  
SR - STATE ROUTE  
CR - NUMBERED COUNTY ROUTE  
TR - NUMBERED TOWNSHIP ROUTE

ROAD TYPE  
AL - ALLEY  
AV - AVENUE  
BL - BOULEVARD  
CR - CIRCLE  
CT - COURT  
DR - DRIVE  
HE - HEIGHTS

INTERSECTION RELATED  
 WITHIN INTERSECTION OR ON APPROACH  
 WITHIN INTERCHANGE AREA

NUMBER OF APPROACHES  
| | |

DISTANCE FROM REFERENCE  
| | | | |

DISTANCE UNIT OF MEASURE  
1 - Miles  
2 - Feet  
3 - Yards

ROAD TYPE  
RD - ROAD  
SQ - SQUARE  
ST - STREET  
TE - TERRACE  
TL - TRAIL  
WA - WAY

ROADWAY  
 ROADWAY DIVIDED

LOCATION OF FIRST HARMFUL EVE  
0 1  
1 - ON ROADWAY  
2 - ON SHOULDER  
3 - IN MEDIAN  
4 - ON ROADSIDE  
5 - ON GORE  
6 - OUTSIDE TRAFFICWAY  
7 - ON RAMP  
8 - OFF RAMP

9 - CROSSOVER  
10 - DRIVEWAY / ALLEY ACCESS  
11 - RAILWAY GRADE CROSSING  
12 - SHARED USE PATHS  
13 - BIKE LANE  
14 - TOLL BOOTH  
99 - OTHER / UNKNOWN

MANNER OF CRASH COLLISION/IMPACT  
1  
1 - NOT COLLISION BETWEEN TWO MOTOR VEHICLES IN TRANSPORT  
2 - REAR-END  
3 - HEAD-ON  
4 - REAR-TO-REAR  
5 - BACKING  
6 - ANGLE  
7 - SIDESWIPE, SAME DIRECTION  
8 - SIDESWIPE, OPPOSITE DIRECTION  
9 - OTHER / UNKNOWN

DIRECTION OF TRAVEL  
| | |    1 - NORTH  
2 - SOUTH  
3 - EAST  
4 - WEST

MEDIAN TYPE  
| | |    1 - DIVIDED FLUSH MEDIAN (<4 FEET)  
2 - DIVIDED FLUSH MEDIAN (4-8 FEET)  
3 - DIVIDED, DEPRESSED MEDIAN  
4 - DIVIDED, RAISED MEDIAN (ANY TYPE)  
9 - OTHER / UNKNOWN

WORK ZONE RELATED  
 WORKERS PRESENT  
 LAW ENFORCEMENT PRESENT  
 ACTIVE SCHOOL ZONE

WORK ZONE TYPE  
1 - LANE CLOSURE  
2 - LANE SHIFT/CROSSOVER  
3 - WORK ON SHOULDER OR MEDIAN  
4 - INTERMITTENT OR MOVING WORK  
5 - OTHER

LOCATION OF CRASH IN WORK ZONE  
1 - BEFORE THE 1ST WORK ZONE WARNING SIGN  
2 - ADVANCE WARNING AREA  
3 - TRANSITION AREA  
4 - ACTIVITY AREA  
5 - TERMINATION AREA

CONTOUR  
1  
1 - STRAIGHT LEVEL  
2 - STRAIGHT GRADE  
3 - CURVE LEVEL  
4 - CURVE GRADE  
9 - OTHER / UNKNOWN

CONDITIONS  
1  
1 - DRY  
2 - WET  
3 - SNOW  
4 - ICE  
5 - SAND, MUD, DIRT, OIL, GRAVEL  
6 - WATER (STANDING, MOVING)  
7 - SLUSH  
9 - OTHER/UNKNOWN

SURFACE  
2  
1 - CONCRETE  
2 - BLACKTOP, BITUMINOUS, ASPHALT  
3 - BRICK/BLOCK  
4 - SLAG, GRAVEL, STONE  
5 - DIRT  
9 - OTHER / UNKNOWN

LIGHT CONDITION  
3  
1 - DAYLIGHT  
2 - DAWN/DUSK  
3 - DARK - LIGHTED ROADWAY  
4 - DARK - ROADWAY NOT LIGHTED  
5 - DARK - UNKNOWN ROADWAY LIGHTING  
9 - OTHER / UNKNOWN

WEATHER  
1  
1 - CLEAR  
2 - CLOUDY  
3 - FOG, SMOG, SMOKE  
4 - RAIN  
5 - SLEET, HAIL  
6 - SNOW  
7 - SEVERE CROSSWINDS  
8 - BLOWING SAND, SOIL, DIRT, SNOW  
9 - FREEZING RAIN OR FREEZING DRIZZLE  
99 - OTHER / UNKNOWN

WEATHER  
6 - SNOW  
7 - SEVERE CROSSWINDS  
8 - BLOWING SAND, SOIL, DIRT, SNOW  
9 - FREEZING RAIN OR FREEZING DRIZZLE  
99 - OTHER / UNKNOWN

NARRATIVE  
UNIT 1 WAS TRAVELING NORTH ON E. 93. DRIVER STATED THAT A SECOND VEHICLE BEGAN DRIVING ERRATIC BEHIND UNIT 1, ZIG ZAGGING AND TAILGATING, CAUSING DRIVER OF UNIT 1 TO PANIC AND ATTEMPT TO PULL OVER. UNIT 1 RAN OFF THE ROAD AND STRUCK A TREE AT 4835 E.93. THE SECOND VEHICLE DID NOT MAKE CONTACT AND LEFT THE SCENE.

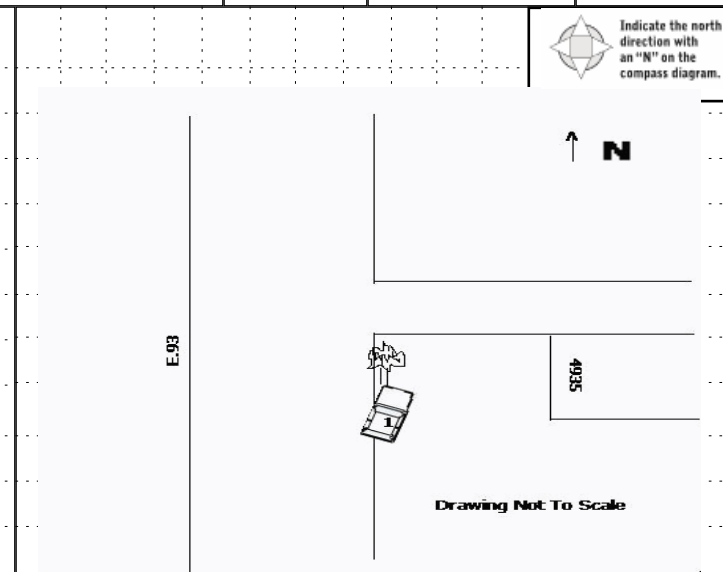

CRASH REPORTED DATE/TIME  
0 2 1 7 2 0 2 3 | 1 7 5 6

DISPATCH DATE/TIME  
0 2 1 7 2 0 2 3 | 1 7 5 7

ARRIVAL DATE/TIME  
0 2 1 7 2 0 2 3 | 1 8 0 2

SCENE CLEARED DATE/TIME  
0 2 1 7 2 0 2 3 | 1 8 2 5

REPORT TAKEN BY  
 POLICE AGENCY  
 MOTORIST

TOTAL TIME ROADWAY CLOSED  
0

OTHER INVESTIGATION TIME  
1 5

TOTAL MINUTES  
3 8

OFFICER'S NAME \*  
B. Cramer  
OFFICER'S BADGE NUMBER\*  
0 3 1

CHECKED BY OFFICER'S NAME\*  
T. Baon  
CHECKED BY OFFICER'S BADGE NUMBER\*  
S 2 0

SUPPLEMENT (CORRECTION OR ADDITION TO EXISTING REPORT SENT TO ODS)

**OWNER**

UNIT # 0 1 OWNER NAME: LAST, FIRST, MIDDLE (  Same As Driver )  
**HARRIS MYRON L**

OWNER ADDRESS: STREET, CITY, STATE, ZIP (  Same As Driver )  
**15707 CLOVERSIDE AVE CLEVELAND OH 44128**

COMMERCIAL CARRIER: NAME, ADDRESS, CITY, STATE, ZIP  
COMMERCIAL CARRIER PHONE: INCLUDE AREA CODE

**DAMAGE**

**DAMAGE SCALE**

4

1 - NONE  
2 - MINOR DAMAGE  
3 - FUNCTIONAL DAMAGE  
4 - DISABLING DAMAGE  
9 - UNKNOWN

**VEHICLE**

LP STATE OH LICENSE PLATE # JVJ6651 VEHICLE IDENTIFICATION # K1NDPMC1A1C81K17591312714 VEHICLE YEAR 2019 VEHICLE MAKE Kia

INSURANCE VERIFIED  INSURANCE COMPANY geico INSURANCE POLICY # 446667947125 VEHICLE COLOR RED VEHICLE MODEL Sportage

TYPE OF USE:  COMMERCIAL  GOVERNMENT  EMERGENCY RESPONSE  INTERLOCK DEVICE EQUIPPED  HIT/SKIP UNIT

US DOT # \_\_\_\_\_ TOWED BY: COMPANY NAME interstate

HAZARDOUS MATERIAL:  MATERIAL  RELEASED

**DAMAGED AREA(S)**  
INDICATE ALL THAT APPLY

- NO DAMAGE [0]  - UNDERCARRIAGE [14]  
 - TOP [13]  - ALL AREAS [15]  
 - UNIT NOT AT SCENE [16]

UNIT TYPE 0 3

1 - PASSENGER CAR  
2 - PASSENGER VAN (MINIVAN)  
3 - SPORT UTILITY VEHICLE  
4 - PICK UP  
5 - CARGO VAN  
6 - VAN (9-15 SEATS)  
7 - MOTORCYCLE 2-WHEEL  
8 - MOTORCYCLE 3-WHEEL  
9 - AUTOCYCLE  
10 - MOPED OR MOTORIZED BICYCLE  
11 - ALL TERRAIN VEHICLE  
12 - GOLF CART  
13 - SNOWMOBILE  
14 - SINGLE UNIT TRUCK  
15 - SEMI-TRACTOR  
16 - FARM EQUIPMENT  
17 - MOTORHOME  
18 - LIMO (LIVERY VEHICLE)  
19 - BUS (16+ PASSENGERS)  
20 - OTHER VEHICLE  
21 - HEAVY EQUIPMENT  
22 - ANIMAL WITH RIDER OR ANIMAL-DRAWN VEHICLE  
23 - PEDESTRIAN/SKATER  
24 - WHEELCHAIR (ANY TYPE)  
25 - OTHER NON- MOTORIST  
26 - BICYCLE  
27 - TRAIN  
99 - UNKNOWN OR HIT/SKIP

# OF TRAILING UNITS \_\_\_\_\_

WAS VEHICLE OPERATING IN AUTONOMOUS MODE WHEN CRASH OCCURRED? 2

1 - YES 2 - NO 9 - OTHER / UNKNOWN

AUTONOMOUS MODE LEVEL 0

0 - NO AUTOMATION  
1 - DRIVER ASSISTANCE  
2 - PARTIAL AUTOMATION  
3 - CONDITIONAL AUTOMATION  
4 - HIGH AUTOMATION  
5 - FULL AUTOMATION  
9 - UNKNOWN

SPECIAL FUNCTION 0 1

1 - NONE  
2 - TAXI  
3 - ELECTRONIC RIDE SHARING  
4 - SCHOOL TRANSPORT  
5 - BUS-TRANSIT/COMMUTER  
6 - BUS - CHARTER/TOUR  
7 - BUS - INTERCITY  
8 - BUS - SHUTTLE  
9 - BUS - OTHER  
10 - AMBULANCE  
11 - FIRE  
12 - MILITARY  
13 - POLICE  
14 - PUBLIC UTILITY  
15 - CONSTRUCTION EQUIPMENT  
16 - FARM  
17 - MOWING  
18 - SNOW REMOVAL  
19 - TOWING  
20 - SAFETY SERVICE PATROL  
21 - MAIL CARRIER  
99 - OTHER / UNKNOWN

CARGO BODY TYPE 0 1

1 - NO CARGO BODY TYPE / NOT APPLICABLE  
2 - BUS  
3 - VEHICLE TOWING ANOTHER MOTOR VEHICLE  
4 - LOGGING  
5 - INTERMODAL CONTAINER CHASSIS  
6 - CARGO VAN/ENCLOSED BOX  
7 - GRAIN/CHIPS/GRAVEL  
8 - POLE  
9 - CARGO TANK  
10 - FLAT BED  
11 - DUMP  
12 - CONCRETE MIXER  
13 - AUTO TRANSPORTER  
14 - GARBAGE/REFUSE  
99 - OTHER / UNKNOWN

VEHICLE DEFECTS

1 - TURN SIGNALS  
2 - HEAD LAMPS  
3 - TAIL LAMPS  
4 - BRAKES  
5 - STEERING  
6 - TIRE BLOWOUT  
7 - WORN OR SLICK TIRES  
8 - TRAILER EQUIPMENT DEFECTIVE  
9 - MOTOR TROUBLE  
10 - DISABLED FROM PRIOR ACCIDENT  
99 - OTHER / UNKNOWN

NON-MOTORIST LOCATION AT IMPACT 0 1

1 - INTERSECTION - MARKED CROSSWALK  
2 - INTERSECTION - UNMARKED CROSSWALK  
3 - INTERSECTION - OTHER  
4 - MIDLANE - MARKED CROSSWALK  
5 - TRAVEL LANE-OTHER LOCATION  
6 - BICYCLE LANE  
7 - SHOULDER/ROADSIDE  
8 - SIDEWALK  
9 - MEDIAN/CROSSING ISLAND  
10 - DRIVEWAY ACCESS  
11 - SHARED USE PATHS OR TRAILS  
12 - FIRST RESPONDER AT INCIDENT SCENE  
99 - OTHER / UNKNOWN

ACTION 3

1 - NON-CONTACT  
2 - NON-COLLISION  
3 - STRIKING  
4 - STRUCK  
5 - BOTH STRIKING & STRUCK  
9 - OTHER / UNKNOWN

PRE-CRASH ACTION 0 1

1 - STRAIGHT AHEAD  
2 - BACKING  
3 - CHANGING LANES  
4 - OVERTAKING/PASSING  
5 - MAKING RIGHT TURN  
6 - MAKING LEFT TURN  
7 - MAKING U-TURN  
8 - ENTERING TRAFFIC LANE  
9 - LEAVING TRAFFIC LANE  
10 - PARKED  
11 - SLOWING OR STOPPED IN TRAFFIC  
12 - DRIVERLESS  
13 - NEGOTIATING A CURVE  
14 - ENTERING OR CROSSING SPECIFIED LOCATION  
15 - WALKING, RUNNING, JOGGING, PLAYING  
16 - WORKING  
17 - PUSHING VEHICLE  
18 - APPROACHING OR LEAVING VEHICLE  
19 - STANDING  
20 - OTHER NON-MOTORIST  
21 - STANDING OUTSIDE DISABLED VEHICLE  
99 - OTHER / UNKNOWN

**INITIAL POINT OF CONTACT**

1 1

0 - NO DAMAGE  
1-12 - REFER TO UNIT DIAGRAM  
13 - TOP  
14 - UNDERCARRIAGE  
15 - VEHICLE NOT AT SCENE

CONTRIBUTING CIRCUMSTANCES

1 - NONE  
2 - FAILURE TO YIELD  
3 - RAN RED LIGHT  
4 - RAN STOP SIGN  
5 - UNSAFE SPEED  
6 - IMPROPER TURN  
7 - LEFT OF CENTER  
8 - FOLLOWING TOO CLOSE/ACDA  
9 - IMPROPER LANE CHANGING  
10 - IMPROPER PASSING  
11 - DROVE OFF ROAD  
12 - IMPROPER BACKING  
13 - IMPROPER START FROM A PARKED POSITION  
14 - STOPPED OR PARKED ILLEGALLY  
15 - SWERVING TO AVOID  
16 - WRONG WAY  
17 - VISION OBSTRUCTION  
18 - OPERATING DEFECTIVE EQUIPMENT  
19 - LOAD SHIFTING/ FALLING/SPILLING  
20 - IMPROPER CROSSING  
21 - LYING IN ROADWAY  
22 - NOT DISCERNABLE  
23 - OPENING DOOR INTO ROADWAY  
99 - OTHER IMPROPER ACTION

**TRAFFIC**

TRAFFICWAY FLOW 2

1 - ONE-WAY  
2 - TWO-WAY

TRAFFIC CONTROL 6

1 - ROUNDABOUT  
2 - SIGNAL  
3 - FLASHER  
4 - STOP SIGN  
5 - YIELD SIGN  
6 - NO CONTROL

# OF THROUGH LANES ON ROAD 2

RAIL GRADE CROSSING 2

1 - NOT INVOLVED  
2 - INVOLVED - ACTIVE CROSSING  
3 - INVOLVED - PASSIVE CROSSING

**SEQUENCE OF EVENTS**

EVENTS

1 0 8

2 4 8

3 \_\_\_\_\_

4 \_\_\_\_\_

5 \_\_\_\_\_

6 \_\_\_\_\_

1 1 FIRST HARMFUL EVENT

2 2 MOST HARMFUL EVENT

1 - OVERTURN/ROLLOVER  
2 - FIRE/EXPLOSION  
3 - IMMERSION  
4 - JACKKNIFE  
5 - CARGO / EQUIPMENT LOSS OR SHIFT  
6 - EQUIPMENT FAILURE  
7 - SEPARATION OF UNITS  
8 - RAN OFF ROAD RIGHT  
9 - RAN OFF ROAD LEFT  
10 - CROSS MEDIAN  
11 - CROSS CENTERLINE - OPPOSITE DIRECTION OF TRAVEL  
12 - DOWNHILL RUNAWAY  
13 - OTHER NON-COLLISION  
14 - PEDESTRIAN  
15 - PEDALCYCLE  
16 - RAILWAY VEHICLE  
17 - ANIMAL - FARM  
18 - ANIMAL - DEER  
19 - ANIMAL - OTHER  
20 - MOTOR VEHICLE IN TRANSPORT  
21 - PARKED MOTOR VEHICLE  
22 - WORK ZONE MAINTENANCE EQUIPMENT  
23 - STRUCK BY FALLING, SHIFTING CARGO OR ANYTHING SET IN MOTION BY A MOTOR VEHICLE  
24 - OTHER MOVABLE OBJECT  
25 - IMPACT ATTENUATOR / CRASH CUSHION  
26 - BRIDGE OVERHEAD STRUCTURE  
27 - BRIDGE PIER OR ABUTMENT  
28 - BRIDGE PARAPET  
29 - BRIDGE RAIL  
30 - GUARDRAIL FACE  
31 - GUARDRAIL END  
32 - PORTABLE BARRIER  
33 - MEDIAN CABLE BARRIER  
34 - MEDIAN GUARDRAIL BARRIER  
35 - MEDIAN CONCRETE BARRIER  
36 - MEDIAN OTHER BARRIER  
37 - TRAFFIC SIGN POST  
38 - OVERHEAD SIGN POST  
39 - LIGHT/LUMINARIES SUPPORT  
40 - UTILITY POLE  
41 - OTHER POST, POLE OR SUPPORT  
42 - CULVERT  
43 - CURB  
44 - DITCH  
45 - EMBANKMENT  
46 - FENCE  
47 - MAILBOX  
48 - TREE  
49 - FIRE HYDRANT  
50 - WORKZONE MAINTENANCE EQUIPMENT  
51 - WALL  
52 - BUILDING  
53 - TUNNEL  
54 - OTHER FIXED OBJECT  
99 - OTHER / UNKNOWN

**UNIT / NON-MOTORIST DIRECTION**

FROM 2 TO 1

1 - NORTH  
2 - SOUTH  
3 - EAST  
4 - WEST  
5 - NORTHEAST  
6 - NORTHWEST  
7 - SOUTHEAST  
8 - SOUTHWEST  
9 - OTHER / UNKNOWN

UNIT SPEED 2 5

POSTED SPEED 2 5

DETECTED SPEED 1

1 - STATED/ESTIMATED SPEED  
2 - CALCULATED / EDR  
3 - UNDETERMINED

# MOTORIST / NON-MOTORIST

LOCAL REPORT NUMBER  
2 0 2 3 0 4 7 9

UNIT # 0 1	NAME: LAST, FIRST, MIDDLE FARILEY ROSE M		DATE OF BIRTH 0 6   1 6   1 9   5 6		AGE 6 6	GENDER F				
ADDRESS: STREET, CITY, STATE, ZIP 15707 CLOVERSIDE AVE CLEVELAND OH 44128				CONTACT PHONE - INCLUDE AREA CODE						
INJURIES 5	INJURED TAKEN BY	EMS AGENCY (NAME)	INJURED TAKEN TO: MEDICAL FACILITY (NAME, CITY)	SAFETY EQUIPMENT USED 0 4	DOT-COMPLIANT MC HELMET	SEATING POSITION 0 1	AIR BAG USAGE 1	EJECTION 1	TRAPPED 1	
OL STATE	OPERATOR LICENSE NUMBER	OFFENSE CHARGED	LOCAL CODE	OFFENSE DESCRIPTION	CITATION NUMBER					
OL CLASS	ENDORSEMENT SELECT UP TO 2	RESTRICTION SELECT UP TO 3	DRIVER DISTRACTED BY 1	ALCOHOL / DRUG SUSPECTED <input type="checkbox"/> ALCOHOL <input type="checkbox"/> MARIJUANA <input type="checkbox"/> OTHER DRUG	CONDITION 1	STATUS 1	ALCOHOL TEST TYPE VALUE STATUS	DRUG TEST(S) TYPE RESULT SELECT UP TO 4		

UNIT #	NAME: LAST, FIRST, MIDDLE		DATE OF BIRTH		AGE	GENDER				
ADDRESS: STREET, CITY, STATE, ZIP				CONTACT PHONE - INCLUDE AREA CODE						
INJURIES	INJURED TAKEN BY	EMS AGENCY (NAME)	INJURED TAKEN TO: MEDICAL FACILITY (NAME, CITY)	SAFETY EQUIPMENT USED	DOT-COMPLIANT MC HELMET	SEATING POSITION	AIR BAG USAGE	EJECTION	TRAPPED	
OL STATE	OPERATOR LICENSE NUMBER	OFFENSE CHARGED	LOCAL CODE	OFFENSE DESCRIPTION	CITATION NUMBER					
OL CLASS	ENDORSEMENT SELECT UP TO 2	RESTRICTION SELECT UP TO 3	DRIVER DISTRACTED BY	ALCOHOL / DRUG SUSPECTED ALCOHOL MARIJUANA OTHER DRUG	CONDITION	STATUS	ALCOHOL TEST TYPE VALUE STATUS	DRUG TEST(S) TYPE RESULT SELECT UP TO 4		

UNIT #	NAME: LAST, FIRST, MIDDLE		DATE OF BIRTH		AGE	GENDER				
ADDRESS: STREET, CITY, STATE, ZIP				CONTACT PHONE - INCLUDE AREA CODE						
INJURIES	INJURED TAKEN BY	EMS AGENCY (NAME)	INJURED TAKEN TO: MEDICAL FACILITY (NAME, CITY)	SAFETY EQUIPMENT USED	DOT-COMPLIANT MC HELMET	SEATING POSITION	AIR BAG USAGE	EJECTION	TRAPPED	
OL STATE	OPERATOR LICENSE NUMBER	OFFENSE CHARGED	LOCAL CODE	OFFENSE DESCRIPTION	CITATION NUMBER					
OL CLASS	ENDORSEMENT SELECT UP TO 2	RESTRICTION SELECT UP TO 3	DRIVER DISTRACTED BY	ALCOHOL / DRUG SUSPECTED ALCOHOL MARIJUANA OTHER DRUG	CONDITION	STATUS	ALCOHOL TEST TYPE VALUE STATUS	DRUG TEST(S) TYPE RESULT SELECT UP TO 4		

INJURIES	SEATING POSITION	AIR BAG	OL CLASS	OL RESTRICTION(S)	DRIVER DISTRACTION	TEST STATUS
1 - FATAL	1 - FRONT - LEFT SIDE (MOTORCYCLE DRIVER)	1 - NOT DEPLOYED	1 - CLASS A	1 - ALCOHOL INTERLOCK DEVICE	1 - NOT DISTRACTED	1 - NONE GIVEN
2 - SUSPECTED SERIOUS INJURY	2 - FRONT - MIDDLE	2 - DEPLOYED FRONT	2 - CLASS B	2 - CDL INTRASTATE ONLY	2 - MANUALLY OPERATING AN ELECTRONIC COMMUNICATION DEVICE (TEXTING, TYPING, DIALING)	2 - TEST REFUSED
3 - SUSPECTED MINOR INJURY	3 - FRONT - RIGHT SIDE	3 - DEPLOYED SIDE	3 - CLASS C	3 - CORRECTIVE LENSES	3 - TALKING ON HANDS-FREE COMMUNICATION DEVICE	3 - TEST GIVEN, CONTAMINATED SAMPLE / UNUSABLE
4 - POSSIBLE INJURY	4 - SECOND - LEFT SIDE (MOTORCYCLE PASSENGER)	4 - DEPLOYED BOTH FRONT / SIDE	4 - REGULAR CLASS (OHIO = D)	4 - FARM WAIVER	4 - TALKING ON HAND-HELD COMMUNICATION DEVICE	4 - TEST GIVEN, RESULTS KNOWN
5 - NO APPARENT INJURY	5 - SECOND - MIDDLE	5 - NOT APPLICABLE	5 - M / C MOPED ONLY	5 - EXCEPT CLASS A BUS	5 - OTHER ACTIVITY WITH AN ELECTRONIC DEVICE	5 - TEST GIVEN, RESULTS UNKNOWN
6 - SECOND - RIGHT SIDE	6 - SECOND - RIGHT SIDE	9 - DEPLOYMENT UNKNOWN	6 - NO VALID OL	6 - EXCEPT CLASS A & CLASS B BUS	6 - PASSENGER	ALCOHOL TEST TYPE
7 - THIRD - LEFT SIDE (MOTORCYCLE SIDE CAR)	7 - THIRD - LEFT SIDE			7 - EXCEPT TRACTOR-TRAILER	7 - OTHER DISTRACTION INSIDE THE VEHICLE	1 - NONE
8 - THIRD - MIDDLE	8 - THIRD - MIDDLE	EJECTION	H - HAZMAT	8 - INTERMEDIATE LICENSE RESTRICTIONS	8 - OTHER DISTRACTIONS OUTSIDE THE VEHICLE	2 - BLOOD
9 - THIRD - RIGHT SIDE	9 - THIRD - RIGHT SIDE	1 - NOT EJECTED	M - MOTORCYCLE	9 - LEARNER'S PERMIT RESTRICTIONS	9 - OTHER / UNKNOWN	3 - URINE
10 - SLEEPER SECTION OF TRUCK CAB	10 - SLEEPER SECTION OF TRUCK CAB	2 - PARTIALLY EJECTED	P - PASSENGER	10 - LIMITED TO DAYLIGHT ONLY		4 - BREATH
11 - PASSENGER IN OTHER ENCLOSED CARGO AREA (NON-TRAILING UNIT, BUS, PICK-UP WITH CAP)	11 - PASSENGER IN OTHER ENCLOSED CARGO AREA (NON-TRAILING UNIT, BUS, PICK-UP WITH CAP)	3 - TOTALLY EJECTED	N - TANKER	11 - LIMITED TO EMPLOYMENT		5 - OTHER
12 - PASSENGER IN UNENCLOSED CARGO AREA	12 - PASSENGER IN UNENCLOSED CARGO AREA	4 - NOT APPLICABLE	Q - MOTOR SCOOTER	12 - LIMITED - OTHER		DRUG TEST TYPE
13 - TRAILING UNIT	13 - TRAILING UNIT	TRAPPED	R - THREE-WHEEL	13 - MECHANICAL DEVICES (SPECIAL BRAKES, HAND CONTROLS, OR OTHER ADAPTIVE DEVICES)		1 - NONE
14 - RIDING ON VEHICLE EXTERIOR (NON-TRAILING UNIT)	14 - RIDING ON VEHICLE EXTERIOR (NON-TRAILING UNIT)	1 - NOT TRAPPED	MOTORCYCLE	14 - MILITARY VEHICLES ONLY		2 - BLOOD
15 - NON-MOTORIST	15 - NON-MOTORIST	2 - EXTRICATED BY MECHANICAL MEANS	S - SCHOOL BUS	15 - MOTOR VEHICLES WITHOUT AIR BRAKES	CONDITION	3 - URINE
99 - OTHER / UNKNOWN	99 - OTHER / UNKNOWN	3 - FREED BY NON-MECHANICAL MEANS	T - DOUBLE & TRIPLE TRAILERS	16 - OUTSIDE MIRROR	1 - APPARENTLY NORMAL	4 - OTHER
			X - TANKER / HAZMAT	17 - PROSTHETIC AID	2 - PHYSICAL IMPAIRMENT	DRUG TEST RESULT(S)
				18 - OTHER	3 - EMOTIONAL (E.G. DEPRESSED, ANGRY, DISTURBED)	1 - AMPHETAMINES
			GENDER		4 - ILLNESS	2 - BARBITURATES
			F - FEMALE		5 - UNDER THE INFLUENCE OF MEDICATIONS / DRUGS / ALCOHOL	3 - BENZODIAZEPINES
			M - MALE		9 - OTHER / UNKNOWN	4 - CANNABINOIDS
			U - OTHER/UNKNOWN			5 - COCAINE
						6 - OPIATES / OPIOIDS
						7 - OTHER
						8 - NEGATIVE RESULTS