

# TRAFFIC CRASH REPORT

\*DENOTES MANDATORY FIELD FOR S

LOCAL REPORT NUMBER \*

2 0 2 3 0 3 2 8

- PHOTOS TAKEN     OH-2     OH-3  
 SECONDARY CRASH     OH-1P     OTHER  
 Private Property

LOCAL INFORMATION

REPORTING AGENCY NAME \*

GARFIELD HEIGHTS

NCIC \*

0 1 8 2 0

HIT/SKIP  
1 - Solved  
2 - Unsolved

NUMBER OF UNITS  
0 2

UNIT IN ERROR  
98 - ANIMAL  
99 - UNKNOWN  
0 2

COUNTY \*  
1 8

LOCALITY \*  
1

LOCATION: CITY, VILLAGE, TOWNSHIP \*  
GARFIELD HTS

CRASH DATE/TIME \*  
0 2 0 2 2 0 2 3 1 7 2 4

- CRASH SEVERITY  
5
- 1 - FATAL
  - 2 - SERIOUS INJURY SUSPECTED
  - 3 - MINOR INJURY SUSPECTED
  - 4 - INJURY POSSIBLE
  - 5 - PROPERTY DAMAGE ONLY

ROUTE TYPE

ROUTE NUMBER

PREFIX

LOCATION ROAD NAME  
I-480 WEST

ROAD TYPE  
H W

LATITUDE DECIMAL DEGREES  
4 1 . 4 1 3 6 3

ROUTE TYPE

ROUTE NUMBER

PREFIX

REFERENCE ROAD NAME (ROAD, MILEPOST, HOUSE #)  
22.4

ROAD TYPE  
M P

LONGITUDE DECIMAL DEGREES  
8 1 . 6 0 5 9 8

REFERENCE POINT  
2

DIRECTION

ROUTE TYPE  
IR - INTERSTATE ROUTE (TP)  
US - FEDERAL US ROUTE  
SR - STATE ROUTE  
CR - NUMBERED COUNTY ROUTE  
TR - NUMBERED TOWNSHIP ROUTE

ROAD TYPE  
AL - ALLEY  
AV - AVENUE  
BL - BOULEVARD  
CR - CIRCLE  
CT - COURT  
DR - DRIVE  
HE - HEIGHTS  
HW - HIGHWAY  
LA - LANE  
MP - MILEPOST  
OV - OVAL  
PK - PARKWAY  
PI - PIKE  
PL - PLACE  
RD - ROAD  
SQ - SQUARE  
ST - STREET  
TE - TERRACE  
TL - TRAIL  
WA - WAY

- INTERSECTION RELATED
- WITHIN INTERSECTION OR ON APPROACH
- WITHIN INTERCHANGE AREA
- NUMBER OF APPROACHES

DISTANCE FROM REFERENCE

DISTANCE UNIT OF MEASURE  
1 - Miles  
2 - Feet  
3 - Yards

ROADWAY

ROADWAY DIVIDED

- LOCATION OF FIRST HARMFUL EYE  
0 1
- 1 - ON ROADWAY
  - 2 - ON SHOULDER
  - 3 - IN MEDIAN
  - 4 - ON ROADSIDE
  - 5 - ON GORE
  - 6 - OUTSIDE TRAFFICWAY
  - 7 - ON RAMP
  - 8 - OFF RAMP
  - 9 - CROSSOVER
  - 10 - DRIVEWAY / ALLEY ACCESS
  - 11 - RAILWAY GRADE CROSSING
  - 12 - SHARED USE PATHS
  - 13 - BIKE LANE
  - 14 - TOLL BOOTH
  - 99 - OTHER / UNKNOWN

- MANNER OF CRASH COLLISION/IMPACT  
6
- 1 - NOT COLLISION BETWEEN TWO MOTOR VEHICLES IN TRANSPORT
  - 2 - REAR-END
  - 3 - HEAD-ON
  - 4 - REAR-TO-REAR
  - 5 - BACKING
  - 6 - ANGLE
  - 7 - SIDESWIPE, SAME DIRECTION
  - 8 - SIDESWIPE, OPPOSITE DIRECTION
  - 9 - OTHER / UNKNOWN

- DIRECTION OF TRAVEL
- 1 - NORTH
  - 2 - SOUTH
  - 3 - EAST
  - 4 - WEST

- MEDIAN TYPE
- 1 - DIVIDED FLUSH MEDIAN (<4 FEET)
  - 2 - DIVIDED FLUSH MEDIAN (4-7 FEET)
  - 3 - DIVIDED, DEPRESSED MEDIAN
  - 4 - DIVIDED, RAISED MEDIAN (ANY TYPE)
  - 9 - OTHER / UNKNOWN

- WORK ZONE RELATED  
 WORKERS PRESENT  
 LAW ENFORCEMENT PRESENT  
 ACTIVE SCHOOL ZONE

- WORK ZONE TYPE
- 1 - LANE CLOSURE
  - 2 - LANE SHIFT/CROSSOVER
  - 3 - WORK ON SHOULDER OR MEDIAN
  - 4 - INTERMITTENT OR MOVING WORK
  - 5 - OTHER

- LOCATION OF CRASH IN WORK ZONE
- 1 - BEFORE THE 1ST WORK ZONE WARNING SIGN
  - 2 - ADVANCE WARNING AREA
  - 3 - TRANSITION AREA
  - 4 - ACTIVITY AREA
  - 5 - TERMINATION AREA

- CONTOUR  
1
- 1 - STRAIGHT LEVEL
  - 2 - STRAIGHT GRADE
  - 3 - CURVE LEVEL
  - 4 - CURVE GRADE
  - 9 - OTHER / UNKNOWN

- CONDITIONS  
1
- 1 - DRY
  - 2 - WET
  - 3 - SNOW
  - 4 - ICE
  - 5 - SAND, MUD, DIRT, OIL, GRAVEL
  - 6 - WATER (STANDING, MOVING)
  - 7 - SLUSH
  - 9 - OTHER/UNKNOWN

- SURFACE  
1
- 1 - CONCRETE
  - 2 - BLACKTOP, BITUMINOUS, ASPHALT
  - 3 - BRICK/BLOCK
  - 4 - SLAG, GRAVEL, STONE
  - 5 - DIRT
  - 9 - OTHER / UNKNOWN

- LIGHT CONDITION  
1
- 1 - DAYLIGHT
  - 2 - DAWN/DUSK
  - 3 - DARK - LIGHTED ROADWAY
  - 4 - DARK - ROADWAY NOT LIGHTED
  - 5 - DARK - UNKNOWN ROADWAY LIGHTING
  - 9 - OTHER / UNKNOWN

- WEATHER  
1
- 1 - CLEAR
  - 2 - CLOUDY
  - 3 - FOG, SMOG, SMOKE
  - 4 - RAIN
  - 5 - SLEET, HAIL
  - 6 - SNOW
  - 7 - SEVERE CROSSWINDS
  - 8 - BLOWING SAND, SOIL, DIRT, SNOW
  - 9 - FREEZING RAIN OR FREEZING DRIZZLE
  - 99 - OTHER / UNKNOWN

NARRATIVE

UNIT 1 WAS TRAVELING W/B ON I-480 IN THE 2ND LANE

UNIT 2 WAS TRAVELING IN THE 3RD LANE ON I-480.

UNIT 2 CHANGED LANES AND FAILED TO YIELD. UNIT 2 STRUCK UNIT 1 IN THE LEFT FRONT.

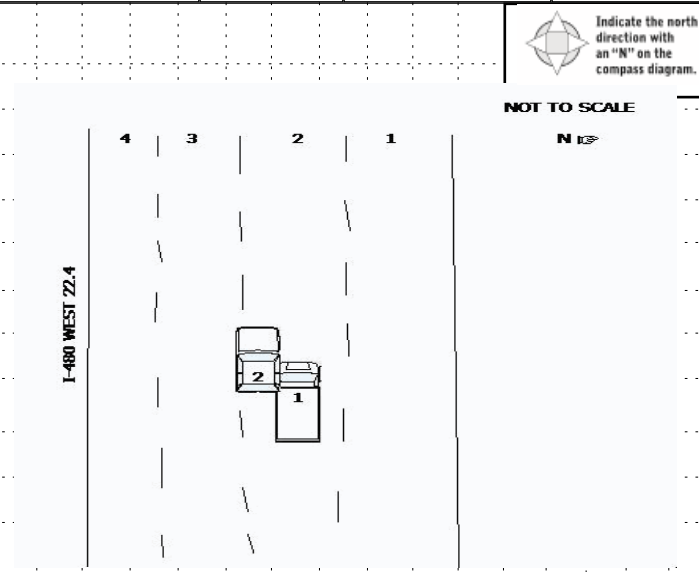

CRASH REPORTED DATE/TIME  
0 2 0 2 2 0 2 3 1 7 2 4

DISPATCH DATE/TIME  
0 2 0 2 2 0 2 3 1 7 2 6

ARRIVAL DATE/TIME  
0 2 0 2 2 0 2 3 1 7 3 1

SCENE CLEARED DATE/TIME  
0 2 0 2 2 0 2 3 1 8 0 0

- REPORT TAKEN BY  
 POLICE AGENCY  
 MOTORIST

TOTAL TIME ROADWAY CLOSED  
0

OTHER INVESTIGATION TIME  
3 0

TOTAL MINUTES  
5 9

OFFICER'S NAME \*  
B. Crespo

OFFICER'S BADGE NUMBER\*  
0 3 2

CHECKED BY OFFICER'S NAME\*  
M. Berdysz

CHECKED BY OFFICER'S BADGE NUMBER\*  
L 1 4

- SUPPLEMENT (CORRECTION OR ADDITION TO EXISTING REPORT SENT TO DODS)

**OWNER**

UNIT # 0 1 OWNER NAME: LAST, FIRST, MIDDLE ( ) Same As Driver  
**JC EHRlich PEST CONTROL**

OWNER ADDRESS: STREET, CITY, STATE, ZIP ( ) Same As Driver  
**8000 SNOWVILLE RD BRECKSVILLE OH 44141**

COMMERCIAL CARRIER: NAME, ADDRESS, CITY, STATE, ZIP  
COMMERCIAL CARRIER PHONE: INCLUDE AREA CODE

**DAMAGE**

**DAMAGE SCALE**

2 1 - NONE 3 - FUNCTIONAL DAMAGE  
2 - MINOR DAMAGE 4 - DISABLING DAMAGE  
9 - UNKNOWN

**VEHICLE**

LP STATE O H LICENSE PLATE # PKD9941 VEHICLE IDENTIFICATION # 1GCHSBEA2J1271647 VEHICLE YEAR 2018 VEHICLE MAKE Chevrolet

INSURANCE VERIFIED  INSURANCE COMPANY ARCH INSURANCE POLICY # 31CAB104402 VEHICLE COLOR WHI VEHICLE MODEL Colorado

TYPE OF USE:  COMMERCIAL  GOVERNMENT  IN EMERGENCY RESPONSE  INTERLOCK DEVICE EQUIPPED  HIT/SKIP UNIT  # OCCUPANTS 0 1

US DOT # \_\_\_\_\_ TOWED BY: COMPANY NAME \_\_\_\_\_

HAZARDOUS MATERIAL:  MATERIAL CLASS # \_\_\_\_\_ PLACARD \_\_\_\_\_  RELEASED

**DAMAGED AREA(S)**  
INDICATE ALL THAT APPLY

- NO DAMAGE [0]  - UNDERCARRIAGE [14]  
 - TOP [13]  - ALL AREAS [15]  
 - UNIT NOT AT SCENE [16]

UNIT TYPE 0 4

1 - PASSENGER CAR 7 - MOTORCYCLE 2-WHEEL 12 - GOLF CART 18 - LIMO (LIVERY VEHICLE) 23 - PEDESTRIAN/SKATER  
2 - PASSENGER VAN (MINIVAN) ED 13 - SNOWMOBILE 19 - BUS (16+ PASSENGERS) 24 - WHEELCHAIR (ANY TYPE)  
3 - SPORT UTILITY VEHICLE 8 - MOTORCYCLE 3-WHEEL 14 - SINGLE UNIT TRUCK 20 - OTHER VEHICLE 25 - OTHER NON- MOTORIST  
4 - PICK UP ED 15 - SEMI-TRACTOR 21 - HEAVY EQUIPMENT 26 - BICYCLE  
5 - CARGO VAN 9 - AUTOCYCLE 16 - FARM EQUIPMENT 22 - ANIMAL WITH RIDER OR ANIMAL-DRAWN VEHICLE 27 - TRAIN  
6 - VAN (9-15 SEATS) 10 - MOPEO OR MOTORIZED BICYCLE 17 - MOTORHOME 99 - UNKNOWN OR HIT/SKIP

# OF TRAILING UNITS \_\_\_\_\_

WAS VEHICLE OPERATING IN AUTONOMOUS MODE WHEN CRASH OCCURRED? 2

1 - YES 2 - NO 9 - OTHER / UNKNOWN

AUTONOMOUS MODE LEVEL 0

0 - NO AUTOMATION 1 - DRIVER ASSISTANCE 2 - PARTIAL AUTOMATION 3 - CONDITIONAL AUTOMATION 4 - HIGH AUTOMATION 5 - FULL AUTOMATION 9 - UNKNOWN

SPECIAL FUNCTION 0 1

1 - NONE 6 - BUS - CHARTER/TOUR 11 - FIRE 16 - FARM 21 - MAIL CARRIER  
2 - TAXI 7 - BUS - INTERCITY 12 - MILITARY 17 - MOWING 99 - OTHER/UNKNOWN  
3 - ELECTRONIC RIDE SHARING 8 - BUS - SHUTTLE 13 - POLICE 18 - SNOW REMOVAL  
4 - SCHOOL TRANSPORT 9 - BUS - OTHER 14 - PUBLIC UTILITY 20 - SAFETY SERVICE PATROL  
5 - BUS-TRANSIT/COMMUTER 10 - AMBULANCE 15 - CONSTRUCTION EQUIPMENT

CARGO BODY TYPE 0 1

1 - NO CARGO BODY TYPE / NOT APPLICABLE 3 - VEHICLE TOWING ANOTHER MOTOR VEHICLE 5 - INTERMODAL CONTAINER CHASSIS 8 - POLE 12 - CONCRETE MIXER  
2 - BUS 4 - LOGGING 6 - CARGO VAN/ENCLOSED BOX 9 - CARGO TANK 13 - AUTO TRANSPORTER  
7 - GRAIN/CHIPS/GRAVEL 10 - FLAT BED 14 - GARBAGE/REFUSE 99 - OTHER / UNKNOWN  
11 - DUMP

VEHICLE DEFECTS

1 - TURN SIGNALS 4 - BRAKES 7 - WORN OR SLICK TIRES 9 - MOTOR TROUBLE 99 - OTHER / UNKNOWN  
2 - HEAD LAMPS 5 - STEERING 8 - TRAILER EQUIPMENT DEFECTIVE 10 - DISABLED FROM PRIOR ACCIDENT  
3 - TAIL LAMPS 6 - TIRE BLOWOUT

NON-MOTORIST LOCATION AT IMPACT 0 1

1 - INTERSECTION - MARKED CROSSWALK 3 - INTERSECTION - OTHER 6 - BICYCLE LANE 9 - MEDIAN/CROSSING ISLAND 12 - FIRST RESPONDER AT INCIDENT SCENE  
2 - INTERSECTION - UNMARKED CROSSWALK 4 - MIDLINER - MARKED CROSSWALK 7 - SHOULDER/ROADSIDE 10 - DRIVEWAY ACCESS 99 - OTHER / UNKNOWN  
5 - TRAVEL LANE-OTHER LOCATION

ACTION 4

1 - NON-CONTACT 2 - NON-COLLISION 3 - STRIKING 4 - STRUCK 5 - BOTH STRIKING & STRUCK 9 - OTHER / UNKNOWN

PRE-CRASH ACTION 0 1

1 - STRAIGHT AHEAD 7 - MAKING U-TURN 13 - NEGOTIATING A CURVE 18 - APPROACHING OR LEAVING VEHICLE OR STANDING  
2 - BACKING 8 - ENTERING TRAFFIC LANE 14 - ENTERING OR CROSSING SPECIFIED LOCATION 19 - STANDING  
3 - CHANGING LANES 9 - LEAVING TRAFFIC LANE 15 - WALKING, RUNNING, JOGGING, PLAYING 20 - OTHER NON-MOTORIST  
4 - OVERTAKING/PASSING 10 - PARKED 16 - WORKING 21 - STANDING OUTSIDE DISABLED VEHICLE  
5 - MAKING RIGHT TURN 11 - SLOWING OR STOPPED IN TRAFFIC 17 - PUSHING VEHICLE 99 - OTHER / UNKNOWN  
6 - MAKING LEFT TURN 12 - DRIVERLESS

**INITIAL POINT OF CONTACT**

1 1 0 - NO DAMAGE 14 - UNDERCARRIAGE  
1-12 - REFER TO UNIT DIAGRAM 15 - VEHICLE NOT AT SCENE  
13 - TOP

CONTRIBUTING CIRCUMSTANCES

1 - NONE 7 - LEFT OF CENTER 13 - IMPROPER START FROM A PARKED POSITION 17 - VISION OBSTRUCTION 21 - LYING IN ROADWAY  
2 - FAILURE TO YIELD 8 - FOLLOWING TOO CLOSE/ACDA 14 - STOPPED OR PARKED ILLEGALLY 18 - ANIMAL - FARM 22 - NOT DISCERNABLE  
3 - RAN RED LIGHT 9 - IMPROPER LANE CHANGING 15 - SWERVING TO AVOID 19 - LOAD SHIFTING/ FALLING/SPILLING 23 - OPENING DOOR INTO ROADWAY  
4 - RAN STOP SIGN 10 - IMPROPER PASSING 16 - WRONG WAY 20 - IMPROPER CROSSING 99 - OTHER IMPROPER ACTION  
5 - UNSAFE SPEED 11 - DROVE OFF ROAD 17 - VISION OBSTRUCTION 21 - LYING IN ROADWAY  
6 - IMPROPER TURN 12 - IMPROPER BACKING

**TRAFFIC**

TRAFFICWAY FLOW 1 1 - ONE-WAY 2 - TWO-WAY

TRAFFIC CONTROL 6 1 - ROUNDABOUT 4 - STOP SIGN  
2 - SIGNAL 5 - YIELD SIGN  
3 - FLASHER 6 - NO CONTROL

SEQUENCE OF EVENTS

EVENTS

1 2 0 1 - OVERTURN/ROLLOVER 6 - EQUIPMENT FAILURE 11 - CROSS CENTERLINE - OPPOSITE DIRECTION OF TRAVEL 16 - RAILWAY VEHICLE 22 - WORK ZONE MAINTENANCE EQUIPMENT  
2 - FIRE/EXPLOSION 7 - SEPARATION OF UNITS 12 - DOWNHILL RUNAWAY 17 - ANIMAL - FARM 23 - STRUCK BY FALLING, SHIFTING CARGO OR ANYTHING SET IN MOTION BY A MOTOR VEHICLE  
3 - IMMERSION 8 - RAN OFF ROAD RIGHT 13 - OTHER NON-COLLISION 18 - ANIMAL - DEER 24 - OTHER MOVABLE OBJECT  
4 - JACKKNIFE 9 - RAN OFF ROAD LEFT 14 - PEDESTRIAN 19 - ANIMAL - OTHER 20 - MOTOR VEHICLE IN TRANSPORT  
5 - CARGO / EQUIPMENT LOSS OR SHIFT 10 - CROSS MEDIAN 15 - PEDALCYCLE 21 - PARKED MOTOR VEHICLE

# OF THROUGH LANES ON ROAD 4

RAIL GRADE CROSSING 1

1 - NOT INVOLVED  
2 - INVOLVED - ACTIVE CROSSING  
3 - INVOLVED - PASSIVE CROSSING

COLLISION WITH FIXED OBJECT - STRUCK

25 - IMPACT ATTENUATOR / CRASH CUSHION 31 - GUARDRAIL END 37 - TRAFFIC SIGN POST 43 - CURB 50 - WORKZONE MAINTENANCE EQUIPMENT  
26 - BRIDGE OVERHEAD STRUCTURE 32 - PORTABLE BARRIER 38 - OVERHEAD SIGN POST 44 - DITCH 51 - WALL  
27 - BRIDGE PIER OR ABUTMENT 33 - MEDIAN CABLE BARRIER 39 - LIGHT/LUMINARIES SUPPORT 45 - EMBANKMENT 52 - BUILDING  
28 - BRIDGE PARAPET 34 - MEDIAN GUARDRAIL BARRIER 40 - UTILITY POLE 46 - FENCE 53 - TUNNEL  
29 - BRIDGE RAIL 35 - MEDIAN CONCRETE BARRIER 41 - OTHER POST, POLE OR SUPPORT 47 - MAILBOX 54 - OTHER FIXED OBJECT  
30 - GUARDRAIL FACE 36 - MEDIAN OTHER BARRIER 42 - CULVERT 48 - TREE 99 - OTHER / UNKNOWN  
49 - FIRE HYDRANT

UNIT SPEED 60 DETECTED SPEED 1 1 - STATED/ESTIMATED SPEED  
2 - CALCULATED / EDR  
3 - UNDETERMINED

POSTED SPEED 60

FIRST HARMFUL EVENT 1 MOST HARMFUL EVENT 1

**UNIT / NON-MOTORIST DIRECTION**

FROM 3 TO 4

1 - NORTH 5 - NORTHEAST  
2 - SOUTH 6 - NORTHWEST  
3 - EAST 7 - SOUTHEAST  
4 - WEST 8 - SOUTHWEST  
9 - OTHER / UNKNOWN

**OWNER**

UNIT # 02 OWNER NAME: LAST, FIRST, MIDDLE ( ) Same As Driver  
**POLENICK JOHN ANDREW**

OWNER ADDRESS: STREET, CITY, STATE, ZIP ( ) Same As Driver  
**10198 BROOKHAVEN LANE BRECKSVILLE OH 44141**

COMMERCIAL CARRIER: NAME, ADDRESS, CITY, STATE, ZIP  
 COMMERCIAL CARRIER PHONE: INCLUDE AREA CODE

**VEHICLE**

LP STATE OH LICENSE PLATE # HYJ4986 VEHICLE IDENTIFICATION # JTJTBARBZXIG2047683 VEHICLE YEAR 2016 VEHICLE MAKE Lexus

INSURANCE VERIFIED  INSURANCE COMPANY STATEFARM INSURANCE POLICY # 2199405-SFP-35 VEHICLE COLOR WHI VEHICLE MODEL NX

TYPE OF USE:  COMMERCIAL  GOVERNMENT  IN EMERGENCY RESPONSE  INTERLOCK DEVICE EQUIPPED  HIT/SKIP UNIT  US DOT # 01 TOWED BY: COMPANY NAME

HAZARDOUS MATERIAL:  MATERIAL  RELEASED CLASS #          PLACARD         

UNIT TYPE 03

1 - PASSENGER CAR	7 - MOTORCYCLE 2-WHEEL	12 - GOLF CART	18 - LIMO (LIVERY VEHICLE)	23 - PEDESTRIAN/SKATER
2 - PASSENGER VAN (MINIVAN)	8 - MOTORCYCLE 3-WHEEL	13 - SNOWMOBILE	19 - BUS (16+ PASSENGERS)	24 - WHEELCHAIR (ANY TYPE)
3 - SPORT UTILITY VEHICLE	9 - AUTOCYCLE	14 - SINGLE UNIT TRUCK	20 - OTHER VEHICLE	25 - OTHER NON- MOTORIST
4 - PICK UP	10 - MOPED OR MOTORIZED BICYCLE	15 - SEMI-TRACTOR	21 - HEAVY EQUIPMENT	26 - BICYCLE
5 - CARGO VAN	11 - ALL TERRAIN VEHICLE	16 - FARM EQUIPMENT	22 - ANIMAL WITH RIDER OR ANIMAL-DRAWN VEHICLE	27 - TRAIN
6 - VAN (9-15 SEATS)		17 - MOTORHOME		99 - UNKNOWN OR HIT/SKIP

# OF TRAILING UNITS         

WAS VEHICLE OPERATING IN AUTONOMOUS MODE WHEN CRASH OCCURRED? 2

AUTONOMOUS MODE LEVEL 0

1 - NONE 2 - TAXI 3 - ELECTRONIC RIDE SHARING 4 - SCHOOL TRANSPORT 5 - BUS-TRANSIT/COMMUTER

6 - BUS - CHARTER/TOUR 7 - BUS - INTERCITY 8 - BUS - SHUTTLE 9 - BUS - OTHER 10 - AMBULANCE

11 - FIRE 12 - MILITARY 13 - POLICE 14 - PUBLIC UTILITY 15 - CONSTRUCTION EQUIPMENT

16 - FARM 17 - MOWING 18 - SNOW REMOVAL 19 - TOWING 20 - SAFETY SERVICE PATROL

21 - MAIL CARRIER 99 - OTHER / UNKNOWN

SPECIAL FUNCTION 01

1 - NO CARGO BODY TYPE / NOT APPLICABLE 2 - BUS

3 - VEHICLE TOWING ANOTHER MOTOR VEHICLE 4 - LOGGING

5 - INTERMODAL CONTAINER CHASSIS 6 - CARGO VAN/ENCLOSED BOX 7 - GRAIN/CHIPS/GRAVEL

8 - POLE 9 - CARGO TANK 10 - FLAT BED 11 - DUMP

12 - CONCRETE MIXER 13 - AUTO TRANSPORTER 14 - GARBAGE/REFUSE 99 - OTHER / UNKNOWN

CARGO BODY TYPE 01

VEHICLE DEFECTS

1 - TURN SIGNALS	4 - BRAKES	7 - WORN OR SLICK TIRES	9 - MOTOR TROUBLE	99 - OTHER / UNKNOWN
2 - HEAD LAMPS	5 - STEERING	8 - TRAILER EQUIPMENT DEFECTIVE	10 - DISABLED FROM PRIOR ACCIDENT	
3 - TAIL LAMPS	6 - TIRE BLOWOUT			

NON-MOTORIST LOCATION AT IMPACT         

1 - INTERSECTION - MARKED CROSSWALK 2 - INTERSECTION - UNMARKED CROSSWALK

3 - INTERSECTION - OTHER 4 - MIDLICK - MARKED CROSSWALK 5 - TRAVEL LANE-OTHER LOCATION

6 - BICYCLE LANE 7 - SHOULDER/ROADSIDE 8 - SIDEWALK

9 - MEDIAN/CROSSING ISLAND 10 - DRIVEWAY ACCESS 11 - SHARED USE PATHS OR TRAILS

12 - FIRST RESPONDER AT INCIDENT SCENE 99 - OTHER / UNKNOWN

ACTION 3

1 - NON-CONTACT 2 - NON-COLLISION 3 - STRIKING 4 - STRUCK 5 - BOTH STRIKING & STRUCK 9 - OTHER / UNKNOWN

PRE-CRASH ACTION 03

1 - STRAIGHT AHEAD 2 - BACKING 3 - CHANGING LANES 4 - OVERTAKING/PASSING 5 - MAKING RIGHT TURN 6 - MAKING LEFT TURN

7 - MAKING U-TURN 8 - ENTERING TRAFFIC LANE 9 - LEAVING TRAFFIC LANE 10 - PARKED 11 - SLOWING OR STOPPED IN TRAFFIC 12 - DRIVERLESS

13 - NEGOTIATING A CURVE 14 - ENTERING OR CROSSING SPECIFIED LOCATION 15 - WALKING, RUNNING, JOGGING, PLAYING 16 - WORKING 17 - PUSHING VEHICLE

18 - APPROACHING OR LEAVING VEHICLE 19 - STANDING 20 - OTHER NON-MOTORIST 21 - STANDING OUTSIDE DISABLED VEHICLE 99 - OTHER / UNKNOWN

CONTRIBUTING CIRCUMSTANCES 02

1 - NONE 2 - FAILURE TO YIELD 3 - RAN RED LIGHT 4 - RAN STOP SIGN 5 - UNSAFE SPEED 6 - IMPROPER TURN

7 - LEFT OF CENTER 8 - FOLLOWING TOO CLOSE/ACDA 9 - IMPROPER LANE CHANGING 10 - IMPROPER PASSING 11 - DROVE OFF ROAD 12 - IMPROPER BACKING

13 - IMPROPER START FROM A PARKED POSITION 14 - STOPPED OR PARKED ILLEGALLY 15 - SWERVING TO AVOID 16 - WRONG WAY

17 - VISION OBSTRUCTION 18 - OPERATING DEFECTIVE EQUIPMENT 19 - LOAD SHIFTING/ FALLING/SPILLING 20 - IMPROPER CROSSING

21 - LYING IN ROADWAY 22 - NOT DISCERNABLE 23 - OPENING DOOR INTO ROADWAY 99 - OTHER IMPROPER ACTION

SEQUENCE OF EVENTS

EVENTS

1 20 1 - OVERTURN/ROLLOVER 2 - FIRE/EXPLOSION 3 - IMMERSION 4 - JACKKNIFE 5 - CARGO / EQUIPMENT LOSS OR SHIFT

6 - EQUIPMENT FAILURE 7 - SEPARATION OF UNITS 8 - RAN OFF ROAD RIGHT 9 - RAN OFF ROAD LEFT 10 - CROSS MEDIAN

11 - CROSS CENTERLINE - OPPOSITE DIRECTION OF TRAVEL 12 - DOWNHILL RUNAWAY 13 - OTHER NON-COLLISION 14 - PEDESTRIAN 15 - PEDALCYCLE

16 - RAILWAY VEHICLE 17 - ANIMAL - FARM 18 - ANIMAL - DEER 19 - ANIMAL - OTHER 20 - MOTOR VEHICLE IN TRANSPORT 21 - PARKED MOTOR VEHICLE

22 - WORK ZONE MAINTENANCE EQUIPMENT 23 - STRUCK BY FALLING, SHIFTING CARGO OR ANYTHING SET IN MOTION BY A MOTOR VEHICLE 24 - OTHER MOVABLE OBJECT

COLLISION WITH FIXED OBJECT - STRUCK

25 - IMPACT ATTENUATOR / CRASH CUSHION 26 - BRIDGE OVERHEAD STRUCTURE 27 - BRIDGE PIER OR ABUTMENT 28 - BRIDGE PARAPET 29 - BRIDGE RAIL 30 - GUARDRAIL FACE

31 - GUARDRAIL END 32 - PORTABLE BARRIER 33 - MEDIAN CABLE BARRIER 34 - MEDIAN GUARDRAIL BARRIER 35 - MEDIAN CONCRETE BARRIER 36 - MEDIAN OTHER BARRIER

37 - TRAFFIC SIGN POST 38 - OVERHEAD SIGN POST 39 - LIGHT/LUMINARIES SUPPORT 40 - UTILITY POLE 41 - OTHER POST, POLE OR SUPPORT 42 - CULVERT

43 - CURB 44 - DITCH 45 - EMBANKMENT 46 - FENCE 47 - MAILBOX 48 - TREE 49 - FIRE HYDRANT

50 - WORKZONE MAINTENANCE EQUIPMENT 51 - WALL 52 - BUILDING 53 - TUNNEL 54 - OTHER FIXED OBJECT 99 - OTHER / UNKNOWN

FIRST HARMFUL EVENT 1 MOST HARMFUL EVENT 1

LOCAL REPORT

20230328

DAMAGE

DAMAGE SCALE

2 1 - NONE 2 - MINOR DAMAGE 3 - FUNCTIONAL DAMAGE 4 - DISABLING DAMAGE 9 - UNKNOWN

DAMAGED AREA(S)

INDICATE ALL THAT APPLY

- NO DAMAGE [0]  - UNDERCARRIAGE [14]

- TOP [13]  - ALL AREAS [15]

- UNIT NOT AT SCENE [16]

INITIAL POINT OF CONTACT

05 0 - NO DAMAGE 1-12 - REFER TO UNIT DIAGRAM 13 - TOP 14 - UNDERCARRIAGE 15 - VEHICLE NOT AT SCENE

TRAFFIC

TRAFFICWAY FLOW 2 1 - ONE-WAY 2 - TWO-WAY

TRAFFIC CONTROL 6 1 - ROUNDABOUT 2 - SIGNAL 3 - FLASHER 4 - STOP SIGN 5 - YIELD SIGN 6 - NO CONTROL

# OF THROUGH LANES ON ROAD 4

RAIL GRADE CROSSING 1 1 - NOT INVOLVED 2 - INVOLVED - ACTIVE CROSSING 3 - INVOLVED - PASSIVE CROSSING

UNIT / NON-MOTORIST DIRECTION

FROM 3 TO 3

1 - NORTH 2 - SOUTH 3 - EAST 4 - WEST 5 - NORTHEAST 6 - NORTHWEST 7 - SOUTHEAST 8 - SOUTHWEST 9 - OTHER / UNKNOWN

UNIT SPEED 60

POSTED SPEED 60

DETECTED SPEED 1 1 - STATED/ESTIMATED SPEED 2 - CALCULATED / EDR 3 - UNDETERMINED

# MOTORIST / NON-MOTORIST

LOCAL REPORT NUMBER  
2 0 2 3 0 3 2 8

UNIT # 0 1	NAME: LAST, FIRST, MIDDLE FOOR SHAWN LEVI		DATE OF BIRTH 0 5 1 8 1 9 9 3		AGE 2 9	GENDER M			
ADDRESS: STREET, CITY, STATE, ZIP 125 W VIRGINIA AVE SEBRING OH 44672					CONTACT PHONE - INCLUDE AREA CODE				
INJURIES 5	INJURED TAKEN BY	EMS AGENCY (NAME)	INJURED TAKEN TO: MEDICAL FACILITY (NAME, CITY)	SAFETY EQUIPMENT USED 0 4	<input type="checkbox"/> DOT-COMPLIANT MC HELMET	SEATING POSITION 0 1	AIR BAG USAGE 1	EJECTION 1	TRAPPED 1
OL STATE	OPERATOR LICENSE NUMBER	OFFENSE CHARGED	LOCAL CODE <input type="checkbox"/>	OFFENSE DESCRIPTION		CITATION NUMBER			
OL CLASS 4	ENDORSEMENT SELECT UP TO 2	RESTRICTION SELECT UP TO 3	DRIVER DISTRACTED BY 1	ALCOHOL / DRUG SUSPECTED <input type="checkbox"/> ALCOHOL <input type="checkbox"/> MARIJUANA <input type="checkbox"/> OTHER DRUG		CONDITION 1	STATUS 1	ALCOHOL TEST TYPE VALUE STATUS TYPE RESULT SELECT UP TO 4	

UNIT # 0 2	NAME: LAST, FIRST, MIDDLE POLENICK LORETTA ROSE		DATE OF BIRTH 0 9 1 7 1 9 4 5		AGE 7 7	GENDER F			
ADDRESS: STREET, CITY, STATE, ZIP 9875 N POINTE CIR BRECKSVILLE OH 44141					CONTACT PHONE - INCLUDE AREA CODE				
INJURIES 5	INJURED TAKEN BY	EMS AGENCY (NAME)	INJURED TAKEN TO: MEDICAL FACILITY (NAME, CITY)	SAFETY EQUIPMENT USED 0 4	<input type="checkbox"/> DOT-COMPLIANT MC HELMET	SEATING POSITION 0 1	AIR BAG USAGE 1	EJECTION 1	TRAPPED 1
OL STATE	OPERATOR LICENSE NUMBER	OFFENSE CHARGED	LOCAL CODE <input type="checkbox"/>	OFFENSE DESCRIPTION		CITATION NUMBER			
OL CLASS 4	ENDORSEMENT SELECT UP TO 2	RESTRICTION SELECT UP TO 3	DRIVER DISTRACTED BY 1	ALCOHOL / DRUG SUSPECTED <input type="checkbox"/> ALCOHOL <input type="checkbox"/> MARIJUANA <input type="checkbox"/> OTHER DRUG		CONDITION 1	STATUS 1	ALCOHOL TEST TYPE VALUE STATUS TYPE RESULT SELECT UP TO 4	

UNIT #	NAME: LAST, FIRST, MIDDLE		DATE OF BIRTH		AGE	GENDER			
ADDRESS: STREET, CITY, STATE, ZIP					CONTACT PHONE - INCLUDE AREA CODE				
INJURIES	INJURED TAKEN BY	EMS AGENCY (NAME)	INJURED TAKEN TO: MEDICAL FACILITY (NAME, CITY)	SAFETY EQUIPMENT USED	<input type="checkbox"/> DOT-COMPLIANT MC HELMET	SEATING POSITION	AIR BAG USAGE	EJECTION	TRAPPED
OL STATE	OPERATOR LICENSE NUMBER	OFFENSE CHARGED	LOCAL CODE <input type="checkbox"/>	OFFENSE DESCRIPTION		CITATION NUMBER			
OL CLASS	ENDORSEMENT SELECT UP TO 2	RESTRICTION SELECT UP TO 3	DRIVER DISTRACTED BY	ALCOHOL / DRUG SUSPECTED ALCOHOL MARIJUANA OTHER DRUG		CONDITION	STATUS	ALCOHOL TEST TYPE VALUE STATUS TYPE RESULT SELECT UP TO 4	

INJURIES	SEATING POSITION	AIR BAG	OL CLASS	OL RESTRICTION(S)	DRIVER DISTRACTION	TEST STATUS
1 - FATAL	1 - FRONT - LEFT SIDE (MOTORCYCLE DRIVER)	1 - NOT DEPLOYED	1 - CLASS A	1 - ALCOHOL INTERLOCK DEVICE	1 - NOT DISTRACTED	1 - NONE GIVEN
2 - SUSPECTED SERIOUS INJURY	2 - FRONT - MIDDLE	2 - DEPLOYED FRONT	2 - CLASS B	2 - CDL INTRASTATE ONLY	2 - MANUALLY OPERATING AN ELECTRONIC COMMUNICATION DEVICE (TEXTING, TYPING, DIALING)	2 - TEST REFUSED
3 - SUSPECTED MINOR INJURY	3 - FRONT - RIGHT SIDE	3 - DEPLOYED SIDE	3 - CLASS C	3 - CORRECTIVE LENSES	3 - TALKING ON HANDS-FREE COMMUNICATION DEVICE	3 - TEST GIVEN, CONTAMINATED SAMPLE / UNUSABLE
4 - POSSIBLE INJURY	4 - SECOND - LEFT SIDE (MOTORCYCLE PASSENGER)	4 - DEPLOYED BOTH FRONT / SIDE	4 - REGULAR CLASS (OHIO = D)	4 - FARM WAIVER	4 - TALKING ON HAND-HELD COMMUNICATION DEVICE	4 - TEST GIVEN, RESULTS KNOWN
5 - NO APPARENT INJURY	5 - SECOND - MIDDLE	5 - NOT APPLICABLE	5 - M / C MOPED ONLY	5 - EXCEPT CLASS A BUS	5 - OTHER ACTIVITY WITH AN ELECTRONIC DEVICE	5 - TEST GIVEN, RESULTS UNKNOWN
	6 - SECOND - RIGHT SIDE	9 - DEPLOYMENT UNKNOWN	6 - NO VALID OL	6 - EXCEPT CLASS A & CLASS B BUS	6 - PASSENGER	
<b>INJURED TAKEN BY</b>	7 - THIRD - LEFT SIDE (MOTORCYCLE SIDE CAR)			7 - EXCEPT TRACTOR-TRAILER	7 - OTHER DISTRACTION INSIDE THE VEHICLE	<b>ALCOHOL TEST TYPE</b>
1 - NOT TRANSPORTED / TREATED AT SCENE	8 - THIRD - MIDDLE	<b>EJECTION</b>	<b>OL ENDORSEMENT</b>	8 - INTERMEDIATE LICENSE RESTRICTIONS	8 - OTHER DISTRACTIONS OUTSIDE THE VEHICLE	1 - NONE
2 - EMS	9 - THIRD - RIGHT SIDE	1 - NOT EJECTED	H - HAZMAT	9 - LEARNER'S PERMIT RESTRICTIONS	9 - OTHER / UNKNOWN	2 - BLOOD
3 - POLICE	10 - SLEEPER SECTION OF TRUCK CAB	2 - PARTIALLY EJECTED	M - MOTORCYCLE	10 - LIMITED TO DAYLIGHT ONLY		3 - URINE
9 - OTHER / UNKNOWN	11 - PASSENGER IN OTHER ENCLOSED CARGO AREA (NON-TRAILING UNIT, BUS, PICK-UP WITH CAP)	3 - TOTALLY EJECTED	P - PASSENGER	11 - LIMITED TO EMPLOYMENT		4 - BREATH
<b>SAFETY EQUIPMENT</b>	12 - PASSENGER IN UNENCLOSED CARGO AREA	4 - NOT APPLICABLE	N - TANKER	12 - LIMITED - OTHER		5 - OTHER
1 - NONE USED	13 - TRAILING UNIT	<b>TRAPPED</b>	Q - MOTOR SCOOTER	13 - MECHANICAL DEVICES (SPECIAL BRAKES, HAND CONTROLS, OR OTHER ADAPTIVE DEVICES)		
2 - SHOULDER BELT ONLY USED	14 - RIDING ON VEHICLE EXTERIOR (NON-TRAILING UNIT)	1 - NOT TRAPPED	R - THREE-WHEEL	14 - MILITARY VEHICLES ONLY	<b>CONDITION</b>	<b>DRUG TEST TYPE</b>
3 - LAP BELT ONLY USED	15 - NON-MOTORIST	2 - EXTRICATED BY MECHANICAL MEANS	MOTORCYCLE	15 - MOTOR VEHICLES WITHOUT AIR BRAKES	1 - APPARENTLY NORMAL	1 - NONE
4 - SHOULDER & LAP BELT USED	99 - OTHER / UNKNOWN	3 - FREED BY NON-MECHANICAL MEANS	S - SCHOOL BUS	16 - OUTSIDE MIRROR	2 - PHYSICAL IMPAIRMENT	2 - BLOOD
5 - CHILD RESTRAINT SYSTEM - FORWARD FACING			T - DOUBLE & TRIPLE TRAILERS	17 - PROSTHETIC AID	3 - EMOTIONAL (E.G. DEPRESSED, ANGRY, DISTURBED)	3 - URINE
6 - CHILD RESTRAINT SYSTEM - REAR FACING			X - TANKER / HAZMAT	18 - OTHER	4 - ILLNESS	4 - OTHER
7 - BOOSTER SEAT					9 - OTHER / UNKNOWN	
8 - HELMET USED						<b>DRUG TEST RESULT(S)</b>
9 - PROTECTIVE PADS USED (ELBOWS, KNEES, ETC.)			<b>GENDER</b>			1 - AMPHETAMINES
10 - REFLECTIVE CLOTHING			F - FEMALE			2 - BARBITURATES
11 - LIGHTING - PEDESTRIAN / BICYCLE ONLY			M - MALE			3 - BENZODIAZEPINES
99 - OTHER / UNKNOWN			U - OTHER/UNKNOWN			4 - CANNABINOIDS
						5 - COCAINE
						6 - OPIATES / OPIOIDS
						7 - OTHER
						8 - NEGATIVE RESULTS