

TRAFFIC CRASH REPORT

*DENOTES MANDATORY FIELD FOR S

LOCAL REPORT NUMBER *

<input type="checkbox"/> PHOTOS TAKEN <input type="checkbox"/> OH-2 <input type="checkbox"/> OH-3 <input type="checkbox"/> SECONDARY CRASH <input type="checkbox"/> OH-1P <input type="checkbox"/> OTHER <input type="checkbox"/> Private Property		LOCAL INFORMATION REPORTING AGENCY NAME * GARFIELD HEIGHTS	NCIC * 01820	HIT/SKIP 1 - Solved 2 - Unsolved <input type="checkbox"/>	NUMBER OF UNITS 01	UNIT IN ERROR <small>98 - ANIMAL 99 - UNKNOWN</small> 01
--	--	---	------------------------	--	------------------------------	---

COUNTY * 18	LOCALITY * 1 - CITY * 2 - VILLAGE * 3 - TOWNSHIP * 1	LOCATION: CITY, VILLAGE, TOWNSHIP * GARFIELD HTS	CRASH DATE/TIME 111232022 0647	CRASH SEVERITY 1 - FATAL 2 - SERIOUS INJURY SUSPECTED 3 - MINOR INJURY SUSPECTED 4 - INJURY 5
-----------------------	---	--	--	---

ROUTE TYPE S R	ROUTE NUMBER 14	PREFIX <input type="checkbox"/>	1 - NORTH 2 - SOUTH 3 - EAST 4 - WEST	LOCATION ROAD NAME	ROAD TYPE	LATITUDE DECIMAL DEGR 41.430120
ROUTE TYPE	ROUTE NUMBER	PREFIX	1 - NORTH 2 - SOUTH 3 - EAST 4 - WEST	REFERENCE ROAD NAME (ROAD, MILEPOST, HOUS 12400	ROAD TYPE	LONGITUDE DECIMAL DEGR 81.596310

REFERENCE POINT 1 - INTERSECTION 2 - MILE POST 3	DIRECTION <small>REFERENCE</small> 1 - NORTH 2 - SOUTH 3 - EAST 4 - WEST <input type="checkbox"/>	ROUTE TYPE IR - INTERSTATE ROUTE (TP) US - FEDERAL US ROUTE SR - STATE ROUTE CR - NUMBERED COUNTY ROUTE	ROAD TYPE AL - ALLEY AV - AVENUE BL - BOULEVARD CR - CIRCLE CT - COURT DR - DRIVE HE - HEIGHTS HW - HIGHWAY LA - LANE MP - MILEPOST OV - OVAL PK - PARKWAY PI - PIKE PL - PLACE RD - ROAD SQ - SQUARE ST - STREET TE - TERRACE TL - TRAIL WA - WAY	INTERSECTION RELATED <input type="checkbox"/> WITHIN INTERSECTION OR ON APPRO <input type="checkbox"/> WITHIN INTERCHANGE ARE <input type="checkbox"/> ROADWAY DIVIDE	NUMBER OF APPROACH
--	---	---	--	--	--------------------

LOCATION OF FIRST HARMFUL EVE 01 1 - ON ROADWAY 2 - ON SHOULDER 3 - IN MEDIAN 4 - ON ROADSIDE 5 - ON GORE 6 - OUTSIDE TRAFFICWAY 7 - ON RAMP 9 - CROSSOVER 10 - DRIVEWAY / ALLEY ACCESS 11 - RAILWAY GRADE CROSSING 12 - SHARED USE PATHS 13 - BIKE LANE	MANNER OF CRASH COLLISION/IMPACT 1 1 - NOT COLLISION BETWEEN TWO MOTOR VEHICLES IN TRANSPORT 2 - REAR-END 3 - HEAD-ON 4 - REAR-TO-REAR 5 - BACKING 6 - ANGLE 7 - SIDESWIPE, SAME DIRECTION 8 - SIDESWIPE, OPPOSITE DIRECTION 9 - OTHER / UNKNOWN	DIRECTION OF TRAV <input type="checkbox"/> 1 - NORTH <input type="checkbox"/> 2 - SOUTH <input type="checkbox"/> 3 - EAST <input type="checkbox"/> 4 - WEST	MEDIAN TYPE <input type="checkbox"/> 1 - DIVIDED FLUSH MEDIAN (<4 FEET) <input type="checkbox"/> 2 - DIVIDED FLUSH MEDIAN (≥4 FEET) <input type="checkbox"/> 3 - DIVIDED, DEPRESSED MEDIAN <input type="checkbox"/> 4 - DIVIDED, RAISED MEDIAN (ANY TYPE)
--	---	---	---

<input type="checkbox"/> WORK ZONE <input type="checkbox"/> RELATED <input type="checkbox"/> WORKERS PRESENT <input type="checkbox"/> LAW ENFORCEMENT <input type="checkbox"/> ACTIVE SCHOOL ZON	WORK ZONE TYPE 1 - LANE CLOSURE 2 - LANE SHIFT/CROSSOVER 3 - WORK ON SHOULDER OR MEDIAN 4 - INTERMITTENT OR MOVING WORK	LOCATION OF CRASH IN WORK ZONE 1 - BEFORE THE 1ST WORK ZONE WARNING SIGN 2 - ADVANCE WARNING AREA 3 - TRANSITION AREA	CONTOUR 1 1 - STRAIGHT LEVEL 2 - STRAIGHT GRADE 3 - CURVE LEVEL 4 - CURVE GRADE	CONDITIONS 1 1 - DRY 2 - WET 3 - SNOW 4 - ICE 5 - SAND, MUD, DIRT OIL, GRAVEL 6 - WATER (STANDING, MOVING) 7 - SLUSH 9 - OTHER/UNKNOW	SURFACE 2 1 - CONCRETE 2 - BLACKTOP, BITUMINOUS, ASPHALT 3 - BRICK/BLOCK 4 - SLAG, GRAVEL, STONE 5 - DIRT 9 - OTHER /UNKNOWN
--	---	---	---	--	--

LIGHT CONDITIO 2 1 - DAYLIGHT 2 - DAWN/DUSK 3 - DARK - LIGHTED ROADWAY 4 - DARK - ROADWAY NOT LIGHTED 5 - DARK - UNKNOWN ROADWAY LIGHTING	WEATHER 1 1 - CLEAR 2 - CLOUDY 3 - FOG, SMOG, SMOKE 4 - RAIN 5 - SLEET, HAIL 6 - SNOW 7 - SEVERE CROSSWINDS 8 - BLOWING SAND, SOIL, DIRT, SNOW 9 - FREEZING RAIN OR FREEZING DRIZZLE 99 - OTHER / UNKNOWN
--	---

NARRATIVE
 UNIT 1 WAS E/B BROADWAY AND LOST CONTROL OF HIS VEHICLE AND DROVE OVER A CURB AND STRUCK UTILITY POLE#337460

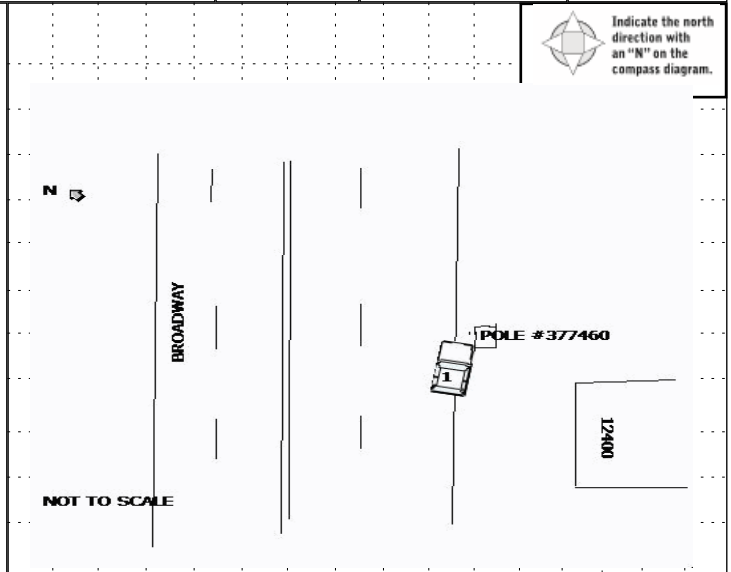

CRASH REPORTED DATE/TIME 111232022 0647	DISPATCH DATE/TIME 111232022 0657	ARRIVAL DATE/TIME 111232022 0709	SCENE CLEARED DATE/TIME 111232022 0735	REPORT TAKEN B POLICE AGENCY <input type="checkbox"/>
TOTAL TIME ROADWAY 0	OTHER INVESTIGATION 45	TOTAL MINUTES 71	OFFICER'S NAME * B. Cwiklinski	CHECKED BY OFFICER'S NAME * N. Rossi
			OFFICER'S BADGE NUMBER* 009	CHECKED BY OFFICER'S BADGE NUMBER* S13

OWNER

UNIT # 01 OWNER NAME: LAST, FIRST, MIDDLE (Same As Driver)
MISLOSKY JOSEPH MICHAEL

OWNER ADDRESS: STREET, CITY, STATE, ZIP (Same As Driver)
53 WANDLE AV BEDFORD OH 44146

COMMERCIAL CARRIER: NAME, ADDRESS, CITY, STATE, ZIP (Same As Driver)

COMMERCIAL CARRIER PHONE: INCLUDE AREA CODE

VEHICLE

LP STATE OH LICENSE PLATE # JTM9625 VEHICLE IDENTIFICATION # 1FAFP2171015G170444 VEHICLE YEAR 2005 VEHICLE MAKE Ford

INSURANCE VERIFIED INSURANCE COMPANY SAFE AUTO INSURANCE POLICY # OH01753998A00 VEHICLE COLOR BLU VEHICLE MODEL Five Hundred

TYPE OF USE: COMMERCIAL GOVERNMENT IN EMERGENCY INTERLOCK DEVICE EQUIPPED HIT/SKIP UNIT # OCCUPANTS 01

US DOT # _____ TOWED BY: COMPANY NAME INTERSTATE

HAZARDOUS MATERIAL: MATERIAL RELEASED CLASS # _____ PLACARD _____

UNIT TYPE: 01

1 - PASSENGER CAR 7 - MOTORCYCLE 2-WHEELED 12 - GOLF CART 18 - LIMO (LIVERY VEHICLE) 23 - PEDESTRIAN/SKATE R

2 - PASSENGER VAN (MINIVAN) 8 - MOTORCYCLE 3-WHEELED 13 - SNOWMOBILE 19 - BUS (16+ PASSENGERS) 24 - WHEELCHAIR (ANY TYPE)

3 - SPORT UTILITY VEHICLE 9 - AUTOCYCLE 14 - SINGLE UNIT TRUCK 20 - OTHER VEHICLE 25 - OTHER NON-MOTORIST

4 - PICK UP 10 - MOPED OR MOTORIZED BICYCLE 15 - SEMI-TRACTOR 21 - HEAVY EQUIPMENT 26 - BICYCLE

5 - CARGO VAN 16 - FARM EQUIPMENT 22 - ANIMAL WITH RIDER OR ANIMAL-DRAWN VEHICLE 27 - TRAIN 99 - UNKNOWN OR HITS KIP

OF TRAILING UNITS _____

WAS VEHICLE OPERATING IN AUTONOMOUS MODE WHEN CRASH OCCURRED? 2

1 - YES 2 - NO 9 - OTHER / _____

AUTONOMOUS MODE LEVEL: 0 - NO AUTOMATION 1 - DRIVER ASSISTANCE 2 - PARTIAL 3 - CONDITIONAL AUTOMATION 4 - HIGH AUTOMATION 9 - UNKNOWN

SPECIAL FUNCTION: 01

1 - NONE 6 - BUS - CHARTER/TOUR 11 - FIRE 16 - FARM 21 - MAIL CARRIER

2 - TAXI 7 - BUS - INTERCITY 12 - MILITARY 17 - MOWING 22 - OTHER JUNK

3 - ELECTRONIC RIDE SHARING 8 - BUS - SHUTTLE 13 - POLICE 18 - SNOW REMOVAL 19 - TOWING

4 - SCHOOL TRANSPORT 9 - BUS - OTHER 14 - PUBLIC UTILITY 20 - SAFETY SERVICE 26 - BICYCLE

5 - BUS-TRANSIT/COMMUNAL 10 - AMBULANCE 15 - CONSTRUCTION EQUIPMENT

CARGO BODY TYPE: 01

1 - NO CARGO BODY TYPE / NOT APPLICABLE 3 - VEHICLE TOWING ANOTHER MOTOR VEHICLE 4 - LOGGING 5 - INTERMODAL CONTAINER CHASSIS 6 - CARGO VAN/ENCLOSED 8 - POLE 9 - CARGO TANK 10 - FLAT BED 12 - CONCRETE MIXER 13 - AUTO TRANSPORTER 14 - GARBAGE/REFUSE

VEHICLE DEFECTS: 01

1 - TURN SIGNALS 2 - HEAD LAMPS 3 - TAIL LAMPS 4 - BRAKES 5 - STEERING 6 - TIRE BLOWOUT 7 - WORN OR SLICK TIRES 8 - TRAILER EQUIPMENT DIFF/TWIF 9 - MOTOR TROUBLE 10 - DISABLED FROM PRIOR ACCIDENT 99 - OTHER / UNKNOWN

NON-MOTORIST LOCATION AT IMPACT: 01

1 - INTERSECTION - MARKED CROSSWALK 2 - INTERSECTION - UNMARKED CROSSWALK 3 - INTERSECTION - OTHER 4 - MIDDLEBLOCK - MARKED CROSSWALK 5 - TRAVEL LANE-OTHER 6 - BICYCLE LANE 7 - SHOULDER/ROADS IDE 8 - SIDEWALK 9 - MEDIAN/CROSSING ISLAND 10 - DRIVEWAY ACCESS 11 - SHARED USE PATHS OR 12 - FIRST RESPONDER AT INCIDENT SCENE 99 - OTHER /

ACTION: 3

1 - NON-CONTACT 2 - NON-COLLISION 3 - STRIKING 4 - STRUCK 5 - BOTH STRIKING & STRUCK 9 - OTHER / UNKNOWN

PRE-CRASH ACTION: 01

1 - STRAIGHT AHEAD 2 - BACKING 3 - CHANGING LANES 4 - OVERTAKING/PASSING 5 - MAKING RIGHT TURN 7 - MAKING U-TURN 8 - ENTERING TRAFFIC LANE 9 - LEAVING TRAFFIC LANE 10 - PARKED 11 - SLOWING OR STOPPED IN TRAFFIC 13 - NEGOTIATING A CURVE 14 - ENTERING OR CROSSING SPECIFIED LOCATION 15 - WALKING, RUNNING, JOGGING, PLAYING 16 - WORKING VEHICLE 18 - APPROACHING OR LEAVING VEHICLE 19 - STANDING 20 - OTHER NON-MOTORIST 21 - STANDING OUTSIDE DISABLED VEHICLE

CONTRIBUTING CIRCUMSTANCES: 11

1 - NONE 2 - FAILURE TO YIELD 3 - RAN RED LIGHT 4 - RAN STOP SIGN 5 - UNSAFE SPEED 6 - IMPROPER TURN 7 - LEFT OF CENTER 8 - FOLLOWING TOO CLOSE/ACDA 9 - IMPROPER LANE CHANGING 10 - IMPROPER PASSING 11 - DROVE OFF ROAD 12 - IMPROPER BACKING 13 - IMPROPER START FROM A PARKED POSITION 14 - STOPPED OR PARKED ILLEGALLY 15 - SWERVING TO AVOID 16 - WRONG WAY 17 - VISION OBSTRUCTION 18 - OPERATING DEFECTIVE EQUIPMENT 19 - LOAD SHIFTING/FALLING/SPILLING 20 - IMPROPER CROSSING 21 - LYING IN ROADWAY 22 - NOT DISCERNABLE 23 - OPENING DOOR INTO ROADWAY 99 - OTHER IMPROPER ACTION

SEQUENCE OF EVENTS

EVENTS

1 08 1 - OVERTURN/ROLLOVER 6 - EQUIPMENT FAILURE 11 - CROSS CENTERLINE - OPPOSITE DIRECTION OF TRAVEL 16 - RAILWAY VEHICLE 22 - WORK ZONE MAINTENANCE EQUIPMENT

2 40 2 - FIRE/EXPLOSION 7 - SEPARATION OF UNITS 12 - DOWNHILL RUNAWAY 17 - ANIMAL - FARM 23 - STRUCK BY FALLING, SHIFTING CARGO OR ANYTHING SET IN MOTION BY A MOTOR

3 _____ 3 - IMMERSION 8 - RAN OFF ROAD RIGHT 13 - OTHER NON-COLLISION 18 - ANIMAL - DEER 24 - OTHER FIXED OBJECT

4 _____ 4 - JACKKNIFE 9 - RAN OFF ROAD LEFT 14 - PEDESTRIAN 19 - ANIMAL - OTHER 25 - OTHER / UNKNOWN

5 _____ 5 - CARGO / EQUIPMENT LOSS OR SHIFT 10 - DROVE OFF ROAD 15 - PEDALCYCLE 20 - MOTOR VEHICLE IN TRANSPORT 26 - BICYCLE

6 _____ 6 - IMPROPER TURN 11 - DROVE OFF ROAD 16 - WRONG WAY 21 - PARKED MOTOR VEHICLE 27 - TRAIN

COLLISION WITH FIXED OBJECT - STRUCK

25 - IMPACT ATTENUATOR / CRASH CUSHION 31 - GUARDRAIL END 37 - TRAFFIC SIGN POST 43 - CURB 50 - WORKZONE MAINTENANCE EQUIPMENT

26 - BRIDGE OVERHEAD STRUCTURE 32 - PORTABLE BARRIER 38 - OVERHEAD SIGN POST 44 - DITCH 51 - WALL

27 - BRIDGE PIER OR ABUTMENT STRUCTURE 33 - MEDIAN CABLE BARRIER 39 - LIGHT/LUMINARIES SUPPORT 45 - EMBANKMENT 52 - BUILDING

28 - BRIDGE PARAPET 34 - MEDIAN GUARDRAIL BARRIER 40 - UTILITY POLE 46 - FENCE 53 - TUNNEL

29 - BRIDGE RAIL 35 - MEDIAN CONCRETE BARRIER 41 - OTHER POST, POLE OR SUPPORT 47 - MAILBOX 54 - OTHER FIXED OBJECT

30 - GUARDRAIL FACE 36 - MEDIAN OTHER BARRIER 42 - CULVERT 48 - TREE 55 - OTHER / UNKNOWN

49 - FIRE HYDRANT

FIRST HARMFUL EVENT: 1

MOST HARMFUL EVENT: 2

LOCAL REPORT

2 0 2 2 3 4 4 7

DAMAGE

DAMAGE SCALE

4

1 - NONE 2 - MINOR DAMAGE 3 - FUNCTIONAL DAMAGE 4 - DISABLING

9 - UNKNOWN

DAMAGED AREA(S)

INDICATE ALL THAT APPLY

- NO DAMAGE [0] - UNDERCARRIAGE [1]

- TOP [13] - ALL AREAS [15]

- UNIT NOT AT SCENE [16]

INITIAL POINT OF CONTACT

0

0 - NO DAMAGE 14 - UNDERCARRIAGE

1-12 - REFER TO UNIT DIAGRAM 15 - VEHICLE NOT AT SCENE

13 - TOP

TRAFFIC

TRAFFICWAY FLOW

2

1 - ONE-WAY 2 - TWO-WAY

TRAFFIC CONTROL

6

1 - ROUNDABOUT 2 - SIGNAL 4 - STOP SIGN 5 - YIELD SIGN 6 - NO CONTROL

OF THROUGH LANES

4

RAIL GRADE CROSSING

0

1 - NOT INVOLVED 2 - INVOLVED - ACTIVE CROSSING 3 - INVOLVED - PASSIVE CROSSING

UNIT / NON-MOTORIST DIRECTION

FROM 4 TO 3

1 - NORTH 2 - SOUTH 3 - EAST 4 - WEST 5 - NORTHEAST 6 - NORTHWEST 7 - SOUTHEAST 8 - SOUTHWEST 9 - OTHER / UNKNOWN

UNIT SPEED

25

POSTED SPEED

25

DETECTED SPEED

1

1 - STATED/ESTIMATED SPEED 2 - CALCULATED / EDR 3 - UNDETERMINED

MOTORIST / NON-MOTORIST

LOCAL REPORT NUMBER
2 0 2 2 3 4 4 7

UNIT # 0 1	NAME: LAST, FIRST, MIDDLE MISLOSKY JOSEPH MICHAEL		DATE OF BIRTH 0 3 2 0 1 9 8 4		AGE 3 8	GENDER M				
ADDRESS: STREET, CITY, STATE, ZIP 53 WANDLE AV BEDFORD OH 44146					CONTACT PHONE - INCLUDE AREA CODE					
INJURIES 5	INJURE D TAKEN	EMS AGENCY (NA ME)	INJURED TAKEN TO: MEDICAL FACILITY (NAME, CITY)	SAFETY EQUIPMENT USED 0 4	<input type="checkbox"/> DOT-COMPLIANT MC HELMET	SEATING POSITION 0 1	AIR BAG USAGE 1	EJECTION 1	TRAPPED 1	
OL STATE	OPERATOR LICENSE NUMBER	OFFENSE CHARGED 331.34	LOCAL CODE ■	OFFENSE DESCRIPTION FAILURE TO ONTROL	CITATION NUMBER G20222699					
OL CLASS 4	ENDORSEME NT	RESTRICTION SELECT UP TO 3	DRIVER DISTRACTE 1	ALCOHOL / DRUG SUSPECTED <input type="checkbox"/> ALCOHOL <input type="checkbox"/> MARIJUANA <input type="checkbox"/> OTHER DRUG	CONDITION 1	STATUS 1	ALCOHOL TEST TYPE VALUE STATUS	DRUG TEST(S) TYPE RESULT SELECT UP TO 4		

UNIT #	NAME: LAST, FIRST, MIDDLE		DATE OF BIRTH		AGE	GENDER				
ADDRESS: STREET, CITY, STATE, ZIP					CONTACT PHONE - INCLUDE AREA CODE					
INJURIES	INJURE D TAKEN	EMS AGENCY (NA ME)	INJURED TAKEN TO: MEDICAL FACILITY (NAME, CITY)	SAFETY EQUIPMENT USED	<input type="checkbox"/> DOT-COMPLIANT MC HELMET	SEATING POSITION	AIR BAG USAGE	EJECTION	TRAPPED	
OL STATE	OPERATOR LICENSE NUMBER	OFFENSE CHARGED	LOCAL CODE	OFFENSE DESCRIPTION	CITATION NUMBER					
OL CLASS	ENDORSEME NT	RESTRICTION SELECT UP TO 3	DRIVER DISTRACTE	ALCOHOL / DRUG SUSPECTED <input type="checkbox"/> ALCOHOL <input type="checkbox"/> MARIJUAN <input type="checkbox"/> OTHER DRUG	CONDITION	STATUS	ALCOHOL TEST TYPE VALUE STATUS	DRUG TEST(S) TYPE RESULT SELECT UP TO 4		

UNIT #	NAME: LAST, FIRST, MIDDLE		DATE OF BIRTH		AGE	GENDER				
ADDRESS: STREET, CITY, STATE, ZIP					CONTACT PHONE - INCLUDE AREA CODE					
INJURIES	INJURE D TAKEN	EMS AGENCY (NA ME)	INJURED TAKEN TO: MEDICAL FACILITY (NAME, CITY)	SAFETY EQUIPMENT USED	<input type="checkbox"/> DOT-COMPLIANT MC HELMET	SEATING POSITION	AIR BAG USAGE	EJECTION	TRAPPED	
OL STATE	OPERATOR LICENSE NUMBER	OFFENSE CHARGED	LOCAL CODE	OFFENSE DESCRIPTION	CITATION NUMBER					
OL CLASS	ENDORSEME NT	RESTRICTION SELECT UP TO 3	DRIVER DISTRACTE	ALCOHOL / DRUG SUSPECTED <input type="checkbox"/> ALCOHOL <input type="checkbox"/> MARIJUAN <input type="checkbox"/> OTHER DRUG	CONDITION	STATUS	ALCOHOL TEST TYPE VALUE STATUS	DRUG TEST(S) TYPE RESULT SELECT UP TO 4		

INJURIES	SEATING POSITION	AIR BAG	OL CLASS	OL RESTRICTION(S)	DRIVER DISTRACTION	TEST STATUS
1 - FATAL	1 - FRONT - LEFT SIDE (MOTORCYCLE DRIVER)	1 - NOT DEPLOYED	1 - CLASS A	1 - ALCOHOL INTERLOCK DEVICE	1 - NOT DISTRACTED	1 - NONE GIVEN
2 - SUSPECTED SERIOUS INJURY	2 - FRONT - MIDDLE	2 - DEPLOYED FRONT	2 - CLASS B	2 - CDL INTRASTATE ONLY	2 - MANUALLY OPERATING AN ELECTRONIC COMMUNICATION DEVICE (TEXTING, TYPING, DIALING)	2 - TEST REFUSED
3 - SUSPECTED MINOR INJURY	3 - FRONT - RIGHT SIDE	3 - DEPLOYED SIDE	3 - CLASS C	3 - CORRECTIVE LENSES	3 - TALKING ON HANDS-FREE COMMUNICATION DEVICE	3 - TEST GIVEN, CONTAMINATED SAMPLE / UNUSABLE
4 - POSSIBLE INJURY	4 - SECOND - LEFT SIDE (MOTORCYCLE PASSENGER)	4 - DEPLOYED BOTH FRONT / SIDE	4 - REGULAR CLASS (OHIO = D)	4 - FARM WAIVER	4 - TALKING ON HAND-HELD COMMUNICATION DEVICE	4 - TEST GIVEN, RESULTS KNOWN
5 - NO APPARENT INJURY	5 - SECOND - MIDDLE	5 - NOT APPLICABLE	5 - M / C MOPED ONLY	5 - EXCEPT CLASS A BUS	5 - OTHER ACTIVITY WITH AN ELECTRONIC DEVICE	5 - TEST GIVEN, RESULTS KNOWN
INJURED TAKEN BY	6 - SECOND - RIGHT SIDE	9 - DEPLOYMENT UNKNOWN	6 - NO VALID OL	6 - EXCEPT CLASS A & CLASS B BUS	6 - PASSENGER	ALCOHOL TEST TYPE
1 - NOT TRANSPORTED /TREATED AT SCENE	7 - THIRD - LEFT SIDE (MOTORCYCLE SIDE CAR)	EJECTION	OL ENDORSEMENT	7 - EXCEPT TRACTOR-TRAILER	7 - OTHER DISTRACTION INSIDE THE VEHICLE	1 - NONE
2 - EMS	8 - THIRD - MIDDLE	1 - NOT EJECTED	H - HAZMAT	8 - INTERMEDIATE LICENSE RESTRICTIONS	8 - OTHER DISTRACTIONS OUTSIDE THE VEHICLE	2 - BLOOD
3 - POLICE	9 - THIRD - RIGHT SIDE	2 - PARTIALLY EJECTED	M - MOTORCYCLE	9 - LEARNER'S PERMIT RESTRICTIONS	9 - OTHER / UNKNOWN	3 - URINE
9 - OTHER / UNKNOWN	10 - SLEEPER SECTION OF TRUCK CAB	3 - TOTALLY EJECTED	P - PASSENGER	10 - LIMITED TO DAYLIGHT ONLY	CONDITION	4 - BREATH
SAFETY EQUIPMENT	11 - PASSENGER IN OTHER ENCLOSED CARGO AREA (NON-TRAILING UNIT, BUS, PICK-UP WITH CAP)	4 - NOT APPLICABLE	N - TANKER	11 - LIMITED TO EMPLOYMENT	1 - APPARENTLY NORMAL	5 - OTHER
1 - NONE USED	12 - PASSENGER IN UNENCLOSED CARGO AREA	TRAPPED	Q - MOTOR SCOOTER	12 - LIMITED - OTHER	2 - PHYSICAL IMPAIRMENT	DRUG TEST TYPE
2 - SHOULDER BELT ONLY USED	13 - TRAILING UNIT	1 - NOT TRAPPED	R - THREE-WHEEL MOTORCYCLE	13 - MECHANICAL DEVICES (SPECIAL BRAKES, HAND CONTROLS, OR OTHER ADAPTIVE DEVICES)	3 - EMOTIONAL (E.G. DEPRESSED, ANGRY, DISTURBED)	1 - NONE
3 - LAP BELT ONLY USED	14 - RIDING ON VEHICLE EXTERIOR (NON-TRAILING UNIT)	2 - EXTRICATED BY MECHANICAL MEANS	S - SCHOOL BUS	14 - MILITARY VEHICLES ONLY	4 - ILLNESS	2 - BLOOD
4 - SHOULDER & LAP BELT USED	15 - NON-MOTORIST	3 - FREED BY NON-MECHANICAL MEANS	T - DOUBLE & TRIPLE TRAILERS	15 - MOTOR VEHICLES WITHOUT AIR BRAKES	5 - FELL ASLEEP, FAINTED, FATIGUED, ETC.	3 - URINE
5 - CHILD RESTRAINT SYSTEM - FORWARD FACING	99 - OTHER / UNKNOWN		X - TANKER / HAZMAT	16 - OUTSIDE MIRROR	6 - UNDER THE INFLUENCE OF MEDICATIONS / DRUGS / ALCOHOL	4 - OTHER
6 - CHILD RESTRAINT SYSTEM - REAR FACING			GENDER	17 - PROSTHETIC AID	9 - OTHER / UNKNOWN	DRUG TEST RESULT(S)
7 - BOOSTER SEAT			F - FEMALE	18 - OTHER		1 - AMPHETAMINES
8 - HELMET USED			M - MALE			2 - BARBITURATES
9 - PROTECTIVE PADS USED (ELBOWS, KNEES, ETC.)			U - OTHER/UNKNOWN			3 - BENZODIAZEPINES
10 - REFLECTIVE CLOTHING						4 - CANNABINOIDS
11 - LIGHTING - PEDESTRIAN / BICYCLE ONLY						5 - COCAINE
99 - OTHER / UNKNOWN						6 - OPIATES / OPIOIDS
						7 - OTHER
						8 - NEGATIVE RESULTS