

Sample Site plan

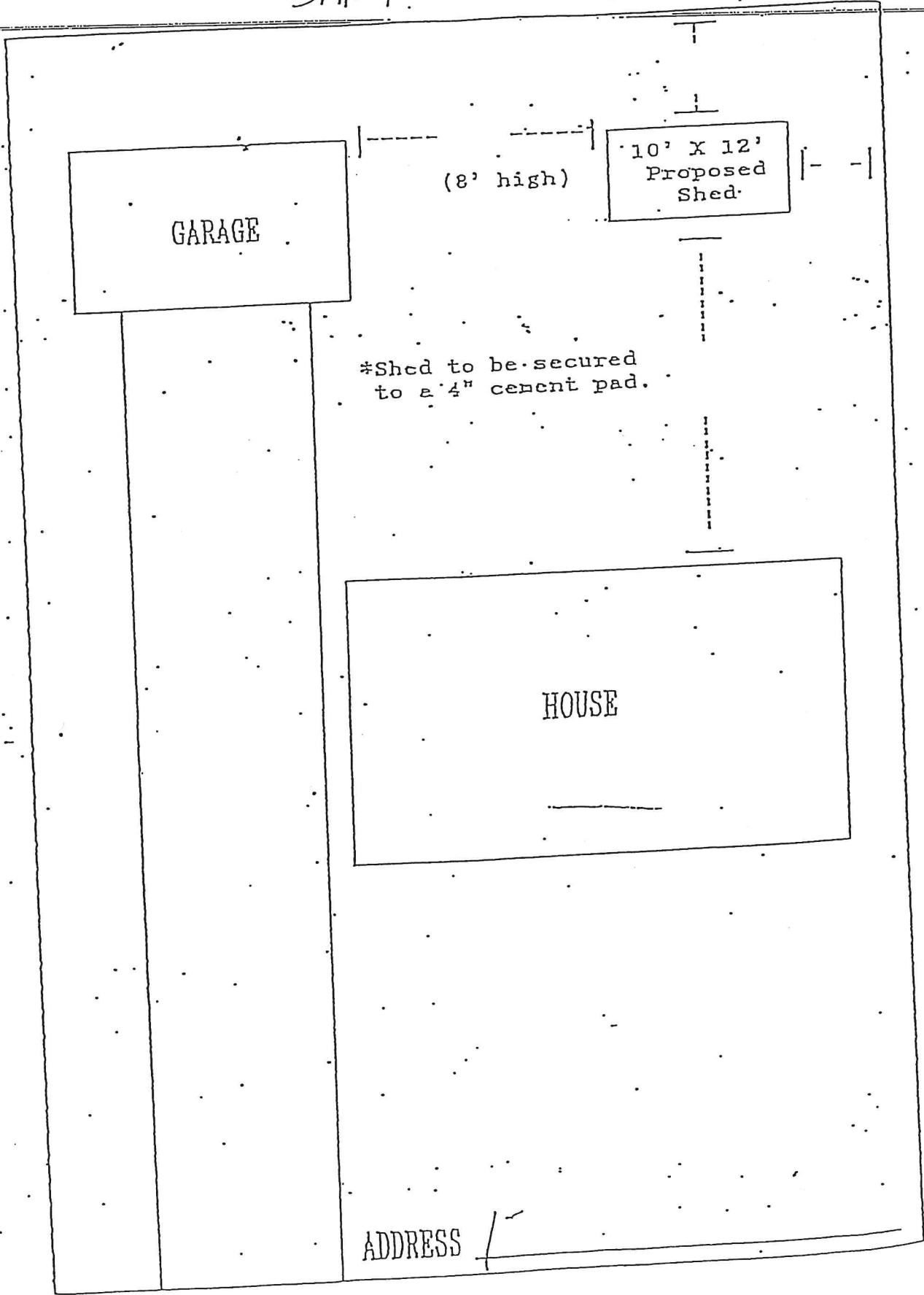

GARAGE

(8' high)

10' X 12'
Proposed
Shed

*Shed to be secured
to a 4" cement pad.

HOUSE

ADDRESS

CHAPTER 1143
Accessory Uses in Residence Districts

**1143.01 Permitted accessory uses;
garages, parking.**

1143.02 Signs; home occupations.

CROSS REFERENCES

Parking generally - see TRAF. Ch. 351
Off-street parking - see TRAF. Ch. 353
Accessory use defined - see P.& Z. 1121.02
Residence districts - see P.& Z. Ch. 1133
Use limitations - see P.& Z. 1145.01

(c) Utility or Storage Sheds. In any residential district, one utility shed and/or storage shed is permitted. The utility shed and/or storage shed shall be placed on a cement pad of at least four-inch thickness and such utility or storage shed shall be secured thereto. Utility or storage sheds shall be limited to 120 square feet and not to exceed eight feet in height.
(Ord. 78-1992. Passed 9-28-92.)